

PACIFIC FISHERY MANAGEMENT COUNCIL

CHAIR'S RECEPTION



Sunday, September 13, 2009

6:00 p.m.

**Marco Polo Room
Crowne Plaza Hotel
Foster City, California**

TO BE RETAINED BY OPERATORS OF HOTELS
MOTELS, AND SIMILAR ACCOMMODATIONS AS
EVIDENCE OF EXEMPT OCCUPANCY

EXEMPTION CERTIFICATE
TAX ON OCCUPANCY
OF HOTEL ROOMS

Imposed Pursuant to
Articles 28 and 29 of the Tax Law

NAME OF HOTEL, APARTMENT HOTEL, OR LODGING HOUSE

Crowne Plaza Hotel

DATES

September 9-18, 2009

ADDRESS

**1221 Chess Drive
Foster City, CA 94404**

This is to certify that the above individuals are representatives of the United States Governmental department, agency or instrumentality indicated below; that the charges for the occupancy at the above establishment on the dates set forth below have been or will be paid for by such governmental unit; and that such charges are incurred in the performance of official duties as representatives or employees of such governmental unit.

DATES OF
OCCUPANCY

Group Name: Pacific Fishery
Management Council
Dates: September 9-18, 2009

SIGNATURE

GOVERNMENTAL
UNIT

DOC/NOAA/NMFS/
Pacific Fishery Management Council

TITLE



The Pacific Fishery Management Council is a federal instrumentality operating under authority of the United States Department of Commerce, National Oceanic and Atmospheric Administration.





Council Meeting Schedule for 2009-2010

2009	
WEEK OF	LOCATION
March 8-13, 2009 Advisory Bodies may begin Fri, March 6 Council Session begins Sun, March 8	Seattle Airport Marriott 3201 S. 176th Street - Seattle, WA 98188 Phone: (206) 241-2000 or (800) 314-0925
April 4-9, 2009 Advisory Bodies may begin Thu, April 2 Council Session begins Sat, Apr 4	The Westin San Francisco Airport 1 Old Bayshore Highway - Millbrae, CA 94030 Phone: 1-888-627-8404
June 13-18, 2009 Advisory Bodies may begin Thu, June 11 Council Session begins Sat, June 13	DoubleTree Hotel Spokane City Center 322 North Spokane Falls Court Spokane, WA 99201 Phone: 1-509-455-9600
September 12-17, 2009 Advisory Bodies may begin Thu, Sep 10 Council Session begins Sat, Sep 12	Crowne Plaza - Mid Peninsula 1221 Chess Dr - Foster City, CA 94404 Phone: 1-650-570-5700
October 31-November 5, 2009 Advisory Bodies may begin Thu, Oct 29 Council Session begins Sat, Oct 31	Hilton Orange County/Costa Mesa 3050 Bristol Street - Costa Mesa, CA 92626 Phone: 714-540-7000
2010	
WEEK OF	LOCATION
March 6-12, 2010 Advisory Bodies may begin Thu, March 4 Council Session begins Sat, March 6	DoubleTree Hotel Sacramento 2001 Point West Way - Sacramento, CA 95815 Phone: 916-929-8855
April 10-15, 2010 Advisory Bodies may begin Thu, April 8 Council Session begins Sat, April 10	Sheraton Portland Airport Hotel 8235 NE Airport Way - Portland, OR 97220 Phone: 503-249-7606
June 12-17, 2010 Advisory Bodies may begin Thu, June 10 Council Session begins Sat, June 12	Crowne Plaza Hotel Foster City 1221 Chess Dr - Foster City, CA 94404 Phone: 650-570-5700
September 11-16, 2010 Advisory Bodies may begin Thu, Sept 9 Council Session begins Sat, Sept 11	Doubletree Hotel Boise Riverside 2900 Chinden Blvd - Boise, ID 83714 Phone: 208-343-1871
**November 4-November 9, 2010 Advisory Bodies may begin Tue, Nov 2 Council Session begins Thu, Nov 4	Hilton Orange County/Costa Mesa 3050 Bristol Street - Costa Mesa, CA 92626 Phone: 714-540-7000

PFMC

8/27/2009

****Note: November 2010 meeting dates have changed from previously published Council Meeting Schedule.**

DIRECTIONS

CROWNE PLAZA HOTEL, MID PENINSULA

1221 Chess Drive
Foster City, CA 94404
650.570.5700

SAN FRANCISCO

101 South to Hwy 92 East (Towards San Mateo Bridge / Hayward)
Exit Foster City Blvd., Left on Metro Center Blvd.
Left on Foster City Blvd., Left on Chess Drive.
Hotel is on the left.

SAN JOSE

101 North to Hwy 92 East (Towards San Mateo Bridge / Hayward)
Exit Foster City Blvd.
Left on Metro Center Blvd., Left on Foster City Blvd., Left on Chess Drive.
Hotel is on the left.

EAST BAY/OAKLAND/HAYWARD

880 South
Exit Jackson Street / San Mateo Bridge (\$2 toll)
After Crossing Bridge, Exit Foster City Blvd., Left at Chess Drive (Stop Light)
Hotel in on the left.

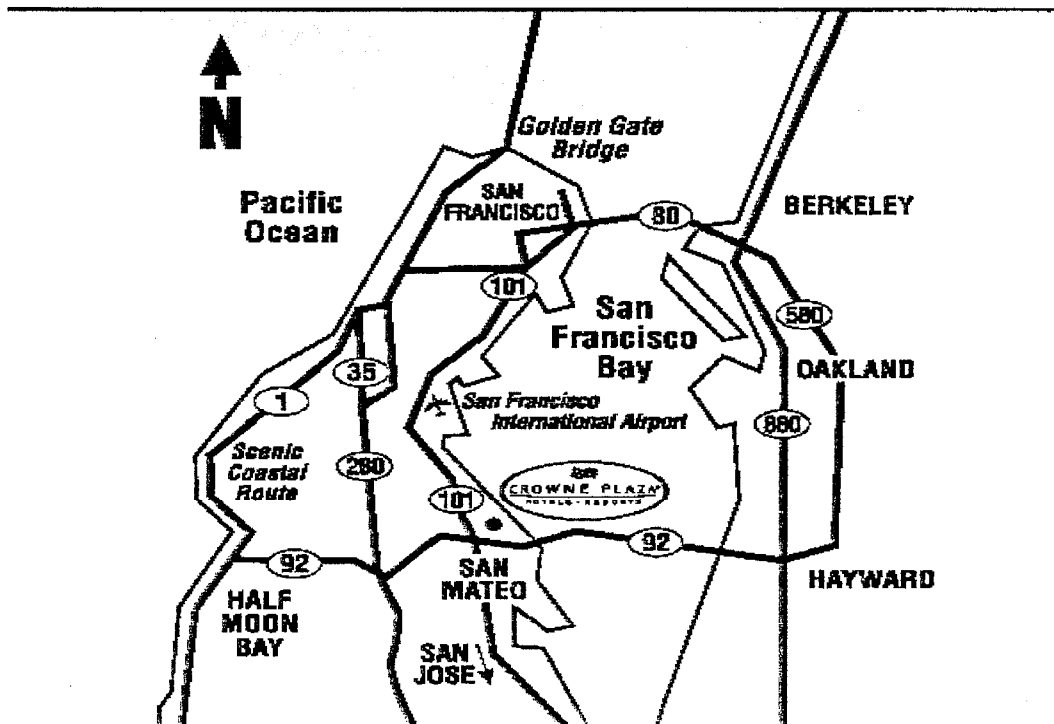

FOSTER CITY
650.570.5700

Key to Hotel Meeting Rooms on the *Main Floor*:

Committee	Meeting Room	Number on Diagram
Budget Committee	Yale	①
California Delegation	Alexandria II-III	②
Coastal Pelagic Species Mgt Team	Drake II	③
Council Office	Syracuse	④
Enforcement Consultants	Yale	①
Groundfish Advisory Subpanel	Alexandria II-III	②
Groundfish Management Team	Alexandria I	⑤
Habitat Committee	Stanford	⑥
Highly Migratory Species Mgt Team	Drake I & Yale	⑦ and ①
Oregon Delegation	Stanford	⑥
Salmon Advisory Subpanel	Drake I	⑦
Salmon Technical Team	Stanford	⑥
Scientific & Statistical Committee	Drake II	③
Washington Delegation	Drake I	⑦

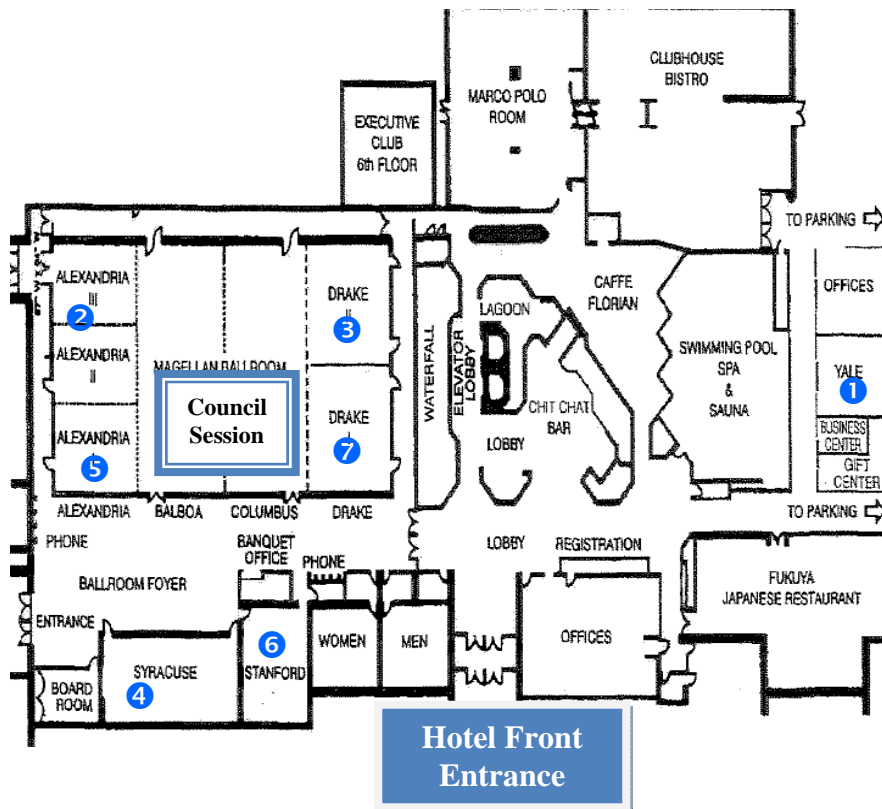

RESTAURANT LIST

CROWNE PLAZA HOTEL
1221 CHESS DRIVE
FOSTER CITY, CA 94404

- 1. Tokai Japanese Restaurant**
1221 Chess Dr
Foster City, CA
650-341-6888
- 2. El Torito Mexican Grill**
388 Vintage Park Dr
Foster City, CA
650-574-6844
- 3. Harry's Hofbrau**
1297 Chess Dr
Foster City, CA
650-349-8411
- 4. Black Angus Steakhouse**
1299 Chess Dr
Foster City, CA
650-345-9971
- 5. Noah's Bagels**
1000 Metro Center Blvd # D
Foster City, CA
650-574-7727
- 6. Boston Market**
1000 Metro Center Blvd # A
Foster City, CA
650-572-1700
- 7. Jamba Juice**
1000 Metro Center Blvd # B
Foster City, CA
650-571-6200
- 8. Savini**
950 Tower Ln # 100
Foster City, CA
650-572-0330
- 9. Mc Donald's**
1101 Triton Dr
Foster City, CA
650-341-4832
- 10. Armadillo Willy's Barbeque**
2260 Bridgepointe Pkwy
San Mateo, CA
650-571-7427

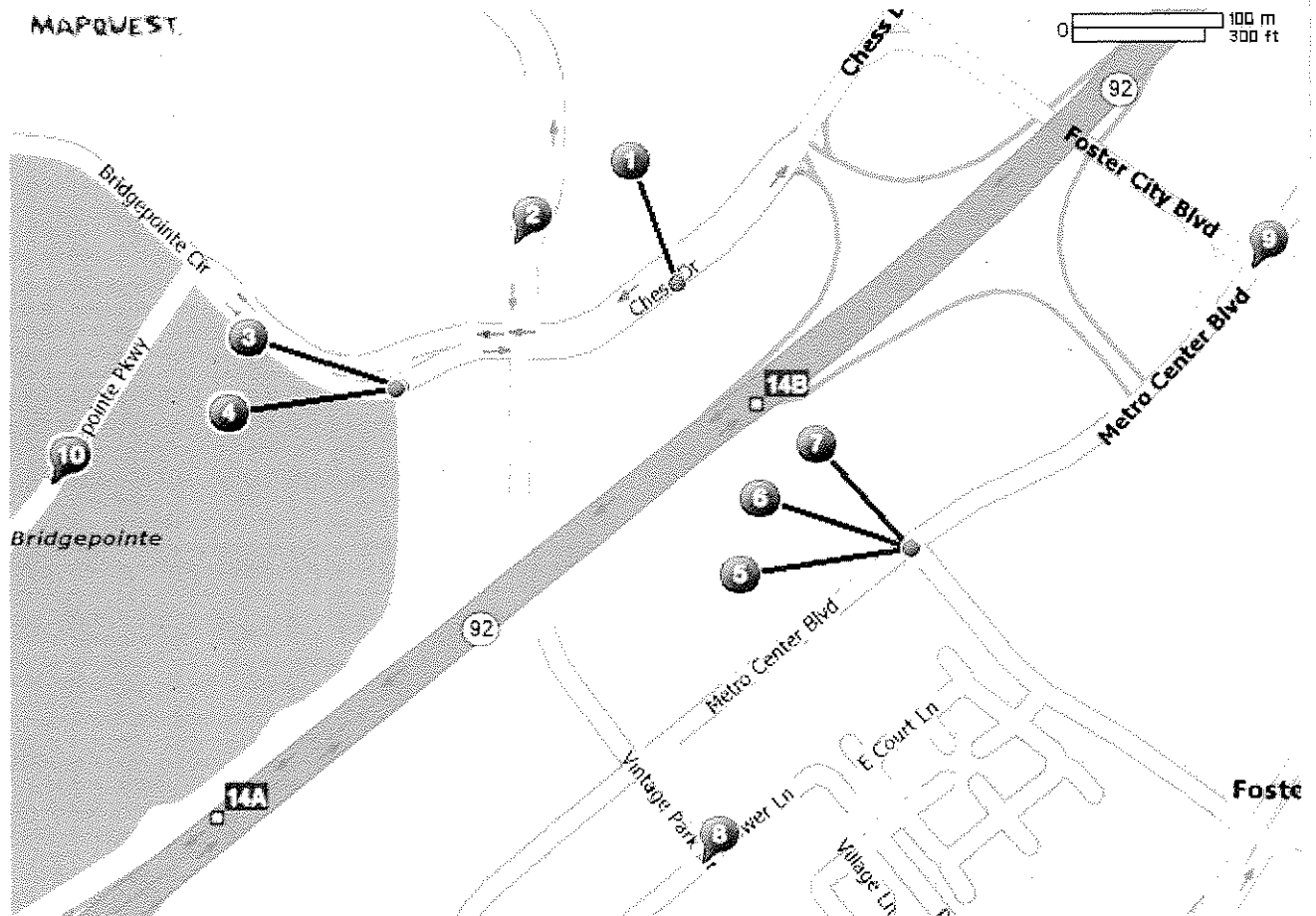

11. IHOP Restaurant
531 Foster City Blvd
Foster City, CA
650-573-8887

12. Taco Bell
1131 Triton Dr
Foster City, CA
650-572-8038

13. Carl's Jr
1140 Triton Dr
Foster City, CA
650-349-1221

14. Pizza Hut
1141 Triton Dr
Foster City, CA
650-345-3511

15. Baja Fresh Mexican Grill
1031 E Hillsdale Blvd
Foster City, CA
650-358-8632

16. Century Cafe
1065 E Hillsdale Blvd # 101
Foster City, CA
650-571-8097

17. Bon Appetite
2215 Bridgepointe Pkwy
San Mateo, CA
650-638-9678

18. Turtle Bay Grill & Seafood
981 E Hillsdale Blvd
Foster City, CA
650-286-1788

19. Mimi's Cafe
2208 Bridgepointe Pkwy
San Mateo, CA
650-574-8767

20. ABC Sea Food Restaurant
973 E Hillsdale Blvd
Foster City, CA
650-358-0566

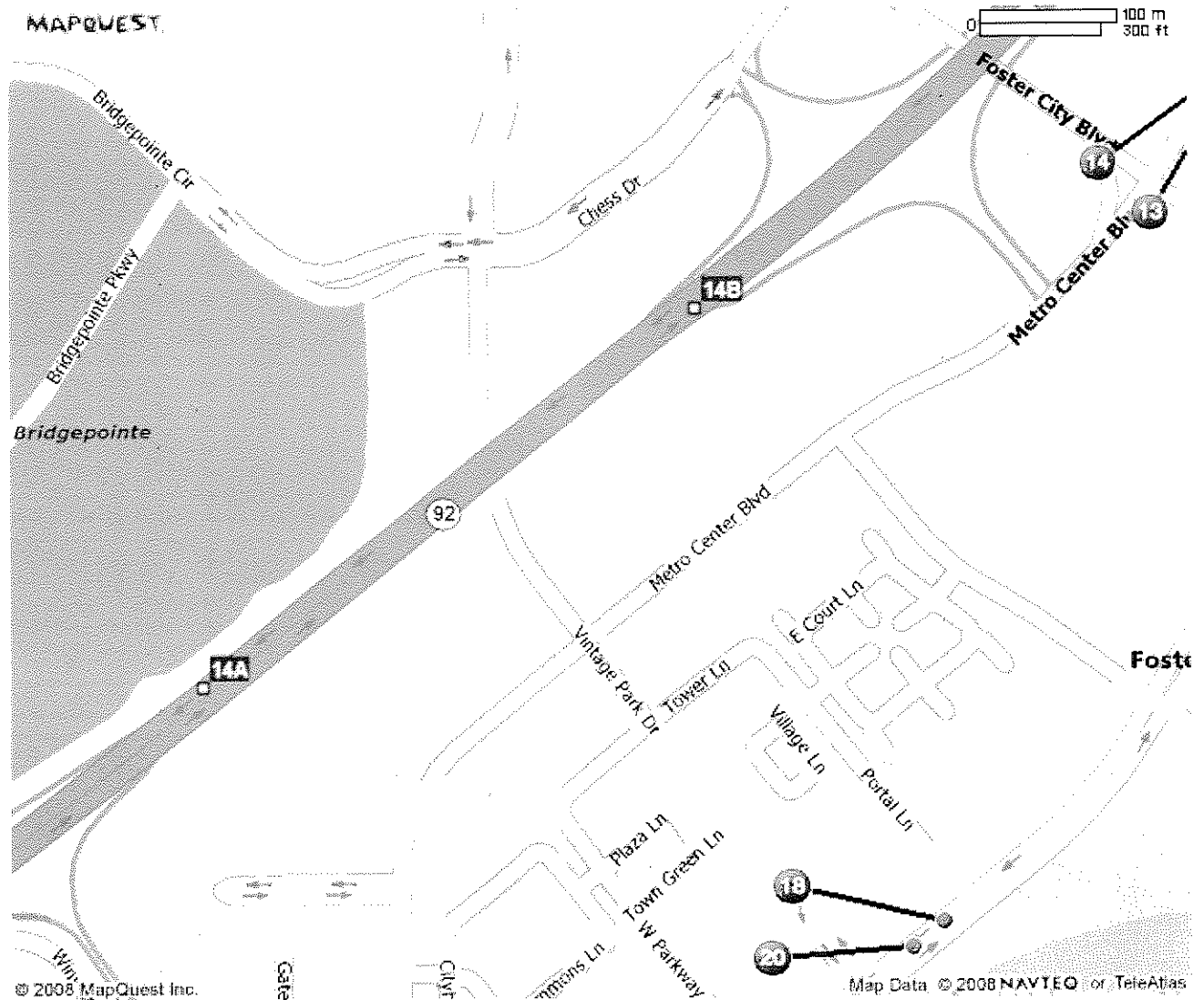

COUNCIL MEETING ROOM DIAGRAM- Crowne Plaza Foster City, CA

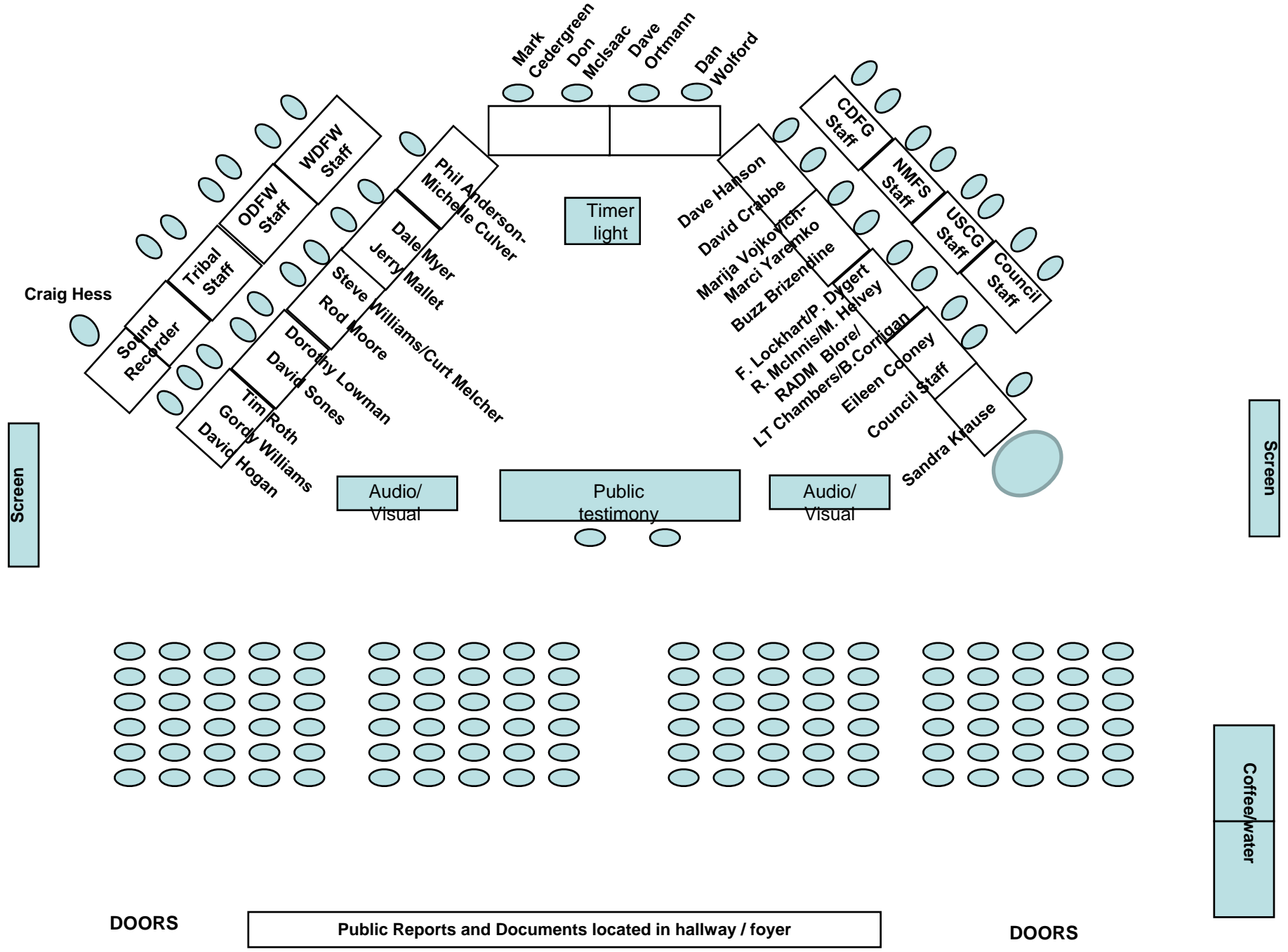

PACIFIC FISHERY MANAGEMENT COUNCIL

CHAIR'S RECEPTION



Sunday, September 13, 2009

6:00 p.m.

**Marco Polo Room
Crowne Plaza Hotel
Foster City, California**

TO BE RETAINED BY OPERATORS OF HOTELS
MOTELS, AND SIMILAR ACCOMMODATIONS AS
EVIDENCE OF EXEMPT OCCUPANCY

EXEMPTION CERTIFICATE
TAX ON OCCUPANCY
OF HOTEL ROOMS

Imposed Pursuant to
Articles 28 and 29 of the Tax Law

NAME OF HOTEL, APARTMENT HOTEL, OR LODGING HOUSE

Crowne Plaza Hotel

DATES

September 9-18, 2009

ADDRESS

**1221 Chess Drive
Foster City, CA 94404**

This is to certify that the above individuals are representatives of the United States Governmental department, agency or instrumentality indicated below; that the charges for the occupancy at the above establishment on the dates set forth below have been or will be paid for by such governmental unit; and that such charges are incurred in the performance of official duties as representatives or employees of such governmental unit.

DATES OF
OCCUPANCY

Group Name: Pacific Fishery
Management Council
Dates: September 9-18, 2009

SIGNATURE

GOVERNMENTAL
UNIT

DOC/NOAA/NMFS/
Pacific Fishery Management Council

TITLE



The Pacific Fishery Management Council is a federal instrumentality operating under authority of the United States Department of Commerce, National Oceanic and Atmospheric Administration.



MEMBERSHIP ROSTER



SEPTEMBER 2009



Roster published by the Pacific Fishery Management Council pursuant to National Oceanic and Atmospheric Administration contract number NA05NMF4410008.

TABLE OF CONTENTS

PACIFIC FISHERY MANAGEMENT COUNCIL:

Council Staff.....	2
Legal Staff	2
Council Members.....	3
STANDING COMMITTEES.....	5
REPRESENTATIVES TO OTHER FORUMS.....	5

ADVISORY BODIES:

Coastal Pelagic Species Advisory Subpanel.....	6
Coastal Pelagic Species Management Team.....	7
Enforcement Consultants	8
Groundfish Allocation Committee – Voting Members.....	9
Groundfish Allocation Committee – Non-Voting.....	9
Groundfish Advisory Subpanel.....	10
Groundfish Management Team.....	12
Habitat Committee.....	13
Highly Migratory Species Advisory Subpanel.....	14
Highly Migratory Species Management Team.....	15
Model Evaluation Workgroup.....	16
Salmon Advisory Subpanel.....	16
Salmon Technical Team.....	18
Scientific and Statistical Committee.....	19

AD HOC COMMITTEES:

Coastal Pelagic Species Tribal Allocation Committee.....	20
Groundfish Essential Fish Habitat Review Committee	20
Groundfish Trawl Individual Quota Committee.....	20
Highly Migratory Species Management Committee	20
Marine Protected Area Committee	20
Salmon Plan Amendment Committee.....	21
Shore-based Whiting Amendment Workgroup.....	21
Trawl Individual Quota Enforcement Group	21
Trawl Individual Quota Independent Experts Panel	21
Trawl Rationalization Tracking and Monitoring Committee	21
Vessel Monitoring System Committee	21

ACRONYMS	21
-----------------------	----

PACIFIC FISHERY MANAGEMENT COUNCIL

7700 NE Ambassador Place, Suite 101 – Portland, Oregon 97220-1384
Telephone 503-820-2280 – Toll Free 866-806-7204 – Fax: 503-820-2299
Website www.pcouncil.org

COUNCIL STAFF

Donald O. McIsaac Executive Director
Donald.McIsaac@noaa.gov

John C. Coon Deputy Director
John.Coon@noaa.gov

<u>Name</u>	<u>Title</u>	<u>Extension</u>	<u>Email</u>
Heather Brandon	Fishery Management Policy Analyst	409	Heather.Brandon@noaa.gov
Merrick Burden	Staff Officer: Groundfish	423	Merrick.Burden@noaa.gov
Mike Burner	Staff Officer: Coastal Pelagic Species, Scientific and Statistical Committee	414	Mike.Burner@noaa.gov
Kit Dahl	Staff Officer: NEPA, Highly Migratory Species	422	Kit.Dahl@noaa.gov
John DeVore	Staff Officer: Groundfish	413	John.Devore@noaa.gov
Renee Dorval	Administrative Specialist	420	Renee.Dorval@noaa.gov
Jennifer Gilden	Associate Staff Officer: Information, Communications, Habitat	418	Jennifer.Gilden@noaa.gov
Donald Hansen	Special Assistant to the Executive Director		Don.Hansen@noaa.gov
Sandra Krause	Information Technology Specialist	419	Sandra.Krause@noaa.gov
Kim Merydith	Administrative Specialist	421	Kimberly.Merydith@noaa.gov
Carrie Montgomery	Administrative Specialist	425	Carrie.Montgomery@noaa.gov
Carolyn Porter	Executive Specialist	411	Carolyn.Porter@noaa.gov
Jim Seger	Staff Officer: Fishery Economics	416	Jim.Seger@noaa.gov
Chuck Tracy	Staff Officer: Salmon, Pacific Halibut	415	Chuck.Tracy@noaa.gov
Mary Wilson	Fiscal Specialist	408	Mary.Wilson@noaa.gov

LEGAL COUNSEL

Eileen Cooney
Northwest Regional Counsel

National Oceanic and Atmospheric
Administration, Office of General
Counsel
7600 Sand Point Way NE, BIN C15700
Seattle, WA 98115-6300

Telephone: 206-526-6075
Fax:
Email: Eileen.Cooney@noaa.gov

Judson Feder
Southwest Regional Counsel

National Oceanic and Atmospheric
Administration, Office of General
Counsel
501 West Ocean Boulevard
Long Beach, CA 90802-4213

Telephone: 562-980-4067
Fax:
Email: Judson.Feder@noaa.gov

COUNCIL MEMBERS

ANDERSON, MR. PHIL State of Washington Principal Official	Deputy Director, Washington Dept. of Fish and Wildlife 600 Capitol Way N Olympia, WA 98501-1091	Telephone: 360-902-2720 Fax: 360-902-2947 Email: anderpma@dfw.wa.gov
1st Designee: Ms. Michele Culver 2nd Designee: Mr. Pat Pattillo	Michele.Culver@dfw.wa.gov patrick.pattillo@dfw.wa.gov	Telephone: 360-249-1211 Telephone: 360-902-2705
BLORE, RADM GARY (nonvoting) U.S. Coast Guard	U.S. Coast Guard 915 Second Ave, Rm 3590 Seattle, WA 98174-1067	Telephone: 206-220-7090 Fax: 206-220-7306 Email: gary.t.blore@uscg.mil
1st Designee: LCDR Brian Chambers 2nd Designee: Mr. Brian Corrigan	robert.b.chambers@uscg.mil brian.p.corrigan@uscg.mil	Telephone: 206-220-7305 Telephone: 206-220-7309
BRIZENDINE, MR. BUZZ At-Large Appointment	2838 Garrison Street San Diego, CA 92106	Telephone: 619-933-7828 Fax: Email: buzzandjulie@cox.net
CEDERGREEN, MR. MARK Vice Chair Washington Obligatory Appointment	Westport Charterboat Association PO Box 546 Westport, WA 98595-0546	Telephone: 360-268-0445 Fax: 360-268-9285 Email: mcedergreen@olynet.com
CRABBE, MR. DAVID California Obligatory Appointment	Mission Street – 2 SE of Vista Carmel, CA 93923	Telephone: 831-622-6826 Fax: Email: dcrabbe@comcast.net
ELICKER, MR. ROY State of Oregon Principal Official	Director, Oregon Dept. of Fish and Wildlife 3406 Cherry Ave NE Salem, OR 97303	Telephone: 503-947-6000 Fax: 503-947-6042 Email: roy.elicker@state.or.us
1st Designee: Mr. Stephen Williams 2nd Designee: Mr. Curt Melcher	stephen.h.williams@state.or.us curt.melcher@state.or.us	Telephone: 503-947-6209 Telephone: 503-947-6044
GROEN, MR. CAL State of Idaho Principal Official	Director, Idaho Dept. of Fish and Game PO Box 25 Boise, ID 83707-0025	Telephone: 208-334-3772 Fax: 208-334-4885 Email: Cgroen@idfg.idaho.gov
Designee: Mr. Jerry Mallet	mallet36@q.com	Telephone: 208-377-4595
HANSON, DR. DAVID (nonvoting) Parliamentarian PSMFC Appointment	Pacific States Marine Fisheries Commission 3468 22nd Street NW Hackensack, MN 56452	Telephone: 218-675-5231 Fax: 503-595-3232 Email: dave_hanson@psmfc.org
HOGAN, MR. DAVID (nonvoting) U.S. State Dept.	U.S. Dept. of State 2201 C St NW, Ste 7820 Washington, DC 20520	Telephone: 202-647-3941 Fax: 202-736-7350 Email: HoganDF@State.gov
Designee: Ms. Amanda Johnson-Miller		Telephone: 202-736-7350
KOCH, MR. DONALD State of California Principal Official	Director, California Dept. of Fish and Game 1416 Ninth Street Sacramento, CA 95814	Telephone: 916-653-7667 Fax: 916-653-7387 Email: director@dfg.ca.gov
1 st Designee: Ms. Marija Vojkovich 2 nd Designee: Mr. Sonke Mastrup 3 rd Designee: Ms. Marci Yaremko	mvojkovich@dfg.ca.gov smastrup@dfg.ca.gov myaremko@dfg.ca.gov	Telephone: 805-568-1246 Telephone: 916-653-4673 Telephone: 805-568-1220

COUNCIL MEMBERS (CONTINUED)

LLOYD, MR. DENBY (nonvoting) State of Alaska Principal Official	Commissioner, Alaska Dept. of Fish and Game PO Box 115526 Juneau, AK 99811-5526	Telephone: 907-465-4100 Fax: 907-465-2332 Email: dfg.commissioner@alaska.gov
Designee: Mr. Gordy Williams	gordy_williams@fishgame.state.ak.us	Telephone: 907-465-6143
LOWMAN, Ms. DOROTHY Oregon Obligatory Appointment	6507 SW Barnes Road Portland, OR 97225	Telephone: 503-804-4234 Fax: 503-292-8553 Email: dmlowman01@comcast.net
THOM, MR. BARRY NMFS Northwest Region	Acting Regional Administrator, Northwest Region National Marine Fisheries Service 7600 Sand Point Way NE, BIN C15700 Seattle, WA 98115-0070	Telephone: 206-526-6150 Fax: 206-526-6736 Email: barry.thom@noaa.gov
1st Designee: Mr. Frank Lockhart 2nd Designee: Dr. Peter Dygert	frank.lockhart@noaa.gov peter.dygert@noaa.gov	Telephone: 206-526-6142 Telephone: 206-526-6734
MCINNIS, MR. ROD NMFS Southwest Region	Regional Administrator, Southwest Region National Marine Fisheries Service 501 W Ocean Blvd, Ste 4200 Long Beach, CA 90802-4213	Telephone: 562-980-4000 Fax: 562-980-4018 Email: rod.mcinnis@noaa.gov
Designee: Mr. Mark Helvey	mark.helvey@noaa.gov	Telephone: 562-980-4040
MOORE, MR. ROD At-Large Appointment	Executive Director, West Coast Seafood Processors Association 1618 SW First St, Ste 318 Portland, OR 97201	Telephone: 503-227-5076 Fax: 503-227-0237 Email: seafood@integra.net
MYER, MR. DALE At-Large Appointment	Arctic Storm, Inc. 400 N 34th St, Ste 306 Seattle, WA 98103	Telephone: 206-547-6557 Fax: 206-547-3165 Email: dmyer@arcticstorm.com
ORTMANN, MR. DAVE Chair Idaho Obligatory Appointment	9007 W Forest Shores Coeur D'Alene, ID 83814	Telephone: 208-765-8733 Fax: Email: cdadavid@aol.com
ROTH, MR. TIM (nonvoting) USFWS	U.S. Fish and Wildlife Service 1211 SE Cardinal Ct, Ste 100 Vancouver, WA 98683	Telephone: 360-604-2500 Fax: 360-604-2505 Email: timothy_roth@fws.gov
SONES, MR. DAVID Tribal Appointment	PO Box 618 Neah Bay, WA 98357	Telephone: 360-645-2193 Fax: 360-645-2323 Email: ddavid160@centurytel.net
WOLFORD, MR. DAN Vice Chair At-Large	16171 Jasmine Way Los Gatos, CA 95032	Telephone: 408-356-2465 Fax: 408-356-4325 Email: danwolford@earthlink.net

STANDING COUNCIL MEMBER COMMITTEES

BUDGET COMMITTEE

MR. JERRY MALLET, Chair

MR. PHIL ANDERSON

DR. DAVID HANSON

MR. MARK HELVEY / MR. FRANK LOCKHART

MR. ROD MOORE

MR. DAVE ORTMANN

MR. DAN WOLFORD

LEGISLATIVE COMMITTEE

DR. DAVID HANSON, Chair

MR. ROD MOORE

MR. DALE MYER

REPRESENTATIVES TO OTHER FORUMS

WESTERN AND CENTRAL PACIFIC FISHERIES COMMISSION

MS. MARIJA VOJKOVICH

INTERNATIONAL PACIFIC HALIBUT COMMISSION

MS. MICHELE CULVER

ADVISORY BODIES

COASTAL PELAGIC SPECIES ADVISORY SUBPANEL

ENTICKNAP, MR. BEN Conservation	Pacific Project Manager, Oceana 222 NW Davis Street, Ste. 200 Portland, OR 97209	Telephone: 503-235-0278 Fax: 503-235-5429 Email: Benticknap@oceana.org
GUGLIELMO, MR. NEIL California Commercial	F/V Trionfo 1728 Via Pajaro Camarillo, CA 93012	Telephone: 805-384-9384 Fax: Email: fvtrionfo@aol.com
HOINSKY, MS. TERRY California Commercial	President, Fishermen's Union of America 510 North Broad Ave Wilmington, CA 90744-5847	Telephone: 310-834-2099 Fax: 310-834-2098 Email:
LAW, MR. EUGENE Oregon Commercial	754 Olalla Rd Toledo, OR 97391	Telephone: 541-336-2645 Fax: 541-336-4214 Email: mslaw2645@hotmail.com
MARCHAND, JR., MR. PIERRE Processor	President, Jessie's Ilwaco Fish Company PO Box 800 Ilwaco, WA 98624-0800	Telephone: 360-642-3773 Fax: 360-642-3362 Email: pierrem@ilwacofish.com
OKONIEWSKI, MR. MIKE Vice Chair Processor	Pacific Seafood 1635 Down River Dr Woodland, WA 98674	Telephone: 360-225-8553 Fax: Email: mokoniewski@pacseafood.com
PLESCHNER-STEELE, MS. DIANE Processor	Executive Director, California Wetfish Producers Association PO Box 1951 Buellton, CA 93427	Telephone: 805-693-5430 Fax: 805-686-9312 Email: dplesch@earthlink.net
ROYAL, MR. JOHN Chair California Commercial	PO Box 1162 San Pedro, CA 90733	Telephone: Fax: Email:
STRASSER, CPT PAUL California Charter/Sport	Owner, M.C.I.P. Sportfishing 141 W 22nd Street San Pedro, CA 90731	Telephone: 310-612-4747 Fax: 310-514-2452 Email: pstrasser12@ca.rr.com
ZUANICH, MR. ROBERT P. Washington Commercial	Purse Seine Vessels' Owners Association, Executive Director 1900 W Nickerson, Ste 320 Seattle, WA 98119	Telephone: 206-283-7733 Fax: 206-283-7795 Email: rpz@psvoa.com

COASTAL PELAGIC SPECIES MANAGEMENT TEAM

VACANCY: One Washington Department of Fish and Wildlife Position

BRADY, MS. BRIANA CDFG	California Dept. of Fish and Game 1933 Cliff Drive, Suite 9 Santa Barbara, CA 93109	Telephone: 805-568-1323 Fax: Email: bcbrady@dfg.ca.gov
CRONE, DR. PAUL NMFS	National Marine Fisheries Service PO Box 271 La Jolla, CA 92038-0271	Telephone: 858-546-7069 Fax: 858-546-5653 Email: paul.crone@noaa.gov
EMMETT, DR. ROBERT NMFS	National Marine Fisheries Service 2030 SE Marine Science Drive Newport, OR 97365	Telephone: 541-867-0109 Fax: 541-867-0389 Email: robert.emmett@noaa.gov
HERRICK, DR. SAMUEL F. Chair NMFS	National Marine Fisheries Service PO Box 271 La Jolla, CA 92037-0271	Telephone: 858-546-7111 Fax: 858-546-7003 Email: Sam.Herrick@noaa.gov
HILL, DR. KEVIN NMFS	National Marine Fisheries Service PO Box 271 La Jolla, CA 92038-0271	Telephone: 858-546-7052 Fax: 858-546-7003 Email: kevin.hill@noaa.gov
KRUTZIKOWSKY, MR. GREG ODFW	Oregon Dept. of Fish and Wildlife 810 SW Alder Street, Suite C Newport, OR 97365	Telephone: 541-265-8306 ext.226 Fax: 541-265-9894 Email: greg.krutzikowsky@state.or.us
SWEETNAM, MR. DALE Vice Chair CDFG	California Dept. of Fish and Game 8604 La Jolla Shores Dr La Jolla, CA 92037	Telephone: 858-546-7170 Fax: 858-546-7116 Email: dale.sweetnam@noaa.gov

ENFORCEMENT CONSULTANTS

CENCI, DEPUTY CHIEF MIKE Chair Washington	Washington Dept. of Fish and Wildlife PO Box 307 Naselle, WA 98638	Telephone: 360-581-3305 Fax: 360-642-3967 Email: cencimac@dfw.wa.gov
CORRIGAN, MR. BRIAN Vice Chair 13th Coast Guard District	U.S. Coast Guard 915 2nd Ave, Rm 3562 Seattle, WA 98174-1067	Telephone: 206-220-7309 Fax: 206-220-7306 Email: brian.p.corrigan@uscg.mil
MASTERS, SAC DON NMFS Southwest Region Designee: SA Tim Broadman	Special Agent in Charge, NMFS SW Region 501 W. Ocean BLVD #4300 Long Beach, CA 90802 tim.broadman@noaa.gov	Telephone: 562-980-4050 Fax: Email: Don.Masters@noaa.gov Telephone: 707-826-9247
NOMURA, SAC VICKI NMFS Northwest Region Designee: Mr. Dayna Matthews	Special Agent in Charge, National Marine Fisheries Service 7600 Sand Point Way NE, BIN C15700 Seattle, WA 98115-0070 dayna.matthews@noaa.gov	Telephone: 206-526-6137 Fax: 206-526-6528 Email: Vicki.Nomura@noaa.gov Telephone: 360-753-4409
SAMUALS, LT. JEFF Oregon	Oregon State Police, Fish and Wildlife General Headquarters 255 Capitol Street NE, 4th Floor Salem, OR 97301	Telephone: 503-934-0222 Fax: 503-363-5475 Email: jeff.samuals@state.or.us
STEWART, LTJG BRITTANY 11th Coast Guard District Designee: LT Elisa Garrity	U.S. Coast Guard Coast Guard Island, Bldg. 50-5 Alameda, CA 94501-5100 Elisa.M.Garrity@uscg.mil	Telephone: 510-437-5392 Fax: 510-437-3223 Email: Brittany.g.stewart@uscg.mil Telephone: 510-437-5392
WARRINGTON, AC TONY California Designee: LT Bob Farrell	California Dept. of Fish and Game 1416 - 9th St, Rm 1326 Sacramento, CA 95814 Bfarrell@dfg.ca.gov	Telephone: 916-826-9416 Fax: 916-653-3772 Email: twarring@dfg.ca.gov Telephone: 707-477-6657

GROUND FISH ALLOCATION COMMITTEE – VOTING MEMBERS

ANDERSON, MR. PHIL WDFW	Washington Dept. of Fish and Wildlife 600 Capitol Way N Olympia, WA 98501-1091	Telephone: 360-902-2720 Fax: 360-902-2158 Email: anderpma@dfw.wa.gov
HANSON, DR. DAVID PSMFC	Pacific States Marine Fisheries Commission 3468 22nd Street NW Hackensack, MN 56452	Telephone: 218-675-5231 Fax: 503-595-3232 Email: dave_hanson@psmfc.org
LOCKHART, MR. FRANK NMFS	National Marine Fisheries Service 7600 Sand Point Way, NE Seattle, WA 98115-0070	Telephone: 206-526-6142 Fax: 206-526-6736 Email: frank.lockhart@noaa.gov
ORTMANN, MR. DAVE Chair Council Chair	9007 W Forest Shores Coeur D'Alene, ID 83814	Telephone: 208-765-8733 Fax: Email: cdadavid@aol.com
VOJKOVICH, MS. MARIJA California	California Dept. of Fish and Game 1933 Cliff Dr, Ste 9 Santa Barbara, CA 93109-1520	Telephone: 805-568-1246 Fax: 805-568-1235 Email: mvjokovich@dfg.ca.gov
WILLIAMS, MR. STEPHEN Oregon	Oregon Dept. of Fish and Wildlife 3406 Cherry Avenue NE Salem, OR 97303	Telephone: 503-947-6209 Fax: 503-947-6402 Email: stephen.h.williams@state.or.us

GROUND FISH ALLOCATION COMMITTEE – NON-VOTING

BORNSTEIN, MR. ANDREW Shoreside Processing	Bornstein Seafoods PO Box 58 Astoria, OR 97103	Telephone: 360-325-6164 Fax: 360-325-0403 Email: Andrew@bornstein.com
GHIO, MR. TOM Open Access Fishery	Ghio Fish Company 112 Gilbert CT Santa Cruz, CA 95065	Telephone: 831-460-1455 Fax: Email: ghiofish2000@yahoo.com
LEIPZIG, MR. PETER Limited Entry Non-Whiting Trawl	Executive Director, Fisherman's Marketing Association 1585 Heartwood Drive McKinleyville, CA 95519	Telephone: 707-840-0182 Fax: 707-840-0539 Email: pete@trawl.org
LONGO EDER, MS. MICHELE Limited Entry Fixed Gear	Michele Longo Eder Attorney at Law, LLC PO Box 1530 Newport, OR 97365	Telephone: 541-265-3337 Fax: 541-265-6633 Email: michele@michelelongoeder.com
OSBORN, MR. ROBERT Recreational Fisher	United Anglers of Southern California 17391 Murphy Avenue Irvine, CA 92614-5919	Telephone: 562-592-6041 Fax: 949-863-9447 Email: bob@unitedanglers.com
PAGANO, MS. LAURA Conservation	Natural Resources Defense Council 111 Sutter Street, 20 th Floor San Francisco, CA 94104	Telephone: 415-875-6100 Fax: 415-875-6161 Email: Lpagano@nrdc.org
WALDECK, MR. DANIEL A. At-sea Processing	Pacific Whiting Conservation Cooperative 205 SE Spokane St, Ste 338 Portland, OR 97202-6413	Telephone: 503-238-7492 Fax: 503-238-7499 Email: dwaldeck@comcast.net

GROUND FISH ADVISORY SUBPANEL

ALVERSON, MR. ROBERT Fixed Gear At-Large	Fishing Vessel Owner's Association 4005 - 20th Ave W, Room 232 Seattle, WA 98199-1290	Telephone: 206-283-7735 Fax: 206-283-3341 Email: robertalverson@msn.com
BAIN, MR. ROGER Tribal Fisher	PO Box 717 Neah Bay, WA 98357	Telephone: 360-645-2190 Fax: Email: PRBain@hotmail.com
ANCONA, MR. TOM Chair California Trawl	Tommy's Marine Service - F/V Caito Bros, Inc. PO Box 1227 Fort Bragg, CA 95437	Telephone: 707-964-5423 Fax: 707-964-7206 Email: ancona@mcn.org
BUTLER, MR. WAYNE Oregon Charter Boat Operator	Prowler Charters PO Box 674 Bandon, OR 97411	Telephone: 541-347-9126 Fax: 541-347-9126 Email: wayne.b1@mycomspan.com
COHEN, MR. BARRY Processor	Olde Port Fisheries/Del Mar PO Box 40 Avila Beach, CA 93424	Telephone: 805-595-9456 Fax: Email: fishmancohen@aol.com
GHIU, MR. TOM Fixed Gear At-Large	Ghio Fish Company 112 Gilbert CT Santa Cruz, CA 95065	Telephone: 831-460-1455 Fax: Email: ghiofish2000@yahoo.com
GIESE, MR. LARRY Washington Charter Boat Operator	Deep Sea Charters PO Box 1115 Westport, WA 98595	Telephone: 360-268-9300 Fax: 360-268-9511 Email: deepsea@seanet.com
HANSEN, MR. MIKE California Charter South of Point Conception	Dana Wharf Sportfishing 34675 Golden Lantern Dana Point, CA 92629-2990	Telephone: 949-496-5794 Fax: 949-496-8212 Email: hansen.of.mike@gmail.com
HENSEL, MR. KENYON Open Access North of Cape Mendocino	Hensel's 871 Elk Valley Rd Crescent City, CA 95531-9345	Telephone: 707-465-6857 Fax: 707-465-6857 Email: khensel@charter.net
HOLLOWAY, MR. JOHN Vice Chair Sport Fisheries At-Large	Executive Board Secretary, Oregon Anglers/Oregon RFA 6823 SW Burlingame Ave Portland, OR 97219-2127	Telephone: 503-452-7919 Fax: 503-452-4919 Email: manleydesign@comcast.net
INGLES, MR. ROBERT C. California Charter North of Pt Conception	Golden Gate Fisherman's Association PO Box 3728 Hayward, CA 94544	Telephone: 510-581-2628 Fax: Email: sherry@fishingboat.com
JUD, MR. SHEMS Conservation	Environmental Defense Fund 1749 Regency Street West Linn, Or 97068	Telephone: 503-358-7053 Fax: Email: sjud@edf.org
LARKIN, MR. MARION J. Washington Trawl	19737 Trophy Ln Mount Vernon, WA 98274	Telephone: 360-445-2400 Fax: 360-445-4049 Email: mjlarlkin@hughes.net
LIBBY, MR. TOM E. Processor	CA Shellfish Co., Inc. 90085 Logan Road Astoria, OR 97103	Telephone: 503-325-5276 Fax: 503-325-5276 Email: telibby@msn.com

•

•

GROUND FISH ADVISORY SUBPANEL (CONTINUED)

MARTIN, MR. JIM Sport Fisheries At-Large	West Coast Regional Director Recreational Fishing Alliance PO Box 2420 Ft. Bragg, CA 95437	Telephone: 707-964-8326 Fax: 707-964-8326 Email: flatland@mcn.org
PLATT, MR. DAN Southern Open Access	STMA 16791 Franklin Road Fort Bragg, CA 95437	Telephone: 707-961-0240 Fax: Email: morefish@mcn.org
RICHTER, MR. GERRY Fixed Gear At-Large	B & G Seafoods, Inc. 217 Calle Manzanita Santa Barbara, CA 93105	Telephone: 805-569-3099 Fax: 805-569-3099 Email: gdrfish@msn.com
SEILER, MR. DAVE Washington Sport Fisher At-Large	9538 Gate Road SW Olympia, WA 98512	Telephone: 360-273-7548 Fax: Email: kndseiler@scattercreek.com
SMOTHERMAN, MR. KELLY E. Oregon Trawl	F/V Fate Hunter PO Box 257 Hammond, OR 97121	Telephone: 503-338-9049 Fax: Email:
WALDECK, MR. DANIEL A. At-Sea Processor	Executive Director, Pacific Whiting Conservation Cooperative 205 SE Spokane St, Ste 338 Portland, OR 97202-6413	Telephone: 503-238-7492 Fax: 503-238-7499 Email: dwaldeck@comcast.net

GROUND FISH MANAGEMENT TEAM

VACANCY: One Washington Department of Fish and Wildlife Position

ARENTZEN, MS. GRETCHEN NMFS Northwest Region	National Marine Fisheries Service 7600 Sand Point Way NE Seattle, WA 98115	Telephone: 206-526-6147 Fax: 206-526-6736 Email: gretchen.arentzen@noaa.gov
BUDRICK, MR. JOHN CDFG	California Dept. of Fish and Game 350 Harbor Blvd. Belmont, CA 94002	Telephone: 650-413-1501 Fax: 650-631-6119 Email: jbudrick@dfg.ca.gov
COPE, DR. JASON NMFS NWFS	NMFS NWFS 2725 Montlake Blvd. East Seattle, WA 98112	Telephone: 206-302-2417 Fax: 206-860-3217 Email: jason.cope@noaa.gov
DICK, DR. EDWARD NMFS SWFSC	NOAA/NMFS 110 Shaffer Road Santa Cruz, CA 95060	Telephone: 831-420-3947 Fax: Email: edward.dick@noaa.gov
ERICKSON, MR. DANIEL ODFW	Oregon Dept. of Fish and Wildlife 2040 SE Marine Science Drive Newport, OR 97365	Telephone: 541-867-0300 ext. 229 Fax: 541-867-0311 Email: Daniel.L.Erickson@state.or.us
GREBEL, MS. JOANNA CDFG	California Dept. of Fish and Game 20 Lower Ragsdale Drive Monterey, CA 93940	Telephone: 831-649-2804 Fax: Email: Jgrebel@dfg.ca.gov
JONES, MR. ROBERT F. Chair Tribal Agency	Northwest Indian Fisheries Commission PO Box 1029 Forks, WA 98331	Telephone: 360-374-5501 Fax: 360-374-5592 Email: rjones@nwifc.org
MATTES, MS. LYNN ODFW	Oregon Dept. of Fish and Wildlife 2040 SE Marine Science Drive Newport, OR 97365	Telephone: 541-867-0300 ex. 237 Fax: 541-867-0311 Email: lynn.mattes@state.or.us
NILES, MR. COREY Vice Chair WDFW	Washington Dept. of Fish and Wildlife 48 Devonshire Road Montesano, WA 98563-9618	Telephone: 360-249-4628 Fax: 360-664-0689 Email: nilscbn@dfw.wa.gov
WILLIAMS, MS. SARAH NMFS Northwest Region	National Marine Fisheries Service 7600 Sand Point Way NE Seattle, WA 98115	Telephone: 206-526-4646 Fax: 206-526-6736 Email: sarah.williams@noaa.gov

HABITAT COMMITTEE

CHESNEY, MR. BRYANT NMFS Regional Representative	National Marine Fisheries Service 501 W Ocean Blvd, Ste 4200 Long Beach, CA 90802	Telephone: 562-980-4037 Fax: 562-980-4092 Email: bryant.chesney@noaa.gov
ELLIS, MR. STUART Chair Northwest Columbia River Tribes	Columbia River Inter-Tribal Fish Commission 729 NE Oregon, Ste 200 Portland, OR 97232-2175	Telephone: 503-238-0667 Fax: 503-235-4228 Email: ells@critfc.org
HAMILTON, MS. LIZ Sport Fisheries At-Large	Executive Director, Northwest Sportfishing Industry Association PO Box 4 Oregon City, OR 97045-0004	Telephone: 503-631-8859 Fax: 503-631-3887 Email: nsializ@aol.com
HANSON, MR. LARRY CDFG Designee: Ms. Vicki Frey	California Dept. of Fish and Game 601 Locust Street Redding, CA 96001 vfrey@dfg.ca.gov	Telephone: 530-225-2280 Fax: Email: LKHanson@dfg.ca.gov Telephone: 707-445-7830
KAWAHARA, MR. JOEL Commercial Fisheries	3652 Lindsay Hill Rd Quilcene, WA 98376	Telephone: 206-406-7026 Fax: Email: joelkaw@earthlink.net
LEITZINGER, MR. ERIC IDFG	Idaho Dept. of Fish and Game 600 S Walnut, PO Box 25 Boise, ID 83707	Telephone: 208-287-2798 Fax: 208-334-2114 Email:eric.leitinger@idfg.idaho.gov
MEREMS, MS. ARLENE ODFW	Oregon Dept. of Fish and Wildlife 2040 SE Marine Science Drive Newport, OR 97365	Telephone: 541-867-0300 ex. 246 Fax: 541-867-0311 Email: arlene.r.merems@state.or.us
ORCUTT, MR. MIKE California Tribes	Hoopa Valley Tribe PO Box 930 Hoopa, CA 95546-0417	Telephone: 530-625-4267 Fax: 530-625-4995 Email: director@hoopa-nsn.gov
OSMOND, MR. MICHAEL Conservation	World Wildlife Fund 171 Forest Ave Palo Alto, CA 94301	Telephone: 650-323-3506 Fax: 650-325-2236 Email: michael.osmond@wwfus.org
RECHT, MS. FRAN PSMFC	Pacific States Marine Fisheries Commission PO Box 221 Depoe Bay, OR 97341-0221	Telephone: 541-765-2229 Fax: 541-765-2229 Email: franrecht@centurytel.net
ROTH, MR. TIM USFWS	U.S. Fish and Wildlife Service 1211 SE Cardinal Ct, Ste 100 Vancouver, WA 98683	Telephone: 360-604-2500 Fax: 360-604-2505 Email: timothy_roth@fws.gov
SCOTT, MS. TERESA WDFW	Washington Dept. of Fish and Wildlife MS 43136, 600 Capitol Way N Olympia, WA 98501-1091	Telephone: 360-902-2713 Fax: 360-902-2158 Email: scotttlls@dfw.wa.gov
WAKEFIELD, DR. WALDO NMFS FSC	National Marine Fisheries Service 2032 SE OSU Dr Newport, OR 97365	Telephone: 541-867-0542 Fax: 541-867-0505 Email: waldo.wakefield@noaa.gov

HABITAT COMMITTEE (CONTINUED)

WHITE, MR. SEAN At-Large	Russion River Flood District 151 Laws Avenue, Suite D Ukiah, CA 95482	Telephone: 707-462-5678 Fax: 707-462-5679 Email: rrfc@saber.net
WOONINCK, DR. LISA National Marine Sanctuaries	Monterey Bay National Marine Sanctuary 299 Foam St, Ste D Monterey, CA 93940	Telephone: 831-647-4254 Fax: 831-647-4250 Email: lisa.wooninck@noaa.gov

HIGHLY MIGRATORY SPECIES ADVISORY SUBPANEL

Vacancies: One Conservation Position and one Southern Charter Boat Position.

BUELL, MS. LINDA Northern Charter Boat Operator	7695 Galloway Road Cloverdale, OR 97112	Telephone: 503-965-2238 Fax: 503-322-0381 Email: fishon@garibaldicharters.com
DUPUY, MR. PETE Commercial At-Large	Ocean Pacific Sea Food 18212 Rosita St Tarzana, CA 91356	Telephone: 818-343-9927 Fax: 818-881-5003 Email: lapazkd@aol.com
FELANDO, MR. AUGUST Commercial Purse Seine	870 San Antonio Pl San Diego, CA 92106	Telephone: 619-223-7654 Fax: 619-223-7958 Email: augustfelando@aol.com
FOLTZ, MR. STEVE Processor South of Cape Mendocino	Chesapeake Fish Co. 535 Harbor Lane San Diego, CA 92101	Telephone: 619-238-0526 Fax: 619-778-9734 Email: sfoltz@chesapeakefish.com
FOSMARK, MR. STEVEN Commercial Gillnet Fisheries	Owner/Operator, F/V Seeadler 3059 Sherman Rd Pebble Beach, CA 93953	Telephone: 831-373-5238 Fax: 831-373-0123 Email: fvseeadler@aol.com
FRICKE, MR. DOUGLAS Chair Commercial At-Large	Boat Seafoods PO Box 306 Hoquiam, WA 98550	Telephone: 360-580-3027 Fax: 360-538-0466 Email: dfricke@techline.com
HEIKKILA, MR. WAYNE Vice Chair Commercial Troll	Executive Director, Western Fishboat Owner's Association PO Box 992723 Redding, CA 96099	Telephone: 530-229-1097 Fax: 530-229-0973 Email: wfoa@charter.net
MARCHAND, JR., MR. PIERRE Processor	President, Jessie's Ilwaco Fish Company PO Box 800 Ilwaco, WA 98624-0800	Telephone: 360-642-3773 Fax: 360-642-3362 Email: pierrem@ilwacofish.com
OSBORN, MR. ROBERT Private Recreational	United Anglers of Southern California 17391 Murphy Avenue Irvine, CA 92614-5919	Telephone: 562-592-6041 Fax: 949-863-9447 Email: bob@unitedanglers.com
SUTTON, MR. BILL Commercial At-Large	F/V Aurelia 876 S Rice Rd Ojai, CA 93023	Telephone: 805-646-9685 Fax: 805-646-1321 Email: seafreshto@aol.com

HIGHLY MIGRATORY SPECIES ADVISORY SUBPANEL (*CONTINUED*)

TOM, MS. PAMELA Public At-Large	University of California Food Science and Technology Dept. One Shields Avenue Davis, CA 95616	Telephone: 530-752-3837 Fax: 530-752-4759 Email: pdtom@ucdavis.edu
---	--	--

HIGHLY MIGRATORY SPECIES MANAGEMENT TEAM

ENRIQUEZ, MR. LYLE NMFS Southwest Region	National Marine Fisheries Service 501 W Ocean Blvd. Long Beach, CA 90802-4213	Telephone: 562-980-4025 Fax: 562-980-4047 Email: lyle.enriquez@noaa.gov
HALLMAN, MR. BRIAN IATTC Designee: Mr. Ricardo Belmontes	Assistant Director, Inter-American Tropical Tuna Commission 8604 La Jolla Shores Drive La Jolla, CA 92037	Telephone: 858-546-7100 Fax: 858-546-7133 Email: bhallman@iattc.org Telephone: 858-546-7100
HEBERER, MR. CRAIG NMFS Southwest Region	U.S. Fish and Wildlife Service 6010 Hidden Valley Road Carlsbad, CA 92009	Telephone: 760-431-9440 ex. 303 Fax: 760-431-9618 Email: craig.heberer@noaa.gov
PINER, DR. KEVIN NMFS Southwest Fisheries Science Center	National Marine Fisheries Service 8604 La Jolla Shores Dr La Jolla, CA 92038-1508	Telephone: 858-546-5613 Fax: 858-546-5651 Email: kevin.piner@noaa.gov
LAUGHLIN, MS. LEEANNE Vice Chair CDFG	California Dept. of Fish and Game 4665 Lampson Ave, Ste C Los Alamitos, CA 90720	Telephone: 562-342-7167 Fax: 562-342-7139 Email: llaughlin@dfg.ca.gov
NILES, MR. COREY WDFW	Washington Dept. of Fish and Wildlife 48 Devonshire Road Montesano, WA 98563-9618	Telephone: 360-249-4628 Fax: 360-664-0689 Email: nilescbn@dfw.wa.gov
SCHMITT, MS. CYREIS ODFW	Oregon Dept. of Fish and Wildlife 2040 SE Marine Science Dr Newport, OR 97365-5294	Telephone: 541-867-0300 ex. 265 Fax: 541-867-0311 Email: cyreis.c.schmitt@state.or.us
STOHS, DR. STEPHEN Chair NMFS SWFSC	National Marine Fisheries Service PO BOX 271 La Jolla, CA 92037-1508	Telephone: 858-546-7084 Fax: 858-546-7003 Email: Stephen.Stohs@noaa.gov

MODEL EVALUATION WORKGROUP

VACANCIES: One California Department of Fish and Game Position and One NMFS NWR Position.

CLEMONS, MR. ETHAN ODFW	Oregon Dept. of Fish and Wildlife 2040 SE Marine Science Drive Newport, OR 97365	Telephone: 541-867-0300 ex. 242 Fax: Email: Ethan.R.Clemons@state.or.us
CONRAD, MR. ROBERT H. Scientific and Statistical Committee	Northwest Indian Fisheries Commission 6730 Martin Way E Olympia, WA 98516-5540	Telephone: 360-528-4345 Fax: 360-753-8659 Email: bconrad@nwifc.org
LAVOY, MR. LARRIE Vice Chair WDFW Designee: Mr. Jim Packer	Washington Dept. of Fish and Wildlife 600 Capitol Way N Olympia, WA 98501-1091 packejfp@dfw.wa.gov	Telephone: 360-902-2841 Fax: 360-902-2949 Email: lavoylw@dfw.wa.gov Telephone: 360-902-2754
RANKIS, MR. ANDY Chair NW Indian Fisheries Commission	Northwest Indian Fisheries Commission 6730 Martin Way E Olympia, WA 98516	Telephone: 360-438-1181 ex. 322 Fax: 360-753-8659 Email: arankis@nwifc.org
SHARMA, MR. RISHI Columbia River Inter-Tribal Fish Commission	Columbia River Inter-Tribal Fish Commission 729 NE Oregon St, Ste 200 Portland, OR 97232	Telephone: 503-238-0667 Fax: 503-235-4228 Email: shar@critfc.org
YUEN, MR. HENRY USFWS	U.S. Fish and Wildlife Service 1211 SE Cardinal Ct, Ste 100 Vancouver, WA 98683	Telephone: 360-604-2500 Fax: 360-604-2505 Email: henry_yuen@fws.gov

SALMON ADVISORY SUBPANEL

FRANK, MR. CALVIN S. Washington Coastal Tribal Fisherman	F/V Cross Winds PO Box 373 Bay Center, WA 98527	Telephone: 360-942-7809 Fax: Email:
HEAP, MR. RICHARD Oregon Sport Fisheries	95975 N. Brookside Drive Brookings, OR 97415	Telephone: 541-469-7111 Fax: Email: fiskare@charter.net
HEIKKILA, MR. PAUL Oregon Troll	786 S. 1st Ave. Coquille, OR 97423	Telephone: 541-396-3096 Fax: Email: pheikkila@mycomspan.com
HIE, MR. JIM Conservation	Pacific Marine Conservation Council 1423 Vista Ave Napa, CA 94559	Telephone: 707-695-8661 Fax: 707-265-0304 Email: jnahie@att.net
HILLEMEIER, MR. DAVE California Tribes	Yurok Tribe PO Box 1027 Klamath, CA 95548	Telephone: 707-482-1350 315 Fax: 707-482-1377 Email: Dave@yuroktribe.nsn.us

SALMON ADVISORY SUBPANEL (*CONTINUED*)

MACLEAN, MR. DUNCAN Vice Chair California Troll	Owner, F/V Barbara Faye PO Box 1942 El Granada, CA 94018-1942	Telephone: 650-726-1373 Fax: 650-712-8744 Email: b-faye@pacbell.net
MARTIN, MR. KENT Commercial Gillnet	PO Box 83 Skamokawa, WA 98647	Telephone: 360-795-3920 Fax: Email: imartin@iinet.com
OLSON, MR. JIM Washington Troll	F/V Cynthia T PO Box 586 Auburn, WA 98071-0586	Telephone: 253-833-8739 Fax: 425-644-6107 Email: Jaocto@juno.com
PIERCE, MR. PAUL California Sport Fisheries	Coastside Fishing Club 512 Pershing Drive San Leandro, CA 94577	Telephone: 510-568-2713 Fax: 510-432-8820 Email: SDAD111@aol.com
REINHOLDT, MR. GERALD K. Processor	Reinholdt Fisheries 62313 S Canaan Rd St. Helens, OR 97051-9117	Telephone: 503-397-3369 Fax: 503-397-3369 Email: reinholdtfish@hotmail.com
SMITH, MR. BUTCH Chair Washington Charter Boat	Co-Ho Charters PO Box 268 Ilwaco, WA 98624	Telephone: 360-642-3333 Fax: 360-642-3758 Email: coho@willapabay.org
SORENSEN, MR. MIKE Oregon Charter Boat	603 Camp 12 Lp Toledo, OR 97391	Telephone: 541-444-2552 Email: fvmissraven@hotmail.com
STONE, MR. CRAIG California Charter Boat	Emeryville Sportfishing 3310 Powell St Emeryville, CA 94608	Telephone: 510-654-6040 Fax: 510-654-2106 Email: emvlsport@aol.com
WATROUS, MR. STEVE Washington Sport Fisheries	Garonaire, Inc. 2515 Kauffman Ave Vancouver, WA 98660	Telephone: 360-696-1604 Fax: 360-695-6031 Email: branchofic@aol.com
WELSH, DR. TOM Idaho Sport Fisheries	290 N. Dale Road Pearce, AZ 85625	Telephone: 208-860-9441 Email: tom.welsh@hotmail.com

SALMON TECHNICAL TEAM

VACANCIES: One NMFS NWR Position.

FOSTER, MR. CRAIG ODFW	Oregon Dept. of Fish and Wildlife 17330 SE Evelyn St Clackamas, OR 97015	Telephone: 971-673-6026 Fax: 971-673-6071 Email: craig.a.foster@state.or.us
PALMER-ZWAHLEN, MS. MELODIE CDFG	California Dept. of Fish and Game 475 Aviation Blvd, Ste 130 Santa Rosa, CA 95403	Telephone: 707-576-2870 Fax: 707-576-7132 Email: mpalmer@dfg.ca.gov
KOPE, DR. ROBERT Chair NMFS NWFSC	National Marine Fisheries Service 2725 Montlake Blvd E Seattle, WA 98112-2097	Telephone: 206-860-3374 Fax: 206-860-3394 Email: robert.kope@noaa.gov
LUTZ, MR. KEITH Tribal	Northwest Indian Fisheries Commission 6730 Martin Way E Olympia, WA 98516	Telephone: 360-528-4326 Fax: 360-753-8659 Email: lutz@nwifc.org
MILWARD, MR. DOUG WDFW	Washington Dept. of Fish and Wildlife 600 Capitol Way N Olympia, WA 98501-1091	Telephone: 360-902-2739 Fax: 360-902-2949 Email: milwadam@dfw.wa.gov
O'FARRELL, DR. MICHAEL Vice Chair NMFS SWFSC	National Marine Fisheries Service 110 Shaffer Rd Santa Cruz, CA 95060	Telephone: 831-420-3976 Fax: 831-420-3980 Email: michael.ofarrell@noaa.gov
YUEN, MR. HENRY USFWS	U.S. Fish and Wildlife Service 1211 SE Cardinal Ct, Ste 100 Vancouver, WA 98683	Telephone: 360-604-2500 Fax: 360-604-2505 Email: henry_yuen@fws.gov

SCIENTIFIC AND STATISTICAL COMMITTEE

VACANCIES: One Oregon Department of Fish and Wildlife Position and One At Large Position.

BARNES, MR. J. THOMAS CDFG	California Dept. of Fish and Game 8604 La Jolla Shores Dr La Jolla, CA 92037-0271	Telephone: 858-546-7167 Fax: 858-546-7003 Email: tombarnes@ucsd.edu
BOTSFORD, DR. LOUIS At-Large	Dept. of Wildlife, Fish, and Conservation Biology University of California One Shields Avenue Davis, CA 95616	Telephone: 530-752-6169 Fax: 530-752-4154 Email: lwbotsford@ucdavis.edu
CONRAD, MR. ROBERT H. Tribal Agency	Northwest Indian Fisheries Commission 6730 Martin Way E Olympia, WA 98516-5540	Telephone: 360-528-4345 Fax: 360-753-8659 Email: bconrad@nwifc.org
CONSER, DR. RAMON J. NMFS Southwest Fisheries Science Center	NOAA/NMFS 8604 La Jolla Shores Dr La Jolla, CA 92037-0271	Telephone: 858-546-5688 Fax: 858-546-5656 Email: ray.conser@noaa.gov
DORN, DR. MARTIN Vice Chair NMFS Alaska Fisheries Science Center	National Marine Fisheries Service 7600 Sand Point Way NE, BIN C15700 Seattle, WA 98115-0070	Telephone: 206-526-6548 Fax: 206-525-6723 Email: martin.dorn@noaa.gov
HAMEL, DR. OWEN NMFS Northwest Fisheries Science Center	National Marine Fisheries Service 2725 Montlake Blvd E Seattle, WA 98112	Telephone: 206-860-3481 Fax: 206-860-3394 Email: owen.hamel@noaa.gov
HEPPELL, DR. SELINA At-Large	Oregon State Univeristy 104 Nash Hall Corvallis, OR 97331	Telephone: 541-737-9039 Fax: 541-737-3590 Email: Selina.Heppell@oregonstate.edu
LAWSON, DR. PETER NMFS Northwest Fisheries Science Center	National Marine Fisheries Service 2030 S Marine Science Dr Newport, OR 97365-5296	Telephone: 541-867-0430 Fax: 541-867-0380 Email: Peter.W.Lawson@noaa.gov
LEE, DR. TODD At-Large	NOAA/NWFSC/Fram Division 2725 Montlake Blvd. East Seattle, WA 98112-2097	Telephone: 206-302-2436 Fax: 206-860-6792 Email: todd.lee@noaa.gov
PETROSKY, DR. CHARLIE IDFG	Idaho Dept. of Fish and Game PO Box 25 Boise, ID 83707	Telephone: 208-334-3791 Fax: 208-334-2114 Email: cpetrosky@idfg.idaho.gov
PUNT, DR. ANDRE At-Large	University of Washington Box 355020 Seattle, WA 98195-5020	Telephone: 206-221-6319 Fax: 206-685-7471 Email: aepunt@u.washington.edu
RALSTON, DR. STEPHEN Chair At-Large	National Marine Fisheries Service 110 Shaffer Rd Santa Cruz, CA 95060	Telephone: 831-420-3949 Fax: 831-420-3977 Email: steve.ralston@noaa.gov
THOMSON, Ms. CINDY NMFS Southwest Fisheries Science Center	National Marine Fisheries Service 110 Shaffer Rd Santa Cruz, CA 95060	Telephone: 831-420-3911 Fax: 831-420-3977 Email: Cindy.Thomson@noaa.gov
TSOU, DR. THERESA WDFW	Washington Dept. of Fish and Wildlife 600 Capitol Way North Olympia, WA 98501	Telephone: 360-902-2855 Fax: Email: Tien-Shui.Tsou@dfw.wa.gov

*

*

SCIENTIFIC AND STATISTICAL COMMITTEE (CONTINUED)

WESPESTAD, DR. VIDAR
At-Large

Research Analysts International
21231 8th PI W
Lynnwood, WA 98036

Telephone: 425-672-7603
Fax: 425-672-1357
Email: vidarw@verizon.net

AD HOC COUNCIL COMMITTEES

COASTAL PELAGIC SPECIES TRIBAL ALLOCATION COMMITTEE

Anderson, Mr. Phil	Helvey, Mr. Mark	Lockhart, Mr. Frank	Sones, Mr. David
Vojkovich, Ms. Marija	Williams, Mr. Stephen		

GROUND FISH ESSENTIAL FISH HABITAT REVIEW COMMITTEE

Bowlby, Mr. Ed	Copps, Mr. Steve	Eder, Mr. Robert	Greene, Dr. Gary
Goldfinger, Dr. Chris	Mackey, Ms. Megan (Vice Chair)	Matthews, Mr. Dayna	Pettinger, Mr. Brad (Chair)
Roberts, Mr. Santi	Schumacker, Mr. Joe	Stadler, Dr. John	Wakefield, Dr. Waldo
Yoklavich, Ms. Mary			

GROUND FISH TRAWL INDIVIDUAL QUOTA COMMITTEE

Bodnar, Mr. Steve	Bornstein, Mr. Jay	Brown, Mr. Ralph	Buckmaster, Mr. Bruce
Hanson, Dr. David	Hightower, Mr. Alan	Jacobs, Mr. Jan	Jincks, Mr. David
Joner, Mr. Steve	Larkin, Mr. Marion J.	Leipzig, Mr. Peter	Lowman, Ms. Dorothy
Matthews, Mr. Dayna	Paine, Mr. Brent	Parker, Ms. Donna	Pettinger, Mr. Brad
Plesha, Mr. Joe	Urness, Mr. Craig		

HIGHLY MIGRATORY SPECIES MANAGEMENT COMMITTEE

Anderson, Mr. Phil	Helvey, Mr. Mark	Vojkovich, Ms. Marija
--------------------	------------------	-----------------------

MARINE PROTECTED AREA COMMITTEE

Anderson, Mr. Phil	Cooney, Ms. Eileen	Fletcher, Mr. Robert
MacLean, Mr. Duncan	Mclsaac, Dr. Donald O.	Pleschner-Steele, Ms. Diane
Thomson, Ms. Cindy	Williams, Mr. Stephen	

SALMON PLAN AMENDMENT COMMITTEE

Boyce, Mr. Ron	Busby, Ms. Peggy	Cooney, Ms. Eileen
Dygert, Dr. Peter	Ise, Ms. Jennifer	Kope, Dr. Robert
Lawson, Dr. Peter	Lutz, Mr. Keith	Lynch, Ms. Sheila
McCall, Ms. Marion	Mendez, Ms. Shelby	Mohr, Mr. Michael
O'Farrell, Dr. Michael	Pinkerton, Ms. Corinne	

SHORE-BASED WHITING AMENDMENT WORKGROUP

Carroll, Mr. Richard	Cenci, Deputy Chief Mike	Lockhart, Mr. Frank
Renko, Ms. Becky	Matthews, Mr. Dayna	Moore, Mr. Rod

TRAWL INDIVIDUAL QUOTA ENFORCEMENT GROUP

Cenci, Deputy Chief Mike	Corrigan, Mr. Brian	Lockhart, Mr. Frank
Matthews, Mr. Dayna	Warrington, Mr. Tony	

TRAWL INDIVIDUAL QUOTA INDEPENDENT EXPERTS PANEL

Deweese, Mr. Chris	Hanna, Dr. Susan	Huppert, Dr. Dan	Sylvia, Dr. Gilbert
--------------------	------------------	------------------	---------------------

TRAWL RATIONALIZATION TRACKING AND MONITORING COMMITTEE

Albert, Mr. Joseph	Colpo, Mr. Dave	Cusick, Mr. Jonathan	Eres, Ms. Joann
Freese, Dr. Steve	Kobylinski, Mr. Gerry	Lee, Dr. Todd	Matthews, Mr. Dayna
Niles, Mr. Corey	Renko, Ms. Becky	Warrington, Mr. Tony	Seabourne, Mr. John

VESSEL MONITORING SYSTEM COMMITTEE

Albert, Mr. Joseph	Alverson, Mr. Bob	Cedergreen, Mr. Mark	Cenci, Dep. Chief Mike
Corrigan, Mr. Brian	Ghio, Mr. Tom	Larkin, Mr. Marion J.	Matthews, Mr. Dayna
Renko, Ms. Becky	Steward, LTJG Brittany		

ACRONYMS

USED IN THIS ROSTER

ADFG.... Alaska Dept. of Fish and Game
CDFG.... California Dept. of Fish and Game
IATTC... Inter-American Tropical Tuna Commission
IDFG Idaho Dept. of Fish and Game
NMFS.... National Marine Fisheries Service
NMS National Marine Sanctuaries
NOAA National Oceanic and Atmospheric
Administration

NWFSC... Northwest Fisheries Science Center
ODFW..... Oregon Dept. of Fish and Wildlife
PFMC..... Pacific Fishery Management Council
PSMFC.... Pacific States Marine Fisheries Commission
SWFSC ... Southwest Fisheries Science Center
USFWS ... United States Fish and Wildlife Service
WDFW.... Washington Dept. of Fish and Wildlife

PFMC 08/31/09

\\Bridget\PFMC_DATA\IPFMC\MEETING\2009\March\Roster\March Roster.doc