

PACIFIC FISHERY MANAGEMENT COUNCIL

CHAIR'S RECEPTION



Sunday, March 9, 2008

6:00 p.m.

CAPITAL BALLROOM SALON D

DoubleTree Hotel

Sacramento, California

TO BE RETAINED BY OPERATORS OF HOTELS
MOTELS, AND SIMILAR ACCOMMODATIONS AS
EVIDENCE OF EXEMPT OCCUPANCY

EXEMPTION CERTIFICATE
TAX ON OCCUPANCY
OF HOTEL ROOMS

Imposed Pursuant to
Articles 28 and 29 of the Tax Law

NAME OF HOTEL, APARTMENT HOTEL, OR LODGING HOUSE

DoubleTree Hotel Sacramento

DATES

March 8-15, 2008

ADDRESS

2001 Point West Way

Sacramento, California 95815

916-929-8855 Telephone - 916-924-0719 Fax

Members of the Pacific Fishery Management Council (Council)

Council Staff

Council Advisory Bodies:

Habitat Committee

Enforcement Consultants

Groundfish Management Team

Salmon Management Team

Groundfish Advisory Subpanel

Salmon Advisory Subpanel

Scientific and Statistical Team

This is to certify that the above individuals are representatives of the United States Governmental department, agency or instrumentality indicated below; that the charges for the occupancy at the above establishment on the dates set forth below have been or will be paid for by such governmental unit; and that such charges are incurred in the performance of official duties as representatives or employees of such governmental unit.

DATES OF
OCCUPANCY

Group Name: Pacific Fishery
Management Council

Dates: March 8-15, 2008

SIGNATURE

GOVERNMENTAL
UNIT

DOC/NOAA/NMFS/
Pacific Fishery Management Council

TITLE



The Pacific Fishery Management Council is a federal instrumentality operating under authority of the United States Department of Commerce, National Oceanic and Atmospheric Administration.



TO BE RETAINED BY OPERATORS OF HOTELS,
MOTELS, AND SIMILAR ACCOMMODATIONS AS
EVIDENCE OF EXEMPT OCCUPANCY

EXEMPTION CERTIFICATE
TAX ON OCCUPANCY
OF HOTEL ROOMS

Imposed Pursuant to
Articles 28 and 29 of the Tax Law

NAME OF HOTEL, APARTMENT HOTEL, OR LODGING HOUSE

Hilton Sacramento

DATES

March 7-9, 2008

ADDRESS

**2200 Harvard Street
Sacramento, California 95815**

This is to certify that the above individuals are representatives of the United States Governmental department, agency or instrumentality indicated below; that the charges for the occupancy at the above establishment on the dates set forth below have been or will be paid for by such governmental unit; and that such charges are incurred in the performance of official duties as representatives or employees of such governmental unit.

DATES OF
OCCUPANCY

Group Name: Pacific Fishery
Management Council

Dates: March 7-9, 2008

SIGNATURE

GOVERNMENTAL
UNIT

DOC/NOAA/NMFS/
Pacific Fishery Management Council

TITLE



The Pacific Fishery Management Council is a federal instrumentality operating under authority of the United States Department of Commerce, National Oceanic and Atmospheric Administration.



COUNCIL MEETING ROOM DIAGRAM- Doubletree Hotel, Sacramento, California

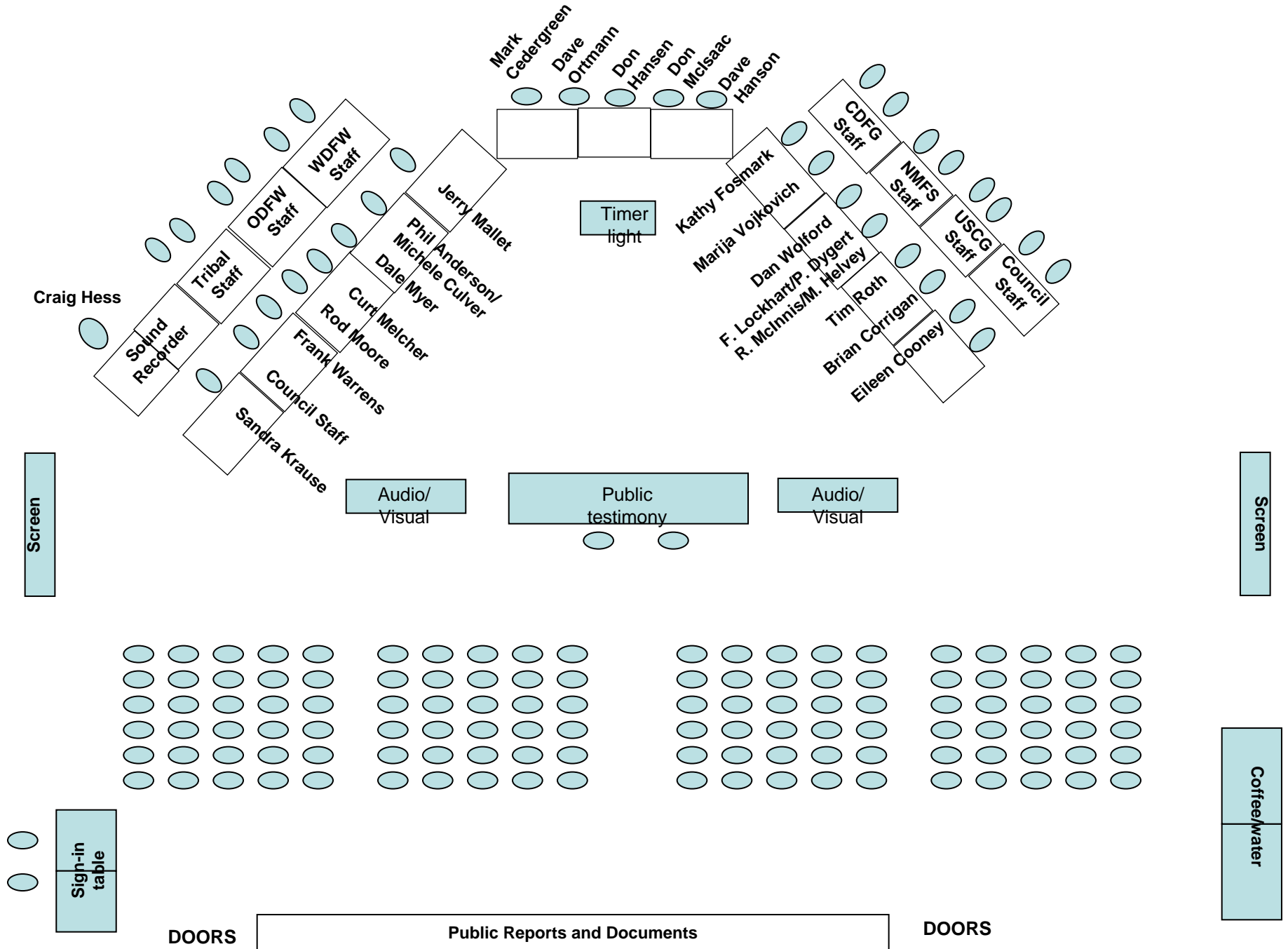

Pacific Fishery Management Council

Council Meeting Schedule

www.pcouncil.org/events/future.html

WEEK OF	LOCATION
March 9–14, 2008	Doubletree Hotel, 2001 Point West Way, Sacramento, CA 95815-4702 916-929-8855 or 800-222-8733
April 6–11, 2008	Marriott Hotel SeaTac Airport, 3201 South 176 th Street, Seattle, WA 98188 206-241-2000
June 8–13, 2008	Crowne Plaza Hotel, 1221 Chess Drive, Foster City, CA 94404 650-5700 or 800-477-5700
September 7–12, 2008 <i>Note: date change</i>	Doubletree Hotel Boise – Riverside 2900 Chinden Boulevard, Boise, Idaho 83714 208-343-1871
November 2–7, 2008	Town and Country Resort, 500 Hotel Circle North, San Diego, CA 92108 619-291-7131
◆ ◆	◆ ◆ ◆
March 8–13, 2009	Marriott Hotel SeaTac Airport, 3201 South 176 th Street, Seattle, WA 98188 206-241-2000
April 5–10, 2009	California
June 14–19, 2009	Washington, Oregon or California
September 13–18, 2009	Washington, Oregon or California
November 1–6, 2009	Oregon or California
◆ ◆	◆ ◆ ◆
March 7–12, 2010	California
April 5–10, 2010 ¹	Oregon or Washington
June 13–18, 2010	Washington, Oregon, or California
September 12–17, 2010	Washington, Oregon, or California
October 31– November 5, 2010	Oregon or California
◆ ◆	◆ ◆ ◆

01/30/08

¹ Easter is April 4, 2010

**DOUBLETREE HOTEL
2001 POINT WEST WAY
SACRAMENTO, CA 95815
916-929-8855**

FROM AIRPORT DIRECTIONS:

Take I-5 south to the Garden Highway exit. Turn Left on Garden Highway, following Garden Highway as it turns into Garden-Arden access. Continue until it turns into Arden Way. Continue on Arden Way, going under Interstate 80. Doubletree Hotel is just past Interstate 80 on Arden Way. Directly after I-80, on Arden Way, the hotel grounds will be on the right hand side. Turn right on Point West Way, and right into the hotel parking lot.

SUPER SHUTTLE:

Sacramento International Airport Super Shuttle is located directly outside the baggage claim area at each terminal. Reservations are not required unless for large parties, or private charters. Simply go to the Super Shuttle service center, and purchase either a round-trip or one way ticket. Taxis are also available at the airport.

General Arrival Directions:

GOING I-5 NORTH:

Take I-5 to HWY 50. Take HWY 50 east to Business 80/Capital City Freeway East. Exit at Arden Way East, keep right. Take the first right onto Point West Way.

GOING I-5 SOUTH:

Take the Garden Highway exit, turning left onto Garden Highway. Continue on Garden Highway until it turns into Garden-Arden. Continue on Garden-Arden as it turns into Arden way. Continue on Arden Way, going under Interstate 80. Just past Interstate 80 you will turn right onto Point West Way, and right into the hotel parking lot.

FROM HIGHWAY 99:

Keep to the left when approaching Sacramento. HWY 99 merges into Business 80/Capital City Freeway. Take the Arden Way east, keep right. Take the first right onto Point West Way. FROM HWY 50: Take the Business 80/Capital City Freeway split. Exit at Arden Way east, keep right. Take the first right onto Point West Way.



Address **2001 Point W Way**
Sacramento, CA 95815

Get Google Maps on your phone
Text the word "GMAPS" to 466453

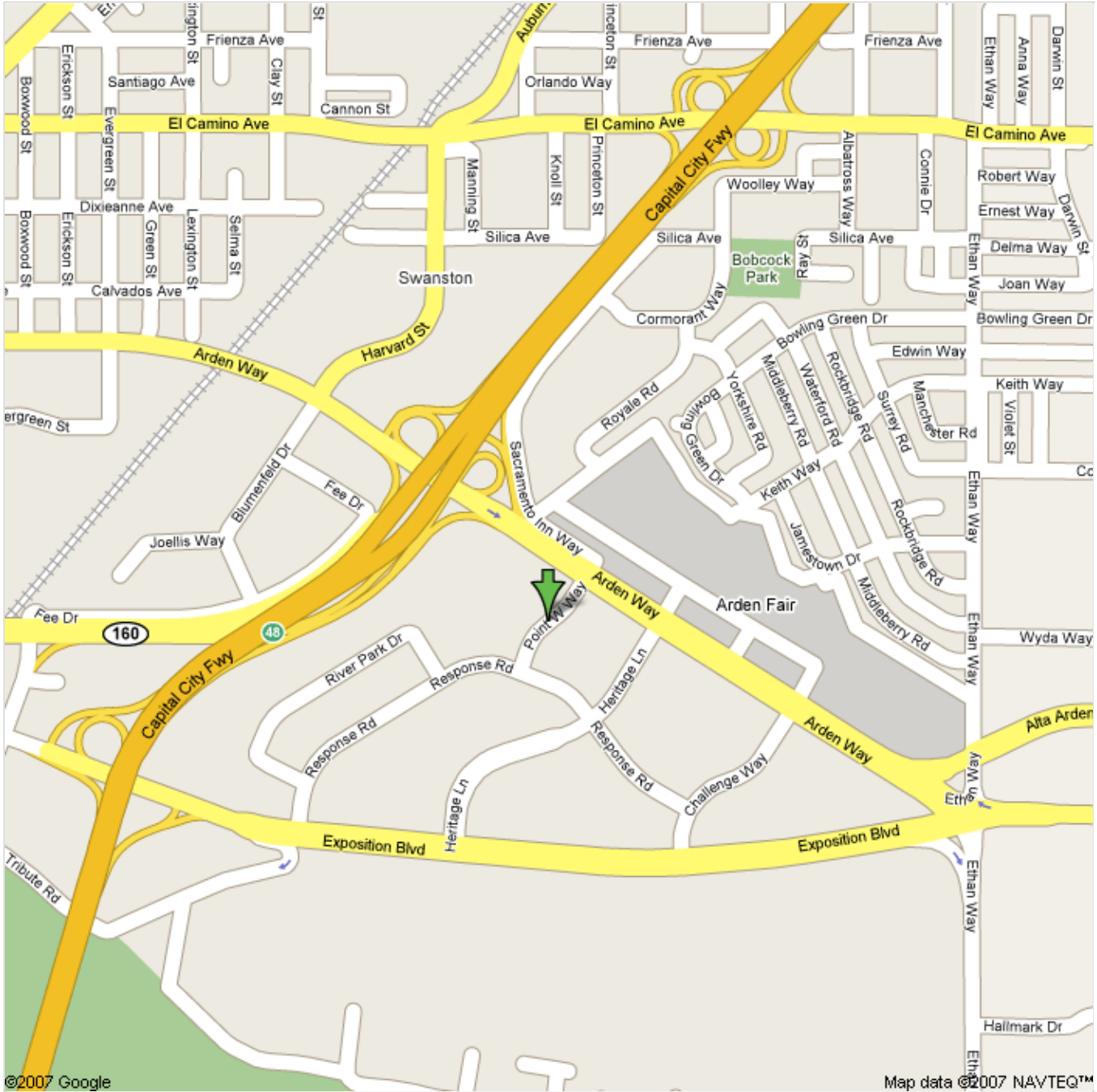

DoubleTree Hotel Sacramento Room Layout



DOUBLE TREE HOTEL
 SACRAMENTO
 2001 POINT WEST WAY
 SACRAMENTO, CA 95815
 916-929-8855
 916-924-4913 FAX

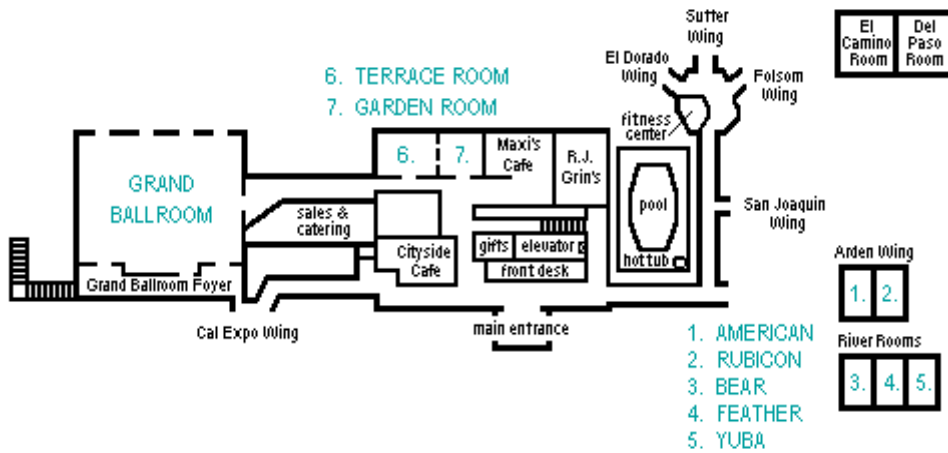

DOUBLETREE HOTEL SACRAMENTO - MAIN LEVEL

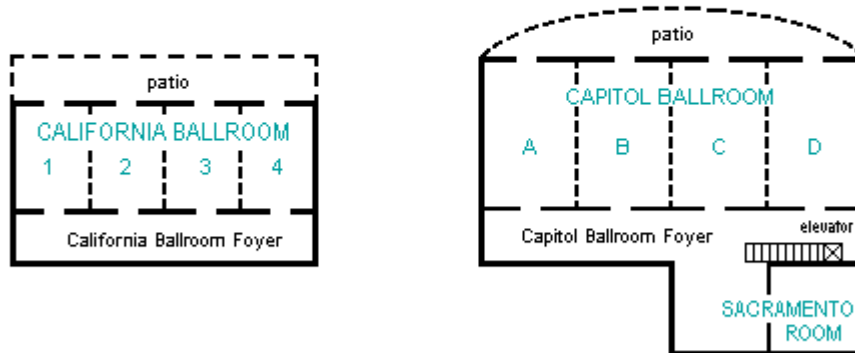

DOUBLETREE HOTEL SACRAMENTO - LOWER LEVEL



PFMC
02/06/07

F:\PFMC\MEETING\2007\March\Hotel\Sacramento_DoubleTree_Layout.doc

RESTAURANT LIST



Results 1-10 of about **20,164** for **restaurants** near **2001 Point W Way, Sacramento, CA 95815**

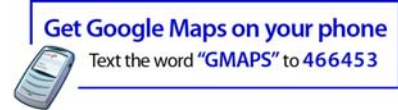

- | | |
|--|--|
| A. Elephant Bar Restaurant
1500 Arden Way, Sacramento, CA
(916) 564-2526 - 2 reviews - 0.1 mi NE | B. El Torito Mexican Grill
1598 Arden Way, Sacramento, CA
(916) 927-0071 - 2 reviews - 0.2 mi E |
| C. Dos Coyotes Border Cafe
1735 Arden Way # 230, Sacramento, CA
(916) 927-0377 - ★★★★★ - 0.3 mi E | D. California Pizza Kitchen
1735 Arden Way # 220, Sacramento, CA
(916) 568-0932 - 4 reviews - 0.3 mi E |
| E. Olive Garden Italian Rstrnt
1780 Challenge Way, Sacramento, CA
(916) 649-8305 - 4 reviews - 0.4 mi SE | F. Sbarro
1689 Arden Way # 2014, Sacramento, CA
(916) 564-0341 - 1 review - 0.3 mi E |
| G. Johnny Rockets
1689 Arden Way # 1106, Sacramento, CA
(916) 564-9567 - 3 reviews - 0.3 mi E | H. Panda Express
1735 Arden Way # 224, Sacramento, CA
(916) 921-5386 - 3 reviews - 0.3 mi E |
| I. Cinnabon
1689 Arden Way # 2002, Sacramento, CA
(916) 927-1964 - 1 review - 0.3 mi E | J. Auntie Anne's Pretzels
1689 Arden Way # 2008, Sacramento, CA
(916) 925-1630 - 0.3 mi E |

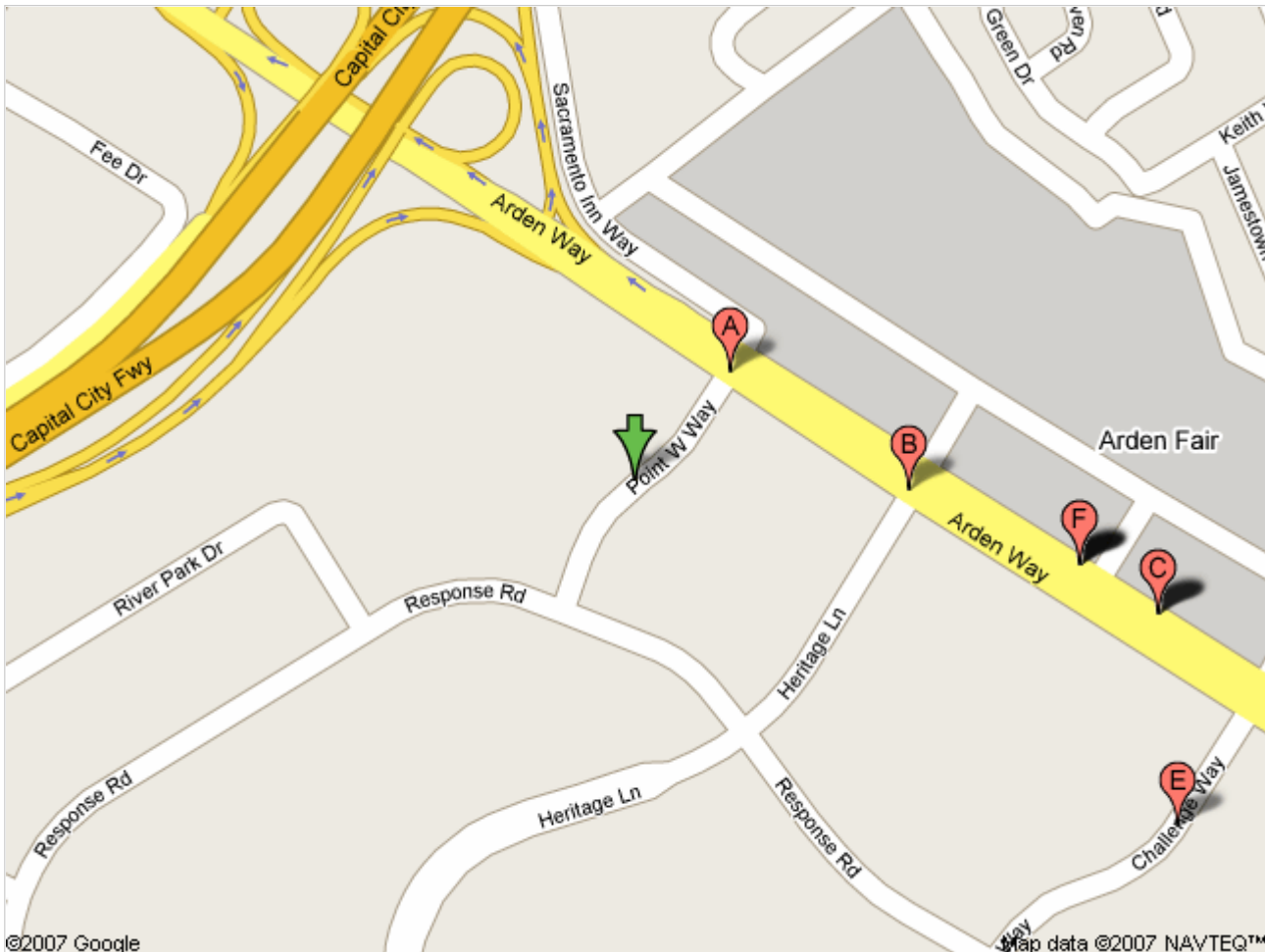



Results 11-20 of about 20,164 for
restaurants near 2001 Point W
Way, Sacramento, CA 95815

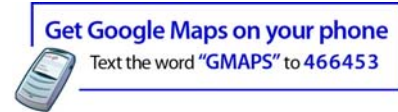

- | | |
|--|--|
| A. Cheesecake Factory
1771 Arden Way, Sacramento, CA
(916) 567-0606 - ★★★★★ - 0.4 mi E | B. Fresh Choice
1689 Arden Way # 1065, Sacramento, CA
(916) 649-3839 - 0.3 mi E |
| C. Papayas Cafe
1555 River Park Dr # 100, Sacramento, CA
(916) 564-3633 - 0.2 mi W | D. Jamba Juice
1689 Arden Way # 1112, Sacramento, CA
(916) 924-5945 - 0.3 mi E |
| E. Steak Escape
1689 Arden Way # 2026, Sacramento, CA
(916) 924-8552 - 1 review - 0.3 mi E | F. Point West Cafe
1610 Arden Way # 155, Sacramento, CA
(916) 649-1928 - 0.3 mi E |
| G. Sierra Gold Inc
1689 Arden Way, Sacramento, CA
(916) 567-0340 - 0.3 mi E | H. China Inn
1689 Arden Way # 2022, Sacramento, CA
(916) 920-0959 - 0.3 mi E |
| I. Cafe Europa
1689 Arden Way # 2016, Sacramento, CA
(916) 929-4140 - 0.3 mi E | J. Cold Stone Creamery
1689 Arden Way # 2010, Sacramento, CA
(916) 568-1415 - 2 reviews - 0.3 mi E |

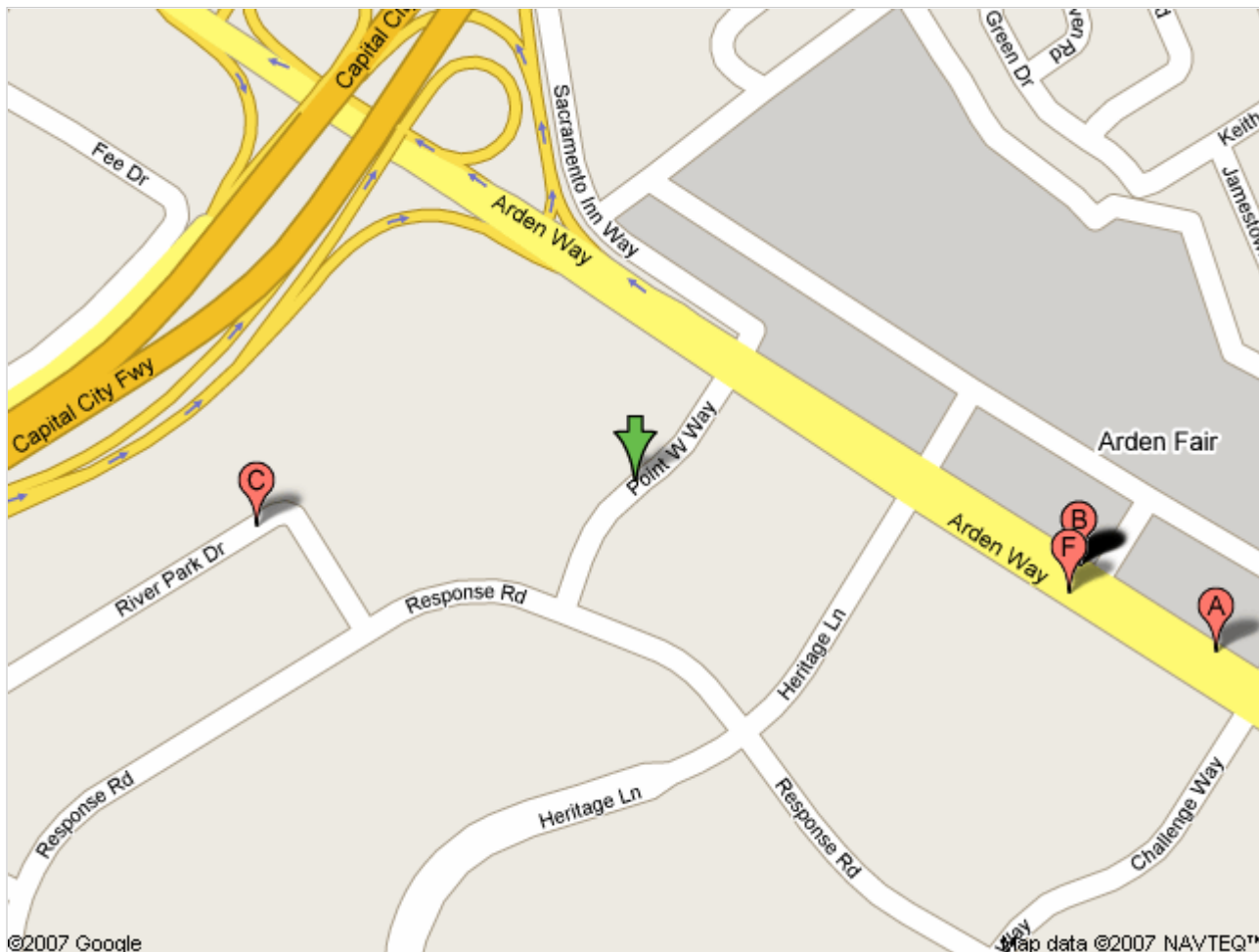



Results 21-30 of about 20,164 for
restaurants near 2001 Point W
Way, Sacramento, CA 95815



- | | |
|---|--|
| A. Frank & Stein Dogs & Drafts
1689 Arden Way, Sacramento, CA
(916) 924-1249 - 0.3 mi E | B. Pretzel Time
1689 Arden Way # 1118, Sacramento, CA
(916) 924-0332 - 0.3 mi E |
| C. Rollerz
1689 Arden Way # 2032, Sacramento, CA
(916) 646-4850 - 0.3 mi E | D. Pluto's Fresh Food
1735 Arden Way, Sacramento, CA
(916) 921-2500 - 2 reviews - 0.3 mi E |
| E. Waffle Shop
1540 River Park Dr # 109, Sacramento, CA
(916) 564-8880 - 0.3 mi W | F. Chuck E Cheese's
1690 Arden Way, Sacramento, CA
(916) 920-9181 - 3 reviews - 0.3 mi E |
| G. Oishii
1689 Arden Way # 2028, Sacramento, CA
(916) 920-5578 - 0.3 mi E | H. Hooters Parco Holdings LP
1555 River Park Dr, Sacramento, CA
(916) 924-9464 - 0.2 mi W |
| I. Market Square Grill
1735 Arden Way # 218, Sacramento, CA
(916) 925-3500 - 0.3 mi E | J. Hooters
1785 Challenge Way, Sacramento, CA
(916) 927-9464 - 1 review - 0.4 mi SE |

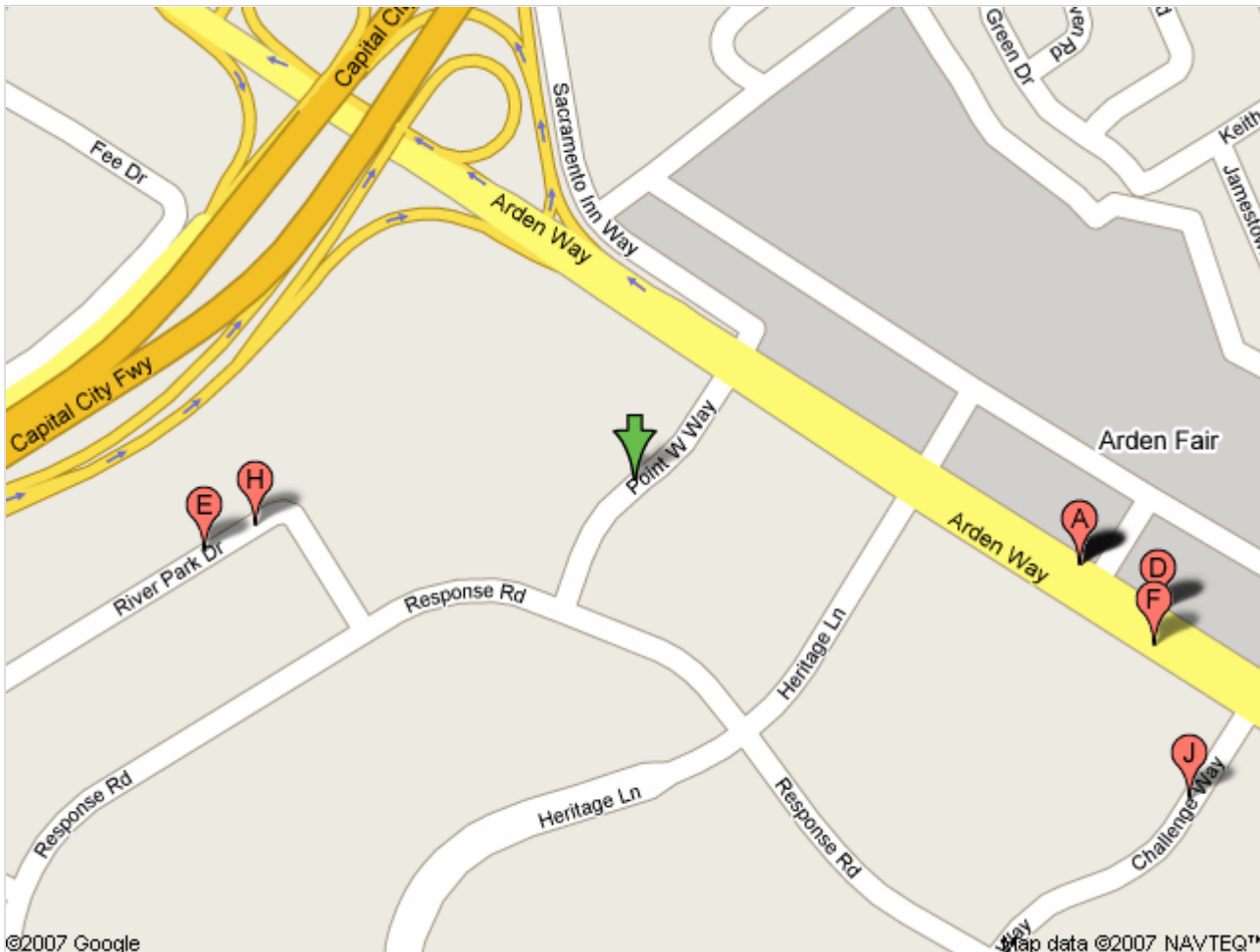



Results 31-40 of about 20,164 for
restaurants near 2001 Point W
Way, Sacramento, CA 95815

Get Google Maps on your phone
Text the word "GMAPS" to 466453



- A. Monterey Bay Cannery
1785 Challenge Way, Sacramento, CA
(916) 920-3474 - 2 reviews - 0.4 mi SE
- B. Mikuni Sushi
1735 Arden Way, Sacramento, CA
(916) 920-2373 - 2 reviews - 0.3 mi E
- C. I Love Teriyaki
1735 Arden Way # 210, Sacramento, CA
(916) 641-2216 - 0.3 mi E
- D. Coco's Bakery Restaurant
1830 Arden Way, Sacramento, CA
(916) 922-6741 - 0.4 mi E
- E. Mikuni
1455 Response Rd # 230, Sacramento, CA
(916) 576-2641 - 0.5 mi SW
- F. Harvard Street Grill
2200 Harvard St, Sacramento, CA
(916) 922-4700 - 0.5 mi NW
- G. Catalina Restaurant Co
1830 Arden Way, Sacramento, CA
(916) 922-0220 - 0.4 mi E
- H. Luau Garden Chinese Buffet
1890 Arden Way, Sacramento, CA
(916) 929-3690 - 1 review - 0.5 mi SE
- I. Romano's Macaroni Grill
2001 Alta Arden Expy, Sacramento, CA
(916) 921-2711 - 2 reviews - 0.7 mi E
- J. Burger King
1915 Arden Way, Sacramento, CA
(916) 925-5024 - 2 reviews - 0.6 mi E

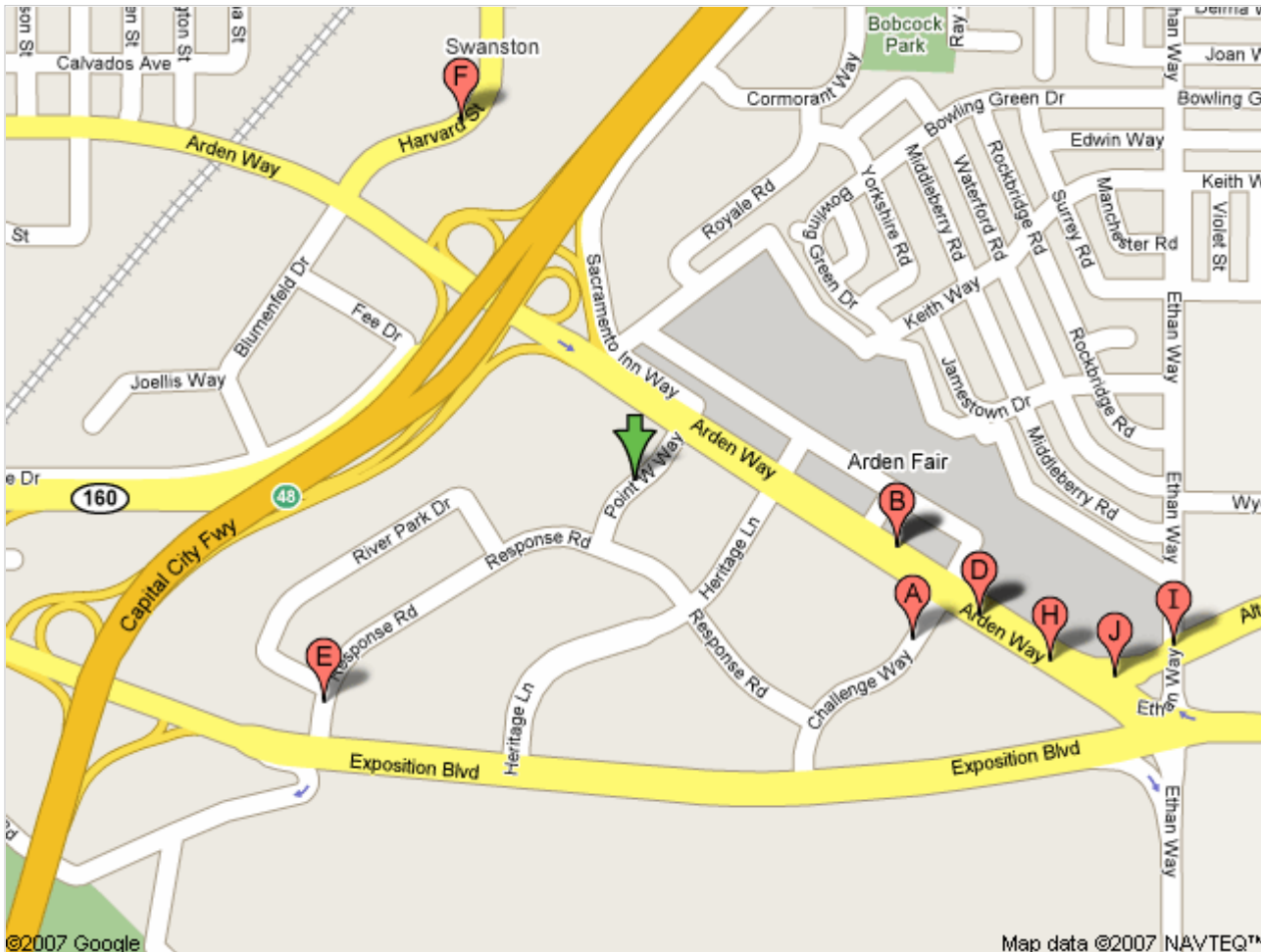



Results 41-50 of about 20,164 for
restaurants near 2001 Point W
Way, Sacramento, CA 95815

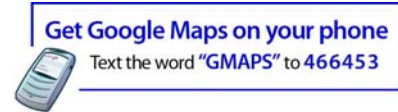

- A. Mimi's Cafe
2029 Alta Arden Expy, Sacramento, CA
(916) 614-9278 - 2 reviews - 0.7 mi E
- B. Punch Line Sacramento
2100 Arden Way # 225, Sacramento, CA
(916) 925-5500 - 3 reviews - 0.9 mi E
- C. Food To You
1600 Sacramento Inn Way # 209, Sacramento, CA
(916) 649-3663 - 4 reviews - 0.5 mi N
- D. Buca Di Beppo
1249 Howe Ave, Sacramento, CA
(916) 922-6673 - ★★★★★ - 1.2 mi SE
- E. Kleenair Restaurant Steam
1657 Silica Ave, Sacramento, CA
(916) 485-4393 - 0.6 mi N
- F. Countertops Designs Inc
1522 Silica Ave, Sacramento, CA
(916) 929-4562 - 0.6 mi N
- G. Chili's Grill & Bar
2100 Arden Way # 185, Sacramento, CA
(916) 929-5838 - 3 reviews - 0.9 mi E
- H. Kitchen Restaurant
2225 Hurley Way # 101, Sacramento, CA
(916) 568-7171 - ★★★★★ - 1.2 mi SE
- I. Jamba Juice
2100 Arden Way # 192, Sacramento, CA
(916) 920-1606 - 1 review - 0.9 mi E
- J. Red Lobster Restaurants
1400 Howe Ave, Sacramento, CA
(916) 921-6011 - 1 review - 1.1 mi SE

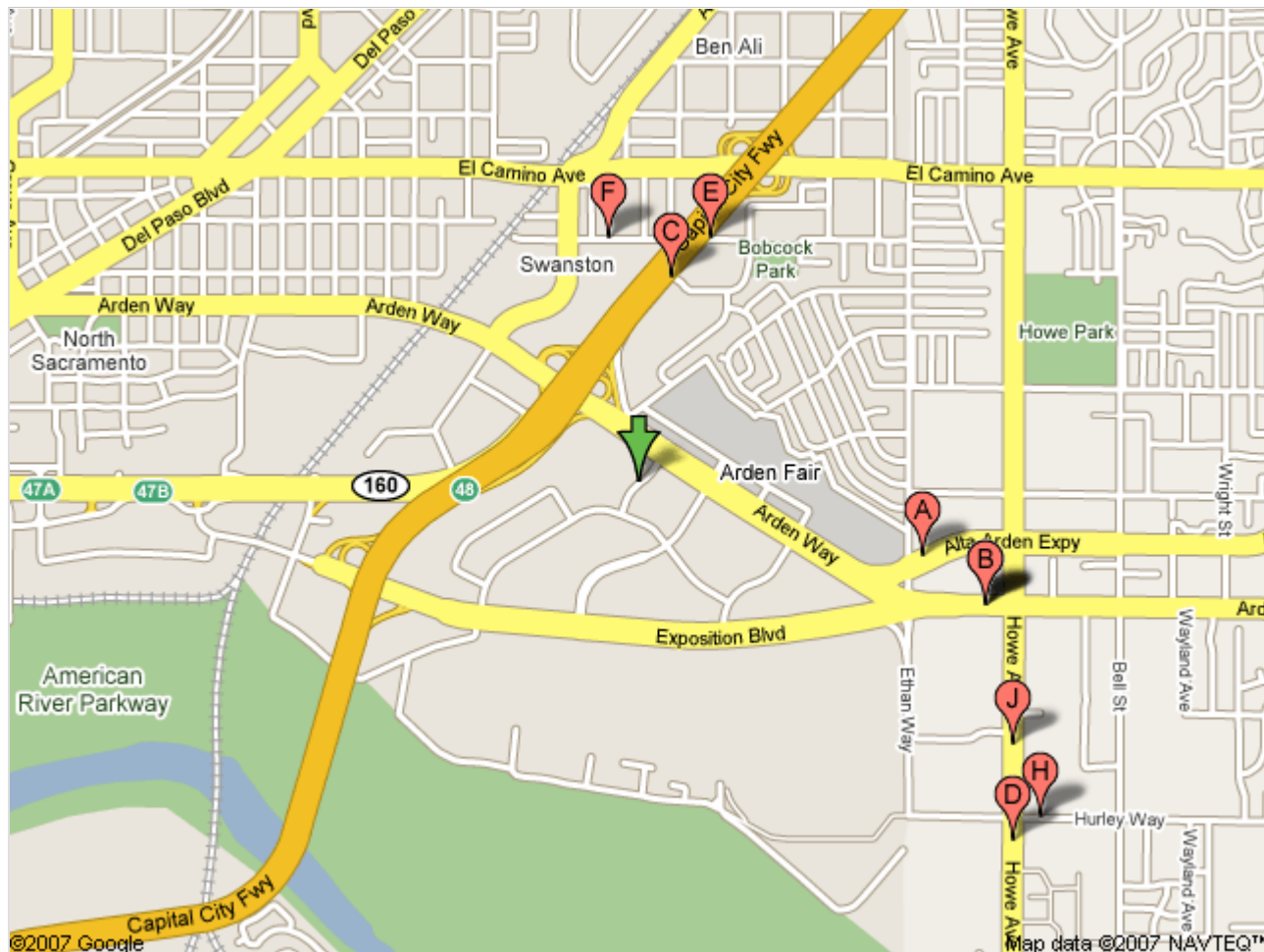

Pacific Fishery Management Council

Roster



Pacific Fishery Management Council
7700 NE Ambassador Place, Suite 101
Portland, Oregon 97220-1384
Phone: 503-820-2280
Toll Free: 866-806-7204
Fax: 503-820-2299
www.pcouncil.org

March 2008

COUNCIL STAFF

Donald O. McIsaac
Executive Director
Donald.McIsaac@noaa.gov

John C. Coon
Deputy Director
John.Coon@noaa.gov

<u>Name</u>	<u>Title</u>	<u>Extension</u>	<u>Email</u>
Brandon, Heather V.	Fishery Management Policy Analyst	409	Heather.Brandon@noaa.gov
Burden, Merrick J.	Staff Officer: Groundfish	423	Merrick.Burden@noaa.gov
Burner, Mike D.	Staff Officer: Coastal Pelagic Species and Scientific and Statistical Committee	414	Mike.Burner@noaa.gov
Dahl, Kit R.	Staff Officer: NEPA and Highly Migratory Species	422	Kit.Dahl@noaa.gov
DeVore, John D.	Staff Officer: Groundfish	413	John.Devore@noaa.gov
Dorval, Renee D.	Administrative Specialist	420	Renee.Dorval@noaa.gov
Gilden, Jennifer D.	Associate Staff Officer: Information, Communications, and Habitat	418	Jennifer.Gilden@noaa.gov
Krause, Sandra J.	Information Technology Specialist	419	Sandra.Krause@noaa.gov
Merydith, Kim A.	Administrative Specialist	425	Kimberly.Merydith@noaa.gov
Montgomery, Carrie K.	Administrative Specialist	421	Carrie.Montgomery@noaa.gov
Porter, Carolyn S.	Executive Specialist	411	Carolyn.Porter@noaa.gov
Seger, James L.	Staff Officer: Fishery Economics	416	Jim.Seger@noaa.gov
Tracy, Charles A.	Staff Officer: Salmon and Pacific Halibut	415	Chuck.Tracy@noaa.gov
Wilson, Mary J.	Fiscal Specialist	408	Mary.Wilson@noaa.gov

LEGAL COUNSEL

<p>Eileen Cooney, Northwest Regional Counsel National Oceanic and Atmospheric Administration Office of General Counsel 7600 Sand Point Way NE BIN C15700 Seattle, WA 98115-6300 206-526-6075</p>	<p>Judson Feder, Southwest Regional Counsel National Oceanic and Atmospheric Administration Office of General Counsel 501 West Ocean Boulevard Long Beach, CA 90802-4213 562-980-4067</p>
--	---



Roster published by the Pacific Fishery Management Council pursuant to National Oceanic and Atmospheric Administration contract number NA05NMF4410008.

TABLE OF CONTENTS

ACRONYMS	5
PACIFIC FISHERY MANAGEMENT COUNCIL.....	7
ADVISORY BODIES.....	11
Coastal Pelagic Species Advisory Subpanel.....	11
Coastal Pelagic Species Management Team	13
Enforcement Consultants.....	15
Groundfish Allocation Committee – Voting Members	17
Groundfish Allocation Committee – Non-Voting Members	19
Groundfish Advisory Subpanel	21
Groundfish Management Team	25
Habitat Committee.....	27
Highly Migratory Species Advisory Subpanel.....	29
Highly Migratory Species Management Team.....	31
Model Evaluation Workgroup	33
Salmon Advisory Subpanel	35
Salmon Technical Team	37
Scientific and Statistical Committee.....	39
AD HOC COMMITTEES	41
Coastal Pelagic Species Tribal Allocation Committee	41
Full Retention Committee:.....	41
Groundfish EFH EIS Oversight Committee:	41
Groundfish Habitat Technical Review Committee:.....	41
Groundfish Multi-year Management Committee:	41
Groundfish Strategic Plan Implementation Oversight Committee:.....	41
Groundfish Strategic Plan Implementation Oversight Open Access Conversion Subcommittee:	41
Groundfish Trawl Individual Quota Committee:.....	41
Highly Migratory Species Management Committee:	41
Marine Protected Area Committee:	41
Observer Implementation Committee.....	41
Salmon Amendment Committee:.....	41
Shore-based Whiting Amendment Workgroup	42
Trawl Individual Quota Enforcement Group:.....	42
Trawl Individual Quota Independent Experts Panel:.....	42
Trawl Rationalization Tracking and Monitoring Committee:	42
Vessel Monitoring System Committee:	42
STANDING COMMITTEES	43
REPRESENTATIVES TO OTHER FORUMS.....	43

ACRONYMS

ADFG	Alaska Department of Fish and Game
CDFG	California Department of Fish and Game
IDFG	Idaho Department of Fish and Game
NMFS	National Marine Fisheries Service
NOAA	National Oceanic and Atmospheric Administration
NWFSC	Northwest Fisheries Science Center
ODFW	Oregon Department of Fish and Wildlife
PSMFC	Pacific States Marine Fisheries Commission
USFWS	United States Fish and Wildlife Service
WDFW	Washington Department of Fish and Wildlife

PACIFIC FISHERY MANAGEMENT COUNCIL

CEDERGREEN, MR. MARK
Washington Obligatory Appointment
Westport Charterboat Association
PO Box 546
Westport, WA 98595-0546
Telephone: (360) 268-0445
Fax: (360) 268-9285
Email: mcedergreen@olynet.com

CURRIER, RADM JOHN
U.S. Coast Guard
U.S. Coast Guard
1st Designee: CDR Peter Martin
2nd Designee: Mr. Brian Corrigan
3rd Designee: LCDR Fran Colantonio
U.S. Coast Guard
915 Second Ave, Rm 3590
Seattle, WA 98174-1067
peter.f.martin@uscg.mil
brian.p.corrigan@uscg.mil
francis.colantonio@uscg.mil
Telephone: (206) 220-7295
Fax: (206) 220-7306
Email: john.p.currier@uscg.mil
Telephone: (206) 220-7304
Telephone: (206) 220-7309
Telephone: (206) 220-7305

ELICKER, MR. ROY
State of Oregon Principal Official
State of Oregon Principal Official
1st Designee: Mr. Steve Williams
2nd Designee: Mr. Curt Melcher
State of Oregon Principal Official
Oregon Department of Fish and Wildlife
3406 Cherry Ave NE
Salem, OR 97303
stephen.h.williams@state.or.us
curt.melcher@state.or.us
Telephone: (503) 947-6000
Fax: (503) 947-6042
Email: roy.elicker@state.or.us
Telephone: (503) 947-6209
Telephone: (503) 947-6044

FOSMARK, MS. KATHY
California Obligatory Appointment
F/V Seadler
PO Box 1338
Pebble Beach, CA 93953
Telephone: (831) 601-0559
Fax: (831) 373-0123
Email: swordstuna@aol.com

GROEN, MR. CAL
State of Idaho Principal Official
Designee: Mr. Jerry Mallet
Director
Idaho Department of Fish and Game
PO Box 25
Boise, ID 83707-0025
mallet36@netzero.net
Telephone: (208) 334-3772
Fax: (208) 334-4885
Email: Cgroen@idfg.idaho.gov
Telephone: (208) 377-4595

HANSEN, MR. DONALD K.
At-Large Appointment
Dana Wharf Sportfishing
34675 Golden Lantern
Dana Point, CA 92629-2990
Telephone: (949) 496-5794
Fax: (949) 496-8212
Email: donald@danawharfssportfishing.com

HANSON, DR. DAVID
Pacific States Marine Fisheries
Commission Appointment
Pacific States Marine Fisheries
Commission
3468 22nd Street NW
Hackensack, MN 56452
Telephone: (218) 675-5231
Fax: (503) 595-3232
Email: dave_hanson@psmfc.org

HOGAN, MR. DAVID
U.S. State Department
Designee: Ms. Amanda Johnson-Miller
U.S. Department of State
2201 C St NW, Ste 7820
Washington, DC 20520
Telephone: (202) 647-3941
Fax: (202) 736-7350
Email: HoganDF@State.gov
Telephone: (202) 736-7350

KOENINGS, DR. JEFF
State of Washington Principal Official

Director
Washington Department of Fish and
Wildlife
600 Capitol Way N
Olympia, WA 98501-1091

Telephone: (360) 902-2225
Fax: (360) 902-2947
Email: director@dfw.wa.gov

1st Designee: Mr. Phil Anderson
2nd Designee: Ms. Michele K. Culver

anderpma@dfw.wa.gov
culvemkc@dfw.wa.gov

Telephone: (360) 902-2720
Telephone: (360) 249-1211

LLOYD, MR. DENBY
State of Alaska Principal Official

Commissioner
Alaska Department of Fish and Game
PO Box 115526
Juneau, AK 99811-5526

Telephone: (907) 465-4100
Fax: (907) 465-2332
Email: dfg.commissioner@alaska.gov

Designee: Mr. Gordy Williams

gordy_williams@fishgame.state.ak.us

Telephone: (907) 465-6143

LOHN, MR. ROBERT
NMFS Northwest Region

Regional Administrator
National Marine Fisheries Service
7600 Sand Point Way NE, BIN
C15700
Seattle, WA 98115-0070

Telephone: (206) 526-6150
Fax: (206) 526-6736
Email: bob.lohn@noaa.gov

1st Designee: Mr. Frank Lockhart
2nd Designee: Dr. Peter Dygert

frank.lockhart@noaa.gov
peter.dygert@noaa.gov

Telephone: (206) 526-6142
Telephone: (206) 526-6734

MCCAMMAN, MR. JOHN
State of California Principal Official

Interim Director
California Department of Fish and
Game
1416 Ninth Street
Sacramento, CA 95814

Telephone: (916) 653-7667
Fax: (916) 653-7387
Email: director@dfg.ca.gov

Designee: Ms. Marija Vojkovich

mvojkovich@dfg.ca.gov

Telephone: (805) 568-1246

MCINNIS, MR. ROD
NMFS Southwest Region

Regional Administrator, Southwest
Region
National Marine Fisheries Service
501 W Ocean Blvd, Ste 4200
Long Beach, CA 90802-4213

Telephone: (562) 980-4000
Fax: (562) 980-4018
Email: rod.mcinnis@noaa.gov

Designee: Mr. Mark Helvey

mark.helvey@noaa.gov

Telephone: (562) 980-4040

MOORE, MR. ROD
At-Large Appointment

Executive Director
West Coast Seafood Processors
Association
1618 SW First St, Ste 318
Portland, OR 97201

Telephone: (503) 227-5076
Fax: (503) 227-0237
Email: seafood@integra.net

MYER, MR. DALE
At-Large Appointment

Arctic Storm, Inc.
400 N 34th St, Ste 306
Seattle, WA 98103

Telephone: (206) 547-6557
Fax: (206) 547-3165
Email: dmyer@arcticstorm.com

ORTMANN, MR. DAVE
Idaho Obligatory Appointment

9007 W Forest Shores
Coeur D'Alene, ID 83814

Telephone: (208) 765-8733
Fax:
Email: haf2fish@verizon.net

ROTH, MR. TIM
U.S. Fish and Wildlife Service

Deputy Project Leader
U.S. Fish and Wildlife Service
1211 SE Cardinal Ct, Ste 100
Vancouver, WA 98683

Telephone: (360) 604-2500
Fax: (360) 604-2505
Email: timothy_roth@fws.gov

SONES, MR. DAVID
Tribal Appointment

PO Box 618
Neah Bay, WA 98357

Telephone: (360) 645-2193
Fax: (360) 645-2323
Email: ddavid160@centurytel.net

WARRENS, MR. FRANK
Oregon Obligatory Appointment

President
Frank Warrens Automotive and
Marine Services, Inc.
50 NW 20th Ave
Portland, OR 97209-1903

Telephone: (503) 228-6607
Fax: (503) 228-1383
Email: frank@frankwarrensauto.com

WOLFORD, MR. DAN
At-Large

16171 Jasmine Way
Los Gatos, CA 95032

Telephone: (408) 356-2465
Fax: (408) 356-4325
Email: danwolford@earthlink.net

ADVISORY BODIES

COASTAL PELAGIC SPECIES ADVISORY SUBPANEL

ENTICKNAP, MR. BEN
Conservation

Pacific Project Manager
Oceana
4189 SE Division Street
Portland, OR 97202

Telephone: (503) 235-0278
Fax: (503) 230-0903
Email: Benticknap@oceana.org

GUGLIELMO, MR. NEIL
California Commercial

F/V Trionfo
1728 Via Pajaro
Camarillo, CA 93012

Telephone: (805) 384-9384
Fax:
Email: fvtrionfo@aol.com

HOINSKY, MS. TERRY
California Commercial

President
Fishermen's Union of America
510 North Broad Ave
Wilmington, CA 90744-5847

Telephone: (310) 834-2099
Fax: (310) 834-2098
Email:

LAW, MR. EUGENE
Oregon Commercial

754 Olalla Rd
Toledo, OR 97391

Telephone: (541) 336-2645
Fax: (541) 336-4214
Email: mslaw2645@hotmail.com

MARCHAND, JR., MR. PIERRE
Processor

President
Jessie's Ilwaco Fish Company
PO Box 800
Ilwaco, WA 98624-0800

Telephone: (360) 642-3773
Fax: (360) 642-3362
Email: pierrem@ilwacofish.com

OKONIEWSKI, MR. MIKE
Vice-Chair
Processor

Pacific Seafood
1635 Down River Dr
Woodland, WA 98674

Telephone: (360) 225-8553
Fax:
Email: mokoniewski@pacseafood.com

PLESCHNER-STEELE, MS. DIANE
Processor

Executive Director
California Wetfish Producers
Association
PO Box 1951
Buellton, CA 93427

Telephone: (805) 693-5430
Fax: (805) 686-9312
Email: dplesch@earthlink.net

ROYAL, MR. JOHN
Chair
California Commercial

PO Box 1162
San Pedro, CA 90733

Telephone:
Fax:
Email:

STRASSER, CPT PAUL
California Charter/Sport

Owner
M.C.I.P. Sportfishing
141 W 22nd Street
San Pedro, CA 90731

Telephone: (310) 612-4747
Fax: (310) 514-2452
Email: pstrasser12@ca.rr.com

ZUANICH, MR. ROBERT P.
Washington Commercial

Executive Director
Stine Vessel Owners
1900 W Nickerson, Ste 320
Seattle, WA 98119

Telephone: (206) 283-7733
Fax: (206) 283-7795
Email: rpz@psvoa.com

COASTAL PELAGIC SPECIES MANAGEMENT TEAM

BRADY, MS. BRIANA
CDFG Representative

California Department of Fish and
Game
1933 Cliff Drive, Suite 9
Santa Barbara, CA 93109

Telephone: (805) 568-1323
Fax:
Email: bcbrady@dfg.ca.gov

CRONE, DR. PAUL
Vice Chair
NMFS

National Marine Fisheries Service
PO Box 271
La Jolla, CA 92038-0271

Telephone: (858) 546-7069
Fax: (858) 546-5653
Email: paul.crone@noaa.gov

HENRY, MS. CAROL
WDFW

Marine Resources Data Analyst
Washington Department of Fish and
Wildlife
48 Devonshire Rd
Montesano, WA 98563-9618

Telephone: (360) 249-4628 254
Fax: (360) 664-0689
Email: henrycah@dfw.wa.gov

HERRICK, DR. SAMUEL F.
Chair
NMFS

Industry Economist
National Marine Fisheries Service
PO Box 271
La Jolla, CA 92037-0271

Telephone: (858) 546-7111
Fax: (858) 546-7003
Email: Sam.Herrick@noaa.gov

HILL, DR. KEVIN
NMFS Representative

National Marine Fisheries Service
PO Box 271
La Jolla, CA 92038-0271

Telephone: (858) 546-7052
Fax: (858) 546-7003
Email: kevin.hill@noaa.gov

SWEETNAM, MR. DALE
CDFG

Senior Marine Biologist, Supervisor
California Department of Fish and
Game
8604 La Jolla Shores Dr
La Jolla, CA 92037

Telephone: (858) 546-7170
Fax: (858) 546-7116
Email: dale.sweetnam@noaa.gov

WIEDOFF, MR. BRETT
ODFW

Nearshore Resources Project Leader
Oregon Department of Fish and
Wildlife
2040 SE Marine Science Dr
Newport, OR 97365

Telephone: (541) 867-0300 258
Fax: (541) 867-0311
Email: Brett.L.Wiedoff@state.or.us

ENFORCEMENT CONSULTANTS

CENCI, CAPT MIKE Washington	Washington Department of Fish and Wildlife PO Box 307 Naselle, WA 98638	Telephone: (360) 581-3305 Fax: (360) 642-3967 Email: cencimac@dfw.wa.gov
COLANTONIO, LCDR FRAN 13th Coast Guard District	U.S. Coast Guard 915 2nd Ave, Rm 3562 Seattle, WA 98174-1067	Telephone: (206) 220-7305 Fax: (206) 220-7306 Email: francis.colantonio@uscg.mil
CORRIGAN, MR. BRIAN Vice-Chair 13th Coast Guard District	U.S. Coast Guard 915 2nd Ave, Rm 3562 Seattle, WA 98174-1067	Telephone: (206) 220-7309 Fax: (206) 220-7306 Email: brian.p.corrigan@uscg.mil
MASTERS, MR. DON NMFS Southwest Region	Special Agent in Charge of the Southwest Division NMFS Southwest Region 501 W. Ocean BLVD #4300 Long Beach, CA 90802	Telephone: (562) 980-4050 Fax: Email: Don.Masters@noaa.gov
Designee: SA Tim Broadman	tim.broadman@noaa.gov	Telephone: (707) 826-9247
NOMURA, MS. VICKI NMFS Northwest Region	Special Agent in Charge National Marine Fisheries Service 7600 Sand Point Way NE, BIN C15700 Seattle, WA 98115-0070	Telephone: (206) 526-6137 Fax: (206) 526-6528 Email: Vicki.Nomura@noaa.gov
Designee: Mr. Dayna Matthews	dayna.matthews@noaa.gov	Telephone: (360) 753-4409
SAMUELS, LT. JEFF Oregon	Oregon State Police, General Headquarters 255 Capitol Street NE, 4th Floor Salem, OR 97301	Telephone: (503) 378-3725 4304 Fax: (503) 363-5475 Email: jeff.samuels@state.or.us
STEWART, LTJG BRITTANY 11th Coast Guard District	U.S. Coast Guard Coast Guard Island, Bldg. 50-5 Alameda, CA 94501-5100	Telephone: (510) 437-5392 Fax: (510) 437-3223 Email: Brittany.g.stewart@uscg.mil
WARRINGTON, MR. TONY Chair California	California Department of Fish and Game 1416 - 9th St, Rm 1326 Sacramento, CA 95814	Telephone: (916) 657-2355 Fax: Email: twarring@dfg.ca.gov
Designee: CPT Marty Maytorena	mmaytorena@dfg.ca.gov	Telephone: (562) 342-7190

GROUND FISH ALLOCATION COMMITTEE – VOTING MEMBERS

ANDERSON, MR. PHIL WDFW	Deputy Director Washington Department of Fish and Wildlife 600 Capitol Way N Olympia, WA 98501-1091	Telephone: (360) 902-2720 Fax: (360) 902-2158 Email: anderpma@dfw.wa.gov
HANSEN, MR. DONALD K. Council Chair	Dana Wharf Sportfishing 34675 Golden Lantern Dana Point, CA 92629-2990	Telephone: (949) 496-5794 Fax: (949) 496-8212 Email: donald@danawharfsportfishing.com
HANSON, DR. DAVID PSMFC	Pacific States Marine Fisheries Commission 3468 22nd Street NW Hackensack, MN 56452	Telephone: (218) 675-5231 Fax: (503) 595-3232 Email: dave_hanson@psmfc.org
LOCKHART, MR. FRANK NMFS	National Marine Fisheries Service 7600 Sand Point Way, NE Seattle, WA 98115-0070	Telephone: (206) 526-6142 Fax: (206) 526-6736 Email: frank.lockhart@noaa.gov
MELCHER, MR. CURT Oregon	Deputy Director of Oregon Fish and Wildlife Programs Oregon Department of Fish and Wildlife 3406 Cherry Avenue NE Salem, OR 97303	Telephone: (503) 947-6208 Fax: (503) 947-6202 Email: curt.melcher@state.or.us
VOJKOVICH, MS. MARIJA California	Offshore Ecosystem Coordinator California Department of Fish and Game 1933 Cliff Dr, Ste 9 Santa Barbara, CA 93109-1520	Telephone: (805) 568-1246 Fax: (805) 568-1235 Email: mvojkovich@dfg.ca.gov

GROUNDFISH ALLOCATION COMMITTEE – NON-VOTING MEMBERS

BARRAGER, DR. STEPHEN Conservation	Stanford Law School 2703 Broderick St. San Francisco, CA 94123	Telephone: (650) 504-1578 Fax: (650) 725-8509 Email: barrager@stanford.edu
GHIO, MR. TOM Open Access Fishery	Ghio Fish Company 112 Gilbert CT Santa Cruz, CA 95065	Telephone: (831) 460-1455 Fax: Email: ghiofish2000@yahoo.com
LEIPZIG, MR. PETER Limited Entry Non-Whiting Trawl	Executive Director Fisherman's Marketing Association 1585 Heartwood Drive McKinleyville, CA 95519	Telephone: (707) 840-0182 Fax: (707) 840-0539 Email: pete@trawl.org
LONGO EDER, MS. MICHELE Limited Entry Fixed Gear	Michele Longo Eder Attorney at Law, LLC PO Box 1530 Newport, OR 97365	Telephone: (541) 265-3337 Fax: (541) 265-6633 Email: michele@michelelongoeder.com
MANN, MS. HEATHER Processor	President Munro Consulting PO Box 176 Siletz, OR 97380	Telephone: (541) 444-2208 Fax: (541) 444-2319 Email: munroconsulting@msn.com
OSBORN, MR. ROBERT Recreational Fisher	Fishery Consultant United Anglers of Southern California 17391 Murphy Avenue Irvine, CA 92614-5919	Telephone: (562) 592-6041 Fax: (949) 863-9447 Email: bob@unitedanglers.com
WALDECK, MR. DANIEL A. Pacific Whiting Fishery	Executive Director Pacific Whiting Conservation Cooperative 205 SE Spokane St, Ste 338 Portland, OR 97202-6413	Telephone: (503) 238-7492 Fax: (503) 238-7499 Email: dwaldeck@comcast.net

GROUND FISH ADVISORY SUBPANEL

ALVERSON, MR. ROBERT Fixed Gear At-Large	Fishing Vessel Owner's Association 4005 - 20th Ave W, Room 232 Seattle, WA 98199-1290	Telephone: (206) 283-7735 Fax: (206) 283-3341 Email: robertalverson@msn.com
ANCONA, MR. TOM California Trawl	Tommy's Marine Service - F/V Caito Bros, Inc. PO Box 1227 Fort Bragg, CA 95437	Telephone: (707) 964-5423 Fax: (707) 964-7206 Email: ancona@mcn.org
BARRAGER, DR. STEPHEN Conservation	Stanford Law School 2703 Broderick St. San Francisco, CA 94123	Telephone: (650) 504-1578 Fax: (650) 725-8509 Email: barrager@stanford.edu
BUTLER, MR. WAYNE Oregon Charter Boat Operator	Prowler Charters PO Box 674 Bandon, OR 97411	Telephone: (541) 347-9126 Fax: (541) 347-9126 Email: wayne.b1@mycomspan.com
COHEN, MR. BARRY Processor	Olde Port Fisheries/Del Mar PO Box 40 Avila Beach, CA 93424	Telephone: Fax: Email: fishmancohen@aol.com
GHIO, MR. TOM Chair Fixed Gear At-Large	Ghio Fish Company 112 Gilbert CT Santa Cruz, CA 95065	Telephone: (831) 460-1455 Fax: Email: ghiofish2000@yahoo.com
HANSEN, MR. MIKE California Charter South of Point Conception	Dana Wharf Sportfishing 34675 Golden Lantern Dana Point, CA 92629-2990	Telephone: (949) 496-5794 Fax: (949) 496-8212 Email: cptomike@cox.net
HENSEL, MR. KENYON Open Access North of Cape Mendocino	Hensel's 871 Elk Valley Rd Crescent City, CA 95531-9345	Telephone: (707) 465-6857 Fax: (707) 465-6857 Email: khensel@charter.net
HOLLOWAY, MR. JOHN Sport Fisheries At-Large	Executive Board Secretary Oregon Anglers/Oregon RFA 6823 SW Burlingame Ave Portland, OR 97219-2127	Telephone: (503) 452-7919 Fax: (503) 452-4919 Email: manleydesign@comcast.net

INGLES, MR. ROBERT C. California Charter North of Pt Conception	Golden Gate Fisherman's Association PO Box 3728 Hayward, CA 94544	Telephone: (510) 581-2628 Fax: Email: sherry@fishingboat.com
LARKIN, MR. MARION J. Washington Trawl	19737 Trophy Ln Mount Vernon, WA 98274	Telephone: (360) 445-2400 Fax: (360) 445-4049 Email: mjlarin@hughes.net
MANN, MS. HEATHER Vice-Chair Processor	President Munro Consulting PO Box 176 Siletz, OR 97380	Telephone: (541) 444-2208 Fax: (541) 444-2319 Email: munroconsulting@msn.com
MARTIN, MR. JIM Sport Fisheries At-Large	West Coast Regional Director Recreational Fishing Alliance PO Box 2420 Ft. Bragg, CA 95437	Telephone: (707) 964-8326 Fax: (707) 964-8326 Email: flatland@mcn.org
PLATT, MR. DAN Southern Open Access	STMA PO Box 1912 Fort Bragg, CA 95437	Telephone: (707) 961-0240 Fax: Email: morefish@mcn.org
RICHTER, MR. GERRY Fixed Gear At-Large	B & G Seafoods, Inc. 217 Calle Manzanita Santa Barbara, CA 93105	Telephone: (805) 569-3099 Fax: (805) 569-3099 Email: gdrfish@msn.com
SEILER, MR. DAVE Washington Sport Fisher At-Large	9538 Gate Road SW Olympia, WA 98512	Telephone: (360) 273-7548 Fax: Email: kindseiler@scattercreek.com
SMITH, MR. GORDON Tribal Fisher	F/V Pacific Stalker PO Box 712 Neah Bay, WA 98357	Telephone: (360) 645-2648 Fax: (360) 645-3199 Email: gmsm@centurytel.net
SMOTHERMAN, MR. KELLY E. Oregon Trawl	F/V Miss Mary PO Box 257 Hammond, OR 97121	Telephone: (503) 861-7716 Fax: (503) 861-0764 Email:
WALDECK, MR. DANIEL A. At-Sea Processor	Executive Director Pacific Whiting Conservation Cooperative 205 SE Spokane St, Ste 338 Portland, OR 97202-6413	Telephone: (503) 238-7492 Fax: (503) 238-7499 Email: dwaldeck@comcast.net

WEBER, MR. RHETT
Washington Charter Boat Operator

F/V Slammer Fishing
PO Box 2511
Westport, WA 98595-2511

Telephone: (360) 268-6229
Fax:
Email: fisherymeetings@comcast.net

GROUND FISH MANAGEMENT TEAM

Vacancy: One ODFW Position, One NMFS Northwest Region Position, One NMFS Southwest Science Center Position.

AMES, MS. KELLY
Chair
ODFW

Oregon Department of Fish and
Wildlife
2040 SE Marine Science Drive
Newport, OR 97365

Telephone: (541) 867-0300 291
Fax:
Email: Kelly.L.Ames@state.or.us

ARENTZEN, MS. GRETCHEN
NMFS Northwest Region

Fishery Management Specialist
National Marine Fisheries Service
7600 Sand Point Way NE
Seattle, WA 98115

Telephone: (206) 526-6147
Fax: (206) 526-6736
Email: gretchen.arentzen@noaa.gov

BUDRICK, MR. JOHN
CDFG

California Department of Fish and
Game
350 Harbor Blvd.
Belmont, CA 94002

Telephone: (650) 413-1501
Fax: (650) 631-6119
Email: jbudrick@dfg.ca.gov

GREBEL, MS. JOANNA
CDFG

California Department of Fish and
Game
20 Lower Ragsdale Drive
Monterey, CA 93940

Telephone: (831) 649-2804
Fax:
Email: Jgrebel@dfg.ca.gov

JONES, MR. ROBERT F.
Tribal Agency

Marine Fish Biologist
Northwest Indian Fisheries
Commission
PO Box 1029
Forks, WA 98331

Telephone: (360) 374-5501
Fax: (360) 374-5592
Email: rjones@nwifc.org

NILES, MR. COREY
WDFW

Marine Resources Policy Coordinator
Washington Department of Fish and
Wildlife
48 Devonshire Road
Montesano, WA 98563-9618

Telephone: (360) 249-4628
Fax: (360) 664-0689
Email: nilescbn@dfw.wa.gov

REED, MS. HEATHER
WDFW

Coastal Marine Resources Policy
Coordinator
Washington Department of Fish and
Wildlife
48 Devonshire Road
Montesano, WA 98563

Telephone: (360) 249-1202
Fax: (360) 664-0689
Email: reedhjr@dfw.wa.gov

WALLACE, MR. JOHN
NMFS NWFSC

National Marine Fisheries Service
2725 Montlake Blvd. East
Seattle, WA 98112

Telephone: (206) 860-3456
Fax: (206) 860-3394
Email: john.wallace@noaa.gov

HABITAT COMMITTEE

Vacancy: One IDFG Position.

CHESNEY, MR. BRYANT NMFS Regional Representative	National Marine Fisheries Service 501 W Ocean Blvd, Ste 4200 Long Beach, CA 90802	Telephone: (562) 980-4037 Fax: (562) 980-4092 Email: bryant.chesney@noaa.gov
Designee: Ms. Korie Schaeffer	korie.schaeffer@noaa.gov	Telephone: (707) 575-6087
ELLIS, MR. STUART Chair Northwest Columbia River Tribes	Fisheries Scientist Columbia River Inter-Tribal Fish Commission 729 NE Oregon, Ste 200 Portland, OR 97232-2175	Telephone: (503) 238-0667 Fax: (503) 235-4228 Email: ells@critfc.org
HAMILTON, MS. LIZ Sport Fisheries At-Large	Executive Director Northwest Sportfishing Industry Association PO Box 4 Oregon City, OR 97045-0004	Telephone: (503) 631-8859 Fax: (503) 631-3887 Email: nsializ@aol.com
HANSON, MR. LARRY K. CDFG Representative	Senior Biologist and Supervisor California Department of Fish and Game 601 Locust Street Redding, CA 96001	Telephone: (530) 225-2866 Fax: (530) 225-2381 Email: lhanson@dfg.ca.gov
Designee: Ms. Vicki Frey	vfrey@dfg.ca.gov	Telephone: (707) 445-7830
KAWAHARA, MR. JOEL Commercial Fisheries	3652 Lindsay Hill Rd Quilcene, WA 98376	Telephone: (206) 406-7026 Fax: Email: joelkaw@earthlink.net
MCGONIGAL, MR. HUFF National Marine Sanctuaries	Monterey Bay National Marine Sanctuary 299 Foam St, Ste D Monterey, CA 93940	Telephone: (831) 647-4254 Fax: (831) 647-4250 Email: huff.mcgonigal@noaa.gov
MEREMS, MS. ARLENE Oregon Department of Fish and Wildlife	Acting Marine Habitat Project Leader Oregon Department of Fish and Wildlife 2040 SE Marine Science Dr Newport, OR 97365	Telephone: (541) 867-0300 246 Fax: (541) 867-0311 Email: arlene.r.merems@state.or.us
ORCUTT, MR. MIKE California Tribes	Hoopa Valley Tribe PO Box 930 Hoopa, CA 95546-0417	Telephone: (530) 625-4267 Fax: (530) 625-4995 Email: director@hoopa-nsn.gov

OSMOND, MR. MICHAEL
Conservation

Senior Program Officer
World Wildlife Fund
171 Forest Ave
Palo Alto, CA 94301

Telephone: (650) 323-3506
Fax: (650) 325-2236
Email: michael.osmond@wwfus.org

RECHT, MS. FRAN
PSMFC

Habitat Program Project Manager
Pacific States Marine Fisheries
Commission
PO Box 221
Depoe Bay, OR 97341-0221

Telephone: (541) 765-2229
Fax: (541) 765-2229
Email: franrecht@centurytel.net

ROTH, MR. TIM
USFWS

Deputy Project Leader
U.S. Fish and Wildlife Service
1211 SE Cardinal Ct, Ste 100
Vancouver, WA 98683

Telephone: (360) 604-2500
Fax: (360) 604-2505
Email: timothy_roth@fws.gov

SCOTT, MS. TERESA
WDFW

Natural Resource Policy Analyst
Washington Department of Fish and
Wildlife
MS 43136, 600 Capitol Way N
Olympia, WA 98501-1091

Telephone: (360) 902-2713
Fax: (360) 902-2158
Email: scotttls@dfw.wa.gov

WAKEFIELD, DR. WALDO
NMFS FSC

National Marine Fisheries Service
2032 SE OSU Dr
Newport, OR 97365

Telephone: (541) 867-0542
Fax: (541) 867-0505
Email: waldo.wakefield@noaa.gov

WHITE, MR. SEAN
At-Large

Principal Environmental Specialist
Sonoma County Water Agency
PO Box 11628
Santa Rosa, CA 95406

Telephone: (707) 547-1908
Fax: (707) 524-3782
Email: seanw@scwa.ca.gov

HIGHLY MIGRATORY SPECIES ADVISORY SUBPANEL

BUELL, MS. LINDA Northern Charter Boat Operator	7695 Galloway Road Cloverdale, OR 97112	Telephone: (503) 965-2238 Fax: (503) 322-0381 Email: fishon@garibaldicharters.com
DUPUY, MR. PETE Commercial At-Large	Ocean Pacific Sea Food 18212 Rosita St Tarzana, CA 91356	Telephone: (818) 343-9927 Fax: (818) 881-5003 Email: lapazkd@aol.com
FELANDO, MR. AUGUST Commercial Purse Seine	870 San Antonio Pl San Diego, CA 92106	Telephone: (619) 223-7654 Fax: (619) 223-7958 Email: augustfelando@aol.com
FLETCHER, MR. ROBERT Southern California Charter Boat Operator	President Sportfishing Association of California 1084 Bangor Street San Diego, CA 92106	Telephone: (619) 226-6455 Fax: (619) 226-0175 Email: dart@sacemup.org
FOLTZ, MR. STEVE Processor South of Cape Mendocino	V.P. Sales/Partner Chesapeake Fish Co. 535 Harbor Lane San Diego, CA 92101	Telephone: (619) 238-0526 Fax: (619) 778-9734 Email: sfoltz@chesapeakefish.com
FOSMARK, MR. STEVEN Commercial Gillnet Fisheries	Owner/Operator F/V Seeadler 3059 Sherman Rd Pebble Beach, CA 93953	Telephone: (831) 373-5238 Fax: (831) 373-0123 Email: fvseeadler@aol.com
FRICKE, MR. DOUGLAS Vice-chair Commercial At-Large	Boat Seafoods PO Box 306 Hoquiam, WA 98550	Telephone: (360) 580-3027 Fax: (360) 538-0466 Email: fricked@techline.com
HEIKKILA, MR. WAYNE Chair Commercial Troll	Executive Director Western Fishboat Owner's Association PO Box 992723 Redding, CA 96099	Telephone: (530) 229-1097 Fax: (530) 229-0973 Email: wfoa@charter.net
JEANS, MS. MEGHAN Conservation	Pacific Fish Conservation Manager The Ocean Conservancy 116 New Montgomery St., Ste. 810 San Francisco, CA 94105	Telephone: (415) 979-0900 Fax: (415) 979-0901 Email: mjeans@oceanconservancy.org

MARCHAND, JR., MR. PIERRE
Processor

President
Jessie's Ilwaco Fish Company
PO Box 800
Ilwaco, WA 98624-0800

Telephone: (360) 642-3773
Fax: (360) 642-3362
Email: pierrem@ilwacofish.com

OSBORN, MR. ROBERT
Private Recreational

Fishery Consultant
United Anglers of Southern California
17391 Murphy Avenue
Irvine, CA 92614-5919

Telephone: (562) 592-6041
Fax: (949) 863-9447
Email: bob@unitedanglers.com

SUTTON, MR. BILL
Commercial At-Large

F/V Aurelia
876 S Rice Rd
Ojai, CA 93023

Telephone: (805) 646-9685
Fax: (805) 646-1321
Email: seafreshto@aol.com

TOM, MS. PAMELA
Public At-Large

University of California
One Shields Avenue
Davis, CA 95616

Telephone: (530) 752-3837
Fax: (530) 752-4759
Email: pdtom@ucdavis.edu

HIGHLY MIGRATORY SPECIES MANAGEMENT TEAM

Vacancy: One IATTC Seat.

ENRIQUEZ, MR. LYLE
NMFS Southwest Region

National Marine Fisheries Service
501 W Ocean Blvd.
Long Beach, CA 90802-4213

Telephone: (562) 980-4025
Fax: (562) 980-4047
Email: lyle.enriquez@noaa.gov

HEBERER, MR. CRAIG
Chair
NMFS Southwest Region

National Marine Fisheries Service
6010 Hidden Valley Road
Carlsbad, CA 92011

Telephone: (760) 431-9440 303
Fax: (760) 431-9618
Email: craig.heberer@noaa.gov

KOHIN, DR. SUZANNE
NMFS Southwest Fisheries Science
Center

Research Fishery Biologist
National Marine Fisheries Service
8604 La Jolla Shores Dr
La Jolla, CA 92038-1508

Telephone: (858) 546-7104
Fax: (858) 546-7003
Email: suzanne.kohin@noaa.gov

LAUGHLIN, MS. LEEANNE
Vice-Chair
CDFG

Marine Biologist
California Department of Fish and
Game
4665 Lampson Ave, Ste C
Los Alamitos, CA 90720

Telephone: (562) 342-7167
Fax: (562) 342-7139
Email: llaughlin@dfg.ca.gov

NILES, MR. COREY
WDFW

Marine Resources Policy Coordinator
Washington Department of Fish and
Wildlife
48 Devonshire Road
Montesano, WA 98563-9618

Telephone: (360) 249-4628
Fax: (360) 664-0689
Email: nilesn@dfw.wa.gov

SCHMITT, MS. CYREIS
ODFW

Marine Policy Project Leader
Oregon Department of Fish and
Wildlife
2040 SE Marine Science Dr
Newport, OR 97365-5294

Telephone: (541) 867-0300 265
Fax: (541) 867-0311
Email: cyreis.c.schmitt@state.or.us

STOHS, DR. STEPHEN
NMFS Southwest Fisheries Science
Center

National Marine Fisheries Service
PO BOX 271
La Jolla, CA 92037-1508

Telephone: (858) 546-7084
Fax: (858) 546-7003
Email: Stephen.Stohs@noaa.gov

MODEL EVALUATION WORKGROUP

CLEMONS, MR. ETHAN ODFW	Project Analyst Oregon Department of Fish and Wildlife 2040 SE Marine Science Drive Newport, OR 97365	Telephone: (541) 867-0300 242 Fax: Email: Ethan.R.Clemons@state.or.us
CONRAD, MR. ROBERT H. Scientific and Statistical Committee	Quantitative Services Manager Northwest Indian Fisheries Commission 6730 Martin Way E Olympia, WA 98516-5540	Telephone: (360) 528-4345 Fax: (360) 753-8659 Email: bconrad@nwifc.org
GROVER, MR. ALLEN CDFG	Marine Biologist California Department of Fish and Game 475 Aviation Blvd, Ste 130 Santa Rosa, CA 95403	Telephone: (707) 576-2860 Fax: (707) 576-7132 Email: agrover@dfg.ca.gov
LAVOY, MR. LARRIE Vice-chair WDFW	Washington Department of Fish and Wildlife 600 Capitol Way N Olympia, WA 98501-1091	Telephone: (360) 902-2841 Fax: (360) 902-2949 Email: lavoylwl@dfw.wa.gov
Designee: Mr. Jim Packer	packejfp@dfw.wa.gov	Telephone: (360) 902-2754
RANKIS, MR. ANDY Chair Northwest Indian Fisheries Commission	Quantitative Fisheries Biologist Northwest Indian Fisheries Commission 6730 Martin Way E Olympia, WA 98516	Telephone: (360) 438-1181 322 Fax: (360) 753-8659 Email: arankis@nwifc.org
SHARMA, MR. RISHI Columbia River Inter-Tribal Fish Commission	Biometrician Columbia River Inter-Tribal Fish Commission 729 NE Oregon St, Ste 200 Portland, OR 97232	Telephone: (503) 238-0667 Fax: (503) 235-4228 Email: shar@critfc.org
SIMMONS, MR. DELL NMFS	National Marine Fisheries Service 510 Desmond Dr SE, Ste 103 Lacey, WA 98503	Telephone: (360) 753-9580 Fax: (360) 753-9517 Email: dell.simmons@noaa.gov
YUEN, MR. HENRY USFWS	Fishery Biologist U.S. Fish and Wildlife Service 1211 SE Cardinal Ct, Ste 100 Vancouver, WA 98683	Telephone: (360) 604-2500 Fax: (360) 604-2505 Email: henry_yuen@fws.gov

SALMON ADVISORY SUBPANEL

FRANK, MR. CALVIN S. Washington Coastal Tribal Fisherman	F/V Cross Winds PO Box 373 Bay Center, WA 98527	Telephone: (360) 942-7809 Fax: Email:
HEAP, MR. RICHARD Oregon Sport Fisheries	95975 N. Brookside Drive Brookings, OR 97415	Telephone: (541) 469-7111 Fax: Email: fiskare@charter.net
HEIKKILA, MR. PAUL Oregon Troller	Oregon State University 786 S. 1st Ave. Coquille, OR 97423	Telephone: (541) 396-3096 Fax: Email: pheikkila@mycomspan.com
HIE, MR. JIM Conservation	Pacific Marine Conservation Council 1423 Vista Ave Napa, CA 94559	Telephone: (707) 265-0304 Fax: (707) 695-8661 Email: jnahie@att.net
HILLEMEIER, MR. DAVE California Tribes	Fisheries Program Manager Yurok Tribe PO Box 1027 Klamath, CA 95548	Telephone: (707) 482-1350 315 Fax: (707) 482-1377 Email: dhillemeier@yuroktribe.nsn.us
MACLEAN, MR. DUNCAN Vice-Chair California Troll	Owner F/V Barbara Faye PO Box 1942 El Granada, CA 94018-1942	Telephone: (650) 726-1373 Fax: (650) 712-8744 Email: b-faye@pacbell.net
MARTIN, MR. KENT Commercial Gillnet	PO Box 83 Skamokawa, WA 98647	Telephone: (360) 795-3920 Fax: Email: imartin@iinet.com
OLSON, MR. JIM Washington Troll	F/V Cynthia T PO Box 586 Auburn, WA 98071-0586	Telephone: (253) 833-8739 Fax: (425) 644-6107 Email: Jaocto@juno.com
PIERCE, MR. PAUL California Sport Fisheries	512 Pershing Drive San Landro, CA 94577	Telephone: (510) 432-8820 Fax: (510) 568-2713 Email: SDAD111@aol.com
REINHOLDT, MR. GERALD K. Processor	Reinholdt Fisheries 62313 S Canaan Rd St. Helens, OR 97051-9117	Telephone: (503) 397-3369 Fax: (503) 397-3369 Email:

SMITH, MR. BUTCH
Chair
Washington Charter Boat Operator

Co-Ho Charters
PO Box 268
Ilwaco, WA 98624

Telephone: (360) 642-3333
Fax: (360) 642-3758
Email: coho@willapabay.org

SORENSEN, MR. MIKE
Oregon Charter Boat Operator

603 Camp 12 Lp
Toledo, OR 97391

Telephone: (541) 444-2552
Fax:
Email: cvmissraven@hotmail.com

STONE, MR. CRAIG
California Sport Fisheries

Emeryville Sportfishing
3310 Powell St
Emeryville, CA 94608

Telephone: (510) 654-6040
Fax: (510) 654-2106
Email: emvlsport@aol.com

WATROUS, MR. STEVE
Washington Sport Fisheries

Garonaire, Inc.
2515 Kauffman Ave
Vancouver, WA 98660

Telephone: (360) 696-1604
Fax: (360) 695-6031
Email: branchofic@aol.com

WELSH, DR. TOM
Idaho Sport Fisheries

Thomas L. Welsh
BIOCONSULTANTS
1001 E. Irene Street
Pearce, AZ 85625

Telephone: (208) 860-9441
Fax:
Email: tom.welsh@hotmail.com

SALMON TECHNICAL TEAM

FOSTER, MR. CRAIG
ODFW

Fish Management Biologist
Oregon Department of Fish and
Wildlife
17330 SE Evelyn St
Clackamas, OR 97015

Telephone: (971) 673-6026
Fax: (971) 673-6071
Email: craig.a.foster@state.or.us

GROVER, MR. ALLEN
Vice-chair
CDFG

Marine Biologist
California Department of Fish and
Game
475 Aviation Blvd, Ste 130
Santa Rosa, CA 95403

Telephone: (707) 576-2860
Fax: (707) 576-7132
Email: agrover@dfg.ca.gov

Designee: Ms. Melodie Palmer-Zwahlen

mpalmer@dfg.ca.gov

Telephone: (707) 576-2870

KOPE, DR. ROBERT
NMFS

Research Fishery Biologist
National Marine Fisheries Service
2725 Montlake Blvd E
Seattle, WA 98112-2097

Telephone: (206) 860-3374
Fax:
Email: robert.kope@noaa.gov

LUTZ, MR. KEITH
Tribal

Northwest Indian Fisheries
Commission
Fisheries Management Division
Manager
6730 Martin Way E
Olympia, WA 98516

Telephone: (360) 528-4326
Fax: (360) 753-8659
Email: lutz@nwifc.org

MILWARD, MR. DOUG
WDFW

Washington Department of Fish and
Wildlife
600 Capitol Way N
Olympia, WA 98501-1091

Telephone: (360) 902-2739
Fax: (360) 902-2949
Email: milwadam@dfw.wa.gov

MOHR, MR. MICHAEL S.
NMFS

National Marine Fisheries Service
110 Shaffer Rd
Santa Cruz, CA 95060

Telephone: (831) 420-3922
Fax: (831) 420-3977
Email: michael.mohr@noaa.gov

SIMMONS, MR. DELL
Chair
NMFS

National Marine Fisheries Service
510 Desmond Dr SE, Ste 103
Lacey, WA 98503

Telephone: (360) 753-9580
Fax: (360) 753-9517
Email: dell.simmons@noaa.gov

YUEN, MR. HENRY
USFWS

Fishery Biologist
U.S. Fish and Wildlife Service
1211 SE Cardinal Ct, Ste 100
Vancouver, WA 98683

Telephone: (360) 604-2500
Fax: (360) 604-2505
Email: henry_yuen@fws.gov

SCIENTIFIC AND STATISTICAL COMMITTEE

Vacancy: WDFW Position.

BARNES, MR. J. THOMAS
CDFG

Senior Biologist
California Department of Fish and
Game
8604 La Jolla Shores Dr
La Jolla, CA 92037-0271

Telephone: (858) 546-7167
Fax: (858) 546-7003
Email: tombarnes@ucsd.edu

CONRAD, MR. ROBERT H.
Chair
Tribal Agency

Quantitative Services Manager
Northwest Indian Fisheries
Commission
6730 Martin Way E
Olympia, WA 98516-5540

Telephone: (360) 528-4345
Fax: (360) 753-8659
Email: bconrad@nwifc.org

CONSER, DR. RAMON J.
NMFS Southwest Fisheries Science
Center

Fisheries Research Biologist
NOAA/NMFS
8604 La Jolla Shores Dr
La Jolla, CA 92037-0271

Telephone: (858) 546-5688
Fax: (858) 546-5656
Email: ray.conser@noaa.gov

DORN, DR. MARTIN
NMFS Alaska Fisheries Science
Center

National Marine Fisheries Service
7600 Sand Point Way NE, BIN
C15700
Seattle, WA 98115-0070

Telephone: (206) 526-6548
Fax: (206) 525-6723
Email: martin.dorn@noaa.gov

HAMEL, DR. OWEN
NMFS Northwest Fisheries Science
Center

Research Fisheries Biologist
National Marine Fisheries Service
2725 Montlake Blvd E
Seattle, WA 98112

Telephone: (206) 860-3481
Fax:
Email: owen.hamel@noaa.gov

HELSEY, DR. THOMAS
At-Large

Research Fishery Biologist
Northwest Fisheries Science Center
2725 Montlake Blvd. East
Seattle, WA 98112-2097

Telephone: (206) 302-2435
Fax: (206) 860-3217
Email: thomas.helsey@noaa.gov

HEPPELL, DR. SELINA
At-Large

Associate Professor
Oregon State University
104 Nash Hall
Corvallis, OR 97331

Telephone: (541) 737-9039
Fax: (541) 737-3590
Email:
Selina.Heppell@oregonstate.edu

LAWSON, DR. PETER
NMFS Northwest Fisheries Science
Center

National Marine Fisheries Service
2030 S Marine Science Dr
Newport, OR 97365-5296

Telephone: (541) 867-0430
Fax: (541) 867-0380
Email: Peter.W.Lawson@noaa.gov

LEE, DR. TODD At-Large	NOAA/NWFSC/Fram Division 2725 Montlake Blvd. East Seattle, WA 98112-2097	Telephone: (206) 302-2436 Fax: (206) 860-6792 Email: todd.lee@noaa.gov
PETROSKY, DR. CHARLIE Idaho Sport Fisher	Fishery Program Coordinator Idaho Department of Fish and Game PO Box 25 Boise, ID 83707	Telephone: (208) 334-3791 Fax: (208) 334-2114 Email: cpetrosky@idfg.idaho.gov
PUNT, DR. ANDRE At-Large	Research Associate Professor University of Washington Box 355020 Seattle, WA 98195-5020	Telephone: (206) 221-6319 Fax: (206) 685-7471 Email: aepunt@u.washington.edu
RALSTON, DR. STEPHEN Vice-Chair At-Large	Fishery Biologist (Research) National Marine Fisheries Service 110 Shaffer Rd Santa Cruz, CA 95060	Telephone: (831) 420-3949 Fax: (831) 420-3977 Email: steve.ralston@noaa.gov
SAMPSON, DR. DAVID ODFW	Professor of Fisheries Oregon State University 2030 SE Marine Science Dr Newport, OR 97365-5296	Telephone: (541) 867-0386 Fax: (541) 867-0345 Email: david.sampson@oregonstate.edu
THOMSON, MS. CINDY NMFS Southwest Fisheries Science Center	National Marine Fisheries Service 110 Shaffer Rd Santa Cruz, CA 95060	Telephone: (831) 420-3911 Fax: (831) 420-3977 Email: Cindy.Thomson@noaa.gov
WANG, DR. SHIZHEN At-Large	Biometrician Quinault Indian Nation 3010 77th ave SE, Suite 104 Mercer Island, WA 98040	Telephone: (206) 236-1407 Fax: (206) 236-6842 Email: szwang@qwest.net
WESPESTAD, DR. VIDAR At-Large	Pacific Whiting Conservation Cooperative 21231 8th Pl W Lynnwood, WA 98036	Telephone: (425) 672-7603 Fax: (425) 672-1357 Email: vidarw@verizon.net

AD HOC COMMITTEES

Coastal Pelagic Species Tribal Allocation Committee: Mr. Phil Anderson, Dr. Patricia Burke, Mr. Donald K. Hansen, Mr. Mark Helvey, Mr. Frank Lockhart, Mr. David Sones, Ms. Marija Vojkovich.

Full Retention Committee: Ms. Eileen Cooney, Dr. James Hastie, Mr. Rod Moore.

Groundfish EFH EIS Oversight Committee: Mr. Phil Anderson, Dr. Patricia Burke, Mr. Tom Ghio, Mr. Peter Huhtala, Mr. Curt Melcher, Ms. Marija Vojkovich.

Groundfish Habitat Technical Review Committee: Dr. Rod Fujita, Dr. Chris Goldfinger, Dr. Gary Greene, Mr. Marion J. Larkin, Mr. Scott McMullen, Dr. Mark Powell, Dr. Waldo Wakefield, Ms. Mary Yoklavich.

Groundfish Multi-year Management Committee: Mr. Phil Anderson, Ms. Eileen Cooney, Dr. James Hastie, Mr. Frank Lockhart, Mr. Curt Melcher.

Groundfish Strategic Plan Implementation Oversight Committee: Mr. Phil Anderson, Mr. Bruce Buckmaster, Mr. Donald K. Hansen, Dr. David Hanson, Mr. Curt Melcher, Ms. Marija Vojkovich.

Groundfish Strategic Plan Implementation Oversight Open Access Conversion Subcommittee: Mr. Phil Anderson, Ms. Eileen Cooney, Ms. Kathy Fosmark, Dr. Steve Freese, Mr. Douglas Fricke, Dr. James Hastie, Mr. Kenyon Hensel, Mr. Steve Joner, Mr. Frank Lockhart, Mr. Mike McCorkle, Mr. Rod Moore, Mr. Brian Petersen, Ms. Marija Vojkovich.

Groundfish Trawl Individual Quota Committee: Mr. Steve Bodnar, Mr. Jay Bornstein, Mr. Ralph Brown, Mr. Bruce Buckmaster, Dr. David Hanson, Mr. Alan Hightower, Mr. Jan Jacobs, Mr. David Jincks, Mr. Steve Joner, Mr. Marion J. Larkin, Mr. Peter Leipzig, Ms. Dorothy Lowman, Mr. Dayna Matthews, Mr. Brent Paine, Ms. Donna Parker, Mr. Brad Pettinger, Mr. Joe Plesha, Mr. Craig Urness.

Highly Migratory Species Management Committee: Mr. Phil Anderson, Mr. Donald K. Hansen, Mr. Mark Helvey, Ms. Marija Vojkovich.

Marine Protected Area Committee: Mr. Phil Anderson, Ms. Eileen Cooney, Mr. Robert Fletcher, Ms. Kathy Fosmark, Mr. Donald K. Hansen, Mr. Duncan MacLean, Dr. Donald O. McIsaac, Mr. Curt Melcher, Ms. Diane Pleschner-Steele, Ms. Cindy Thomson.

Observer Implementation Committee: Mr. J. Thomas Barnes, Mr. William Barss, Dr. David Hanson, Ms. Becky Renko, Ms. Teresa Turk.

Salmon Amendment Committee: Mr. Ray Beamesderfer, Mr. LB Boydston, Mr. Mike Burner, Mr. Eric Chavez, Dr. Christopher Dahl, Dr. Peter Dygert, Mr. Craig Foster, Mr. Allen Grover, Mr. Dave Hillemeier, Mr. George Kautsky, Dr. Robert Kope, Mr. Larrie LaVoy, Dr. Peter Lawson, Mr. Michael Letourneau, Mr. Duncan MacLean, Mr. Michael S. Mohr, Dr. Gary Morishima, Ms. Corinne Pinkerton, Mr. James L. Seger, Ms. Cindy Thomson, Mr. Chuck Tracy, Mr. Dan Wolford, Mr. Chris Wright.

Shore-based Whiting Amendment Workgroup: Mr. Richard Carroll, CAPT Mike Cenci, Mr. Frank Lockhart, Ms. Heather Mann, Mr. Dayna Matthews, Mr. Rod Moore, Ms. Becky Renko.

Trawl Individual Quota Enforcement Group: CAPT Mike Cenci, Mr. Brian Corrigan, Mr. Frank Lockhart, Mr. Dayna Matthews, Mr. Tony Warrington.

Trawl Individual Quota Independent Experts Panel: Mr. Chris Dewees, Dr. Susan Hanna, Dr. Dan Huppert, Dr. Gilbert Sylvia.

Trawl Rationalization Tracking and Monitoring Committee: Mr. Joseph Alber, Mr. Dave Colpo, Mr. Jonathan Cusick, Ms. Joann Eres, Dr. Steve Freese, Gerry Kobylinski, Dr. Todd Lee, Mr. Dayna Matthews, Mr. Corey Niles, Ms. Becky Renko, Mr. John Seabourne, Mr. Tony Warrington.

Vessel Monitoring System Committee: Mr. Joseph Albert, Mr. Mark Cedergreen, CAPT Mike Cenci, Mr. Brian Corrigan, Mr. John Crowley, Ms. Kathy Fosmark, Mr. Tom Ghio, Mr. Donald K. Hansen, Mr. Kenyon Hensel, Mr. Marion J. Larkin, Mr. Dayna Matthews, Ms. Becky Renko, LTJG Brittany Steward.

STANDING COMMITTEES

BUDGET COMMITTEE

CHAIRMAN: MR. JERRY MALLET
MR. PHIL ANDERSON
MR. DONALD K. HANSEN
DR. DAVID HANSON
MR. FRANK LOCKHART/MR. MARK HELVEY
MR. FRANK WARRENS

LEGISLATIVE COMMITTEE

CHAIRMAN: DR. DAVID HANSON
MS. KATHY FOSMARK
MR. DONALD K. HANSEN
MR. ROD MOORE
MR. DALE MYER
MR. ROGER THOMAS

REPRESENTATIVES TO OTHER FORUMS

WESTERN AND CENTRAL PACIFIC FISHERIES COMMISSION
MS. MARIJA VOJKOVICH

INTERNATIONAL PACIFIC HALIBUT COMMISSION
MR. PHIL ANDERSON

TO BE RETAINED BY OPERATORS OF HOTELS
MOTELS, AND SIMILAR ACCOMMODATIONS AS
EVIDENCE OF EXEMPT OCCUPANCY

EXEMPTION CERTIFICATE
TAX ON OCCUPANCY
OF HOTEL ROOMS

Imposed Pursuant to
Articles 28 and 29 of the Tax Law

NAME OF HOTEL, APARTMENT HOTEL, OR LODGING HOUSE

DoubleTree Hotel Sacramento

DATES

March 8-15, 2008

ADDRESS

2001 Point West Way

Sacramento, California 95815

916-929-8855 Telephone - 916-924-0719 Fax

Members of the Pacific Fishery Management Council (Council)

Council Staff

Council Advisory Bodies:

Habitat Committee

Enforcement Consultants

Groundfish Management Team

Salmon Management Team

Groundfish Advisory Subpanel

Salmon Advisory Subpanel

Scientific and Statistical Team

This is to certify that the above individuals are representatives of the United States Governmental department, agency or instrumentality indicated below; that the charges for the occupancy at the above establishment on the dates set forth below have been or will be paid for by such governmental unit; and that such charges are incurred in the performance of official duties as representatives or employees of such governmental unit.

DATES OF
OCCUPANCY

Group Name: Pacific Fishery
Management Council

Dates: March 8-15, 2008

SIGNATURE

GOVERNMENTAL
UNIT

DOC/NOAA/NMFS/
Pacific Fishery Management Council

TITLE



The Pacific Fishery Management Council is a federal instrumentality operating under authority of the United States Department of Commerce, National Oceanic and Atmospheric Administration.



TO BE RETAINED BY OPERATORS OF HOTELS,
MOTELS, AND SIMILAR ACCOMMODATIONS AS
EVIDENCE OF EXEMPT OCCUPANCY

EXEMPTION CERTIFICATE
TAX ON OCCUPANCY
OF HOTEL ROOMS

Imposed Pursuant to
Articles 28 and 29 of the Tax Law

NAME OF HOTEL, APARTMENT HOTEL, OR LODGING HOUSE

Hilton Sacramento

DATES

March 7-9, 2008

ADDRESS

**2200 Harvard Street
Sacramento, California 95815**

This is to certify that the above individuals are representatives of the United States Governmental department, agency or instrumentality indicated below; that the charges for the occupancy at the above establishment on the dates set forth below have been or will be paid for by such governmental unit; and that such charges are incurred in the performance of official duties as representatives or employees of such governmental unit.

DATES OF
OCCUPANCY

Group Name: Pacific Fishery
Management Council

Dates: March 7-9, 2008

SIGNATURE

GOVERNMENTAL
UNIT

DOC/NOAA/NMFS/
Pacific Fishery Management Council

TITLE



The Pacific Fishery Management Council is a federal instrumentality operating under authority of the United States Department of Commerce, National Oceanic and Atmospheric Administration.

