

PACIFIC FISHERY MANAGEMENT COUNCIL

CHAIR'S RECEPTION



Monday, September 11, 2006

6:00 p.m.

Marco Polo Room

Crowne Plaza Hotel

Foster City, California

Pacific Fishery Management Council
Council Meeting Schedule
www.pcouncil.org/events/future.html

WEEK OF	LOCATION
March 5-10, 2006	Seattle Marriott Hotel-Sea Tac, 3201 S 176 th Street, Seattle, WA 98188-4094 206-241-2000 or 800-314-0925
April 2-7, 2006	Double Tree Hotel, 2001 Point West Way, Sacramento, CA 95815-4702 916-929-8855 or 800-222-8733
June 11-16, 2006	Crowne Plaza Mid Peninsula, 1221 Chess Drive, Foster City, CA 94404 800-227-6963 or 650-570-5700
September 10-15, 2006	Crowne Plaza Hotel, 1221 Chess Drive, Foster City, CA 94404 650-5700 or 800-477-5700
November 12-17, 2006	Hilton San Diego/Del Mar, 15575 Jimmy Durante Blvd, Del Mar, CA 92014 858-792-5200
◆ ◆	◆ ◆ ◆
March 4-9, 2007	Double Tree Hotel, 2001 Point West Way, Sacramento, CA 95815-4702 916-929-8855 or 800-222-8733
April 1-6, 2007	Oregon or Washington
June 10-15, 2007	Crowne Plaza Hotel, 1221 Chess Drive, Foster City, CA 94404 650-5700 or 800-477-5700
September 9-14, 2007	Washington, Oregon or California
November 4-9, 2007	Hyatt Regency Islandia Hotel, 1441 Quivira Road, San Diego, CA 92109 619-224-1234
◆ ◆	◆ ◆ ◆
March 9-14, 2008	Oregon or Washington
April 6-11, 2008	California
June 8-13, 2008	Washington, Oregon or California
September 14-19, 2008	Washington, Oregon or California
November 2-7, 2008	Oregon or California
◆ ◆	◆ ◆ ◆

Council Meeting Schedule (*continued*)

WEEK OF	LOCATION
March 8-13, 2009	California
April 5-10, 2009	Oregon or Washington
June 14-19, 2009	Washington, Oregon or California
September 13-18, 2009	Washington, Oregon or California
November 1-6, 2009	Oregon or California
◆ ◆	◆ ◆ ◆
March 7-12, 2010	Oregon or Washington
April 5-10, 2010 ¹	California
June 13-18, 2010	Washington, Oregon, or California
September 12-17, 2010	Washington, Oregon, or California
October 31- November 5, 2010	Oregon or California
◆ ◆	◆ ◆ ◆

08/10/2006

¹ Easter is April 4, 2010

DIRECTIONS

CROWNE PLAZA HOTEL, MID PENINSULA
1221 Chess Drive
Foster City, CA 94404
650.570.5700

SAN FRANCISCO

101 South to Hwy 92 East (Towards San Mateo Bridge / Hayward)
Exit Foster City Blvd., Left on Metro Center Blvd.
Left on Foster City Blvd., Left on Chess Drive.
Hotel is on the left.

SAN JOSE

101 North to Hwy 92 East (Towards San Mateo Bridge / Hayward)
Exit Foster City Blvd.
Left on Metro Center Blvd., Left on Foster City Blvd., Left on Chess Drive.
Hotel is on the left.

EAST BAY/OAKLAND/HAYWARD

880 South
Exit Jackson Street / San Mateo Bridge (\$2 toll)
After Crossing Bridge, Exit Foster City Blvd., Left at Chess Drive (Stop Light)
Hotel in on the left.

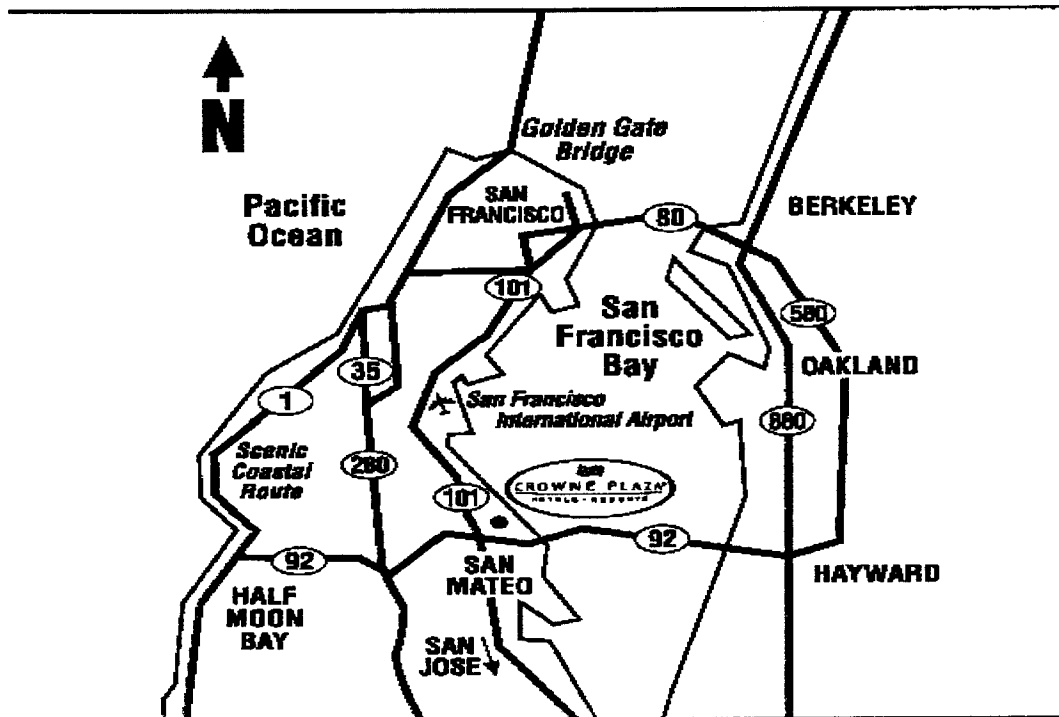

FOSTER CITY
650.570.5700

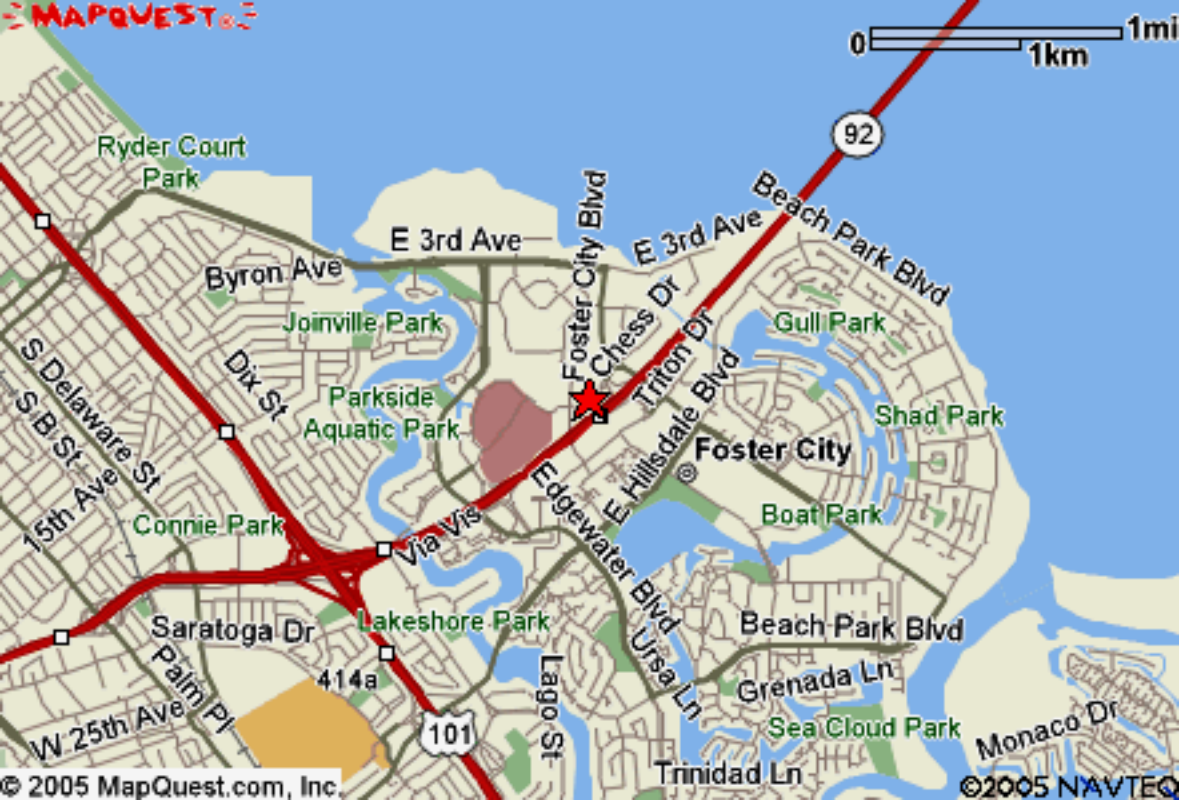



SAN FRANCISCO MID PENINSULA

Banquet Room Diagram

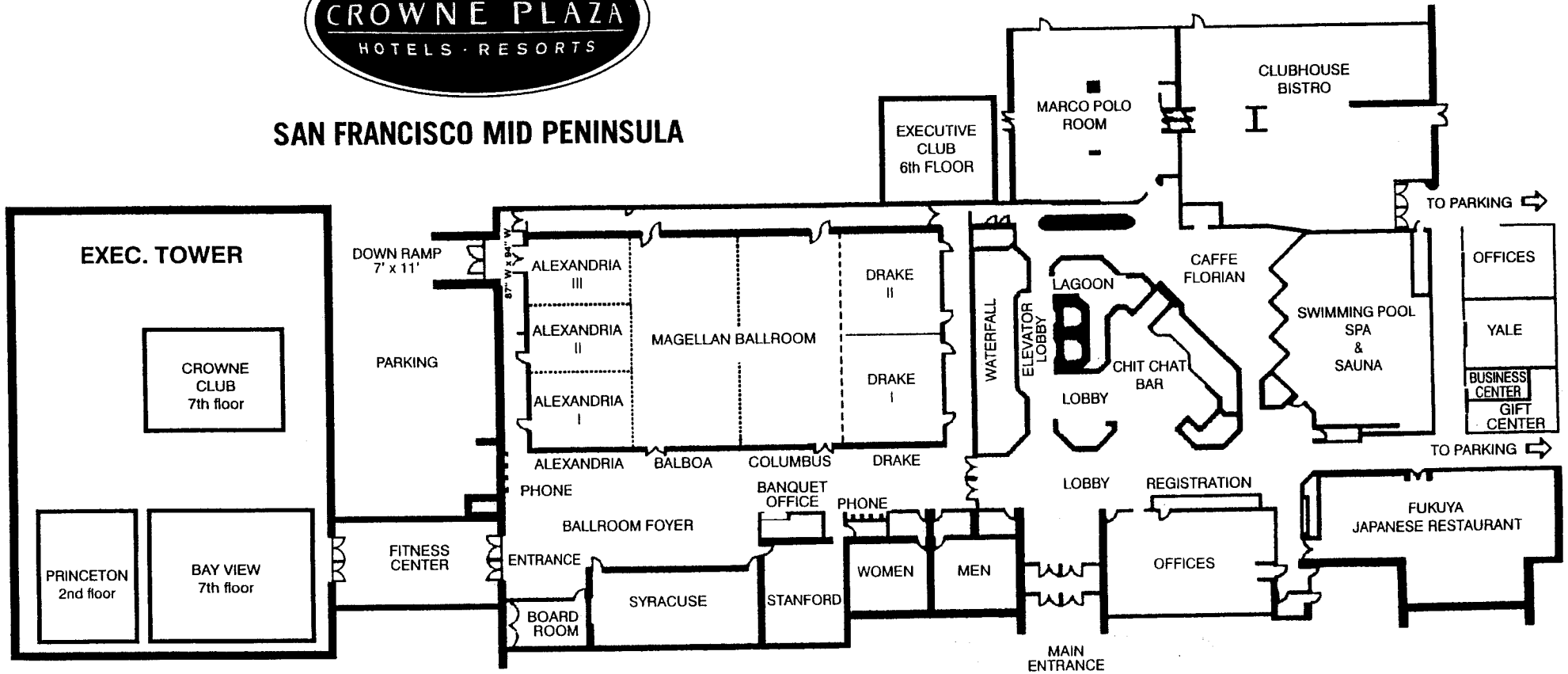

NAME OF ROOM	DIMENSIONS L X W X H	SQ.FT.	BANQUET ROUNDS (PP)	COCKTAIL RECEPTION	CONFERENCE/MEETINGS		
					U-SHAPE	CLASSROOM	THEATRE
Foyer	135 x 31 x 30	4,185					
Foyer A & B	71 x 31 x 30	2,201					
Foyer C & D	64 x 18 x 25	1,152					
Magellan Ballroom	120 x 60 x 12	7,440	680	1,500	150	400	1,000
Alexandria	30 x 60 x 12	1,800	150	200	50	90	200
Balboa	30 x 60 x 12	1,800	150	200	50	90	200
Columbus	30 x 60 x 12	1,800	150	200	50	90	200
Drake	30 x 60 x 12	1,800	150	200	50	90	200
Yale	23 x 18 x 10	415	40	40	20	24	40
Alexandria I	30 x 20 x 12	600	50	60	24	24	60
Alexandria II	30 x 20 x 12	600	50	60	24	24	60

All numbers reflect maximum number of people per room.

NAME OF ROOM	DIMENSIONS L X W X H	SQ.FT.	BANQUET ROUNDS (PP)	COCKTAIL RECEPTION	CONFERENCE/MEETINGS		
					U-SHAPE	CLASSROOM	THEATRE
Alexandria III	30 x 20 x 12	600	50	60	24	24	60
Drake I	31 x 30 x 12	930	70	100	30	40	80
Drake II	31 x 30 x 12	930	70	100	30	40	80
Syracuse	48 X 22 X 10	1,056	90	150	48	60	150
Stanford	31 X 25 X 10	795	50	60	25	32	60
Marco Polo Room	48 x 39 x 10	1,872	120	150	35	80	100
Chit Chat Lounge	31 x 25 x —	775	50	70	**	**	**
Boardroom	24 x 14 x 10	336	12 / Existing Set-up	***	***	**	**
Presidential Suite	24 x 25 x 10	575	6 / Existing Set-up	***	***	**	**
Clubhouse Bistro	98 x 51 x 16	5,000	125 / Existing Set-up	200	**	**	**
Crowne Club	25 x 27 x 12	675	**	50	**	**	**
Bay View	50 x 27 x 12	1,350	80	150	40	60	130
Princeton	27 x 24 x 8	660	60	70	22	22	70
Executive Club	24 x 18 x 8	432	40	40	15	15	25

All numbers reflect maximum number of people per room.

Tel: (650) 570-5700

1221 Chess Drive, Foster City, CA 94404

www.crowneplaza.com/sfo-peninsula

Fax: (650) 570-0540

Restaurant List

CROWNE PLAZA HOTEL
1221 CHESS DRIVE
FOSTER CITY, CA 94404-1173
650-570-5700

Sort by Distance 

- 1) Fukuya Japanese Restaurant**
1221 Chess Dr, Foster City, CA (0.00 miles away)
650-349-7890
[Map](#) | [Directions To](#) | [Directions From](#)
- 2) El Torito Mexican Restaurant**
388 Vintage Park Dr, Foster City, CA (0.08 miles away)
650-574-6844
[Map](#) | [Directions To](#) | [Directions From](#)
- 3) Wybridge Restaurant Group**
373 Vintage Park Dr, Foster City, CA (0.13 miles away)
650-341-8103
[Map](#) | [Directions To](#) | [Directions From](#)
- 4) Black Angus Restaurant**
1299 Chess Dr, Foster City, CA (0.15 miles away)
650-345-9971
[Map](#) | [Directions To](#) | [Directions From](#)
- 5) Carvery**
1297 Chess Dr, Foster City, CA (0.15 miles away)
650-349-8411
[Map](#) | [Directions To](#) | [Directions From](#)
- 6) Harry's Hofbrau**
1297 Chess Dr, Foster City, CA (0.15 miles away)
650-349-8411
[Map](#) | [Directions To](#) | [Directions From](#)
- 7) Boston Market**
1000 Metro Center Blvd # A, Foster City, CA (0.18 miles away)
650-572-1700
[Map](#) | [Directions To](#) | [Directions From](#)
- 8) Jamba Juice**
1000 Metro Center Blvd # B, Foster City, CA (0.18 miles away)
650-571-6200
[Map](#) | [Directions To](#) | [Directions From](#)
- 9) Rawlings All American Grille**
2200 Bridgepointe Pkwy, San Mateo, CA (0.26 miles away)
650-570-5555
[Map](#) | [Directions To](#) | [Directions From](#)
- 10) Scores Legendary Sports Rstrnt**
2200 Bridgepointe Pkwy, San Mateo, CA (0.26 miles away)
650-357-1998
[Map](#) | [Directions To](#) | [Directions From](#)
- 11) Cucina Cucina Italian Cafe**
2206 Bridgepointe Pkwy, San Mateo, CA (0.27 miles)
650-372-9144
[Map](#) | [Directions To](#) | [Directions From](#)
- 12) Savini**
950 Tower Ln # 100, Foster City, CA (0.28 miles away)
650-572-0330
[Map](#) | [Directions To](#) | [Directions From](#)
- 13) Mc Donald's**
1101 Triton Dr, Foster City, CA (0.30 miles away)
650-341-4832
[Map](#) | [Directions To](#) | [Directions From](#)
- 14) Carrows Restaurant**
531 Foster City Blvd, Foster City, CA (0.35 miles away)
650-345-4009
[Map](#) | [Directions To](#) | [Directions From](#)
- 15) Taco Bell**
1131 Triton Dr, Foster City, CA (0.35 miles away)
650-572-8038
[Map](#) | [Directions To](#) | [Directions From](#)
- 16) Armadillo Willy's**
2260 Bridgepointe Parkway, San Mateo, CA (0.37 miles)
650-571-7427
[Map](#) | [Directions To](#) | [Directions From](#)
- 17) Carls Jr**
1140 Triton Dr, San Mateo, CA (0.37 miles away)
650-349-1221
[Map](#) | [Directions To](#) | [Directions From](#)
- 18) Carl's Jr**
1140 Triton Dr, Foster City, CA (0.37 miles away)
650-349-1221
[Map](#) | [Directions To](#) | [Directions From](#)
- 19) Pizza Hut**
1141 Triton Dr, Foster City, CA (0.37 miles away)
650-345-3511
[Map](#) | [Directions To](#) | [Directions From](#)
- 20) Baja Fresh Mexican Grill**
1031 E Hillsdale Blvd, Foster City, CA (0.40 miles away)
650-358-8632
[Map](#) | [Directions To](#) | [Directions From](#)

Pacific Fishery Management Council COUNCIL MEETING ROOM DIAGRAM Crowne Plaza Hotel – Foster City, CA

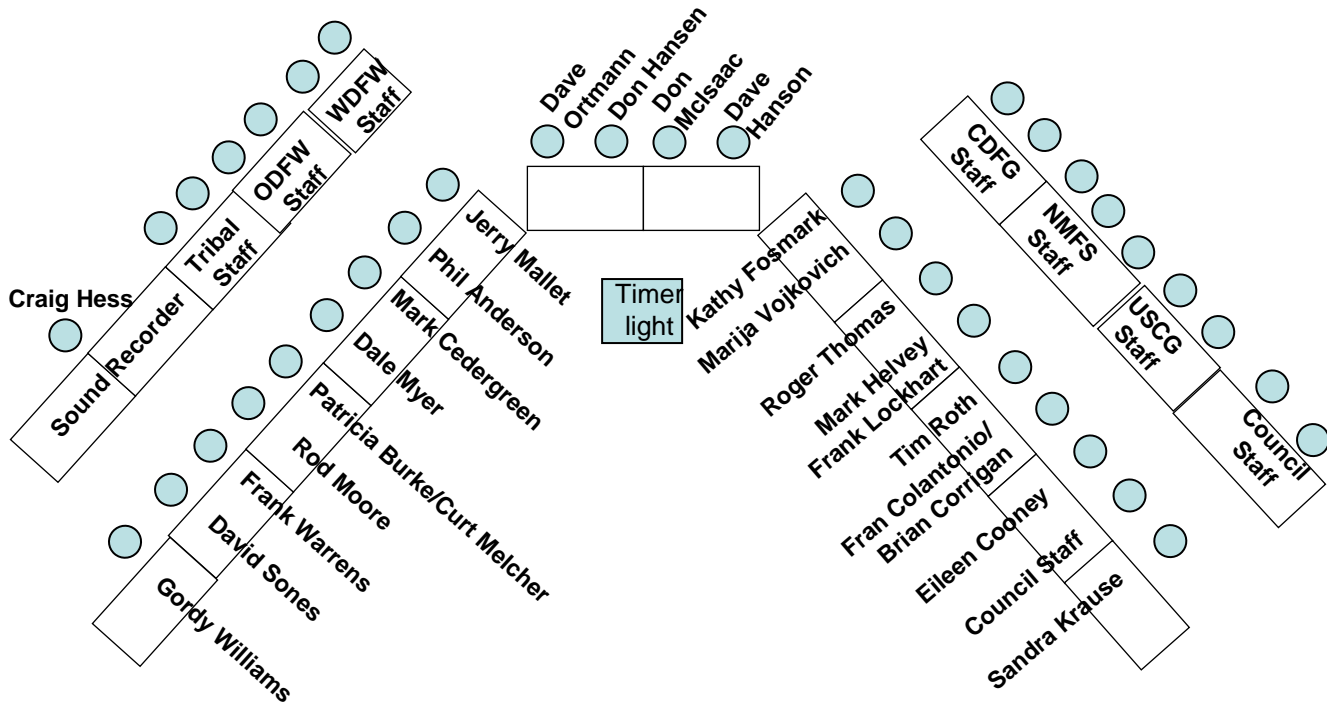

Screen

Audio/
Visual

Public
testimony

Audio/
Visual

Screen

Sign-in table

Coffee / water

DOORS

Public Documents – Reports/ Outside Doors

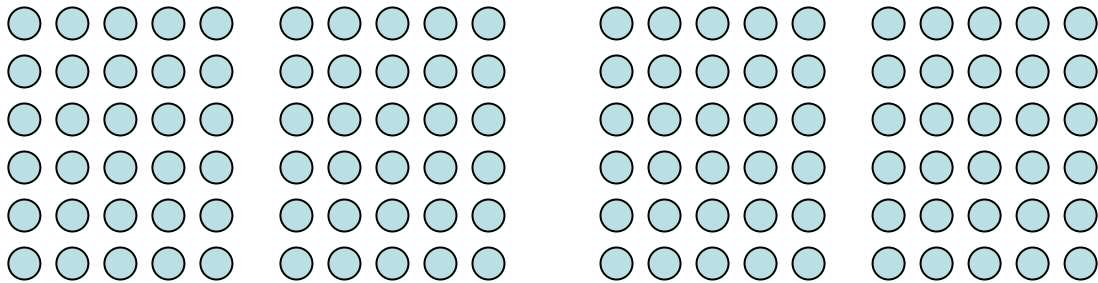

Pacific Fishery Management Council

Roster



Pacific Fishery Management Council
7700 NE Ambassador Place, Suite 101
Portland, Oregon 97220-1384
Phone: 503-820-2280
Toll Free: 866-806-7204
Fax: 503-820-2299
www.pcouncil.org

September 2006

COUNCIL STAFF

Donald O. McIsaac
Executive Director
Donald.McIsaac@noaa.gov

John C. Coon
Deputy Director
John.Coon@noaa.gov

<u>Name</u>	<u>Title</u>	<u>Extension</u>	<u>Email</u>
Bozzi, Laura A.	Fishery Management Policy Analyst	408	Laura.Bozzi@noaa.gov
Burner, Mike D.	Staff Officer: Coastal Pelagic Species and Scientific and Statistical Committee	414	Mike.Burner@noaa.gov
Compton, Carrie K.	Administrative Specialist	421	Carrie.Compton@noaa.gov
Dahl, Kit. R.	Staff Officer: NEPA and Highly Migratory Species	422	Kit.Dahl@noaa.gov
DeVore, John D.	Staff Officer: Groundfish	413	John.Devore@noaa.gov
Dorval, Renee D.	Administrative Specialist	420	Renee.Dorval@noaa.gov
Gilden, Jennifer D.	Associate Staff Officer: Information, Communications, and Habitat	418	Jennifer.Gilden@noaa.gov
Krause, Sandra J.	Information Technology Specialist	419	Sandra.Krause@noaa.gov
Porter, Carolyn S.	Executive Specialist	411	Carolyn.Porter@noaa.gov
Seeger, James L.	Staff Officer: Fishery Economics	416	Jim.Seeger@noaa.gov
Stauffer, Sara K.	Administrative Assistant	424	Sara.Stauffer@noaa.gov
Tracy, Chuck A.	Staff Officer: Salmon and Pacific Halibut	415	Chuck.Tracy@noaa.gov
Wilson, Mary J.	Fiscal Specialist	408	Mary.Wilson@noaa.gov

LEGAL COUNSEL

Eileen Cooney, Northwest Regional Counsel
National Oceanic and Atmospheric Administration
Office of General Counsel
7600 Sand Point Way NE
BIN C15700
Seattle, WA 98115-6300
206-526-6075

Judson Feder, Southwest Regional Counsel
National Oceanic and Atmospheric Administration
Office of General Counsel
501 West Ocean Boulevard
Long Beach, CA 90802-4213
562-980-4067



Roster published by the Pacific Fishery Management Council pursuant to National Oceanic and Atmospheric Administration contract number NA05NMF4410008

TABLE OF CONTENTS

PACIFIC FISHERY MANAGEMENT COUNCIL.....	5
ADVISORY BODIES.....	9
Coastal Pelagic Species Advisory Subpanel.....	9
Coastal Pelagic Species Management Team	11
Enforcement Consultants.....	12
Groundfish Allocation Committee.....	14
Groundfish Allocation Committee Advisory Members for Individual Fishing Quota Considerations (Non-Voting).....	15
Groundfish Advisory Subpanel	16
Groundfish Management Team	18
Habitat Committee.....	20
Highly Migratory Species Advisory Subpanel	22
Highly Migratory Species Management Team.....	24
Model Evaluation Workgroup	25
Salmon Advisory Subpanel	27
Salmon Technical Team	29
Scientific and Statistical Committee.....	30
AD HOC COMMITTEES	33
STANDING COMMITTEES	35
REPRESENTATIVES TO OTHER FORUMS.....	35

PACIFIC FISHERY MANAGEMENT COUNCIL

BRODRICK, MR. RYAN
State of California Principal Official

Director
California Department of Fish and
Game
PO Box 944209
Sacramento, CA 94244-2090

Telephone: (916) 653-7664
Fax: (916) 653-4645
Email: director@dfg.ca.gov

1st Designee: Ms. Marija Vojkovich

mvojkovich@dfg.ca.gov

Telephone: (805) 568-1246

CAMPBELL, MR. MCKIE
State of Alaska Principal Official

Commissioner
Alaska Department of Fish and Game
PO Box 25526
Juneau, AK 99802-5526

Telephone: (907) 465-6141
Fax: (907) 465-2332
Email: mckie_campbell@fishgame.state.ak.us

1st Designee: Mr. Gordy Williams
2nd Designee: Mr. David Bedford

gordy_williams@fishgame.state.ak.us
david_bedford@fishgame.state.ak.us

Telephone: (907) 465-6143
Telephone: (907) -46-5-41

CEDERGREEN, MR. MARK
Washington Obligatory

Westport Charterboat Association
PO Box 546
Westport, WA 98595-0546

Telephone: (360) 268-0445
Fax: (360) 268-9285
Email: mcedergreen@olynet.com

FOSMARK, MS. KATHY
California Obligatory

PO Box 1338
Pebble Beach, CA 93953

Telephone: (831) 373-5238
Fax: (831) 373-0123
Email: swordstuna@aol.com

HANSEN, MR. DONALD K.
Chairman
At-Large

Dana Wharf Sportfishing
34675 Golden Lantern
Dana Point, CA 92629-2990

Telephone: (949) 496-5794
Fax: (949) 496-8212
Email: donald@danawharfsportfishing.com

HANSON, DR. DAVID
Parliamentarian
PSMFC

Pacific States Marine Fisheries
Commission
3468 22nd Street NW
Hackensack, MN 56452

Telephone: (218) 675-5231
Fax: (503) 595-3232
Email: dave_hanson@psmfc.org

HOGAN, MR. DAVID
U.S. State Department

U.S. Department of State
2201 C St NW, Ste 7820
Washington, DC 20520

Telephone: (202) 647-3941
Fax: (202) 736-7350
Email:

1st Designee: Ms. Amanda Johnson-Miller

Telephone: (202) 736-7350

<p>HOUCK, RADM RICHARD R. Non-voting U.S. Coast Guard</p> <p>1st Designee: LCDR Fran Colantonio 2nd Designee: Mr. Brian Corrigan 3rd Designee: CDR Peter Martin</p>	<p>U.S. Coast Guard 915 Second Ave, Rm 3590 Seattle, WA 98174-1067</p> <p>francis.colantonio@uscg.mil brian.p.corrigan@uscg.mil peter.f.martin@uscg.mil</p>	<p>Telephone: (206) 220-7090 Fax: (206) 220-7306 Email: richard.r.houck@uscg.mil</p> <p>Telephone: (206) 220-7305 Telephone: (206) 220-7309 Telephone: (206) 220-7306</p>
<p>HUFFAKER, MR. STEVE State of Idaho Principal Official</p> <p>1st Designee: Mr. Jerry Mallet</p>	<p>Director Idaho Department of Fish and Game PO Box 25 Boise, ID 83707-0025</p> <p>mallet36@netzero.net</p>	<p>Telephone: (208) 334-3771 Fax: (208) 334-4885 Email: shuffaker@idfg.state.id.us</p> <p>Telephone: (208) 377-4595</p>
<p>KOENINGS, DR. JEFF State of Washington Principal Official</p> <p>1st Designee: Mr. Phil Anderson 2nd Designee: Ms. Michele Culver</p>	<p>Director Washington Department of Fish and Wildlife 600 Capitol Way N Olympia, WA 98501-1091</p> <p>anderpma@dfw.wa.gov culvemkc@dfw.wa.gov</p>	<p>Telephone: (360) 902-2225 Fax: (360) 902-2947 Email: director@dfw.wa.gov</p> <p>Telephone: (360) 902-2720 Telephone: (360) 249-1211</p>
<p>LOHN, MR. ROBERT NMFS - Northwest Region</p> <p>1st Designee: Mr. Frank Lockhart 2nd Designee: Dr. Peter Dygert</p>	<p>Regional Administrator National Marine Fisheries Service 7600 Sand Point Way NE, BIN C15700 Seattle, WA 98115-0070</p> <p>frank.lockhart@noaa.gov peter.dygert@noaa.gov</p>	<p>Telephone: (206) 526-6150 Fax: (206) 526-6736 Email: bob.lohn@noaa.gov</p> <p>Telephone: (206) 526-6142 Telephone: (206) 526-6734</p>
<p>MCINNIS, MR. ROD NMFS-Southwest Region</p> <p>1st Designee: Mr. Mark Helvey</p>	<p>Regional Administrator, Southwest Region National Marine Fisheries Service 501 W Ocean Blvd, Ste 4200 Long Beach, CA 90802-4213</p> <p>mark.helvey@noaa.gov</p>	<p>Telephone: (562) 980-4000 Fax: (562) 980-4018 Email: rod.mcinnis@noaa.gov</p> <p>Telephone: (562) 980-4040</p>
<p>MOORE, MR. ROD At-Large</p>	<p>Executive Director West Coast Seafood Processors Association 1618 SW First St, Ste 318 Portland, OR 97201</p>	<p>Telephone: (503) 227-5076 Fax: (503) 227-0237 Email: seafood@attglobal.net</p>
<p>MOORE, MR. VIRGIL State of Oregon Principal Official</p> <p>1st Designee: Mr. Curt Melcher 2nd Designee: Dr. Patricia Burke</p>	<p>Director Oregon Department of Fish and Wildlife 3406 Cherry Ave. NE Salem, OR 97303</p> <p>curt.melcher@state.or.us patty.m.burke@state.or.us</p>	<p>Telephone: (503) 947-6000 Fax: (503) 947-6042 Email: Virgil.Moore@state.or.us</p> <p>Telephone: (503) 947-6208 Telephone: (541) 867-0300</p>

MYER, MR. DALE
At-Large

Arctic Storm, Inc.
400 N 34th St, Ste 306
Seattle, WA 98103

Telephone: (206) 547-6557
Fax: (206) 547-3165
Email: dmyer@arcticstorm.com

ORTMANN, MR. DAVE
Vice Chairman
Idaho Obligatory

9007 W Forest Shores
Coeur D'Alene, ID 83814

Telephone: (208) 765-8733
Fax:
Email: haf2fish@verizon.net

ROTH, MR. TIM
U.S. Fish and Wildlife Service

Deputy Project Leader
U.S. Fish and Wildlife Service
1211 SE Cardinal Ct, Ste 100
Vancouver, WA 98683

Telephone: (360) 604-2500
Fax: (360) 604-2505
Email: timothy_roth@fws.gov

SONES, MR. DAVID
Tribal Obligatory
(Term Commences
September 22, 2006)

Tribal Representative
Makah Tribal Council
PO Box 618
Neah Bay, WA 98357

Telephone:
Fax:
Email: dsones@centurytel.net

THOMAS, MR. ROGER
At-Large

Golden Gate Fishermen's Association
PO Box 40
Sausalito, CA 94966-0040

Telephone: (415) 674-3474
Fax: (415) 332-4003
Email:

WARRENS, MR. FRANK
Oregon Obligatory

President
Frank Warrens Automotive and
Marine Services, Inc.
50 NW 20th Ave
Portland, OR 97209-1903

Telephone: (503) 228-6607
Fax: (503) 228-1383
Email: frank@frankwarrensauto.com

ADVISORY BODIES

COASTAL PELAGIC SPECIES ADVISORY SUBPANEL

ENTICKNAP, BEN
Conservation Representative

Pacific Project Manager
Oceana
4189 SE Division Street
Portland, OR 97202

Telephone: (503) 235-0278
Fax: (503) 230-0903
Email: Benticknap@oceana.org

GUGLIELMO, MR. NEIL
California Commercial

F/V Trionfo
1728 Via Pajaro
Camarillo, CA 93012

Telephone: (805) 384-9384
Fax:
Email: fvtrionfo@aol.com

HOINSKY, MS. TERRY
California Commercial

President
Fishermen's Union of America
510 North Broad Ave
Wilmington, CA 90744-5847

Telephone: (310) 834-2099
Fax: (310) 834-2098
Email:

LAW, MR. EUGENE
Oregon Commercial

754 Olalla Rd
Toledo, OR 97391

Telephone: (541) 336-2645
Fax: (541) 336-4214
Email: mslaw@harborside.com

MARCHAND, JR., MR. PIERRE
Processor

President
Jessie's Ilwaco Fish Company
PO Box 800
Ilwaco, WA 98624-0800

Telephone: (360) 642-3773
Fax: (360) 642-3362
Email: pierrem@ilwacofish.com

OKONIEWSKI, MR. MIKE
Processor

Pacific Seafood
1635 Down River Dr
Woodland, WA 98674

Telephone: (360) 225-8553
Fax:
Email:

PLESCHNER-STEEL, MS. DIANE
Processor

Executive Director
California Wetfish Producers
Association
PO Box 1951
Buellton, CA 93427

Telephone: (805) 693-5430
Fax: (805) 686-9312
Email: dplesch@earthlink.net

ROYAL, MR. JOHN
Chair
California Commercial

PO Box 1162
San Pedro, CA 90733

Telephone:
Fax:
Email:

STRASSER, CPT PAUL
California Charter/Sport

Owner
M.C.I.P. Sportfishing
141 W 22nd Street
San Pedro, CA 90731

Telephone: (310) 612-4747
Fax: (310) 514-2452
Email: pstrasser12@comcast.net

ZUANICH, MR. ROBERT P.
Washington Commercial

Executive Director
Stine Vessel Owners
1900 W Nickerson, Ste 320
Seattle, WA 98119

Telephone: (206) 283-7733
Fax: (206) 283-7795
Email: rpz@psvoa.com

COASTAL PELAGIC SPECIES MANAGEMENT TEAM

CRONE, DR. PAUL
Vice Chair
NMFS Representative

National Marine Fisheries Service
PO Box 271
La Jolla, CA 92038-0271

Telephone: (858) 546-7069
Fax: (858) 546-5653
Email: paul.crone@noaa.gov

CULVER, MR. BRIAN
WDFW Representative

Coastal Groundfish Policy Coordinator
Washington Department of Fish and
Wildlife
48A Devonshire Rd
Montesano, WA 98563-9618

Telephone: (360) 249-1205
Fax: (360) 664-0689
Email: culvebnc@dfw.wa.gov

HERRICK, DR. SAMUEL F.
Chair
NMFS Representative

Industry Economist
National Marine Fisheries Service
PO Box 271
La Jolla, CA 92037-0271

Telephone: (858) 546-7111
Fax: (858) 546-7003
Email: Sam.Herrick@noaa.gov

HILL, DR. KEVIN
NMFS Representative

National Marine Fisheries Service
PO Box 271
La Jolla, CA 92038-0271

Telephone: (858) 546-7052
Fax: (858) 546-7003
Email: kevin.hill@noaa.gov

LAUGHLIN, MS. LEEANNE
CDFG Representative

Marine Biologist
California Department of Fish and
Game
4665 Lampson Ave, Ste C
Los Alamitos, CA 90720

Telephone: (562) 342-7167
Fax: (562) 342-7139
Email: llaughlin@dfg.ca.gov

MCCRAE, MS. JEAN
ODFW Representative

Project Leader
Oregon Department of Fish and
Wildlife
2040 SE Marine Science Dr
Newport, OR 97365

Telephone: (541) 867-4741
Fax: (541) 867-0311
Email: jean.e.mccrae@state.or.us

SWEETNAM, MR. DALE
CDFG Representative

Senior Marine Biologist, Supervisor
California Department of Fish and
Game
8604 La Jolla Shores Dr
La Jolla, CA 92037

Telephone: (858) 546-7170
Fax: (858) 546-7116
Email: dale.sweetnam@noaa.gov

ENFORCEMENT CONSULTANTS

BROADMAN, MR. TIM NMFS Southwest Region Representative	National Marine Fisheries Service 1125 16th Street Arcata, CA 95521	Telephone: (707) 826-9247 Fax: Email: tim.broadman@noaa.gov
CENCI, CAPT MIKE Washington Representative	Washington Department of Fish and Wildlife PO Box 307 Nafelle, WA 98638	Telephone: (360) 581-3305 Fax: (360) 642-3967 Email: cencimac@dfw.wa.gov
CLEARY, LT DAVID Chair Oregon Representative	Oregon State Police 400 Public Service Building Salem, OR 97310-0660	Telephone: (503) 378-3725 4308 Fax: (503) 363-5475 Email: dave.cleary@state.or.us
COLANTONIO, LCDR FRAN 13th Coast Guard District	U.S. Coast Guard 915 2nd Ave, Rm 3562 Seattle, WA 98174-1067	Telephone: (206) 220-7305 Fax: (206) 220-7306 Email: francis.colantonio@uscg.mil
EASLEY, MR. OTHA NMFS Southwest Region Representative	Deputy Special Agent in Charge of the Southwest Division NOAA Office for Law Enforcement 501 W Ocean Blvd, Ste 4300 Long Beach, CA 90802	Telephone: (562) 980-4050 Fax: (562) 980-4058 Email: otha.easley@noaa.gov
1st Designee: Mr. Dan Torquemada	dan.torquemada@noaa.gov	Telephone: (707) 575-6070
FOLEY, MS. NANCY California Representative	Assistant Chief California Department of Fish and Game PO Box 1373 Placerville, CA 95667	Telephone: (916) 996-9003 Fax: Email: nfoley@dfg.ca.gov
1st Designee: CPT Marty Maytorena	mmaytorena@dfg.ca.gov	Telephone: (562) 342-7190
GUSTAFSON, LT JACOB 11th Coast Guard District	U.S. Coast Guard Coast Guard Island, Bldg. 15-1 Alameda, CA 94501	Telephone: (510) 437-5392 Fax: (510) 437-3223 Email: jgustafson@d11.uscg.mil
NOMURA, MS. VICKI NMFS Northwest Region	Special Agent in Charge National Marine Fisheries Service 7600 Sand Point Way NE, BIN C15700 Seattle, WA 98115-0070	Telephone: (206) 526-6137 Fax: (206) 526-6528 Email: Vicki.Nomura@noaa.gov
1st Designee: Mr. Dayna Matthews	dayna.matthews@noaa.gov	Telephone: (360) 753-4409

WARRINGTON, MR. TONY

California Department of Fish and
Game
1416 - 9th St, Rm 1326
Sacramento, CA 95814

Telephone: (916) 657-2355
Fax:
Email: twarring@dfg.ca.gov

GROUND FISH ALLOCATION COMMITTEE

ANDERSON, MR. PHIL Washington Representative	Special Assistant to the Director Washington Department of Fish and Wildlife 600 Capitol Way N Olympia, WA 98501-1091	Telephone: (360) 902-2720 Fax: (360) 902-2158 Email: anderpma@dfw.wa.gov
COONEY, MS. EILEEN NOAA General Counsel	Northwest Regional Counsel NOAA 7600 Sand Point Way NE, BIN C15700 Seattle, WA 98115-6300	Telephone: (206) 526-6075 Fax: (206) 526-6542 Email: eileen.cooney@noaa.gov
HANSEN, MR. DONALD K. Council Chair	Dana Wharf Sportfishing 34675 Golden Lantern Dana Point, CA 92629-2990	Telephone: (949) 496-5794 Fax: (949) 496-8212 Email: donald@danawharfssportfishing.com
HANSON, DR. DAVID Pacific States Marine Fisheries Commission	Pacific States Marine Fisheries Commission 3468 22nd Street NW Hackensack, MN 56452	Telephone: (218) 675-5231 Fax: (503) 595-3232 Email: dave_hanson@psmfc.org
LOCKHART, MR. FRANK NMFS Representative	National Marine Fisheries Service 7600 Sand Point Way, NE Bin C15700 Seattle, WA 98115-0070	Telephone: (206) 526-6142 Fax: (206) 526-6736 Email: frank.lockhart@noaa.gov
MELCHER, MR. CURT Oregon Representative	Statewide Salmon Fishery Manager Oregon Department of Fish and Wildlife 3406 Cherry Avenue NE Salem, OR 97303	Telephone: (503) 947-6208 Fax: (503) 947-6202 Email: curt.melcher@state.or.us
VOJKOVICH, MS. MARIJA California Representative	Offshore Ecosystem Coordinator California Department of Fish and Game 1933 Cliff Dr, Ste 9 Santa Barbara, CA 93109-1520	Telephone: (805) 568-1246 Fax: (805) 568-1235 Email: mvojkovich@dfg.ca.gov

GROUND FISH ALLOCATION COMMITTEE ADVISORY MEMBERS FOR INDIVIDUAL FISHING QUOTA CONSIDERATIONS (NON-VOTING)

Current Vacancies: One Whiting Fishery Position and One Open Access Position.

HENEMAN, MR. BURR Conservation Representative	Director Commenweal 35 Horseshoe Hill Rd Bollinas, CA 94924-9712	Telephone: (415) 868-1460 Fax: (415) 956-7441 Email: burr@igc.org
LEIPZIG, MR. PETER Trawl	Executive Director Fisherman's Marketing Association 320 Second St, Ste 2B Eureka, CA 95501-0457	Telephone: (707) 442-3789 Fax: (707) 442-9166 Email: pete@trawl.org
LONGO EDER, MS. MICHELE Fixed Gear	Michele Longo Eder Attorney at Law, LLC PO Box 1530 Newport, OR 97365	Telephone: (541) 265-3337 Fax: (541) 265-6633 Email: michele@michelelongoeder.com
MANN, MS. HEATHER Processor	President Munro Consulting PO Box 176 Siletz, OR 97380	Telephone: (541) 444-2208 Fax: (541) 444-2319 Email: munroconsulting@msn.com
OSBORN, MR. ROBERT Recreational Fisher	Fishery Consultant United Anglers of Southern California PO Box 385 Surfside, CA 90743	Telephone: (714) 840-0227 Fax: (714) 840-3146 Email: bob@unitedanglers.com

GROUND FISH ADVISORY SUBPANEL

Current Vacancies: One At-Sea Processor Position and One Open Access Position.

ANCONA, MR. TOM California Trawler	Tommy's Marine Service - F/V Caito Bros, Inc. PO Box 1227 Fort Bragg, CA 95437	Telephone: (707) 964-5423 Fax: (707) 964-7206 Email: ancona@mcn.org
BARRAGER, DR. STEPHEN Conservation Representative	Stanford Law School 2703 Broderick St. San Francisco, CA 94123	Telephone: (650) 504-1578 Fax: (650) 725-8509 Email: barrager@stanford.edu
BUTLER, MR. WAYNE Oregon Charter Boat Operator	Prowler Charters PO Box 674 Bandon, OR 97411	Telephone: (541) 347-9126 Fax: (541) 347-9126 Email: wayne.b1@verizon.net
COHEN, MR. BARRY Processor	Olde Port Fisheries/Del Mar 7121 Fern Flat Rd Aptos, CA 95003	Telephone: (831) 661-0867 Fax: Email: fishmancohen@aol.com
CROWLEY, MR. JOHN Fixed Gear At-Large	Pacific Ocean Fisheries, Inc. 1828 NW 204th St Seattle, WA 98177-2252	Telephone: (206) 542-2017 Fax: (206) 546-9001 Email: pacificseadancer@msn.com
GHIO, MR. TOM Acting Chair Fixed Gear At-Large	Ghio Fish Company 112 Gilbert CT Santa Cruz, CA 95065	Telephone: (831) 460-1455 Fax: Email: ghiofish2000@yahoo.com
HENSEL, MR. KENYON Northern Open Access	Hensel's 871 Elk Valley Rd Crescent City, CA 95531-9345	Telephone: (707) 465-6857 Fax: (707) 465-6857 Email: chensell@earthlink.net
HOLLOWAY, MR. JOHN Sport Fisheries At-Large	Executive Board Secretary Oregon Anglers/Oregon RFA 6823 SW Burlingame Ave Portland, OR 97219-2127	Telephone: (503) 452-7919 Fax: (503) 452-4919 Email: manleydesign@comcast.net
INGLES, MR. ROBERT C. Charter North of Pt Conception	Golden Gate Fisherman's Association PO Box 3728 Hayward, CA 94544	Telephone: (510) 581-2628 Fax: Email: sherry@fishingboat.com

LARKIN, MR. MARION J.
Washington Trawler

19737 Trophy Ln
Mount Vernon, WA 98274

Telephone: (360) 445-2400
Fax: (360) 445-4049
Email: mjlarkin@clearwire.net

MANN, MS. HEATHER
Processor

President
Munro Consulting
PO Box 176
Siletz, OR 97380

Telephone: (541) 444-2208
Fax: (541) 444-2319
Email: munroconsulting@msn.com

MARTIN, MR. JIM
Sport Fisheries At-Large

West Coast Regional Director
Recreational Fishing Alliance
PO Box 2420
Ft. Bragg, CA 95437

Telephone: (707) 964-8326
Fax: (707) 964-8326
Email: flatland@mcn.org

RICHTER, MR. GERRY
Fixed Gear At-Large

B & G Seafoods, Inc.
217 Calle Manzanita
Santa Barbara, CA 93105

Telephone: (805) 569-3099
Fax: (805) 569-3099
Email: gdrfish@msn.com

SMITH, MR. GORDON
Tribal Fisher

F/V Pacific Stalker
PO Box 712
Neah Bay, WA 98357

Telephone: (360) 645-2648
Fax: (360) 645-3199
Email: gmsm@centurytel.net

SMOTHERMAN, MR. KELLY E.
Oregon Trawler

F/V Miss Mary
PO Box 257
Hammond, OR 97121

Telephone: (503) 861-7716
Fax: (503) 861-0764
Email:

STRUNK, MR. DANIEL R.
Charter South of Pt Conception

Owner
Pierpoint Sportfishing
2618 182nd Place
Redondo Beach, CA 90278

Telephone: (310) 251-4140
Fax:
Email: skippersgirl@msn.com

WEBER, MR. RHETT
Washington Charter Boat Operator

F/V Slammer Fishing
PO Box 2511
Westport, WA 98595-2511

Telephone: (360) 268-6229
Fax:
Email: slammer@techline.com

ZUMACH, MR. GORDON
Sport Fisher At Large

230 Rainview Lane
Sequim, WA 98382

Telephone: (360) 681-2457
Fax:
Email: gazuuum@localnet.com

GROUND FISH MANAGEMENT TEAM

ASELTINE-NEILSON, MS. DEBORAH
CDFG Representative

California Department of Fish and Game
8604 La Jolla Shores Dr
La Jolla, CA 92037

Telephone: (858) 546-7150
Fax: (858) 546-7003
Email: daseltine@dfg.ca.gov

ASHCRAFT, MS. SUSAN E.
CDFG Representative
Chair

Associate Marine Biologist
California Department of Fish and Game
350 Harbor Blvd
Belmont, CA 94110

Telephone: (650) 631-6786
Fax: (650) 631-6793
Email: sashcraft@dfg.ca.gov

BURDEN, MR. MERRICK
NMFS Northwest Region
Vice Chair

Economist
National Marine Fisheries Service
7600 Sand Point Way, Bldg 1,
FNWR/2
Seattle, WA 98115

Telephone: (206) 526-4656
Fax: (206) 526-6736
Email: merrick.burden@noaa.gov

CULVER, MS. MICHELE K.
WDFW Representative

Marine Resources Policy Coordinator
Washington Department of Fish and Wildlife
48 Devonshire Road
Montesano, WA 98563

Telephone: (360) 249-1211
Fax: (360) 664-0689
Email: culvemkc@dfw.wa.gov

CULVER, MR. BRIAN
WDFW Representative

Coastal Groundfish Policy Coordinator
Washington Department of Fish and Wildlife
48A Devonshire Rd
Montesano, WA 98563-9618

Telephone: (360) 249-1205
Fax: (360) 664-0689
Email: culvebnc@dfw.wa.gov

FIELD, DR. JOHN
NMFS Southwest Fisheries Science Center

Research Fishery Biologist
NMFS Southwest Fisheries Science Center
110 Schaffer Rd
Santa Cruz, CA 95060

Telephone: (831) 420-3907
Fax: (831) 420-3977
Email: john.field@noaa.gov

JONES, MR. ROBERT F.
Tribal Scientist

Marine Fish Biologist
Northwest Indian Fisheries
Commission
PO Box 1029
Forks, WA 98331

Telephone: (360) 374-5501
Fax: (360) 374-5592
Email: rjones@nwifc.org

KIRCHNER-ROGERS, MS. GWAY
ODFW Representative

Assistant Project Leader
Oregon Department of Fish and
Wildlife
2040 SE Marine Science Dr
Newport, OR 97365-5294

Telephone: (541) 867-0300 267
Fax: (541) 867-0311
Email: gway.r.kirchner@state.or.us

RENKO, MS. BECKY
NMFS Northwest Region

National Marine Fisheries Service
7600 Sand Point Way NE, BIN
C15700
Seattle, WA 98115-0070

Telephone: (206) 526-6110
Fax: (206) 526-6736
Email: becky.renko@noaa.gov

SAELENS, MR. MARK
ODFW Representative

Oregon Department of Fish and
Wildlife
2040 SE Marine Science Dr
Newport, OR 97365-5294

Telephone: (541) 867-0300 251
Fax: (541) 867-0311
Email: mark.r.saelens@state.or.us

WALLACE, MR. JOHN
NMFS NWFSC Representative

National Marine Fisheries Service
2725 Montlake Blvd. East
Seattle, WA 98112

Telephone: (206) 860-3456
Fax: (206) 860-3394
Email: john.wallace@noaa.gov

HABITAT COMMITTEE

BEDFORD, MR. DENNIS
CDFG Representative

Associate Marine Biologist
California Department of Fish and
Game
7665 Lampson Ave, Ste C
Los Alamitos, CA 90720

Telephone: (562) 342-7172
Fax: (562) 342-7193
Email: dbedford@dfg.ca.gov

CHESNEY, MR. BRYANT
NMFS Regional Representative

National Marine Fisheries Service
501 W Ocean Blvd, Ste 4200
Long Beach, CA 90802

Telephone: (562) 980-4037
Fax: (562) 980-4092
Email: bryant.chesney@noaa.gov

1st Designee: Ms. Korie Schaeffer

korie.schaeffer@noaa.gov

Telephone: (707) 575-6087

ELLIS, MR. STUART
Chair
Northwest Tribal Representative

Fisheries Scientist
Columbia River Inter-Tribal Fish
Commission
729 NE Oregon, Ste 200
Portland, OR 97232-2175

Telephone: (503) 238-0667
Fax: (503) 235-4228
Email: ells@critfc.org

HAMILTON, MS. LIZ
Sport Fisheries At-Large

Executive Director
Northwest Sportfishing Industry
Association
PO Box 4
Oregon City, OR 97045-0004

Telephone: (503) 631-8859
Fax: (503) 631-3887
Email: nsializ@aol.com

HEIKKILA, MR. PAUL
Commercial Fisher

Oregon State University
631 Alder St
Myrtle Point, OR 97458

Telephone: (541) 572-5263 288
Fax: (541) 572-5963
Email: paul.heikkila@oregonstate.edu

HILLEMEIER, MR. DAVE
California Tribal Representative

Fisheries Program Manager
Yurok Tribe
PO Box 1027
Klamath, CA 95548

Telephone: (707) 482-1350 315
Fax: (707) 482-1377
Email: naypooie@northcoast.com

MCGONIGAL, MR. HUFF
National Marine Sanctuary
Representative

Monterey Bay National Marine
Sanctuary
299 Foam St, Ste D
Monterey, CA 93940

Telephone: (831) 647-4254
Fax: (831) 647-4250
Email: huff.mcgonigal@noaa.gov

OSMOND, MR. MICHAEL
Conservation Representative

Senior Program Officer
World Wildlife Fund
171 Forest Ave
Palo Alto, CA 94301

Telephone: (650) 323-3506
Fax: (650) 325-2236
Email:

PETROSKY, DR. CHARLIE IDFG Representative	Fishery Program Coordinator Idaho Department of Fish and Game 600 S. Walnut Boise, ID 83707	Telephone: (208) 334-3791 Fax: (208) 334-2114 Email: cpetrosky@idfg.idaho.gov
RECHT, MS. FRAN PSMFC Representative	Habitat Program Project Manager Pacific States Marine Fisheries Commission PO Box 221 Depoe Bay, OR 97341-0221	Telephone: (541) 765-2229 Fax: (541) 765-2229 Email: franrecht@centurytel.net
ROTH, MR. TIM USFW Representative	Deputy Project Leader U.S. Fish and Wildlife Service 1211 SE Cardinal Ct, Ste 100 Vancouver, WA 98683	Telephone: (360) 604-2500 Fax: (360) 604-2505 Email: timothy_roth@fws.gov
SCOTT, MS. TERESA WDFW Representative	Natural Resource Policy Analyst Washington Department of Fish and Wildlife MS 43136, 600 Capitol Way N Olympia, WA 98501-1091	Telephone: (360) 902-2713 Fax: (360) 902-2158 Email: scotttls@dfw.wa.gov
WAKEFIELD, DR. WALDO NMFS FSC Representative	National Marine Fisheries Service 2032 SE OSU Dr Newport, OR 97365	Telephone: (541) 867-0542 Fax: (541) 867-0505 Email: waldo.wakefield@noaa.gov
WEEKS, DR. HAL ODFW Representative	Marine Habitat Project Leader Oregon Dept of Fish and Wildlife 2040 SE Marine Science Drive Newport, OR 97365	Telephone: (541) 867-0300 279 Fax: (541) 867-0311 Email: Hal.Weeks@state.or.us
1st Designee: Ms. Arlene Merems	arlene.r.merems@state.or.us	Telephone: (541) 867-0300
WHITE, MR. SEAN Public At-Large	Principal Environmental Specialist Sonoma County Water Agency PO Box 11628 Santa Rosa, CA 95406	Telephone: (707) 547-1908 Fax: (707) 524-3782 Email: seanw@scwa.ca.gov

HIGHLY MIGRATORY SPECIES ADVISORY SUBPANEL

AUGELLO, MR. ANGELO Southern Processor	Western Fish Company 740 South Seaside Ave Terminal Island, CA 90731	Telephone: (310) 519-0254 Fax: (310) 519-3707 Email: westernfish740@aol.com
BROWN, MR. MICHAEL Northern Processor	Pacific Coast Seafood Company PO Box 70 Warrenton, OR 97146	Telephone: (503) 861-2201 Fax: Email: mbrown@pacseafood.com
DUPUY, MR. PETE Commercial At-Large	Ocean Pacific Sea Food 18212 Rosita St Tarzana, CA 91356	Telephone: (818) 343-9927 Fax: (818) 881-5003 Email: lapazkd@aol.com
FELANDO, MR. AUGUST Commercial Purse Seine	870 San Antonio Pl San Diego, CA 92106	Telephone: (619) 223-7654 Fax: (619) 223-7958 Email: tunaug@compuserve.com
FLETCHER, MR. ROBERT Charter Boat Operator	President Sportfishing Association of California 1084 Bangor St San Diego, CA 92106	Telephone: (619) 226-6455 Fax: (619) 226-0175 Email: dart@sacemup.org
FOSMARK, MR. STEVEN Gillnet Fisheries Representative	Owner/Operator F/V Seeadler 3059 Sherman Rd Pebble Beach, CA 93953	Telephone: (831) 373-5238 Fax: (831) 373-0123 Email: fvseeadler@aol.com
FRICKE, MR. DOUGLAS Vice-chair Commercial At-Large	Boat Seafoods 110 Valley Rd Hoquiam, WA 98550	Telephone: (360) 533-2069 Fax: (360) 538-0466 Email: fricked@techline.com
HEIKKILA, MR. WAYNE Chair Commercial Troller	Executive Director Western Fishboat Owner's Association PO Box 992723 Redding, CA 96099	Telephone: (530) 229-1097 Fax: (530) 229-0973 Email: wfoa@charter.net
MCHALE, MS. TANA Public At-Large	25 NW 23rd Pl, Ste 6, PMB 394 Portland, OR 97210-5599	Telephone: (503) 820-2280 Fax: Email:

NELSON, DR. RUSSELL S.
Recreational At-Large

Fishery Scientist
Nelson Resources Consulting, Inc.
765 NW 35th St
Oakland Park, FL 33309

Telephone: (561) 449-9637
Fax:
Email: DrRSNNC@aol.com

OSBORN, MR. ROBERT
Private Recreational

Fishery Consultant
United Anglers of Southern California
PO Box 385
Surfside, CA 90743

Telephone: (714) 840-0227
Fax: (714) 840-3146
Email: bob@unitedanglers.com

SUTTON, MR. BILL
Commercial At-Large

F/V Aurelia
876 S Rice Rd
Ojai, CA 93023

Telephone: (805) 646-9685
Fax: (805) 646-1321
Email:

WING, MS. KATE
Conservation Representative

Ocean Policy Analyst
Natural Resources Defense Council
111 Sutter St, 20th Fl
San Francisco, CA 94104

Telephone: (415) 875-6100
Fax: (415) 875-6161
Email: kwing@nrdc.org

HIGHLY MIGRATORY SPECIES MANAGEMENT TEAM

Current Vacancies: One NMFS SWFSC Position.

CULVER, MS. MICHELE K.

Co-chair

WDFW Representative

Marine Resources Policy Coordinator
Washington Department of Fish and
Wildlife
48 Devonshire Road
Montesano, WA 98563

Telephone: (360) 249-1211
Fax: (360) 664-0689
Email: culvemkc@dfw.wa.gov

HEBERER, MR. CRAIG

NMFS Southwest Region

National Marine Fisheries Service
501 W Ocean Blvd, Ste 4200
Long Beach, CA 90802-4213

Telephone: (562) 980-4034
Fax: (562) 980-4047
Email: craig.heberer@noaa.gov

KOHIN, DR. SUZANNE

NMFS Southwest Fisheries Science
Center

Research Fishery Biologist
National Marine Fisheries Service
8604 La Jolla Shores Dr
La Jolla, CA 92038-1508

Telephone: (858) 546-7104
Fax: (858) 546-7003
Email: suzanne.kohin@noaa.gov

MCCRAE, MS. JEAN

ODFW Representative

Project Leader
Oregon Department of Fish and
Wildlife
2040 SE Marine Science Dr
Newport, OR 97365

Telephone: (541) 867-4741
Fax: (541) 867-0311
Email: jean.e.mccrae@state.or.us

PETRAS, MS. ELIZABETH

NMFS Southwest Region

Liaison Officer
National Marine Fisheries Service
501 West Ocean Blvd, Ste 4200
Long Beach, CA 90802-4213

Telephone: (562) 980-3238
Fax: (562) 980-4027
Email: elizabeth.petras@noaa.gov

STOHS, DR. STEPHEN

NMFS Southwest Fisheries Science
Center

National Marine Fisheries Service
PO BOX 271
La Jolla, CA 92037-1508

Telephone: (858) 546-7084
Fax: (858) 546-7003
Email: Stephen.Stohs@noaa.gov

WERTZ, MR. STEVE

California Representative

California Department of Fish and
Game
4665 Lampson Ave, Ste C
Los Alamitos, CA 90720

Telephone: (562) 342-7184
Fax: (562) 342-7139
Email: swertz@dfg.ca.gov

MODEL EVALUATION WORKGROUP

CLEMONS, MR. ETHAN ODFW Representative	Project Analyst Oregon Department of Fish and Wildlife 3406 Cherry Ave. NE Salem, OR 97303	Telephone: (503) 947-6200 Fax: (503) 947-6203 Email: Ethan.R.Clemons@state.or.us
CONRAD, MR. ROBERT H. Scientific and Statistical Committee	Quantitative Services Manager Northwest Indian Fisheries Commission 6730 Martin Way E Olympia, WA 98516-5540	Telephone: (360) 528-4345 Fax: (360) 753-8659 Email: bconrad@nwifc.org
GROVER, MR. ALLEN CDFG Representative	Marine Biologist California Department of Fish and Game 475 Aviation Blvd, Ste 130 Santa Rosa, CA 95403	Telephone: (707) 576-2860 Fax: (707) 576-7132 Email: agrover@dfg.ca.gov
LAVOY, MR. LARRIE Vice-chair WDFW Representative	Washington Department of Fish and Wildlife 600 Capitol Way N Olympia, WA 98501-1091	Telephone: (360) 902-2841 Fax: (360) 902-2949 Email: lavoylwl@dfw.wa.gov
1st Designee: Mr. Jim Packer	packejfp@dfw.wa.gov	Telephone: (360) 902-2754
RANKIS, MR. ANDY Chair Northwest Indian Fisheries Commission	Quantitative Fisheries Biologist Northwest Indian Fisheries Commission 6730 Martin Way E Olympia, WA 98516	Telephone: (360) 438-1181 322 Fax: (360) 753-8659 Email: arankis@nwifc.org
SHARMA, MR. RISHI Columbia River Inter-Tribal Fish Commission	Bio-Metrician Columbia River Inter-Tribal Fish Commission 729 NE Oregon St, Ste 200 Portland, OR 97232	Telephone: (503) 238-0667 Fax: (503) 235-4228 Email: shar@critfc.org
SIMMONS, MR. DELL NMFS Representative	National Marine Fisheries Service 510 Desmond Dr SE, Ste 103 Lacey, WA 98503	Telephone: (360) 753-9580 Fax: (360) 753-9517 Email: dell.simmons@noaa.gov

YUEN, MR. HENRY
USFWS Representative

Fishery Biologist
U.S. Fish and Wildlife Service
1211 SE Cardinal Ct, Ste 100
Vancouver, WA 98683

Telephone: (360) 604-2500
Fax: (360) 604-2505
Email: henry_yuen@fws.gov

SALMON ADVISORY SUBPANEL

FELDNER, MR. JEFF Oregon Troll Representative	1651 Moonshine Park Road Logsdon, OR 97357	Telephone: (541) 444-2460 Fax: Email: jfeldner@teleport.com
FRANK, MR. CALVIN S. Washington Coastal Tribal Fisherman	F/V Cross Winds PO Box 373 Bay Center, WA 98527	Telephone: (360) 942-7809 Fax: Email:
MACLEAN, MR. DUNCAN California Troller	Owner F/V Barbara Faye PO Box 1942 El Granada, CA 94018-1942	Telephone: (650) 726-1373 Fax: (650) 712-8744 Email: b-faye@pacbell.net
MARTIN, MR. KENT Gillnet Fisheries Representative	PO Box 83 Skamokawa, WA 98647	Telephone: (360) 795-3920 Fax: Email: imartin@tdn.com
OLSON, MR. JIM Washington Troller	F/V Cynthia T PO Box 586 Auburn, WA 98071-0586	Telephone: (253) 833-8739 Fax: (425) 644-6107 Email:
ORCUTT, MR. MIKE California Tribal Representative	Hoopa Valley Tribe PO Box 417 Hoopa, CA 95546-0417	Telephone: (530) 625-4267 Fax: (530) 625-4995 Email: director@pcweb.net
REINHOLDT, MR. GERALD K. Processor	Reinholdt Fisheries 62313 S Canaan Rd St. Helens, OR 97051-9117	Telephone: (503) 397-3369 Fax: (503) 397-3369 Email:
SMITH, MR. BUTCH Vice-chair Washington Charter Boat Operatorl	Co-Ho Charters PO Box 268 Ilwaco, WA 98624	Telephone: (360) 642-3333 Fax: (360) 642-3758 Email: coho@willapabay.org
SORENSEN, MR. MIKE Oregon Charter Boat Operator	603 Camp 12 Lp Toledo, OR 97391	Telephone: (541) 444-2552 Fax: Email:
STONE, MR. CRAIG California Sport Fisher	Emeryville Sportfishing 3310 Powell St Emeryville, CA 94608	Telephone: (510) 654-6040 Fax: (510) 654-2106 Email: emvlsport@aol.com

STRICKLAND, MR. ROBERT
California Sport Fisher

President
United Anglers of California
15572 Woodard Rd
San Jose, CA 95124

Telephone: (408) 371-0331
Fax: (408) 371-9459
Email: bobstrickland@unitedanglers.org

TUGGLE, MR. JIM
Conservation Representative

3092 Hampton Dr SW
Tumwater, WA 98512

Telephone:
Fax:
Email: tugstours@comcast.net

WATROUS, MR. STEVE
Washington Sport Fisher

Garonaire, Inc.
2515 Kauffman Ave
Vancouver, WA 98660

Telephone: (360) 696-1604
Fax: (360) 695-6031
Email: branchofic@aol.com

WELSH, DR. TOM
Idaho Sport Fisher

Thomas L. Welsh
BIOCONSULTANTS
PO Box 2783
McCall, ID 83638

Telephone: (208) 860-9441
Fax:
Email: thomaslwelsh@peoplepc.com

WELTER, MR. JIM
Oregon Sport Fisher

404 Pacific Ave
Brookings, OR 97415

Telephone: (541) 469-7044
Fax:
Email: jswltr@verizon.net

SALMON TECHNICAL TEAM

FOSTER, MR. CRAIG
ODFW Representative

Fish Management Biologist
Oregon Department of Fish and
Wildlife
17330 SE Evelyn St
Clackamas, OR 97015

Telephone: (503) 657-2000 248
Fax: (503) 657-2095
Email: craig.a.foster@state.or.us

GROVER, MR. ALLEN
Vice-chair
CDFG Representative

Marine Biologist
California Department of Fish and
Game
475 Aviation Blvd, Ste 130
Santa Rosa, CA 95403

Telephone: (707) 576-2860
Fax: (707) 576-7132
Email: agrover@dfg.ca.gov

1st Designee: Ms. Melodie Palmer-Zwahlen
(707) 576-2870

mpalmer@dfg.ca.gov Telephone:

KOPE, DR. ROBERT
NMFS Representative

Research Fishery Biologist
National Marine Fisheries Service
2725 Montlake Blvd E
Seattle, WA 98112-2097

Telephone: (206) 860-3374
Fax:
Email: robert.kope@noaa.gov

MILWARD, MR. DOUG
WDFW Representative

Washington Department of Fish and
Wildlife
600 Capitol Way N
Olympia, WA 98501-1091

Telephone: (360) 902-2739
Fax: (360) 902-2949
Email: milwadam@dfw.wa.gov

MOHR, MR. MICHAEL S.
NMFS Representative

National Marine Fisheries Service
110 Shaffer Rd
Santa Cruz, CA 95060

Telephone: (831) 420-3922
Fax: (831) 420-3977
Email: michael.mohr@noaa.gov

MORISHIMA, DR. GARY
Tribal Representative

3010 - 77th SE, Ste 104
Mercer Island, WA 98040-2829

Telephone: (206) 236-1406
Fax: (206) 236-6842
Email: morikog@aol.com

SIMMONS, MR. DELL
Chair
NMFS Representative

National Marine Fisheries Service
510 Desmond Dr SE, Ste 103
Lacey, WA 98503

Telephone: (360) 753-9580
Fax: (360) 753-9517
Email: dell.simmons@noaa.gov

YUEN, MR. HENRY
USFWS Representative

Fishery Biologist
U.S. Fish and Wildlife Service
1211 SE Cardinal Ct, Ste 100
Vancouver, WA 98683

Telephone: (360) 604-2500
Fax: (360) 604-2505
Email: henry_yuen@fws.gov

SCIENTIFIC AND STATISTICAL COMMITTEE

Current Vacancies: One IDFG Representative Position

BARNES, MR. J. THOMAS CDFG Representative	Senior Biologist California Department of Fish and Game 8604 La Jolla Shores Dr La Jolla, CA 92037-0271	Telephone: (858) 546-7167 Fax: (858) 546-7003 Email: tombarnes@ucsd.edu
BERKELEY, MR. STEVEN A. At-Large	University of California, Santa Cruz 100 Shaffer Rd Santa Cruz, CA 95060	Telephone: (831) 459-3530 Fax: (831) 459-3383 Email: stevenab@cats.ucsc.edu
CONRAD, MR. ROBERT H. Chair Tribal Agency	Quantitative Services Manager Northwest Indian Fisheries Commission 6730 Martin Way E Olympia, WA 98516-5540	Telephone: (360) 528-4345 Fax: (360) 753-8659 Email: bconrad@nwifc.org
CONSER, DR. RAMON J. At-Large	Fisheries Research Biologist NOAA/NMFS 8604 La Jolla Shores Dr La Jolla, CA 92037-0271	Telephone: (858) 546-5688 Fax: (858) 546-5656 Email: ray.conser@noaa.gov
DALTON, DR. MICHAEL At-Large	California State University, Monterey Bay 100 Campus Center Seaside, CA 93955-8001	Telephone: (831) 582-3024 Fax: (831) 582-4688 Email: michael_dalton@csumb.edu
DORN, DR. MARTIN NMFS Alaska Fisheries Science Center	National Marine Fisheries Service 7600 Sand Point Way NE, BIN C15700 Seattle, WA 98115-0070	Telephone: (206) 526-6548 Fax: (206) 525-6723 Email: martin.dorn@noaa.gov
HAMEL, DR. OWEN NMFS Northwest Fisheries Science Center	Research Fisheries Biologist National Marine Fisheries Service 2725 Montlake Blvd E Seattle, WA 98112	Telephone: (206) 860-3481 Fax: Email: owen.hamel@noaa.gov
HILL, DR. KEVIN NMFS Southwest Fisheries Science Center	National Marine Fisheries Service PO Box 271 La Jolla, CA 92038-0271	Telephone: (858) 546-7052 Fax: (858) 546-7003 Email: kevin.hill@noaa.gov

JAGIELO, MR. TOM WDFW Representative	Research Scientist Washington Department of Fish and Wildlife PO Box 93 Copalis Beach, WA 98535	Telephone: (360) 791-9089 Fax: Email: jagiethj@dfw.wa.gov
LAWSON, DR. PETER NMFS Northwest Fisheries Science Center	National Marine Fisheries Service 2030 S Marine Science Dr Newport, OR 97365-5296	Telephone: (541) 867-0430 Fax: (541) 867-0380 Email: Peter.W.Lawson@noaa.gov
PUNT, DR. ANDRE At-Large	Research Associate Professor University of Washington Box 355020 Seattle, WA 98195-5020	Telephone: (206) 221-6319 Fax: (206) 685-7471 Email: aepunt@u.washington.edu
RADTKE, DR. HANS At-Large	PO Box 244 Yachats, OR 97498	Telephone: (541) 547-3087 Fax: (541) 547-3087 Email: hradtk@oregonvos.net
RALSTON, DR. STEPHEN Vice-Chair At-Large	Fishery Biologist (Research) National Marine Fisheries Service 110 Shaffer Rd Santa Cruz, CA 95060	Telephone: (831) 420-3949 Fax: (831) 420-3977 Email: steve.ralston@noaa.gov
SAMPSON, DR. DAVID ODFW Representative	Professor of Fisheries Oregon State University 2030 SE Marine Science Dr Newport, OR 97365-5296	Telephone: (541) 867-0386 Fax: (541) 867-0345 Email: david.sampson@oregonstate.edu
THOMSON, MS. CINDY NMFS Southwest Fisheries Science Center	National Marine Fisheries Service 110 Shaffer Rd Santa Cruz, CA 95060	Telephone: (831) 420-3911 Fax: (831) 420-3977 Email: Cindy.Thomson@noaa.gov

Ad Hoc COMMITTEES

Coastal Pelagic Species Tribal Allocation Committee: Mr. Phil Anderson, Dr. Patricia Burke, Mr. Donald K. Hansen, Mr. Mark Helvey, Mr. Frank Lockhart, Ms. Marija Vojkovich, Vacant Tribal Position.

Full Retention Committee: LT David Cleary, Ms. Eileen Cooney, Mr. Brian Culver, Dr. James Hastie, Mr. Rod Moore.

Groundfish Essential Fish Habitat Environmental Impact Statement Oversight Committee: Mr. Phil Anderson, Dr. Patricia Burke, Mr. Tom Ghio, Mr. Peter Huhtala, Mr. Curt Melcher, Ms. Marija Vojkovich.

Groundfish Habitat Technical Review Committee: Dr. Rod Fujita, Dr. Chris Goldfinger, Dr. Gary Greene, Mr. Marion J. Larkin, Mr. Scott McMullen, Dr. Mark Powell, Dr. Waldo Wakefield, Ms. Mary Yoklavich.

Groundfish Multi-year Management Committee: Mr. Phil Anderson, Ms. Eileen Cooney, Dr. James Hastie, Mr. Frank Lockhart, Mr. Curt Melcher.

Groundfish Strategic Plan Implementation Oversight Committee: Mr. Phil Anderson, Mr. Donald K. Hansen, Dr. David Hanson, Mr. Curt Melcher, Ms. Marija Vojkovich.

Groundfish Strategic Plan Implementation Oversight Committee : Mr. Phil Anderson, Ms. Eileen Cooney, Ms. Kathy Fosmark, Dr. Steve Freese, Mr. Douglas Fricke, Dr. James Hastie, Mr. Kenyon Hensel, Mr. Steve Joner, Mr. Frank Lockhart, Mr. Mike McCorkle, Mr. Rod Moore, Mr. Brian Petersen, Ms. Marija Vojkovich.

Groundfish Trawl Individual Quota Committee: Mr. Steve Bodnar, Mr. Jay Bornstein, Mr. Frank Dulcich, Mr. Chris Garbrick, Ms. Ginny Goblirsch, Dr. David Hanson, Mr. Alan Hightower, Mr. Jan Jacobs, Mr. David Jincks, Mr. Steve Joner, Mr. Marion Larkin, Mr. Peter Leipzig, Ms. Dorothy Lowman, Mr. Dayna Matthews, Mr. Dale Myer, Mr. Brad Pettinger, Mr. Joe Plesha, Dr. Richard Young.

Highly Migratory Species Management Committee: Mr. Phil Anderson, Mr. Donald K. Hansen, Mr. Mark Helvey, Ms. Marija Vojkovich.

Marine Protected Area Committee: Mr. Phil Anderson, Ms. Eileen Cooney, Mr. Robert Fletcher, Ms. Kathy Fosmark, Mr. Donald K. Hansen, Mr. Duncan MacLean, Dr. Donald O. McIsaac, Mr. Curt Melcher, Ms. Diane Pleschner-Steel, Ms. Cindy Thomson.

Observer Program Implementation Committee: Mr. J. Thomas Barnes, Mr. William Barss, Mr. Brian Culver, Dr. David Hanson, Ms. Becky Renko, Mr. Mark Saelens, Ms. Teresa Turk.

Salmon Amendment Committee: Mr. Ray Beamesderfer, Mr. LB Boydston, Mr. Mike Burner, Mr. Eric Chavez, Dr. Kit Dahl, Dr. Peter Dygert, Mr. Craig Foster, Mr. Allen Grover, Mr. Dave Hillemeier, Mr. George Kautsky, Dr. Robert Kope, Mr. Larrie LaVoy, Dr. Peter Lawson, Mr. Duncan MacLean, Mr. Michael S. Mohr, Dr. Gary Morishima, Ms. Corinne Pinkerton, Mr. James L. Seger, Ms. Cindy Thomson, Mr. Chuck Tracy, Mr. Dan Wolford, Mr. Chris Wright.

Trawl Individual Quota Analytical Team: Dr. Carl Lian, Ms. Kathryn Quigley, Ms. Suzanne Russell, Mr. Terry Tillman.

Trawl Individual Quota Enforcement Group: CAPT Mike Cenci, LT David Cleary, LT Brian Corrigan, Mr. Otha Easley, Mr. Frank Lockhart, Mr. Dayna Matthews, Mr. Tony Warrington.

Trawl Individual Quota Independent Experts Panel: Mr. Christophe Dewees, Dr. Robert Francis, Dr. Susan Hanna, Dr. Dan Huppert, Dr. Gilbert Sylvia.

Vessel Monitoring System Committee: Mr. Joseph Albert, Mr. Mark Cedergreen, CAPT Mike Cenci, LT Brian Corrigan, Mr. John Crowley, Ms. Kathy Fosmark, Mr. Tom Ghio, LT Jacob Gustafson, Mr. Donald K. Hansen, Mr. Kenyon Hensel, Mr. Marion J. Larkin, Mr. Dayna Matthews, Ms. Becky Renko.

STANDING COMMITTEES

BUDGET COMMITTEE

CHAIRMAN: MR. JERRY MALLET
MR. DONALD K. HANSEN
DR. DAVID HANSON
MR. FRANK LOCKHART/MR. MARK HELVEY

LEGISLATIVE COMMITTEE

CHAIRMAN: DR. DAVID HANSON
MR. DONALD K. HANSEN
MR. ROD MOORE
MR. ROGER THOMAS

REPRESENTATIVES TO OTHER FORUMS

INTERNATIONAL PACIFIC HALIBUT COMMISSION
MR. PHIL ANDERSON

KLAMATH FISHERY MANAGEMENT COUNCIL
MR. FRANK WARRENS