

PACIFIC FISHERY MANAGEMENT COUNCIL

CHAIR'S RECEPTION



Monday, June 12, 2006

6:00 p.m.

Marco Polo Room

Crowne Plaza Hotel
Foster City, California

Pacific Fishery Management Council

Council Meeting Schedule

www.pcouncil.org/events/future.html

WEEK OF	LOCATION
March 5-10, 2006	Seattle Marriott Hotel-Sea Tac, 3201 S 176 th Street, Seattle, WA 98188-4094 206-241-2000 or 800-314-0925
April 2-7, 2006	Double Tree Hotel, 2001 Point West Way, Sacramento, CA 95815-4702 916-929-8855 or 800-222-8733
June 11-16, 2006	Crowne Plaza Mid Peninsula, 1221 Chess Drive, Foster City, CA 94404 800-227-6963 or 650-570-5700
September 10-15, 2006	Crowne Plaza Hotel, 1221 Chess Drive, Foster City, CA 94404 650-5700 or 800-477-5700
November 12-17, 2006	Hilton San Diego/Del Mar, 15575 Jimmy Durante Blvd, Del Mar, CA 92014 858-792-5200
◆ ◆	◆ ◆ ◆
March 4-9, 2007	Double Tree Hotel, 2001 Point West Way, Sacramento, CA 95815-4702 916-929-8855 or 800-222-8733
April 1-6, 2007	Oregon or Washington
June 10-15, 2007	Crowne Plaza Hotel, 1221 Chess Drive, Foster City, CA 94404 650-5700 or 800-477-5700
September 9-14, 2007	Washington, Oregon or California
November 4-9, 2007	Hyatt Regency Islandia Hotel, 1441 Quivira Road, San Diego, CA 92109 619-224-1234
◆ ◆	◆ ◆ ◆
March 9-14, 2008	Oregon or Washington
April 6-11, 2008	California
June 8-13, 2008	Washington, Oregon or California
September 14-19, 2008	Washington, Oregon or California
November 2-7, 2008	Oregon or California
◆ ◆	◆ ◆ ◆

Council Meeting Schedule (*continued*)

WEEK OF	LOCATION
March 8-13, 2009	California
April 5-10, 2009	Oregon or Washington
June 14-19, 2009	Washington, Oregon or California
September 13-18, 2009	Washington, Oregon or California
November 1-6, 2009	Oregon or California
◆ ◆	◆ ◆ ◆
March 7-12, 2010	Oregon or Washington
April 5-10, 2010 ¹	California
June 13-18, 2010	Washington, Oregon, or California
September 12-17, 2010	Washington, Oregon, or California
October 31- November 5, 2010	Oregon or California
◆ ◆	◆ ◆ ◆

05/17/2006

¹ Easter is April 4, 2010

DIRECTIONS

CROWNE PLAZA HOTEL, MID PENINSULA
1221 Chess Drive
Foster City, CA 94404
650.570.5700

SAN FRANCISCO

101 South to Hwy 92 East (Towards San Mateo Bridge / Hayward)
Exit Foster City Blvd., Left on Metro Center Blvd.
Left on Foster City Blvd., Left on Chess Drive.
Hotel is on the left.

SAN JOSE

101 North to Hwy 92 East (Towards San Mateo Bridge / Hayward)
Exit Foster City Blvd.
Left on Metro Center Blvd., Left on Foster City Blvd., Left on Chess Drive.
Hotel is on the left.

EAST BAY/OAKLAND/HAYWARD

880 South
Exit Jackson Street / San Mateo Bridge (\$2 toll)
After Crossing Bridge, Exit Foster City Blvd., Left at Chess Drive (Stop Light)
Hotel in on the left.

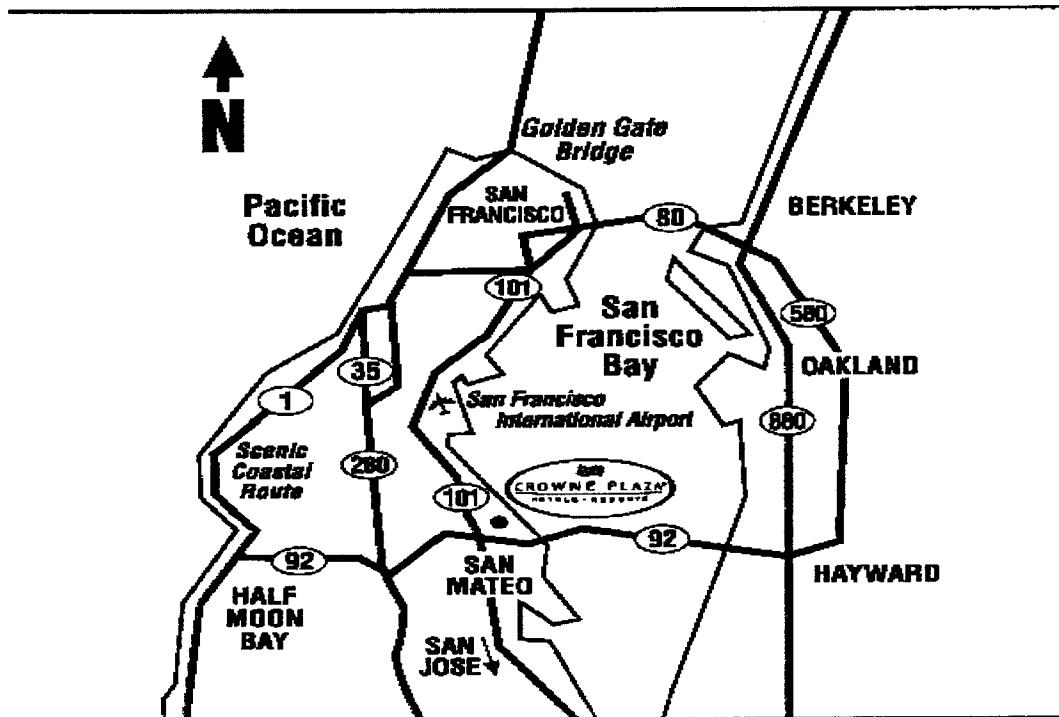

FOSTER CITY
650.570.5700

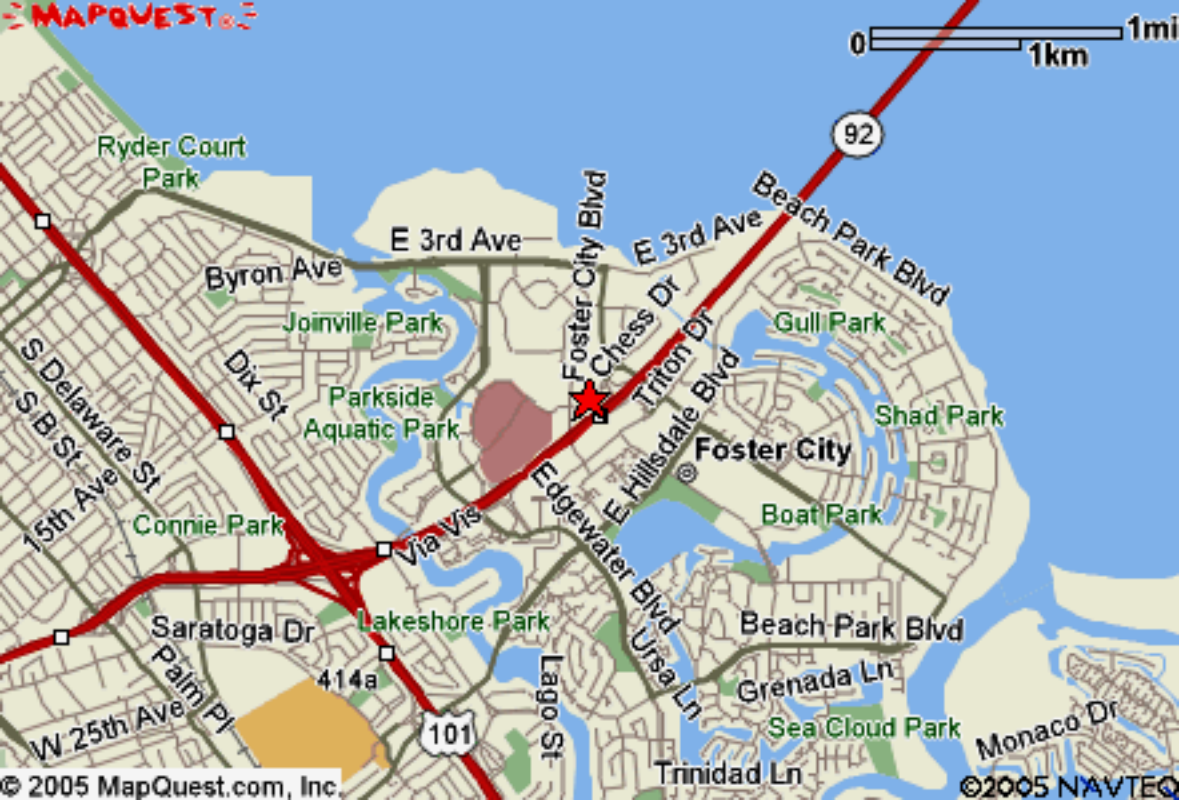



SAN FRANCISCO MID PENINSULA

Banquet Room Diagram

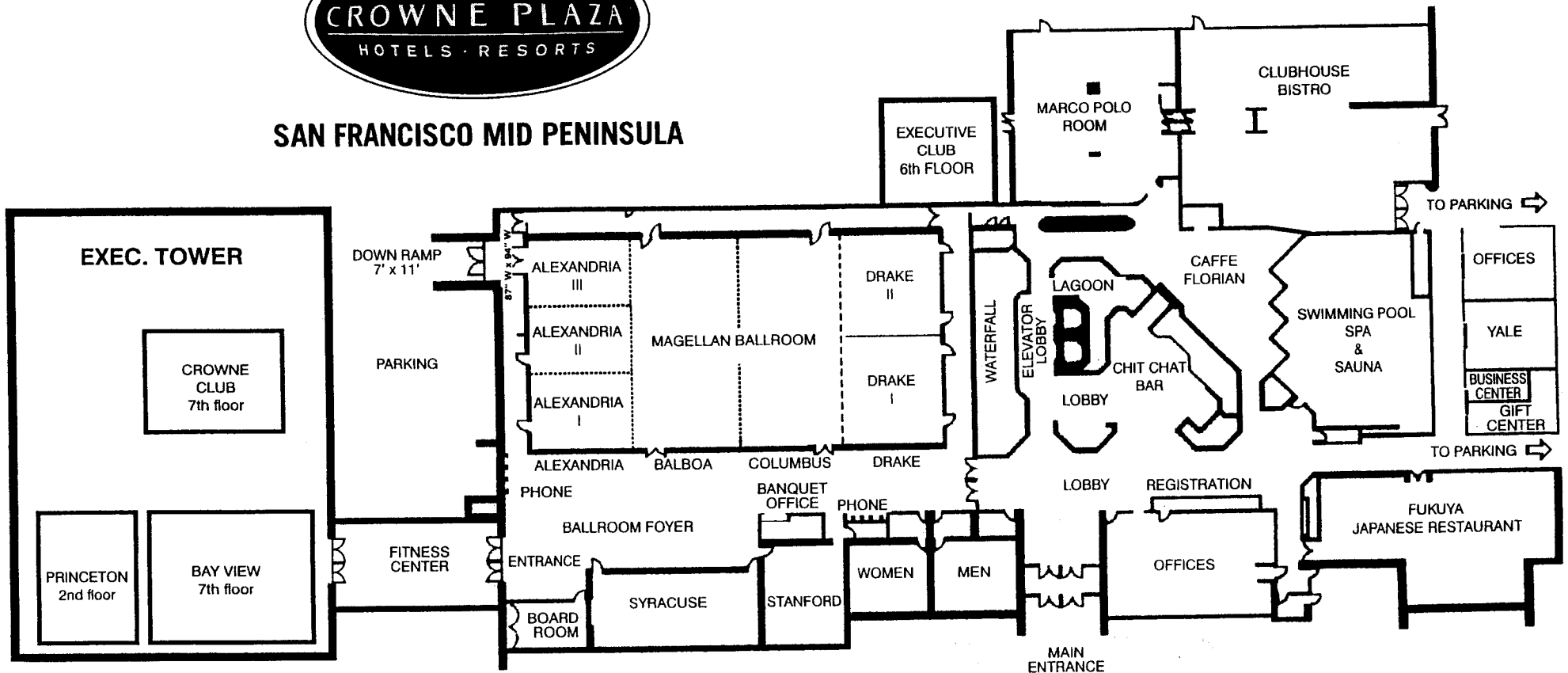

NAME OF ROOM	DIMENSIONS L X W X H	SQ.FT.	BANQUET ROUNDS (PP)	COCKTAIL RECEPTION	CONFERENCE/MEETINGS		
					U-SHAPE	CLASSROOM	THEATRE
Foyer	135 x 31 x 30	4,185					
Foyer A & B	71 x 31 x 30	2,201					
Foyer C & D	64 x 18 x 25	1,152					
Magellan Ballroom	120 x 60 x 12	7,440	680	1,500	150	400	1,000
Alexandria	30 x 60 x 12	1,800	150	200	50	90	200
Balboa	30 x 60 x 12	1,800	150	200	50	90	200
Columbus	30 x 60 x 12	1,800	150	200	50	90	200
Drake	30 x 60 x 12	1,800	150	200	50	90	200
Yale	23 x 18 x 10	415	40	40	20	24	40
Alexandria I	30 x 20 x 12	600	50	60	24	24	60
Alexandria II	30 x 20 x 12	600	50	60	24	24	60

All numbers reflect maximum number of people per room.

NAME OF ROOM	DIMENSIONS L X W X H	SQ.FT.	BANQUET ROUNDS (PP)	COCKTAIL RECEPTION	CONFERENCE/MEETINGS		
					U-SHAPE	CLASSROOM	THEATRE
Alexandria III	30 x 20 x 12	600	50	60	24	24	60
Drake I	31 x 30 x 12	930	70	100	30	40	80
Drake II	31 x 30 x 12	930	70	100	30	40	80
Syracuse	48 X 22 X 10	1,056	90	150	48	60	150
Stanford	31 X 25 X 10	795	50	60	25	32	60
Marco Polo Room	48 x 39 x 10	1,872	120	150	35	80	100
Chit Chat Lounge	31 x 25 x —	775	50	70	**	**	**
Boardroom	24 x 14 x 10	336	12 / Existing Set-up	***	***	**	**
Presidential Suite	24 x 25 x 10	575	6 / Existing Set-up	***	***	**	**
Clubhouse Bistro	98 x 51 x 16	5,000	125 / Existing Set-up	200	**	**	**
Crowne Club	25 x 27 x 12	675	**	50	**	**	**
Bay View	50 x 27 x 12	1,350	80	150	40	60	130
Princeton	27 x 24 x 8	660	60	70	22	22	70
Executive Club	24 x 18 x 8	432	40	40	15	15	25

All numbers reflect maximum number of people per room.

Tel: (650) 570-5700

1221 Chess Drive, Foster City, CA 94404

www.crownplaza.com/sfo-peninsula

Fax: (650) 570-0540

Restaurant List

CROWNE PLAZA HOTEL
1221 CHESS DRIVE
FOSTER CITY, CA 94404-1173
650-570-5700

Sort by Distance 

1) Fukuya Japanese Restaurant

1221 Chess Dr, Foster City, CA (0.00 miles away)
650-349-7890
[Map](#) | [Directions To](#) | [Directions From](#)

2) El Torito Mexican Restaurant

388 Vintage Park Dr, Foster City, CA (0.08 miles away)
650-574-6844
[Map](#) | [Directions To](#) | [Directions From](#)

3) Wybridge Restaurant Group

373 Vintage Park Dr, Foster City, CA (0.13 miles away)
650-341-8103
[Map](#) | [Directions To](#) | [Directions From](#)

4) Black Angus Restaurant

1299 Chess Dr, Foster City, CA (0.15 miles away)
650-345-9971
[Map](#) | [Directions To](#) | [Directions From](#)

5) Carvery

1297 Chess Dr, Foster City, CA (0.15 miles away)
650-349-8411
[Map](#) | [Directions To](#) | [Directions From](#)

6) Harry's Hofbrau

1297 Chess Dr, Foster City, CA (0.15 miles away)
650-349-8411
[Map](#) | [Directions To](#) | [Directions From](#)

7) Boston Market

1000 Metro Center Blvd # A, Foster City, CA (0.18 miles away)
650-572-1700
[Map](#) | [Directions To](#) | [Directions From](#)

8) Jamba Juice

1000 Metro Center Blvd # B, Foster City, CA (0.18 miles away)
650-571-6200
[Map](#) | [Directions To](#) | [Directions From](#)

9) Rawlings All American Grille

2200 Bridgepointe Pkwy, San Mateo, CA (0.26 miles away)
650-570-5555
[Map](#) | [Directions To](#) | [Directions From](#)

10) Scores Legendary Sports Rstrnt

2200 Bridgepointe Pkwy, San Mateo, CA (0.26 miles away)
650-357-1998
[Map](#) | [Directions To](#) | [Directions From](#)

11) Cucina Cucina Italian Cafe

2206 Bridgepointe Pkwy, San Mateo, CA (0.27 miles away)
650-372-9144
[Map](#) | [Directions To](#) | [Directions From](#)

12) Savini

950 Tower Ln # 100, Foster City, CA (0.28 miles away)
650-572-0330
[Map](#) | [Directions To](#) | [Directions From](#)

13) Mc Donald's

1101 Triton Dr, Foster City, CA (0.30 miles away)
650-341-4832
[Map](#) | [Directions To](#) | [Directions From](#)

14) Carrows Restaurant

531 Foster City Blvd, Foster City, CA (0.35 miles away)
650-345-4009
[Map](#) | [Directions To](#) | [Directions From](#)

15) Taco Bell

1131 Triton Dr, Foster City, CA (0.35 miles away)
650-572-8038
[Map](#) | [Directions To](#) | [Directions From](#)

16) Armadillo Willy's

2260 Bridgepointe Parkway, San Mateo, CA (0.37 miles away)
650-571-7427
[Map](#) | [Directions To](#) | [Directions From](#)

17) Carls Jr

1140 Triton Dr, San Mateo, CA (0.37 miles away)
650-349-1221
[Map](#) | [Directions To](#) | [Directions From](#)

18) Carl's Jr

1140 Triton Dr, Foster City, CA (0.37 miles away)
650-349-1221
[Map](#) | [Directions To](#) | [Directions From](#)

19) Pizza Hut

1141 Triton Dr, Foster City, CA (0.37 miles away)
650-345-3511
[Map](#) | [Directions To](#) | [Directions From](#)

20) Baja Fresh Mexican Grill

1031 E Hillsdale Blvd, Foster City, CA (0.40 miles away)
650-358-8632
[Map](#) | [Directions To](#) | [Directions From](#)

Pacific Fishery Management Council

Roster



Pacific Fishery Management Council
7700 NE Ambassador Place, Suite 200
Portland, Oregon 97220-1384
Phone: 503-820-2280
Toll Free: 866-806-7204
Fax: 503-820-2299
www.pcouncil.org

June 2006

COUNCIL STAFF

Donald O. McIsaac
Executive Director
Extension 410
Donald.McIsaac@noaa.gov

John C. Coon
Deputy Director
Extension 412
John.Coon@noaa.gov

<u>Name</u>	<u>Title</u>	<u>Extension</u>	<u>Email</u>
Bozzi, Laura	Fishery Management Policy Analyst	408	Laura.Bozzi@noaa.gov
Burner, Mike	Staff Officer: Coastal Pelagic Species and Scientific and Statistical Committee	414	Mike.Burner@noaa.gov
Compton, Carrie	Administrative Specialist	421	Carrie.Compton@noaa.gov
Dahl, Kit	Staff Officer: NEPA and Highly Migratory Species	422	Kit.Dahl@noaa.gov
DeVore, John	Staff Officer: Groundfish	413	John.Devore@noaa.gov
Dorval, Renee	Administrative Specialist	420	Renee.Dorval@noaa.gov
Gilden, Jennifer	Associate Staff Officer: Information, Communications, and Habitat	418	Jennifer.Gilden@noaa.gov
Krause, Sandra	Information Technology Specialist	419	Sandra.Krause@noaa.gov
Porter, Carolyn	Executive Specialist	411	Carolyn.Porter@noaa.gov
Seger, Jim	Staff Officer: Fishery Economics	416	Jim.Seger@noaa.gov
Stauffer, Sara	Administrative Assistant	424	Sara.Stauffer@noaa.gov
Tracy, Chuck	Staff Officer: Salmon and Pacific Halibut	415	Chuck.Tracy@noaa.gov
Wilson, Mary	Fiscal Specialist	408	Mary.Wilson@noaa.gov

LEGAL COUNSEL

Eileen Cooney, Northwest Regional Counsel
National Oceanic and Atmospheric Administration
Office of General Counsel
7600 Sand Point Way NE
BIN C15700
Seattle, WA 98115-6300
206-526-6075

LEGAL COUNSEL

Judson Feder, Southwest Regional Counsel
National Oceanic and Atmospheric Administration
Office of General Counsel
501 West Ocean Boulevard, Suite 4470
Long Beach, CA 90802
562-980-4067



Roster published by the Pacific Fishery Management Council pursuant to National Oceanic and Atmospheric Administration contract number NA05NM4410008

TABLE OF CONTENTS

PACIFIC FISHERY MANAGEMENT COUNCIL	4
ADVISORY BODIES	7
Coastal Pelagic Species Advisory Subpanel	7
Coastal Pelagic Species Management Team.....	9
Enforcement Consultants	11
Groundfish Advisory Subpanel.....	13
Groundfish Allocation Committee	15
Groundfish Management Team.....	17
Habitat Committee	19
Highly Migratory Species Advisory Subpanel.....	21
Highly Migratory Species Management Team	23
Model Evaluation Workgroup.....	25
Salmon Advisory Subpanel.....	27
Salmon Technical Team.....	29
Scientific and Statistical Committee	31
AD HOC COMMITTEES	33
STANDING COMMITTEES	35
REPRESENTATIVES TO OTHER FORUMS	35

PACIFIC FISHERY MANAGEMENT COUNCIL

ALVERSON, MR. ROBERT At-Large	Fishing Vessel Owner's Association 4005 - 20th Ave W, Room 232 Seattle, WA 98199-1290	Telephone: (206) 283-7735 Fax: (206) 283-3341 Email: robertalverson@msn.com
ANDERSON, MR. PHIL State of Washington Official	Special Assistant to the Director Washington Department of Fish and Wildlife 600 Capitol Way N Olympia, WA 98501-1091	Telephone: (360) 902-2720 Fax: (360) 902-2158 Email: anderpma@dfw.wa.gov
1st Designee: Mr. William Tweit	twelitwmt@dfw.wa.gov	(360) 902-2723
BRODRICK, MR. RYAN State of California	Director California Department of Fish and Game PO Box 944209 Sacramento, CA 94244-2090	Telephone: (916) 653-7664 Fax: (916) 653-4645 Email: director@dfg.ca.gov
1st Designee: Ms. Marija Vojkovich	mvojvovich@dfg.ca.gov	(805) 568-1246
CAMPBELL, MR. MCKIE State of Alaska	Commissioner Alaska Department of Fish and Game PO Box 25526 Juneau, AK 99802-5526	Telephone: (907) 465-6141 Fax: (907) 465-2332 Email: mckie_campbell@fishgame.state.ak.us
1st Designee: Mr. Gordy Williams 2nd Designee: Mr. David Bedford	gordy_williams@fishgame.state.ak.us david_bedford@fishgame.state.ak.us	(907) 465-6143 (907) -46-5-41
CEDERGREEN, MR. MARK Washington Obligatory	Westport Charterboat Association PO Box 546 Westport, WA 98595-0546	Telephone: (360) 268-0445 Fax: (360) 268-9285 Email: mcedergreen@olynet.com
ELICKER, MR. ROY State of Oregon	State of Oregon Official Oregon Department of Fish and Wildlife 3406 Cherry Ave NE Salem, OR 97303	Telephone: (503) 947-6000 Fax: (503) 947-6042 Email:
1st Designee: Mr. Curt Melcher 2nd Designee: Dr. Patricia Burke	curt.melcher@state.or.us patty.m.burke@state.or.us	(503) 974-6208 (541) 867-0300
HANSEN, MR. DONALD K. CHAIRMAN At-Large	Dana Wharf Sportfishing 34675 Golden Lantern Dana Point, CA 92629-2990	Telephone: (949) 496-5794 Fax: (949) 496-8212 Email: donald@danawharfsportfishing.com
HANSON, DR. DAVID PARLIAMENTARIAN PSMFC	Pacific States Marine Fisheries Commission 3468 22nd Street NW Hackensack, MN 56452	Telephone: (218) 675-5231 Fax: (503) 595-3232 Email: dave_hanson@psmfc.org
HARP, MR. JIM Tribal Obligatory	Tribal Representative Northwest Indian Fisheries Commission PO Box 57 Amanda Park, WA 98526-0057	Telephone: (360) 580-6131 Fax: (360) 249-2085 Email: Jeharp@aol.com

HOGAN, MR. DAVID U.S. State Department	U.S. Department of State 2201 C St NW, Ste 7820 Washington, DC 20520	Telephone: (202) 647-3941 Fax: (202) 736-7350 Email:
1st Designee: Ms. Amanda Johnson-Miller		(202) 736-7350
HOUCK, RADM RICHARD R. Non-voting U.S. Coast Guard	U.S. Coast Guard 915 Second Ave, Rm 3590 Seattle, WA 98174-1067	Telephone: (206) 220-7090 Fax: (206) 220-7306 Email: richard.r.houck@uscg.mil
1st Designee: LCDR Fran Colantonio 2nd Designee: Mr. Brian Corrigan	francis.colantonio@uscg.mil brian.p.corrigan@uscg.mil	(206) 220-7305 (206) 220-7309
HUFFAKER, MR. STEVE State of Idaho Official	Director Idaho Department of Fish and Game PO Box 25 Boise, ID 83707-0025	Telephone: (208) 334-3771 Fax: (208) 334-4885 Email: shuffaker@idfg.state.id.us
1st Designee: Mr. Jerry Mallet	mallet36@netzero.net	(208) 377-4595
LOHN, MR. ROBERT NMFS - Northwest Region	Regional Administrator National Marine Fisheries Service 7600 Sand Point Way NE, BIN C15700 Seattle, WA 98115-0070	Telephone: (206) 526-6150 Fax: (206) 526-6736 Email: bob.lohn@noaa.gov
1st Designee: Mr. Frank Lockhart 2nd Designee: Dr. Peter Dygert	frank.lockhart@noaa.gov peter.dygert@noaa.gov	(206) 526-6142 (206) 526-6734
MCINNIS, MR. ROD NMFS-Southwest Region	Regional Administrator, Southwest Region National Marine Fisheries Service 501 W Ocean Blvd, Ste 4200 Long Beach, CA 90802-4213	Telephone: (562) 980-4000 Fax: (562) 980-4018 Email: rod.mcinnis@noaa.gov
1st Designee: Mr. Mark Helvey	mark.helvey@noaa.gov	(562) 980-4040
MOORE, MR. ROD At-Large	Executive Director West Coast Seafood Processors Association 1618 SW First St, Ste 318 Portland, OR 97201	Telephone: (503) 227-5076 Fax: (503) 227-0237 Email: seafood@attglobal.net
ORTMANN, MR. DAVE VICE CHAIR Idaho Obligatory	9007 W Forest Shores Coeur D'Alene, ID 83814	Telephone: (208) 765-8733 Fax: Email: haf2fish@verizon.net
ROTH, MR. TIM U.S. Fish and Wildlife Service	Deputy Project Leader U.S. Fish and Wildlife Service 1211 SE Cardinal Ct, Ste 100 Vancouver, WA 98683	Telephone: (360) 604-2500 Fax: (360) 604-2505 Email: timothy_roth@fws.gov
THOMAS, MR. ROGER At-Large	Golden Gate Fishermen's Association PO Box 40 Sausalito, CA 94966-0040	Telephone: (415) 674-3474 Fax: (415) 332-4003 Email:
TICEHURST, MR. DARRELL California Obligatory	25 Joyce Rd Hillsborough, CA 94010	Telephone: (650) 347-5919 Fax: (650) 343-7744 Email: d.ticehurst@comcast.net

WARRENS, MR. FRANK
Oregon Obligatory

President
Frank Warrens Automotive and Marine
Services, Inc.
50 NW 20th Ave
Portland, OR 97209-1903

Telephone: (503) 228-6607
Fax: (503) 228-1383
Email: frank@frankwarrensauto.com

ADVISORY BODIES

COASTAL PELAGIC SPECIES ADVISORY SUBPANEL

ENTICKNAP, BEN Conservation Seat	Pacific Project Manager Oceana 4189 SE Division Street Portland, OR 97202	Telephone: (503) 235-0278 Fax: (503) 230-0903 Email: Benticknap@oceana.org
GUGLIELMO, MR. NEIL California Commercial	F/V Trionfo 1728 Via Pajaro Camarillo, CA 93012	Telephone: (805) 384-9384 Fax: Email: fvtrionfo@aol.com
HOINSKY, MS. TERRY California Commercial	President Fishermen's Union of America 510 North Broad Ave Wilmington, CA 90744-5847	Telephone: (310) 834-2099 Fax: (310) 834-2098 Email:
LAW, MR. EUGENE Oregon Commercial	754 Olalla Rd Toledo, OR 97391	Telephone: (541) 336-2645 Fax: (541) 336-4214 Email: mslaw@harborside.com
MARCHAND, JR., MR. PIERRE Processor	President Jessie's Ilwaco Fish Company PO Box 800 Ilwaco, WA 98624-0800	Telephone: (360) 642-3773 Fax: (360) 642-3362 Email: pierrem@ilwacofish.com
OKONIEWSKI, MR. MIKE Vice Chair Processor	Pacific Seafood 1635 Down River Dr Woodland, WA 98674	Telephone: (360) 225-8553 Fax: Email:
PLESCHNER-STEEL, MS. DIANE Processor	Executive Director California Wetfish Producers Association PO Box 1951 Buellton, CA 93427	Telephone: (805) 693-5430 Fax: (805) 686-9312 Email: dplesch@earthlink.net
ROYAL, MR. JOHN Chair California Commercial	PO Box 1162 San Pedro, CA 90733	Telephone: Fax: Email:
STRASSER, CPT PAUL California Charter/Sport	Owner M.C.I.P. Sportfishing 141 W 22nd Street San Pedro, CA 90731	Telephone: (310) 612-4747 Fax: (310) 514-2452 Email: pstrasser12@comcast.net
ZUANICH, MR. ROBERT P. Washington Commercial	Executive Director Stine Vessel Owners 1900 W Nickerson, Ste 320 Seattle, WA 98119	Telephone: (206) 283-7733 Fax: (206) 283-7795 Email: rpz@psvoa.com

COASTAL PELAGIC SPECIES MANAGEMENT TEAM

CRONE, DR. PAUL Vice Chair NMFS Representative	National Marine Fisheries Service PO Box 271 La Jolla, CA 92038-0271	Telephone: (858) 546-7069 Fax: (858) 546-5653 Email: paul.crone@noaa.gov
CULVER, MR. BRIAN WDFW Representative	Coastal Groundfish Policy Coordinator Washington Department of Fish and Wildlife 48A Devonshire Rd Montesano, WA 98563-9618	Telephone: (360) 249-1205 Fax: (360) 664-0689 Email: culvebnc@dfw.wa.gov
HERRICK, DR. SAMUEL F. Chair NMFS Representative	Industry Economist National Marine Fisheries Service PO Box 271 La Jolla, CA 92037-0271	Telephone: (858) 546-7111 Fax: (858) 546-7003 Email: Sam.Herrick@noaa.gov
HILL, DR. KEVIN NMFS Representative	National Marine Fisheries Service PO Box 271 La Jolla, CA 92038-0271	Telephone: (858) 546-7052 Fax: (858) 546-7003 Email: kevin.hill@noaa.gov
LAUGHLIN, MS. LEEANNE CDFG Representative	Marine Biologist California Department of Fish and Game 4665 Lampson Ave, Ste C Los Alamitos, CA 90720	Telephone: (562) 342-7167 Fax: (562) 342-7139 Email: llaughlin@dfg.ca.gov
MCCRAE, MS. JEAN ODFW Representative	Project Leader Oregon Department of Fish and Wildlife 2040 SE Marine Science Dr Newport, OR 97365	Telephone: (541) 867-4741 Fax: (541) 867-0311 Email: jean.e.mccrae@state.or.us
SWEETNAM, MR. DALE CDFG Representative	Senior Marine Biologist, Supervisor California Department of Fish and Game 8604 La Jolla Shores Dr La Jolla, CA 92037	Telephone: (858) 546-7170 Fax: (858) 546-7116 Email: dale.sweetnam@noaa.gov

ENFORCEMENT CONSULTANTS

BROADMAN, MR. TIM NMFS Southwest Region Representative	National Marine Fisheries Service 1125 16th Street Arcata, CA 95521	Telephone: (707) 826-9247 Fax: Email: tim.broadman@noaa.gov
CENCI, CAPT MIKE Washington Representative	Washington Department of Fish and Wildlife PO Box 307 Nafelle, WA 98638	Telephone: (360) 581-3305 Fax: (360) 642-3967 Email: cencimac@dfw.wa.gov
CLEARY, LT DAVID Chair Oregon Representative	Oregon State Police 400 Public Service Building Salem, OR 97310-0660	Telephone: (503) 378-3725 4308 Fax: (503) 363-5475 Email: dave.cleary@state.or.us
COLANTONIO, LCDR FRAN 13th Coast Guard District	U.S. Coast Guard 915 2nd Ave, Rm 3562 Seattle, WA 98174-1067	Telephone: (206) 220-7305 Fax: (206) 220-7306 Email: francis.colantonio@uscg.mil
EASLEY, MR. OTHA NMFS Southwest Region Representative	Deputy Special Agent in Charge of the Southwest Division NOAA Office for Law Enforcement 501 W Ocean Blvd, Ste 4300 Long Beach, CA 90802	Telephone: (562) 980-4050 Fax: (562) 980-4058 Email: otha.easley@noaa.gov
1st Designee: Mr. Dan Torquemada	dan.torquemada@noaa.gov	(707) 575-6070
FOLEY, MS. NANCY California Representative	Assistant Chief California Department of Fish and Game PO Box 1373 Placerville, CA 95667	Telephone: (916) 996-9003 Fax: Email: nfoley@dfg.ca.gov
1st Designee: CPT Marty Maytorena	mmaytorena@dfg.ca.gov	(562) 342-7190
2nd Designee: Mr. Tony Warrington	twarrington@dfg.ca.gov	(916) 657-2355
GUSTAFSON, LT JACOB 11th Coast Guard District	U.S. Coast Guard Coast Guard Island, Bldg. 15-1 Alameda, CA 94501	Telephone: (510) 437-5392 Fax: (510) 437-3223 Email: jgustafson@d11.uscg.mil
NOMURA, MS. VICKI NMFS Northwest Region	Special Agent in Charge National Marine Fisheries Service 7600 Sand Point Way NE, BIN C15700 Seattle, WA 98115-0070	Telephone: (206) 526-6137 Fax: (206) 526-6528 Email: Vicki.Nomura@noaa.gov
1st Designee: Mr. Dayna Matthews	dayna.matthews@noaa.gov	(360) 753-4409

GROUND FISH ADVISORY SUBPANEL

CURRENT VACANCIES: SPORT FISHERIES AT LARGE SEAT VACANT.

ANCONA, MR. TOM California Trawler	Tommy's Marine Service - F/V Caito Bros, Inc. PO Box 1227 Fort Bragg, CA 95437	Telephone: (707) 964-5423 Fax: (707) 964-7206 Email: ancona@mcn.org
BARRAGER, DR. STEPHEN Conservation Representative	Stanford Law School 2703 Broderick St. San Francisco, CA 94123	Telephone: (650) 504-1578 Fax: (650) 725-8509 Email: barrager@stanford.edu
BUTLER, MR. WAYNE Oregon Charter Boat Operator	Prowler Charters PO Box 674 Bandon, OR 97411	Telephone: (541) 347-9126 Fax: (541) 347-9126 Email: wayne.b1@verizon.net
COHEN, MR. BARRY Processor	Olde Port Fisheries/Del Mar 7121 Fern Flat Rd Aptos, CA 95003	Telephone: (831) 661-0867 Fax: Email: fishmancohen@aol.com
CROWLEY, MR. JOHN Fixed Gear At-Large	Pacific Ocean Fisheries, Inc. 1828 NW 204th St Seattle, WA 98177-2252	Telephone: (206) 542-2017 Fax: (206) 546-9001 Email: pacificseadancer@msn.com
FOSMARK, MS. KATHY Southern Open Access	F/V Seeadler 3059 Sherman Road Pebble Beach, CA 93953-2851	Telephone: (831) 373-5238 Fax: (831) 373-0123 Email: swordstuna@aol.com
GHIO, MR. TOM Acting Chair Fixed Gear At-Large	Ghio Fish Company 112 Gilbert CT Santa Cruz, CA 95065	Telephone: (831) 460-1455 Fax: Email: ghiofish2000@yahoo.com
HENSEL, MR. KENYON Northern Open Access	Hensel's 871 Elk Valley Rd Crescent City, CA 95531-9345	Telephone: (707) 465-6857 Fax: (707) 465-6857 Email: chensel1@earthlink.net
HOLLOWAY, MR. JOHN Sport Fisheries At-Large	Executive Board Secretary Oregon Anglers/Oregon RFA 6823 SW Burlingame Ave Portland, OR 97219-2127	Telephone: (503) 452-7919 Fax: (503) 452-4919 Email: manleydesign@comcast.net
INGLES, MR. ROBERT C. Charter South of Pt Conception	Golden Gate Fisherman's Association PO Box 3728 Hayward, CA 94544	Telephone: (510) 581-2628 Fax: Email: sherry@fishingboat.com
LARKIN, MR. MARION J. Washington Trawler	19737 Trophy Ln Mount Vernon, WA 98274	Telephone: (360) 445-2400 Fax: (360) 445-4049 Email: mjlarlin@clearwire.net

MANN, MS. HEATHER Processor	President Munro Consulting PO Box 176 Siletz, OR 97380	Telephone: (541) 444-2208 Fax: (541) 444-2319 Email: munroconsulting@msn.com
MARTIN, MR. JIM Sport Fisheries At-Large	West Coast Regional Director Recreational Fishing Alliance PO Box 2420 Ft. Bragg, CA 95437	Telephone: (707) 964-8326 Fax: (707) 964-8326 Email: flatland@mcn.org
MYER, MR. DALE At-Sea Processor	Arctic Storm, Inc. 400 N 34th St, Ste 306 Seattle, WA 98103	Telephone: (206) 547-6557 Fax: (206) 547-3165 Email: dmyer@arcticstorm.com
RICHTER, MR. GERRY Fixed Gear At-Large	B & G Seafoods, Inc. 217 Calle Manzanita Santa Barbara, CA 93105	Telephone: (805) 569-3099 Fax: (805) 569-3099 Email: gdrfish@msn.com
SMITH, MR. GORDON Tribal Fisher	F/V Pacific Stalker PO Box 712 Neah Bay, WA 98357	Telephone: (360) 645-2648 Fax: (360) 645-3199 Email: gmsm@centurytel.net
SMOTHERMAN, MR. KELLY E. Oregon Trawler	F/V Miss Mary PO Box 257 Hammond, OR 97121	Telephone: (503) 861-7716 Fax: (503) 861-0764 Email:
STRUNK, MR. DANIEL R. Charter North of Pt Conception	Owner Pierpoint Sportfishing 200 Aquarium Way Long Beach, CA 90802-8140	Telephone: (310) 251-4140 Fax: Email: skippersgirl@msn.com
WEBER, MR. RHETT Washington Charter Boat Operator	F/V Slammer Fishing PO Box 2511 Westport, WA 98595-2511	Telephone: (360) 268-6229 Fax: Email: slammer@techline.com

GROUND FISH ALLOCATION COMMITTEE

ANDERSON, MR. PHIL
Washington Representative

Special Assistant to the Director
Washington Department of Fish and
Wildlife
600 Capitol Way N
Olympia, WA 98501-1091

Telephone: (360) 902-2720
Fax: (360) 902-2158
Email: anderpma@dfw.wa.gov

COONEY, MS. EILEEN
NOAA General Counsel

Northwest Regional Counsel
NOAA
7600 Sand Point Way NE, BIN C15700
Seattle, WA 98115-6300

Telephone: (206) 526-6075
Fax: (206) 526-6542
Email: eileen.cooney@noaa.gov

HANSEN, MR. DONALD K.
Council Chair

Dana Wharf Sportfishing
34675 Golden Lantern
Dana Point, CA 92629-2990

Telephone: (949) 496-5794
Fax: (949) 496-8212
Email: donald@danawharfsportfishing.com

HANSON, DR. DAVID
Pacific States Marine Fisheries
Commission

Pacific States Marine Fisheries
Commission
3468 22nd Street NW
Hackensack, MN 56452

Telephone: (218) 675-5231
Fax: (503) 595-3232
Email: dave_hanson@psmfc.org

LOCKHART, MR. FRANK
NMFS Representative

National Marine Fisheries Service
7600 Sand Point Way, NE Bin C15700
Seattle, WA 98115-0070

Telephone: (206) 526-6142
Fax: (206) 526-6736
Email: frank.lockhart@noaa.gov

MELCHER, MR. CURT
Oregon Representative

Statewide Salmon Fishery Manager
Oregon Department of Fish and Wildlife
3406 Cherry Avenue NE
Salem, OR 97303

Telephone: (503) 974-6208
Fax: (503) 947-6202
Email: curt.melcher@state.or.us

VOJKOVICH, MS. MARIJA
California Representative

Offshore Ecosystem Coordinator
California Department of Fish and Game
1933 Cliff Dr, Ste 9
Santa Barbara, CA 93109-1520

Telephone: (805) 568-1246
Fax: (805) 568-1235
Email: mvojkovich@dfg.ca.gov

**GROUND FISH ALLOCATION COMMITTEE ADVISORY MEMBERS FOR
INDIVIDUAL FISHING QUOTA CONSIDERATIONS (NON-VOTING)**

FOSMARK, MS. KATHY Open Access	F/V Seeadler 3059 Sherman Road Pebble Beach, CA 93953-2851	Telephone: (831) 373-5238 Fax: (831) 373-0123 Email: swordstuna@aol.com
HENEMAN, MR. BURR Conservation Representative	Director Commenweal 35 Horseshoe Hill Rd Bolin, CA 94924-9712	Telephone: (415) 868-1460 Fax: (415) 956-7441 Email: burr@igc.org
LEIPZIG, MR. PETER Non-Whiting Trawl	Executive Director Fisherman's Marketing Association 320 Second St, Ste 2B Eureka, CA 95501-0457	Telephone: (707) 442-3789 Fax: (707) 442-9166 Email: pete@trawl.org
LONGO EDER, MS. MICHELE Fixed Gear	Michele Longo Eder Attorney at Law, LLC PO Box 1530 Newport, OR 97365	Telephone: (541) 265-3337 Fax: (541) 265-6633 Email: michele@michelelongoeder.com
MANN, MS. HEATHER Processor	President Munro Consulting PO Box 176 Siletz, OR 97380	Telephone: (541) 444-2208 Fax: (541) 444-2319 Email: munroconsulting@msn.com
MYER, MR. DALE Whiting Trawl	Arctic Storm, Inc. 400 N 34th St, Ste 306 Seattle, WA 98103	Telephone: (206) 547-6557 Fax: (206) 547-3165 Email: dmyer@arcticstorm.com
OSBORN, MR. ROBERT Recreational Fisher	Fishery Consultant United Anglers of Southern California PO Box 385 Surfside, CA 90743	Telephone: (714) 840-0227 Fax: (714) 840-3146 Email: bob@unitedanglers.com

GROUND FISH MANAGEMENT TEAM

ASELTINE-NEILSON, MS. DEBORAH CDFG Representative	California Department of Fish and Game 8604 La Jolla Shores Dr La Jolla, CA 92037	Telephone: (858) 546-7150 Fax: (858) 546-7003 Email: daseltine@dfg.ca.gov
ASHCRAFT, MS. SUSAN E. Chair CDFG Representative	Associate Marine Biologist California Department of Fish and Game 350 Harbor Blvd Belmont, CA 94110	Telephone: (650) 631-6786 Fax: (650) 631-6793 Email: sashcraft@dfg.ca.gov
BURDEN, MR. MERRICK Vice Chair NMFS Northwest Region	Economist National Marine Fisheries Service 7600 Sand Point Way, Bldg 1, FNWR/2 Seattle, WA 98115	Telephone: (206) 526-4656 Fax: (206) 526-6736 Email: merrick.burden@noaa.gov
CULVER, MS. MICHELE K. WDFW Representative	Marine Resources Policy Coordinator Washington Department of Fish and Wildlife 48 Devonshire Road Montesano, WA 98563	Telephone: (360) 249-1211 Fax: (360) 664-0689 Email: culvemkc@dfw.wa.gov
CULVER, MR. BRIAN WDFW Representative	Coastal Groundfish Policy Coordinator Washington Department of Fish and Wildlife 48A Devonshire Rd Montesano, WA 98563-9618	Telephone: (360) 249-1205 Fax: (360) 664-0689 Email: culvebnc@dfw.wa.gov
FIELD, DR. JOHN NMFS Southwest Fisheries Science Center	Research Fishery Biologist NMFS Southwest Fisheries Science Center 110 Schaffer Rd Santa Cruz, CA 95060	Telephone: (831) 420-3907 Fax: (831) 420-3977 Email: john.field@noaa.gov
JONES, MR. ROBERT F. Tribal Scientist	Marine Fish Biologist Northwest Indian Fisheries Commission PO Box 1029 Forks, WA 98331	Telephone: (360) 374-5501 Fax: (360) 374-5592 Email: rjones@nwifc.org
RENKO, MS. BECKY NMFS Northwest Region	National Marine Fisheries Service 7600 Sand Point Way NE, BIN C15700 Seattle, WA 98115-0070	Telephone: (206) 526-6110 Fax: (206) 526-6736 Email: becky.renko@noaa.gov
ROGERS-KIRCHNER, MS. GWAY ODFW Representative	Assistant Project Leader Oregon Department of Fish and Wildlife 2040 SE Marine Science Dr Newport, OR 97365	Telephone: (541) 867-0300 271 Fax: (541) 867-0311 Email: gway.r.kirchner@state.or.us
SAELENS, MR. MARK ODFW Representative	Oregon Department of Fish and Wildlife 2040 SE Marine Science Dr Newport, OR 97365-5294	Telephone: (541) 867-0300 251 Fax: (541) 867-0311 Email: mark.r.saelens@state.or.us

WALLACE, MR. JOHN
NMFS NWFSC Representative

National Marine Fisheries Service
2725 Montlake Blvd. East
Seattle, WA 98112

Telephone: (206) 860-3456
Fax: (206) 860-3394
Email: john.wallace@noaa.gov

HABITAT COMMITTEE

CURRENT VACANCIES: ONE CDFG SEAT IS CURRENTLY VACANT.

BEDFORD, MR. DENNIS CDFG Representative (1 st Designee)	Associate Marine Biologist California Department of Fish and Game 7665 Lampson Ave, Ste C Los Alamitos, CA 90720	Telephone: (562) 342-7172 Fax: (562) 342-7193 Email: dbedford@dfg.ca.gov
CHESNEY, MR. BRYANT NMFS Representative 1st Designee: Ms. Korie Schaeffer	National Marine Fisheries Service 501 W Ocean Blvd, Ste 4200 Long Beach, CA 90802 korie.schaeffer@noaa.gov	Telephone: (562) 980-4037 Fax: (562) 980-4092 Email: bryant.chesney@noaa.gov (707) 575-6087
ELLIS, MR. STUART Chair Northwest Tribal Representative	Fisheries Scientist Columbia River Inter-Tribal Fish Commission 729 NE Oregon, Ste 200 Portland, OR 97232-2175	Telephone: (503) 238-0667 Fax: (503) 235-4228 Email: ells@critfc.org
HAMILTON, MS. LIZ Sport Fisheries At-Large	Executive Director Northwest Sportfishing Industry Association PO Box 4 Oregon City, OR 97045-0004	Telephone: (503) 631-8859 Fax: (503) 631-3887 Email: nsializ@aol.com
HEIKKILA, MR. PAUL Commercial Fisher	Oregon State University 631 Alder St Myrtle Point, OR 97458	Telephone: (541) 572-5263 288 Fax: (541) 572-5963 Email: paul.heikkila@oregonstate.edu
HILLEMEIER, MR. DAVE California Tribal Representative	Fisheries Program Manager Yurok Tribe PO Box 1027 Klamath, CA 95548	Telephone: (707) 482-1350 315 Fax: (707) 482-1377 Email: naypooie@northcoast.com
MCGONIGAL, MR. HUFF National Marine Sanctuary Representative	Monterey Bay National Marine Sanctuary 299 Foam St, Ste D Monterey, CA 93940	Telephone: (831) 647-4254 Fax: (831) 647-4250 Email: huff.mcgonigal@noaa.gov
OSMOND, MR. MICHAEL Conservation Representative	Senior Program Officer World Wildlife Fund 171 Forest Ave Palo Alto, CA 94301	Telephone: (650) 323-3506 Fax: (650) 325-2236 Email:
PETROSKY, DR. CHARLIE IDFG Representative	Fishery Program Coordinator Idaho Department of Fish and Game 600 S. Walnut Boise, ID 83707	Telephone: (208) 334-3791 Fax: (208) 334-2114 Email: cpetrosky@idfg.idaho.gov

RECHT, MS. FRAN
PSMFC Representative

Habitat Program Project Manager
Pacific States Marine Fisheries
Commission
PO Box 221
Depoe Bay, OR 97341-0221

Telephone: (541) 765-2229
Fax: (541) 765-2229
Email: franrecht@centurytel.net

ROTH, MR. TIM
USFW Representative

Deputy Project Leader
U.S. Fish and Wildlife Service
1211 SE Cardinal Ct, Ste 100
Vancouver, WA 98683

Telephone: (360) 604-2500
Fax: (360) 604-2505
Email: timothy_roth@fws.gov

SCOTT, MS. TERESA
WDFW Representative

Natural Resource Policy Analyst
Washington Department of Fish and
Wildlife
MS 43136, 600 Capitol Way N
Olympia, WA 98501-1091

Telephone: (360) 902-2713
Fax: (360) 902-2158
Email: scotttls@dfw.wa.gov

WAKEFIELD, DR. WALDO
NMFS NWFSFC Representative

National Marine Fisheries Service
2032 SE OSU Dr
Newport, OR 97365

Telephone: (541) 867-0542
Fax: (541) 867-0505
Email: waldo.wakefield@noaa.gov

WEEKS, DR. HAL
ODFW Representative

Marine Habitat Project Leader
Oregon Dept of Fish and Wildlife
2040 SE Marine Science Drive
Newport, OR 97365

Telephone: (541) 867-0300 279
Fax: (541) 867-0311
Email: Hal.Weeks@state.or.us

1st Designee: Ms. Arlene Merems

arlene.r.merems@state.or.us

(541) 867-0300

WHITE, MR. SEAN
Public At-Large

Principal Environmental Specialist
Sonoma County Water Agency
PO Box 11628
Santa Rosa, CA 95406

Telephone: (707) 547-1908
Fax: (707) 524-3782
Email: seanw@scwa.ca.gov

HIGHLY MIGRATORY SPECIES ADVISORY SUBPANEL

CURRENT VACANCIES: ONE NORTHERN PROCESSOR SEAT IS CURRENTLY VACANT.

AUGELLO, MR. ANGELO Southern Processor	Western Fish Company 740 South Seaside Ave Terminal Island, CA 90731	Telephone: (310) 519-0254 Fax: (310) 519-3707 Email: westernfish740@aol.com
DUPUY, MR. PETE Commercial At-Large	Ocean Pacific Sea Food 18212 Rosita St Tarzana, CA 91356	Telephone: (818) 343-9927 Fax: (818) 881-5003 Email: lapazkd@aol.com
FELANDO, MR. AUGUST Commercial Purse Seine	870 San Antonio Pl San Diego, CA 92106	Telephone: (619) 223-7654 Fax: (619) 223-7958 Email: tunaug@compuserve.com
FLETCHER, MR. ROBERT Charter Boat Operator	President Sportfishing Association of California 1084 Bangor St San Diego, CA 92106	Telephone: (619) 226-6455 Fax: (619) 226-0175 Email: dart@sacemup.org
FOSMARK, MR. STEVEN Gillnet Fisheries Representative	Owner/Operator F/V Seeadler 3059 Sherman Rd Pebble Beach, CA 93953	Telephone: (831) 373-5238 Fax: (831) 373-0123 Email: fvseeadler@aol.com
FRICKE, MR. DOUGLAS Vice-chair Commercial At-Large	Boat Seafoods 110 Valley Rd Hoquiam, WA 98550	Telephone: (360) 533-2069 Fax: (360) 538-0466 Email: fricked@techline.com
HEIKKILA, MR. WAYNE Chair Commercial Troller	Executive Director Western Fishboat Owner's Association PO Box 992723 Redding, CA 96099	Telephone: (530) 229-1097 Fax: (530) 229-0973 Email: wfoa@charter.net
McHALE, MS. TANA Public At-Large	25 NW 23rd Pl, Ste 6, PMB 394 Portland, OR 97210-5599	Telephone: (503) 820-2280 Fax: Email:
NELSON, DR. RUSSELL S. Recreational At-Large	Fishery Scientist Nelson Resources Consulting, Inc. 765 NW 35th St Oakland Park, FL 33309	Telephone: (561) 449-9637 Fax: Email: DrRSNNC@aol.com
OSBORN, MR. ROBERT Private Recreational	Fishery Consultant United Anglers of Southern California PO Box 385 Surfside, CA 90743	Telephone: (714) 840-0227 Fax: (714) 840-3146 Email: bob@unitedanglers.com
SUTTON, MR. BILL Commercial At-Large	F/V Aurelia 876 S Rice Rd Ojai, CA 93023	Telephone: (805) 646-9685 Fax: (805) 646-1321 Email:

WING, MS. KATE
Conservation Representative

Ocean Policy Analyst
Natural Resources Defense Council
111 Sutter St, 20th Fl
San Francisco, CA 94104

Telephone: (415) 875-6100
Fax: (415) 875-6161
Email: kwing@nrdc.org

HIGHLY MIGRATORY SPECIES MANAGEMENT TEAM

CULVER, MS. MICHELE K. Co-chair WDFW Representative	Marine Resources Policy Coordinator Washington Department of Fish and Wildlife 48 Devonshire Road Montesano, WA 98563	Telephone: (360) 249-1211 Fax: (360) 664-0689 Email: culvemkc@dfw.wa.gov
HEBERER, MR. CRAIG NMFS Southwest Region	National Marine Fisheries Service 501 W Ocean Blvd, Ste 4200 Long Beach, CA 90802-4213	Telephone: (562) 980-4034 Fax: (562) 980-4047 Email: craig.heberer@noaa.gov
KOHIN, DR. SUZANNE NMFS Southwest Fisheries Science Center	Research Fishery Biologist National Marine Fisheries Service 8604 La Jolla Shores Dr La Jolla, CA 92038-1508	Telephone: (858) 546-7104 Fax: (858) 546-7003 Email: suzanne.kohin@noaa.gov
MCCRAE, MS. JEAN ODFW Representative	Project Leader Oregon Department of Fish and Wildlife 2040 SE Marine Science Dr Newport, OR 97365	Telephone: (541) 867-4741 Fax: (541) 867-0311 Email: jean.e.mccrae@state.or.us
PETRAS, MS. ELIZABETH NMFS Southwest Region	Liaison Officer National Marine Fisheries Service 501 West Ocean Blvd, Ste 4200 Long Beach, CA 90802-4213	Telephone: (562) 980-3238 Fax: (562) 980-4027 Email: elizabeth.petras@noaa.gov
SQUIRES, DR. DALE Co-Chair NMFS Southwest Fisheries Science Center	National Marine Fisheries Service PO Box 271 La Jolla, CA 92037-0271	Telephone: (858) 546-7113 Fax: (858) 546-7003 Email: Dale.Squires@noaa.gov
STOHS, DR. STEPHEN NMFS Southwest Fisheries Science Center	National Marine Fisheries Service PO BOX 271 La Jolla, CA 92037-0271	Telephone: (858) 546-7084 Fax: (858) 546-7003 Email: Stephen.Stohs@noaa.gov
WERTZ, MR. STEVE CDFG Representative	California Department of Fish and Game 4665 Lampson Ave, Ste C Los Alamitos, CA 90720	Telephone: (562) 342-7184 Fax: (562) 342-7139 Email: swertz@dfg.ca.gov

MODEL EVALUATION WORKGROUP

CURRENT VACANCIES: ONE ODFW SEAT IS CURRENTLY VACANT.

CONRAD, MR. ROBERT H. Scientific and Statistical Committee	Quantitative Services Manager Northwest Indian Fisheries Commission 6730 Martin Way E Olympia, WA 98516-5540	Telephone: (360) 528-4345 Fax: (360) 753-8659 Email: bconrad@nwifc.org
GROVER, MR. ALLEN CDFG Representative	Marine Biologist California Department of Fish and Game 475 Aviation Blvd, Ste 130 Santa Rosa, CA 95403	Telephone: (707) 576-2860 Fax: (707) 576-7132 Email: agrover@dfg.ca.gov
LAVOY, MR. LARRIE Vice-chair WDFW Representative	Washington Department of Fish and Wildlife 600 Capitol Way N Olympia, WA 98501-1091	Telephone: (360) 902-2841 Fax: (360) 902-2949 Email: lavoylwl@dfw.wa.gov
1st Designee: Mr. Jim Packer	packejfp@dfw.wa.gov	(360) 902-2754
RANKIS, MR. ANDY Chair Northwest Indian Fisheries Commission	Quantitative Fisheries Biologist Northwest Indian Fisheries Commission 6730 Martin Way E Olympia, WA 98516	Telephone: (360) 438-1181 322 Fax: (360) 753-8659 Email: arankis@nwifc.org
SHARMA, MR. RISHI Columbia River Inter-Tribal Fish Commission	Bio-Metrician Columbia River Inter-Tribal Fish Commission 729 NE Oregon St, Ste 200 Portland, OR 97232	Telephone: (503) 238-0667 Fax: (503) 235-4228 Email: shar@critfc.org
SIMMONS, MR. DELL NMFS Representative	National Marine Fisheries Service 510 Desmond Dr SE, Ste 103 Lacey, WA 98503	Telephone: (360) 753-9580 Fax: (360) 753-9517 Email: dell.simmons@noaa.gov
YUEN, MR. HENRY USFW Representative	Fishery Biologist U.S. Fish and Wildlife Service 1211 SE Cardinal Ct, Ste 100 Vancouver, WA 98683	Telephone: (360) 604-2500 Fax: (360) 604-2505 Email: henry_yuen@fws.gov

SALMON ADVISORY SUBPANEL

CURRENT VACANCIES: ONE OREGON TROLLER SEAT IS CURRENTLY VACANT.

FRANK, MR. CALVIN S. Washington Coastal Tribal Fisherman	F/V Cross Winds PO Box 373 Bay Center, WA 98527	Telephone: (360) 942-7809 Fax: Email:
MACLEAN, MR. DUNCAN California Troller	Owner F/V Barbara Faye PO Box 1942 El Granada, CA 94018-1942	Telephone: (650) 726-1373 Fax: (650) 712-8744 Email: b-faye@pacbell.net
MARTIN, MR. KENT Gillnet Fisheries Representative	PO Box 83 Skamokawa, WA 98647	Telephone: (360) 795-3920 Fax: Email: imartin@tdn.com
OLSON, MR. JIM Washington Troller	F/V Cynthia T PO Box 586 Auburn, WA 98071-0586	Telephone: (253) 833-8739 Fax: (425) 644-6107 Email:
ORCUTT, MR. MIKE California Tribal Representative	Hoopla Valley Tribe PO Box 417 Hoopla, CA 95546-0417	Telephone: (530) 625-4267 Fax: (530) 625-4995 Email: director@pcweb.net
REINHOLDT, MR. GERALD K. Processor	Reinholdt Fisheries 62313 S Canaan Rd St. Helens, OR 97051-9117	Telephone: (503) 397-3369 Fax: (503) 397-3369 Email:
SMITH, MR. BUTCH Vice-chair Washington Charter Boat Operator	Co-Ho Charters PO Box 268 Ilwaco, WA 98624	Telephone: (360) 642-3333 Fax: (360) 642-3758 Email: coho@willapabay.org
SORENSEN, MR. MIKE Oregon Charter Boat Operator	603 Camp 12 Lp Toledo, OR 97391	Telephone: (541) 444-2552 Fax: Email: missraven@actionnet.net
STONE, MR. CRAIG California Sport Fisher	Emeryville Sportfishing 3310 Powell St Emeryville, CA 94608	Telephone: (510) 654-6040 Fax: (510) 654-2106 Email: emvlsport@aol.com
STRICKLAND, MR. ROBERT California Sport Fisher	President United Anglers of California 15572 Woodard Rd San Jose, CA 95124	Telephone: (408) 371-0331 Fax: (408) 371-9459 Email: bobstrickland@unitedanglers.org
TUGGLE, MR. JIM Conservation Representative	3092 Hampton Dr SW Tumwater, WA 98512	Telephone: Fax: Email: tugstours@comcast.net

WATROUS, MR. STEVE
Washington Sport Fisher

Garonaire, Inc.
2515 Kauffman Ave
Vancouver, WA 98660

Telephone: (360) 696-1604
Fax: (360) 695-6031
Email: branchofic@aol.com

WELSH, DR. TOM
Idaho Sport Fisher

419 E Highland View Dr
Boise, ID 83628

Telephone: (480) 488-3926
Fax:
Email: mwelsh9538@aol.com

WELTER, MR. JIM
Oregon Sport Fisher

404 Pacific Ave
Brookings, OR 97415

Telephone: (541) 469-7044
Fax:
Email: jswltr@verizon.net

SALMON TECHNICAL TEAM

FOSTER, MR. CRAIG ODFW Representative	Fish Management Biologist Oregon Department of Fish and Wildlife 17330 SE Evelyn St Clackamas, OR 97015	Telephone: (503) 657-2000 248 Fax: (503) 657-2095 Email: craig.a.foster@state.or.us
GROVER, MR. ALLEN Vice-chair CDFG Representative	Marine Biologist California Department of Fish and Game 475 Aviation Blvd, Ste 130 Santa Rosa, CA 95403	Telephone: (707) 576-2860 Fax: (707) 576-7132 Email: agrover@dfg.ca.gov
1st Designee: Ms. Melodie Palmer-Zwahlen	mpalmer@dfg.ca.gov	(707) 576-2870
KOPE, DR. ROBERT NMFS Representative	Research Fishery Biologist National Marine Fisheries Service 2725 Montlake Blvd E Seattle, WA 98112-2097	Telephone: (206) 860-3374 Fax: Email: robert.kope@noaa.gov
MILWARD, MR. DOUG WDFW Representative	Washington Department of Fish and Wildlife 600 Capitol Way N Olympia, WA 98501-1091	Telephone: (360) 902-2739 Fax: (360) 902-2949 Email: milwadam@dfw.wa.gov
MOHR, MR. MICHAEL S. NMFS Representative	National Marine Fisheries Service 110 Shaffer Rd Santa Cruz, CA 95060	Telephone: (831) 420-3922 Fax: (831) 420-3977 Email: michael.mohr@noaa.gov
MORISHIMA, DR. GARY Tribal Representative	3010 - 77th SE, Ste 104 Mercer Island, WA 98040-2829	Telephone: (206) 236-1406 Fax: (206) 236-6842 Email: morikog@aol.com
SIMMONS, MR. DELL Chair NMFS Representative	National Marine Fisheries Service 510 Desmond Dr SE, Ste 103 Lacey, WA 98503	Telephone: (360) 753-9580 Fax: (360) 753-9517 Email: dell.simmons@noaa.gov
YUEN, MR. HENRY USFW Representative	Fishery Biologist U.S. Fish and Wildlife Service 1211 SE Cardinal Ct, Ste 100 Vancouver, WA 98683	Telephone: (360) 604-2500 Fax: (360) 604-2505 Email: henry_yuen@fws.gov

SCIENTIFIC AND STATISTICAL COMMITTEE

BARNES, MR. J. THOMAS CDFG Representative	Senior Biologist California Department of Fish and Game 8604 La Jolla Shores Dr La Jolla, CA 92037-0271	Telephone: (858) 546-7167 Fax: (858) 546-7003 Email: tombarnes@ucsd.edu
BERKELEY, MR. STEVEN A. At-Large	University of California, Santa Cruz 100 Shaffer Rd Santa Cruz, CA 95060	Telephone: (831) 459-3530 Fax: (831) 459-3383 Email: stevenab@cats.ucsc.edu
BYRNE, MR. ALAN IDFG Representative	Senior Fisheries Research Biologist Idaho Department of Fish and Game 1414 E Locust Lane Nampa, ID 83686-8451	Telephone: (208) 465-8404 Fax: (208) 465-8434 Email: abyrne@idfg.state.id.us
CONRAD, MR. ROBERT H. Chair Tribal Agency	Quantitative Services Manager Northwest Indian Fisheries Commission 6730 Martin Way E Olympia, WA 98516-5540	Telephone: (360) 528-4345 Fax: (360) 753-8659 Email: bconrad@nwifc.org
CONSER, DR. RAMON J. At-Large	Fisheries Research Biologist NOAA/NMFS 8604 La Jolla Shores Dr La Jolla, CA 92037-0271	Telephone: (858) 546-5688 Fax: (858) 546-5656 Email: ray.conser@noaa.gov
DALTON, DR. MICHAEL At-Large	California State University, Monterey Bay 100 Campus Center Seaside, CA 93955-8001	Telephone: (831) 582-3024 Fax: (831) 582-4688 Email: michael_dalton@csumb.edu
DORN, DR. MARTIN NMFS Alaska Fisheries Science Center	National Marine Fisheries Service 7600 Sand Point Way NE, BIN C15700 Seattle, WA 98115-0070	Telephone: (206) 526-6548 Fax: (206) 525-6723 Email: martin.dorn@noaa.gov
HAMEL, DR. OWEN NMFS Northwest Fisheries Science Center	Research Fisheries Biologist National Marine Fisheries Service 2725 Montlake Blvd E Seattle, WA 98112	Telephone: (206) 860-3481 Fax: Email: owen.hamel@noaa.gov
HILL, DR. KEVIN NMFS Southwest Fisheries Science Center	National Marine Fisheries Service PO Box 271 La Jolla, CA 92038-0271	Telephone: (858) 546-7052 Fax: (858) 546-7003 Email: kevin.hill@noaa.gov
JAGIELO, MR. TOM WDFW Representative	Research Scientist Washington Department of Fish and Wildlife PO Box 93 Copalis Beach, WA 98535	Telephone: (360) 791-9089 Fax: Email: jagiethj@dfw.wa.gov

LAWSON, DR. PETER
NMFS Northwest Fisheries Science
Center

National Marine Fisheries Service
2030 S Marine Science Dr
Newport, OR 97365-5296

Telephone: (541) 867-0430
Fax: (541) 867-0380
Email: Peter.W.Lawson@noaa.gov

PUNT, DR. ANDRE
At-Large

Research Associate Professor
University of Washington
Box 355020
Seattle, WA 98195-5020

Telephone: (206) 221-6319
Fax: (206) 685-7471
Email: aepunt@u.washington.edu

RADTKE, DR. HANS
At-Large

PO Box 244
Yachats, OR 97498

Telephone: (541) 547-3087
Fax: (541) 547-3087
Email: hradtke@oregonvos.net

RALSTON, DR. STEPHEN
Vice-Chair
At-Large

Fishery Biologist (Research)
National Marine Fisheries Service
110 Shaffer Rd
Santa Cruz, CA 95060

Telephone: (831) 420-3949
Fax: (831) 420-3977
Email: steve.ralston@noaa.gov

SAMPSON, DR. DAVID
ODFW Representative

Professor of Fisheries
Oregon State University
2030 SE Marine Science Dr
Newport, OR 97365-5296

Telephone: (541) 867-0386
Fax: (541) 867-0345
Email: david.sampson@oregonstate.edu

THOMSON, MS. CINDY
NMFS Southwest Fisheries Science
Center

National Marine Fisheries Service
110 Shaffer Rd
Santa Cruz, CA 95060

Telephone: (831) 420-3911
Fax: (831) 420-3977
Email: Cindy.Thomson@noaa.gov

Ad Hoc COMMITTEES

FULL RETENTION COMMITTEE

LT DAVID CLEARY
MS. EILEEN COONEY
MR. BRIAN CULVER
DR. JAMES HASTIE
MR. ROD MOORE

GROUND FISH STRATEGIC PLAN IMPLEMENTATION OVERSIGHT COMMITTEE

MR. ROBERT ALVERSON
MR. PHIL ANDERSON
MR. DONALD K. HANSEN
DR. DAVID HANSON
MR. FRANK LOCKHART
MR. CURT MELCHER
MS. MARIJA VOJKOVICH

GROUND FISH ESSENTIAL FISH HABITAT ENVIRONMENTAL IMPACT STATEMENT

OVERSIGHT COMMITTEE

MR. PHIL ANDERSON
MR. TOM GHIO
MR. PETER HUHTALA
MR. CURT MELCHER
MS. MARIJA VOJKOVICH

GROUND FISH TRAWL INDIVIDUAL QUOTA COMMITTEE

MR. STEVE BODNAR
MR. JAY BORNSTEIN
MR. FRANK DULCICH
MR. CHRIS GARBRICK
MS. GINNY GOBLIRSCH
DR. DAVID HANSON
MR. ALAN HIGHTOWER
MR. JAN JACOBS
MR. DAVID JINCKS
MR. STEVE JONER
MR. MARION J. LARKIN
MR. PETER LEIPZIG
MS. DOROTHY LOWMAN
MR. DAYNA MATTHEWS
MR. DALE MYER
MR. BRAD PETTINGER
MR. JOE PLESHA
DR. RICHARD YOUNG

GROUND FISH HABITAT TECHNICAL REVIEW COMMITTEE

DR. ROD FUJITA
DR. CHRIS GOLDFINGER
MR. GARY GREEN
MR. MARION J. LARKIN
MR. SCOTT MCMULLEN
DR. MARK POWELL
DR. WALDO WAKEFIELD
MS. MARY YOKLAVICH

GROUND FISH INFORMATION POLICY COMMITTEE

MR. PHIL ANDERSON
DR. ELIZABETH CLARKE
MR. DONALD K. HANSEN
MR. FRANK LOCKHART
MR. CURT MELCHER
MS. MARIA VOJKOVICH

MARINE PROTECTED AREAS COMMITTEE POLICY MEMBERS (VOTING)

MR. PHIL ANDERSON
MR. DONALD K. HANSEN
MR. CURT MELCHER

ADVISORY MEMBERS (NON-VOTING)

MS. EILEEN COONEY
MS. KATHY FOSMARK
MR. ROBERT FLETCHER
MR. DUNCAN MACLEAN
DR. DONALD MCISAAC
MS. DIANE PLESCHNER-STEELE
MS. CINDY THOMSON

GROUND FISH MULTI-YEAR MANAGEMENT COMMITTEE

MR. PHIL ANDERSON
MS. EILEEN COONEY
DR. JAMES HASTIE
MR. FRANK LOCKHART
MR. CURT MELCHER

**OBSERVER PROGRAM IMPLEMENTATION
COMMITTEE**

MR. J. THOMAS BARNES
MR. WILLIAM BARSS
MR. BRIAN CULVER
DR. DAVID HANSON
MS. BECKY RENKO
MR. MARK SAELENS
MS. TERESA TURK

**TRAWL INDIVIDUAL QUOTA ANALYTICAL
TEAM**

DR. CARL LIAN
MS. KATHRYN QUIGLEY
MS. SUZANNE RUSSELL
MR. TERRY TILLMAN

**TRAWL INDIVIDUAL QUOTA ENFORCEMENT
GROUP**

CAPT MIKE CENCI
LT DAVID CLEARY
MR. BRIAN CORRIGAN
MR. OTHA EASLEY
MR. FRANK LOCKHART
MR. DAYNA MATTHEWS
MR. TONY WARRENTON

**TRAWL INDIVIDUAL QUOTA INDEPENDENT
EXPERTS PANEL**

MR. CHRISTOPHER M. DEWEES
DR. ROBERT FRANCIS
DR. SUSAN HANNA
DR. DAN HUPPERT
DR. GILBERT SYLVIA

**COASTAL PELAGIC SPECIES TRIBAL
ALLOCATION COMMITTEE**

MR. PHIL ANDERSON
DR. PATRICIA BURKE
MR. DONALD K. HANSEN
MR. JIM HARP
MR. FRANK LOCKHART/ MR. MARK HELVEY
MS. MARIJA VOJKOVICH

**HIGHLY MIGRATORY SPECIES MANAGEMENT
COMMITTEE**

MR. PHIL ANDERSON
MR. DONALD K. HANSEN
MR. MARK HELVEY
MS. MARIJA VOJKOVICH

VESSEL MONITORING SYSTEM COMMITTEE

MR. JOSEPH ALBERT
MR. MARK CEDERGREEN
CAPT MIKE CENCI
MR. BRIAN CORRIGAN
MR. JOHN CROWLEY
MS. KATHY FOSMARK
MR. TOM GHIO
LT JACOB GUSTAFSON
MR. DONALD K. HANSEN
MR. KENYON HENSEL
MR. MARION J. LARKIN
MS. HEATHER MANN
MR. DAYNA MATTHEWS
MS. BECKY RENKO

**GROUNDFISH STRATEGIC PLAN
IMPLEMENTATION OVERSIGHT COMMITTEE
OPEN ACCESS CONVERSION SUBCOMMITTEE**

MR. PHIL ANDERSON
MS. EILEEN COONEY
MS. KATHY FOSMARK
MR. DOUGLAS FRICKE
DR. JAMES HASTIE
MR. KENYON HENSEL
MR. STEVE JONER
MR. FRANK LOCKHART
MR. MIKE MCCORKLE
MR. CURT MELCHER
MR. ROD MOORE
MR. BRIAN PETERSEN
MS. MARIJA VOJKOVICH

SALMON AMENDMENT COMMITTEE

MR. RAY BEAMESDERFER
MR. L.B. BOYDSTUN
MR. MIKE BURNER
MR. ERIC CHAVEZ
DR. KIT DAHL
DR. PETER DYGERT
MR. CRAIG FOSTER
MR. ALLEN GROVER
MR. DAVE HILLEMEIER
MR. GEORGE KAUTSKY
DR. ROBERT KOPE
MR. LARRIE LAVOY
DR. PETER LAWSON
MR. DUNCAN MACLEAN
MR. MICHAEL MOHR
DR. GARY MORISHIMA
MS. CORINNE PINKERTON
MR. JIM SEGER
MS. CINDY THOMSON
MR. CHUCK TRACY
MR. DAN WOLFORD

STANDING COMMITTEES

BUDGET COMMITTEE

CHAIRMAN: MR. JIM HARP
MR. DONALD K. HANSEN
DR. DAVID HANSON
MR. JERRY MALLET
MR. FRANK LOCKHART/MR. MARK HELVEY

LEGISLATIVE COMMITTEE

CHAIRMAN: DR. DAVID HANSON
MR. ROBERT ALVERSON
MR. DONALD K. HANSEN
MR. ROD MOORE
MR. ROGER THOMAS

REPRESENTATIVES TO OTHER FORUMS

INTERNATIONAL PACIFIC HALIBUT COMMISSION
MR. PHIL ANDERSON

KLAMATH FISHERY MANAGEMENT COUNCIL
MR. JIM HARP

U.S.-CANADA ALBACORE TREATY
MR. PHIL ANDERSON

Pacific Fishery Management Council COUNCIL MEETING ROOM DIAGRAM Crowne Plaza Hotel – Foster City, CA

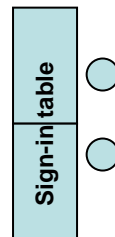
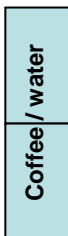
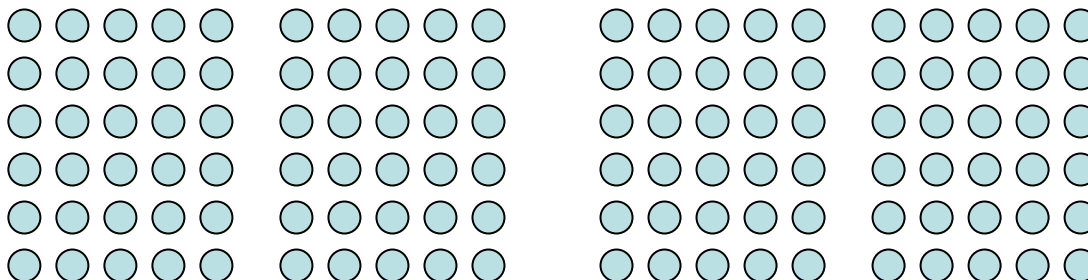
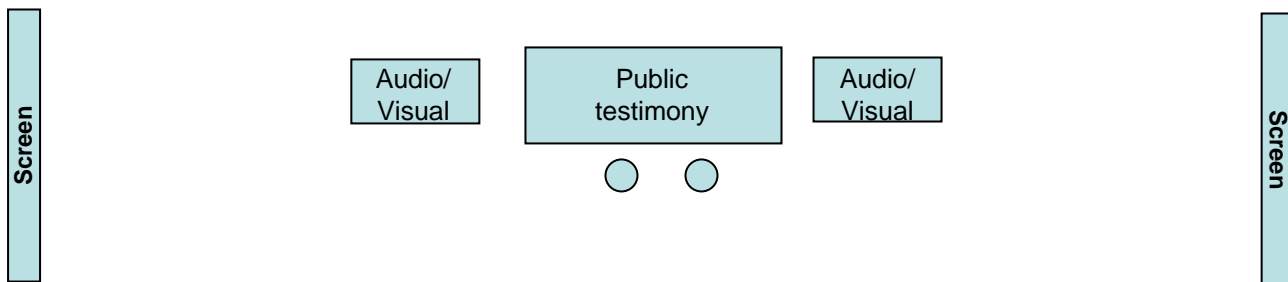
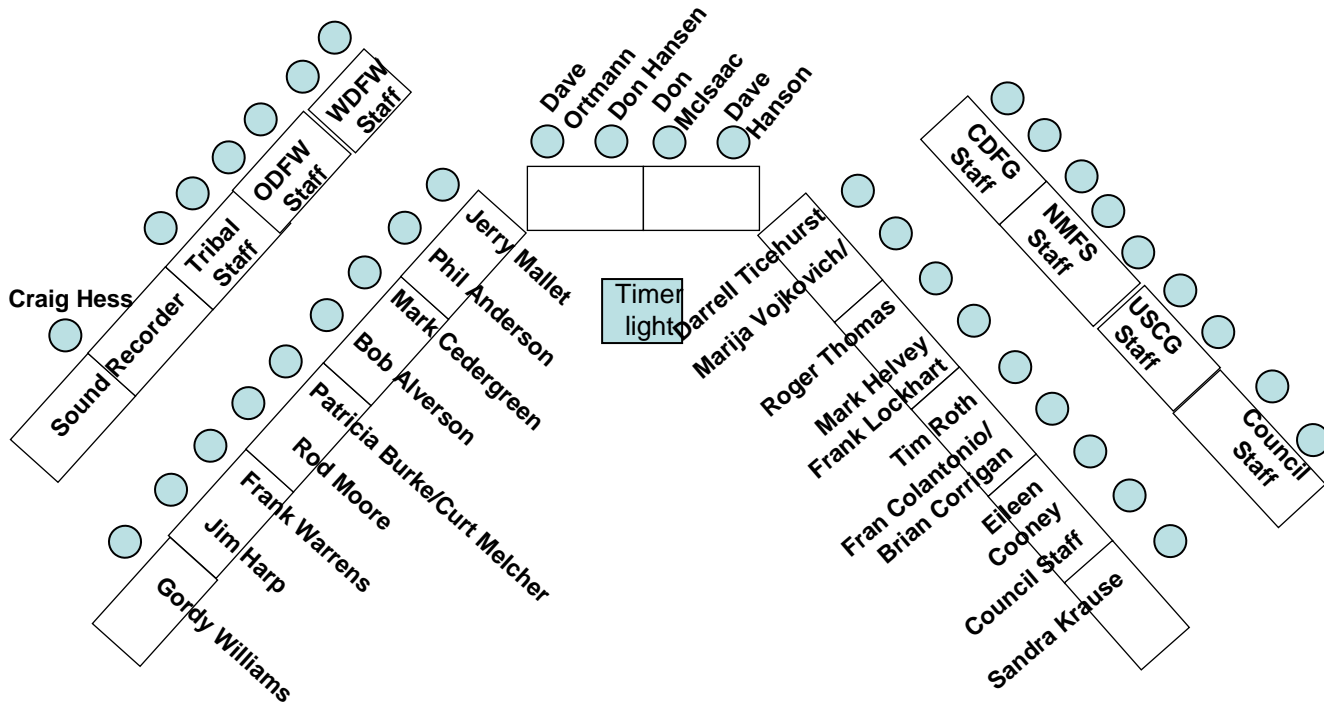

DOORS



TO BE RETAINED BY OPERATORS OF HOTELS
MOTELS, AND SIMILAR ACCOMMODATIONS AS
EVIDENCE OF EXEMPT OCCUPANCY

EXEMPTION CERTIFICATE
TAX ON OCCUPANCY
OF HOTEL ROOMS

Imposed Pursuant to
Articles 28 and 29 of the Tax Law

NAME OF HOTEL, APARTMENT HOTEL, OR LODGING HOUSE

Crowne Plaza Hotel

DATES

June 11-17, 2006

ADDRESS

1221 Chess Drive

Foster City, California 94404

650-570-5700 phone, 650-295-6135 fax

This is to certify that the above individuals are representatives of the United States Governmental department, agency or instrumentality indicated below; that the charges for the occupancy at the above establishment on the dates set forth below have been or will be paid for by such governmental unit; and that such charges are incurred in the performance of official duties as representatives or employees of such governmental unit.

DATES OF
OCCUPANCY

Group Name: Pacific Fishery
Management Council

Dates: June 11-17, 2006

SIGNATURE

GOVERNMENTAL
UNIT

DOC/NOAA/NMFS/
Pacific Fishery Management Council

TITLE



The Pacific Fishery Management Council is a federal instrumentality operating under authority of the United States Department of Commerce, National Oceanic and Atmospheric Administration.

