

**PACIFIC FISHERY MANAGEMENT COUNCIL**

# **CHAIR'S RECEPTION**



**Sunday, September 13, 2009**

**6:00 p.m.**

**Marco Polo Room  
Crowne Plaza Hotel  
Foster City, California**

TO BE RETAINED BY OPERATORS OF HOTELS  
MOTELS, AND SIMILAR ACCOMMODATIONS AS  
EVIDENCE OF EXEMPT OCCUPANCY

EXEMPTION CERTIFICATE  
TAX ON OCCUPANCY  
OF HOTEL ROOMS

Imposed Pursuant to  
Articles 28 and 29 of the Tax Law

---

NAME OF HOTEL, APARTMENT HOTEL, OR LODGING HOUSE

**Crowne Plaza Hotel**

DATES

**September 9-18, 2009**

---

ADDRESS

**1221 Chess Drive  
Foster City, CA 94404**

This is to certify that the above individuals are representatives of the United States Governmental department, agency or instrumentality indicated below; that the charges for the occupancy at the above establishment on the dates set forth below have been or will be paid for by such governmental unit; and that such charges are incurred in the performance of official duties as representatives or employees of such governmental unit.

DATES OF  
OCCUPANCY

**Group Name:** Pacific Fishery  
Management Council  
**Dates:** September 9-18, 2009

---

SIGNATURE

GOVERNMENTAL  
UNIT

DOC/NOAA/NMFS/  
Pacific Fishery Management Council

---

TITLE



The Pacific Fishery Management Council is a federal instrumentality operating under authority of the United States Department of Commerce, National Oceanic and Atmospheric Administration.





# Council Meeting Schedule for 2009-2010

2009	
WEEK OF	LOCATION
March 8-13, 2009 Advisory Bodies may begin Fri, March 6 Council Session begins Sun, March 8	<a href="#">Seattle Airport Marriott</a> 3201 S. 176th Street - Seattle, WA 98188 Phone: (206) 241-2000 or (800) 314-0925
April 4-9, 2009 Advisory Bodies may begin Thu, April 2 Council Session begins Sat, Apr 4	<a href="#">The Westin San Francisco Airport</a> 1 Old Bayshore Highway - Millbrae, CA 94030 Phone: 1-888-627-8404
June 13-18, 2009 Advisory Bodies may begin Thu, June 11 Council Session begins Sat, June 13	<a href="#">DoubleTree Hotel Spokane City Center</a> 322 North Spokane Falls Court Spokane, WA 99201 Phone: 1-509-455-9600
September 12-17, 2009 Advisory Bodies may begin Thu, Sep 10 Council Session begins Sat, Sep 12	<a href="#">Crowne Plaza - Mid Peninsula</a> 1221 Chess Dr - Foster City, CA 94404 Phone: 1-650-570-5700
October 31-November 5, 2009 Advisory Bodies may begin Thu, Oct 29 Council Session begins Sat, Oct 31	<a href="#">Hilton Orange County/Costa Mesa</a> 3050 Bristol Street - Costa Mesa, CA 92626 Phone: 714-540-7000
2010	
WEEK OF	LOCATION
March 6-12, 2010 Advisory Bodies may begin Thu, March 4 Council Session begins Sat, March 6	<a href="#">DoubleTree Hotel Sacramento</a> 2001 Point West Way - Sacramento, CA 95815 Phone: 916-929-8855
April 10-15, 2010 Advisory Bodies may begin Thu, April 8 Council Session begins Sat, April 10	<a href="#">Sheraton Portland Airport Hotel</a> 8235 NE Airport Way - Portland, OR 97220 Phone: 503-249-7606
June 12-17, 2010 Advisory Bodies may begin Thu, June 10 Council Session begins Sat, June 12	<a href="#">Crowne Plaza Hotel Foster City</a> 1221 Chess Dr - Foster City, CA 94404 Phone: 650-570-5700
September 11-16, 2010 Advisory Bodies may begin Thu, Sept 9 Council Session begins Sat, Sept 11	<a href="#">Doubletree Hotel Boise Riverside</a> 2900 Chinden Blvd - Boise, ID 83714 Phone: 208-343-1871
**November 4-November 9, 2010 Advisory Bodies may begin Tue, Nov 2 Council Session begins Thu, Nov 4	<a href="#">Hilton Orange County/Costa Mesa</a> 3050 Bristol Street - Costa Mesa, CA 92626 Phone: 714-540-7000

PFMC

8/27/2009

**\*\*Note: November 2010 meeting dates have changed from previously published Council Meeting Schedule.**

# DIRECTIONS

## CROWNE PLAZA HOTEL, MID PENINSULA

1221 Chess Drive  
Foster City, CA 94404  
650.570.5700

### SAN FRANCISCO

101 South to Hwy 92 East (Towards San Mateo Bridge / Hayward)  
Exit Foster City Blvd., Left on Metro Center Blvd.  
Left on Foster City Blvd., Left on Chess Drive.  
Hotel is on the left.

### SAN JOSE

101 North to Hwy 92 East (Towards San Mateo Bridge / Hayward)  
Exit Foster City Blvd.  
Left on Metro Center Blvd., Left on Foster City Blvd., Left on Chess Drive.  
Hotel is on the left.

### EAST BAY/OAKLAND/HAYWARD

880 South  
Exit Jackson Street / San Mateo Bridge (\$2 toll)  
After Crossing Bridge, Exit Foster City Blvd., Left at Chess Drive (Stop Light)  
Hotel in on the left.

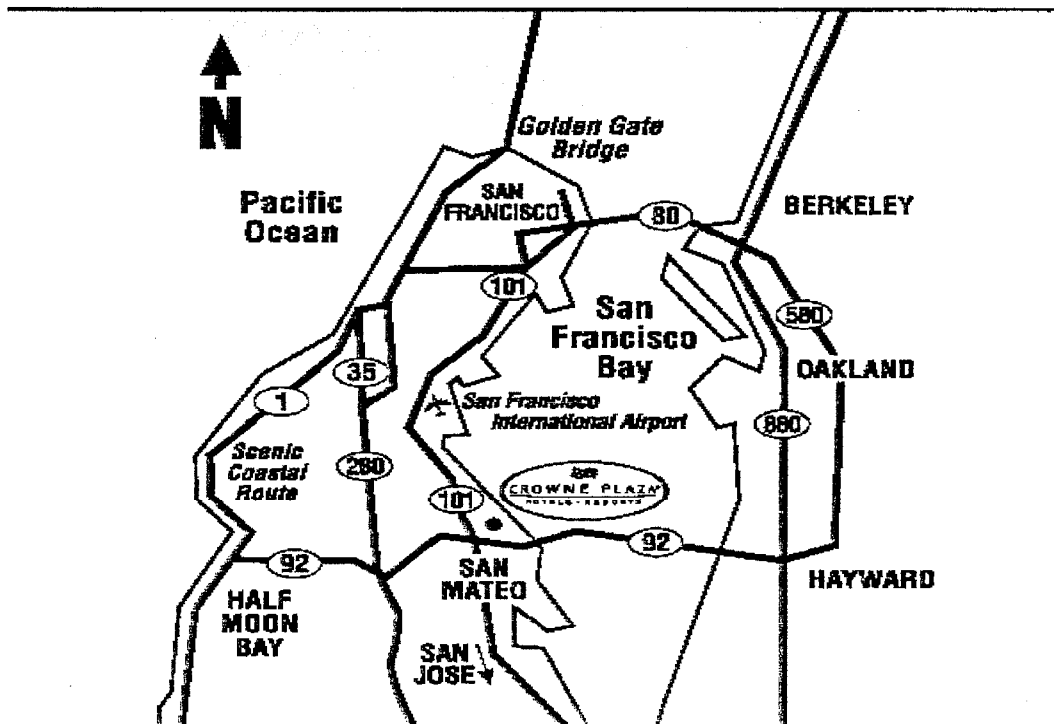

FOSTER CITY  
650.570.5700

## Key to Hotel Meeting Rooms on the *Main Floor*:

Committee	Meeting Room	Number on Diagram
Budget Committee	Yale	①
California Delegation	Alexandria II-III	②
Coastal Pelagic Species Mgt Team	Drake II	③
Council Office	Syracuse	④
Enforcement Consultants	Yale	①
Groundfish Advisory Subpanel	Alexandria II-III	②
Groundfish Management Team	Alexandria I	⑤
Habitat Committee	Stanford	⑥
Highly Migratory Species Mgt Team	Drake I & Yale	⑦ and ①
Oregon Delegation	Stanford	⑥
Salmon Advisory Subpanel	Drake I	⑦
Salmon Technical Team	Stanford	⑥
Scientific & Statistical Committee	Drake II	③
Washington Delegation	Drake I	⑦

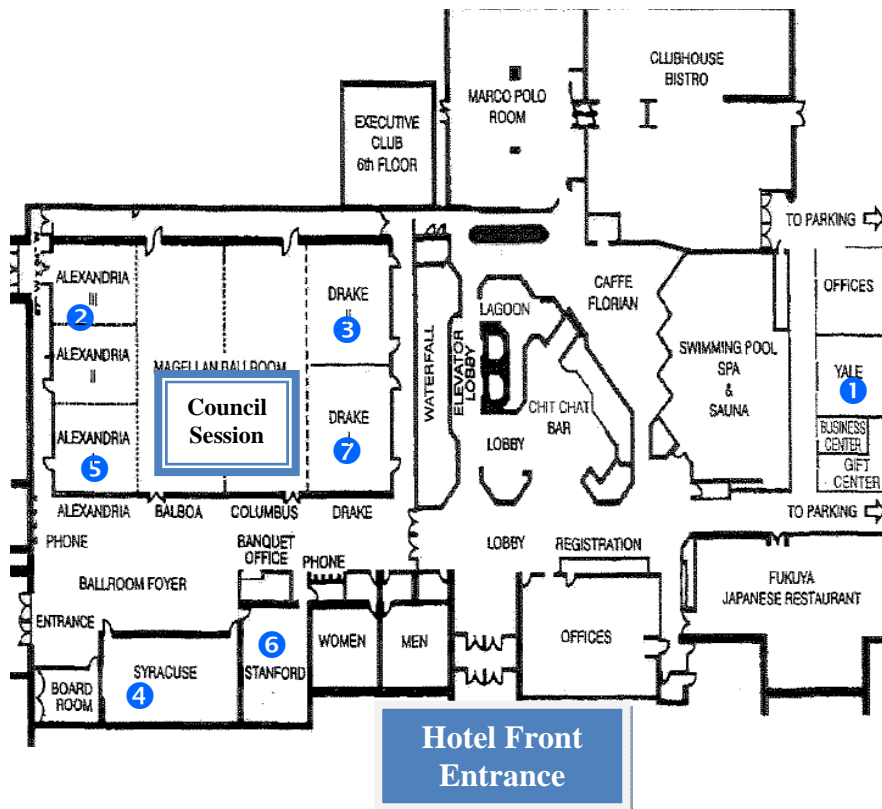

# RESTAURANT LIST

CROWNE PLAZA HOTEL  
1221 CHESS DRIVE  
FOSTER CITY, CA 94404

- 1. Tokai Japanese Restaurant**  
1221 Chess Dr  
Foster City, CA  
650-341-6888
- 2. El Torito Mexican Grill**  
388 Vintage Park Dr  
Foster City, CA  
650-574-6844
- 3. Harry's Hofbrau**  
1297 Chess Dr  
Foster City, CA  
650-349-8411
- 4. Black Angus Steakhouse**  
1299 Chess Dr  
Foster City, CA  
650-345-9971
- 5. Noah's Bagels**  
1000 Metro Center Blvd # D  
Foster City, CA  
650-574-7727
- 6. Boston Market**  
1000 Metro Center Blvd # A  
Foster City, CA  
650-572-1700
- 7. Jamba Juice**  
1000 Metro Center Blvd # B  
Foster City, CA  
650-571-6200
- 8. Savini**  
950 Tower Ln # 100  
Foster City, CA  
650-572-0330
- 9. Mc Donald's**  
1101 Triton Dr  
Foster City, CA  
650-341-4832
- 10. Armadillo Willy's Barbeque**  
2260 Bridgepointe Pkwy  
San Mateo, CA  
650-571-7427

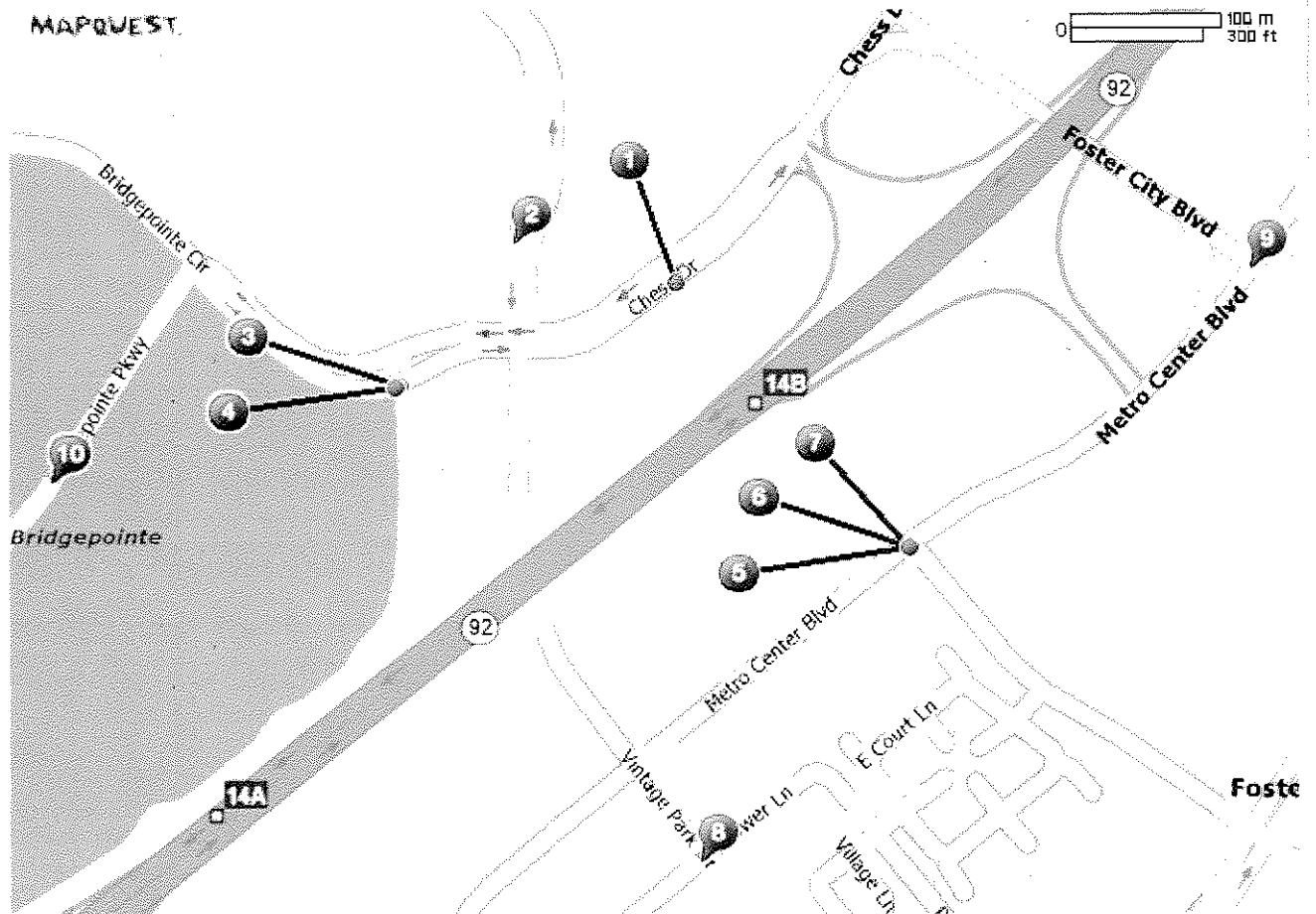

**11. IHOP Restaurant**  
531 Foster City Blvd  
Foster City, CA  
650-573-8887

**12. Taco Bell**  
1131 Triton Dr  
Foster City, CA  
650-572-8038

**13. Carl's Jr**  
1140 Triton Dr  
Foster City, CA  
650-349-1221

**14. Pizza Hut**  
1141 Triton Dr  
Foster City, CA  
650-345-3511

**15. Baja Fresh Mexican Grill**  
1031 E Hillsdale Blvd  
Foster City, CA  
650-358-8632

**16. Century Cafe**  
1065 E Hillsdale Blvd # 101  
Foster City, CA  
650-571-8097

**17. Bon Appetite**  
2215 Bridgepointe Pkwy  
San Mateo, CA  
650-638-9678

**18. Turtle Bay Grill & Seafood**  
981 E Hillsdale Blvd  
Foster City, CA  
650-286-1788

**19. Mimi's Cafe**  
2208 Bridgepointe Pkwy  
San Mateo, CA  
650-574-8767

**20. ABC Sea Food Restaurant**  
973 E Hillsdale Blvd  
Foster City, CA  
650-358-0566

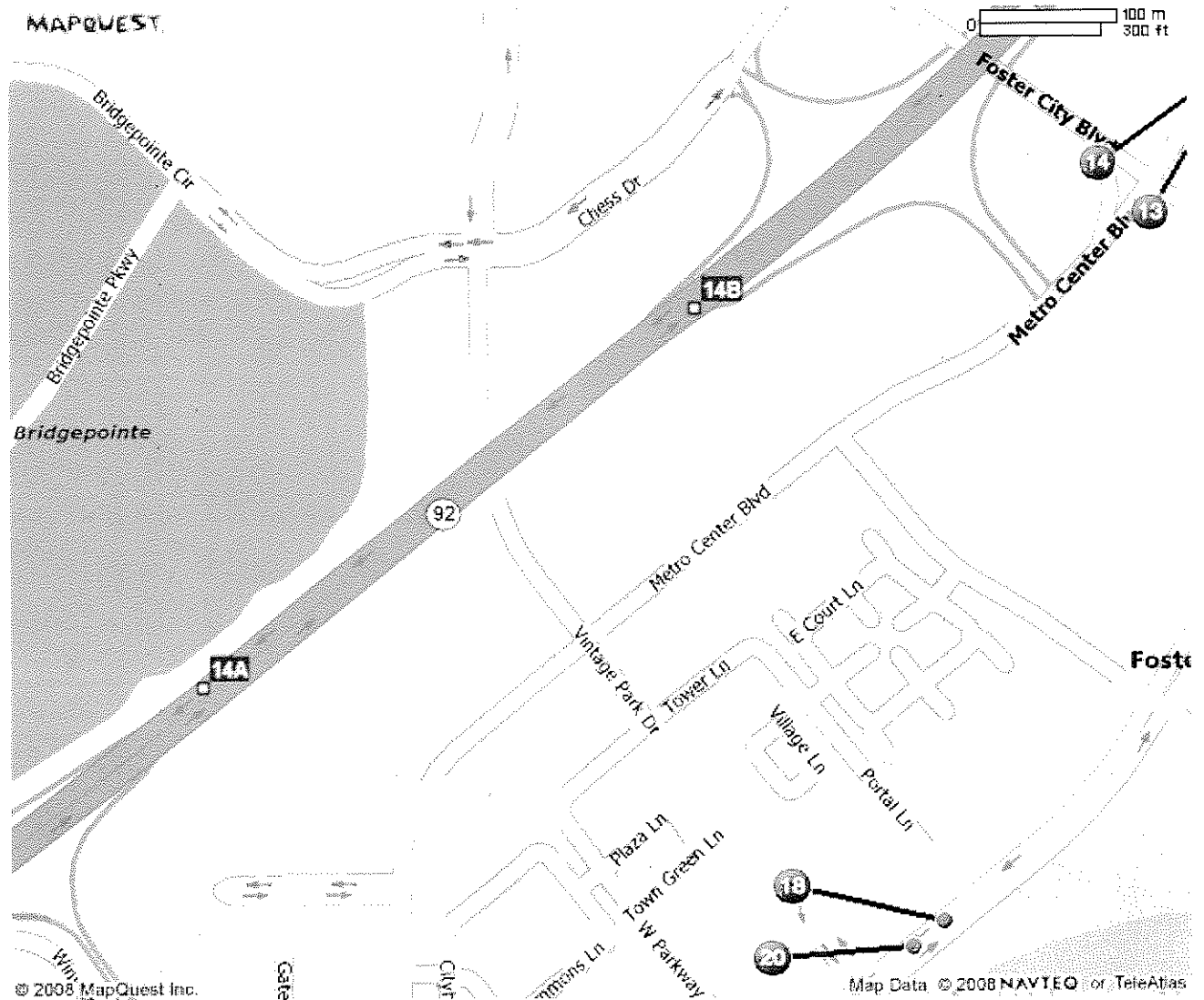

# COUNCIL MEETING ROOM DIAGRAM- Crowne Plaza Foster City, CA

