

PACIFIC FISHERY MANAGEMENT COUNCIL

CHAIR'S RECEPTION



Sunday, March 9, 2008

6:00 p.m.

CAPITAL BALLROOM SALON D

DoubleTree Hotel

Sacramento, California

TO BE RETAINED BY OPERATORS OF HOTELS
MOTELS, AND SIMILAR ACCOMMODATIONS AS
EVIDENCE OF EXEMPT OCCUPANCY

EXEMPTION CERTIFICATE
TAX ON OCCUPANCY
OF HOTEL ROOMS

Imposed Pursuant to
Articles 28 and 29 of the Tax Law

NAME OF HOTEL, APARTMENT HOTEL, OR LODGING HOUSE

DoubleTree Hotel Sacramento

DATES

March 8-15, 2008

ADDRESS

2001 Point West Way

Sacramento, California 95815

916-929-8855 Telephone - 916-924-0719 Fax

Members of the Pacific Fishery Management Council (Council)

Council Staff

| | | |
|------------------------------|----------------------------|---------------------------------|
| Council Advisory Bodies: | Habitat Committee | |
| Enforcement Consultants | Groundfish Management Team | Salmon Management Team |
| Groundfish Advisory Subpanel | Salmon Advisory Subpanel | Scientific and Statistical Team |

This is to certify that the above individuals are representatives of the United States Governmental department, agency or instrumentality indicated below; that the charges for the occupancy at the above establishment on the dates set forth below have been or will be paid for by such governmental unit; and that such charges are incurred in the performance of official duties as representatives or employees of such governmental unit.

DATES OF
OCCUPANCY

Group Name: Pacific Fishery
Management Council
Dates: March 8-15, 2008

SIGNATURE

GOVERNMENTAL
UNIT

DOC/NOAA/NMFS/
Pacific Fishery Management Council

TITLE



The Pacific Fishery Management Council is a federal instrumentality operating under authority of the United States Department of Commerce, National Oceanic and Atmospheric Administration.



TO BE RETAINED BY OPERATORS OF HOTELS,
MOTELS, AND SIMILAR ACCOMMODATIONS AS
EVIDENCE OF EXEMPT OCCUPANCY

EXEMPTION CERTIFICATE
TAX ON OCCUPANCY
OF HOTEL ROOMS

Imposed Pursuant to
Articles 28 and 29 of the Tax Law

NAME OF HOTEL, APARTMENT HOTEL, OR LODGING HOUSE

Hilton Sacramento

DATES

March 7-9, 2008

ADDRESS

**2200 Harvard Street
Sacramento, California 95815**

This is to certify that the above individuals are representatives of the United States Governmental department, agency or instrumentality indicated below; that the charges for the occupancy at the above establishment on the dates set forth below have been or will be paid for by such governmental unit; and that such charges are incurred in the performance of official duties as representatives or employees of such governmental unit.

DATES OF
OCCUPANCY

Group Name: Pacific Fishery
Management Council

Dates: March 7-9, 2008

SIGNATURE

GOVERNMENTAL
UNIT

DOC/NOAA/NMFS/
Pacific Fishery Management Council

TITLE



The Pacific Fishery Management Council is a federal instrumentality operating under authority of the United States Department of Commerce, National Oceanic and Atmospheric Administration.



COUNCIL MEETING ROOM DIAGRAM- Doubletree Hotel, Sacramento, California

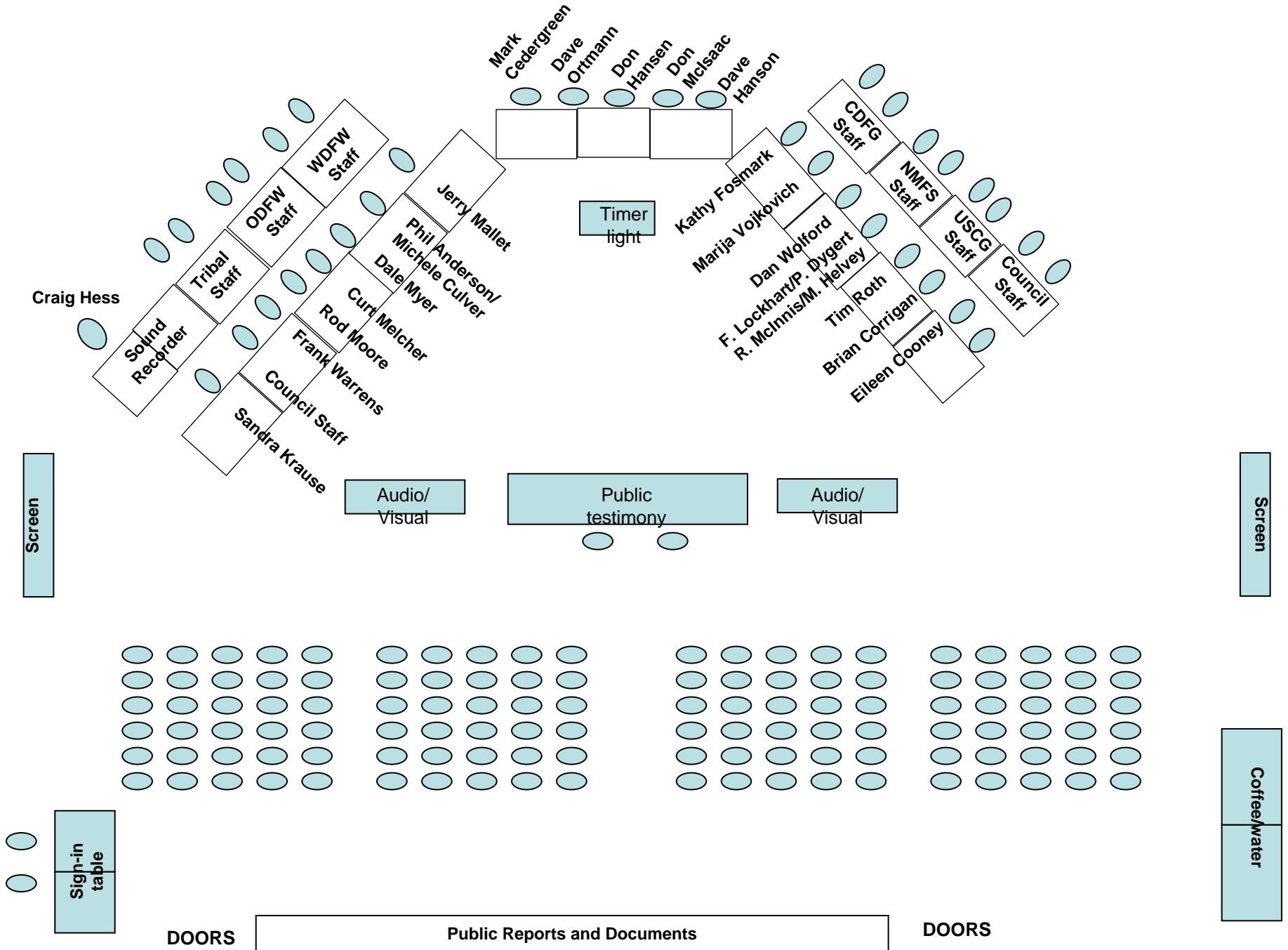

Pacific Fishery Management Council

Council Meeting Schedule

www.pcouncil.org/events/future.html

| WEEK OF | LOCATION |
|---|---|
| March 9–14, 2008 | Doubletree Hotel, 2001 Point West Way, Sacramento, CA 95815-4702 916-929-8855 or 800-222-8733 |
| April 6–11, 2008 | Marriott Hotel SeaTac Airport, 3201 South 176 th Street, Seattle, WA 98188 206-241-2000 |
| June 8–13, 2008 | Crowne Plaza Hotel, 1221 Chess Drive, Foster City, CA 94404 650-5700 or 800-477-5700 |
| September 7–12, 2008 <i>Note: date change</i> | Doubletree Hotel Boise – Riverside 2900 Chinden Boulevard, Boise, Idaho 83714 208-343-1871 |
| November 2–7, 2008 | Town and Country Resort, 500 Hotel Circle North, San Diego, CA 92108 619-291-7131 |
| ◆ ◆ | ◆ ◆ ◆ |
| March 8–13, 2009 | Marriott Hotel SeaTac Airport, 3201 South 176 th Street, Seattle, WA 98188 206-241-2000 |
| April 5–10, 2009 | California |
| June 14–19, 2009 | Washington, Oregon or California |
| September 13–18, 2009 | Washington, Oregon or California |
| November 1–6, 2009 | Oregon or California |
| ◆ ◆ | ◆ ◆ ◆ |
| March 7–12, 2010 | California |
| April 5–10, 2010 ¹ | Oregon or Washington |
| June 13–18, 2010 | Washington, Oregon, or California |
| September 12–17, 2010 | Washington, Oregon, or California |
| October 31– November 5, 2010 | Oregon or California |
| ◆ ◆ | ◆ ◆ ◆ |

01/30/08

¹ Easter is April 4, 2010

**DOUBLETREE HOTEL
2001 POINT WEST WAY
SACRAMENTO, CA 95815
916-929-8855**

FROM AIRPORT DIRECTIONS:

Take I-5 south to the Garden Highway exit. Turn Left on Garden Highway, following Garden Highway as it turns into Garden-Arden access. Continue until it turns into Arden Way. Continue on Arden Way, going under Interstate 80. Doubletree Hotel is just past Interstate 80 on Arden Way. Directly after I-80, on Arden Way, the hotel grounds will be on the right hand side. Turn right on Point West Way, and right into the hotel parking lot.

SUPER SHUTTLE:

Sacramento International Airport Super Shuttle is located directly outside the baggage claim area at each terminal. Reservations are not required unless for large parties, or private charters. Simply go to the Super Shuttle service center, and purchase either a round-trip or one way ticket. Taxis are also available at the airport.

General Arrival Directions:

GOING I-5 NORTH:

Take I-5 to HWY 50. Take HWY 50 east to Business 80/Capital City Freeway East. Exit at Arden Way East, keep right. Take the first right onto Point West Way.

GOING I-5 SOUTH:

Take the Garden Highway exit, turning left onto Garden Highway. Continue on Garden Highway until it turns into Garden-Arden. Continue on Garden-Arden as it turns into Arden way. Continue on Arden Way, going under Interstate 80. Just past Interstate 80 you will turn right onto Point West Way, and right into the hotel parking lot.



FROM HIGHWAY 99:

Keep to the left when approaching Sacramento. HWY 99 merges into Business 80/Capital City Freeway. Take the Arden Way east, keep right. Take the first right onto Point West Way. FROM HWY 50: Take the Business 80/Capital City Freeway split. Exit at Arden Way east, keep right. Take the first right onto Point West Way.

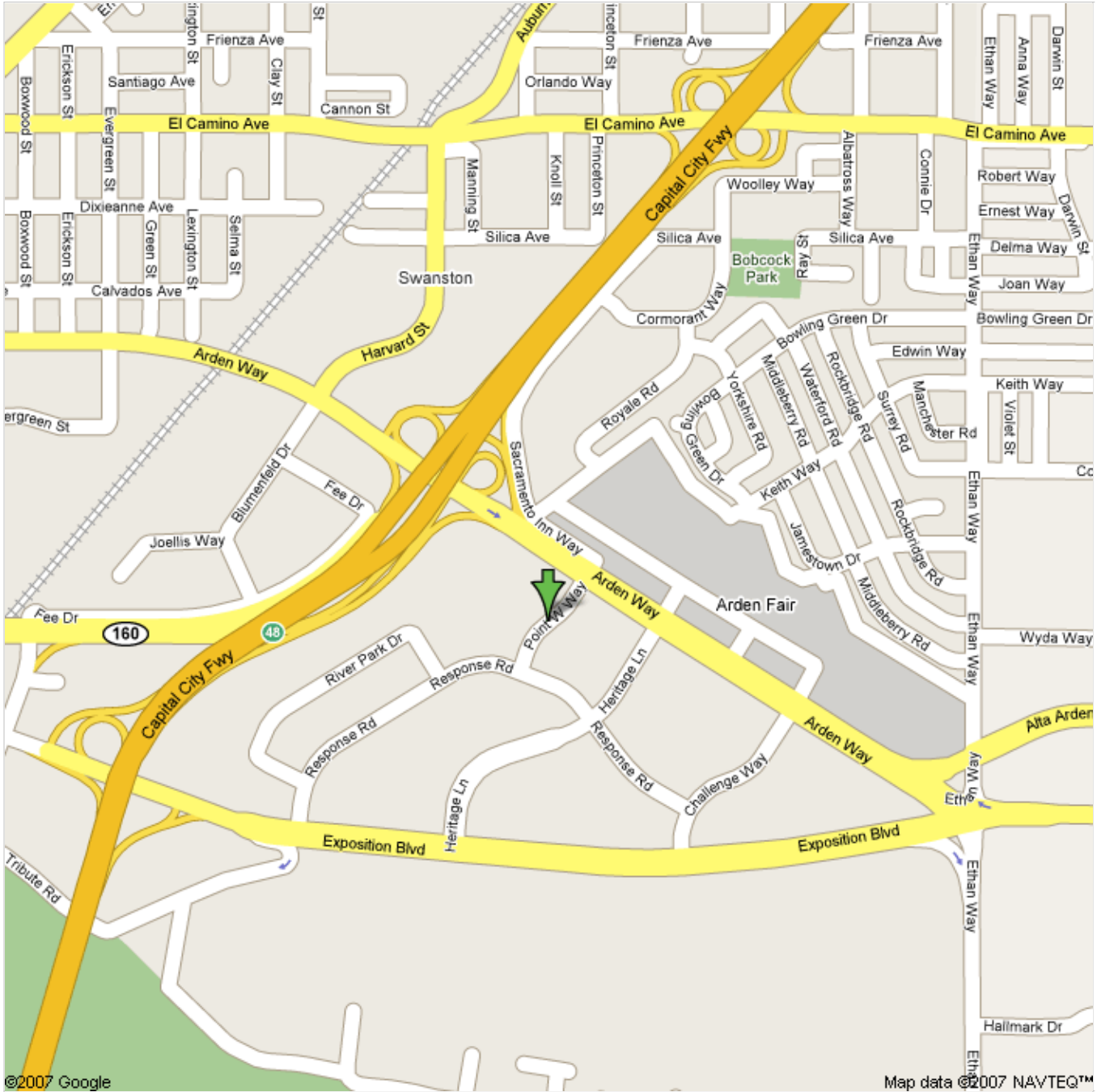

Address **2001 Point W Way**
Sacramento, CA 95815

Get Google Maps on your phone
Text the word "GMAPS" to 466453



DoubleTree Hotel Sacramento Room Layout



DOUBLE TREE HOTEL
 SACRAMENTO
 2001 POINT WEST WAY
 SACRAMENTO, CA 95815
 916-929-8855
 916-924-4913 FAX

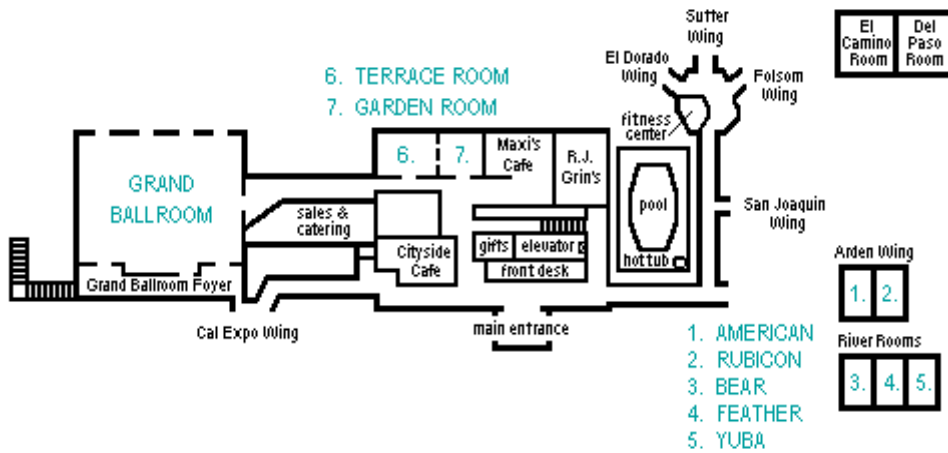

DOUBLETREE HOTEL SACRAMENTO - MAIN LEVEL

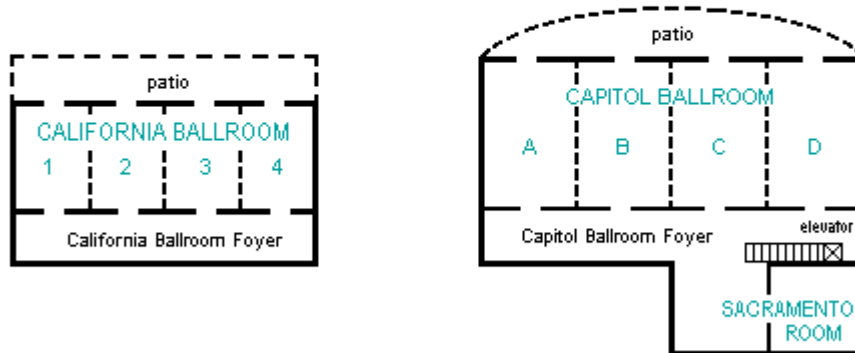

DOUBLETREE HOTEL SACRAMENTO - LOWER LEVEL



PFMC
02/06/07

F:\PFMC\MEETING\2007\March\Hotel\Sacramento_DoubleTree_Layout.doc

RESTAURANT LIST



Results 1-10 of about **20,164** for **restaurants** near **2001 Point W Way, Sacramento, CA 95815**

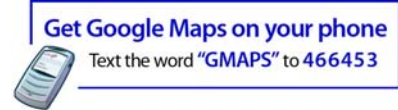

- | | |
|--|--|
| A. Elephant Bar Restaurant 1500 Arden Way, Sacramento, CA (916) 564-2526 - 2 reviews - 0.1 mi NE | B. El Torito Mexican Grill 1598 Arden Way, Sacramento, CA (916) 927-0071 - 2 reviews - 0.2 mi E |
| C. Dos Coyotes Border Cafe 1735 Arden Way # 230, Sacramento, CA (916) 927-0377 - ★★★★★ - 0.3 mi E | D. California Pizza Kitchen 1735 Arden Way # 220, Sacramento, CA (916) 568-0932 - 4 reviews - 0.3 mi E |
| E. Olive Garden Italian Rstrnt 1780 Challenge Way, Sacramento, CA (916) 649-8305 - 4 reviews - 0.4 mi SE | F. Sbarro 1689 Arden Way # 2014, Sacramento, CA (916) 564-0341 - 1 review - 0.3 mi E |
| G. Johnny Rockets 1689 Arden Way # 1106, Sacramento, CA (916) 564-9567 - 3 reviews - 0.3 mi E | H. Panda Express 1735 Arden Way # 224, Sacramento, CA (916) 921-5386 - 3 reviews - 0.3 mi E |
| I. Cinnabon 1689 Arden Way # 2002, Sacramento, CA (916) 927-1964 - 1 review - 0.3 mi E | J. Auntie Anne's Pretzels 1689 Arden Way # 2008, Sacramento, CA (916) 925-1630 - 0.3 mi E |

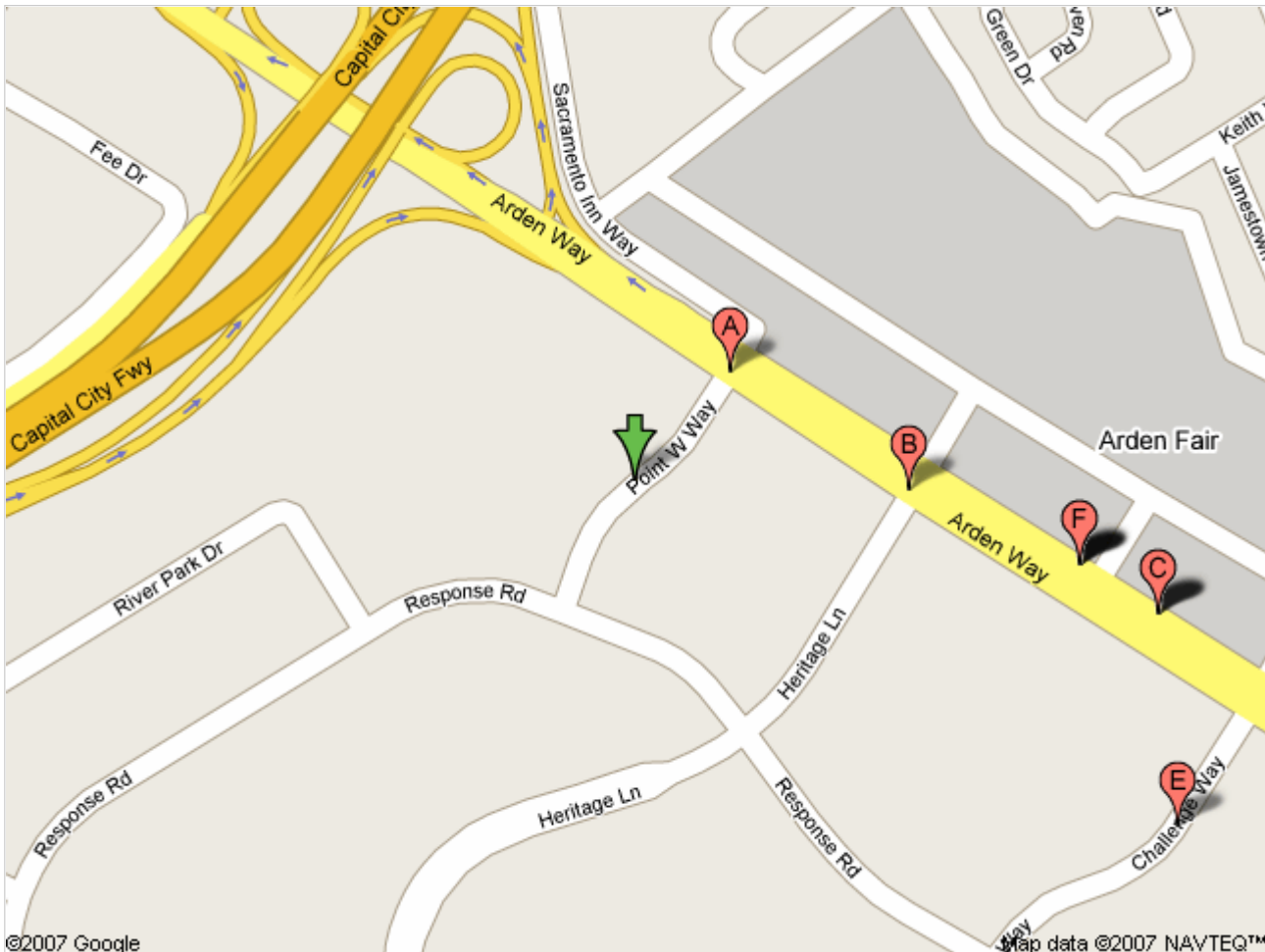



Results 11-20 of about 20,164 for restaurants near 2001 Point W Way, Sacramento, CA 95815



- A. Cheesecake Factory
1771 Arden Way, Sacramento, CA
(916) 567-0606 - ★★★★★ - 0.4 mi E
- B. Fresh Choice
1689 Arden Way # 1065, Sacramento, CA
(916) 649-3839 - 0.3 mi E
- C. Papayas Cafe
1555 River Park Dr # 100, Sacramento, CA
(916) 564-3633 - 0.2 mi W
- D. Jamba Juice
1689 Arden Way # 1112, Sacramento, CA
(916) 924-5945 - 0.3 mi E
- E. Steak Escape
1689 Arden Way # 2026, Sacramento, CA
(916) 924-8552 - 1 review - 0.3 mi E
- F. Point West Cafe
1610 Arden Way # 155, Sacramento, CA
(916) 649-1928 - 0.3 mi E
- G. Sierra Gold Inc
1689 Arden Way, Sacramento, CA
(916) 567-0340 - 0.3 mi E
- H. China Inn
1689 Arden Way # 2022, Sacramento, CA
(916) 920-0959 - 0.3 mi E
- I. Cafe Europa
1689 Arden Way # 2016, Sacramento, CA
(916) 929-4140 - 0.3 mi E
- J. Cold Stone Creamery
1689 Arden Way # 2010, Sacramento, CA
(916) 568-1415 - 2 reviews - 0.3 mi E

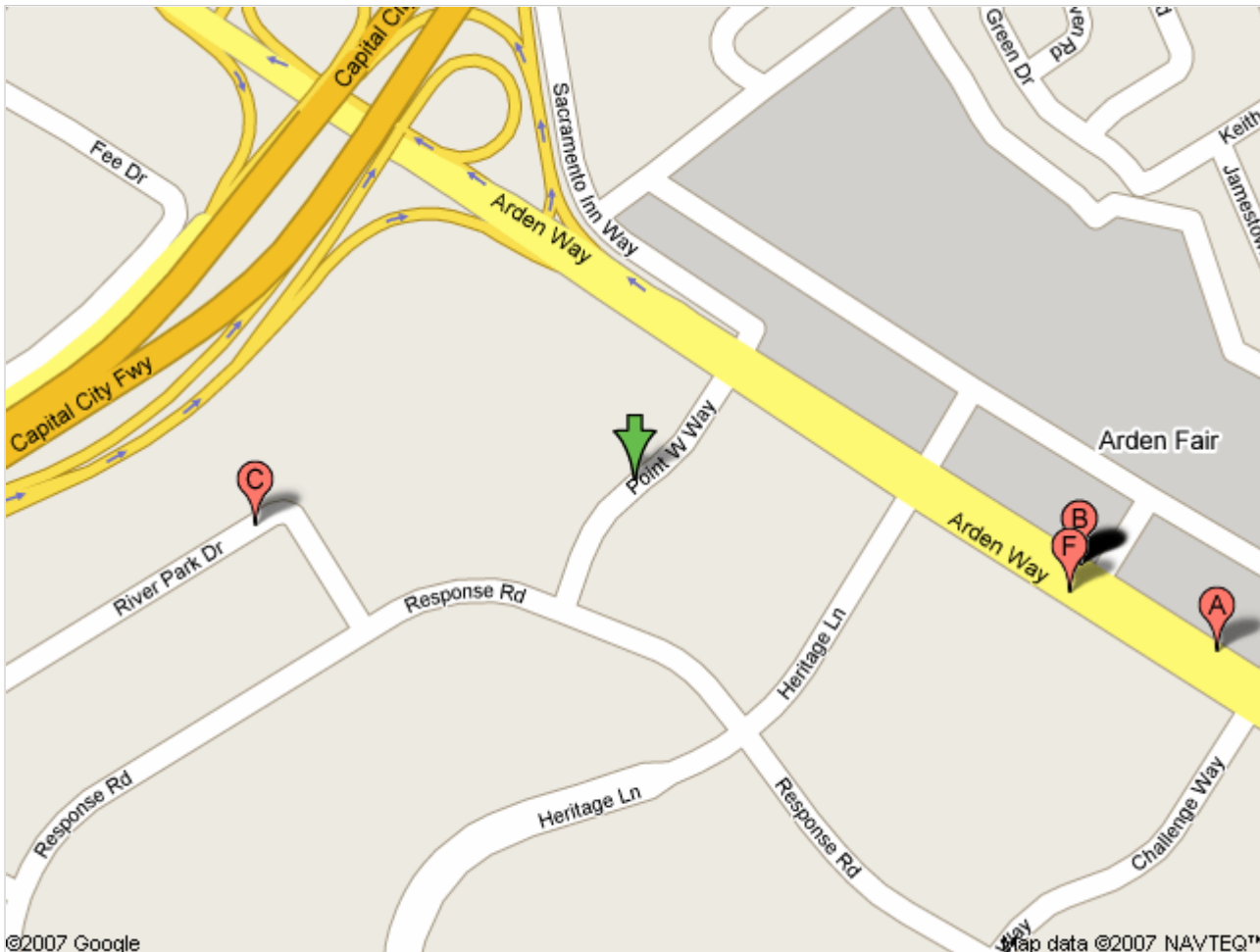



Results 21-30 of about 20,164 for restaurants near 2001 Point W Way, Sacramento, CA 95815



- | | |
|---|--|
| A. Frank & Stein Dogs & Drafts 1689 Arden Way, Sacramento, CA (916) 924-1249 - 0.3 mi E | B. Pretzel Time 1689 Arden Way # 1118, Sacramento, CA (916) 924-0332 - 0.3 mi E |
| C. Rollerz 1689 Arden Way # 2032, Sacramento, CA (916) 646-4850 - 0.3 mi E | D. Pluto's Fresh Food 1735 Arden Way, Sacramento, CA (916) 921-2500 - 2 reviews - 0.3 mi E |
| E. Waffle Shop 1540 River Park Dr # 109, Sacramento, CA (916) 564-8880 - 0.3 mi W | F. Chuck E Cheese's 1690 Arden Way, Sacramento, CA (916) 920-9181 - 3 reviews - 0.3 mi E |
| G. Oishii 1689 Arden Way # 2028, Sacramento, CA (916) 920-5578 - 0.3 mi E | H. Hooters Parco Holdings LP 1555 River Park Dr, Sacramento, CA (916) 924-9464 - 0.2 mi W |
| I. Market Square Grill 1735 Arden Way # 218, Sacramento, CA (916) 925-3500 - 0.3 mi E | J. Hooters 1785 Challenge Way, Sacramento, CA (916) 927-9464 - 1 review - 0.4 mi SE |

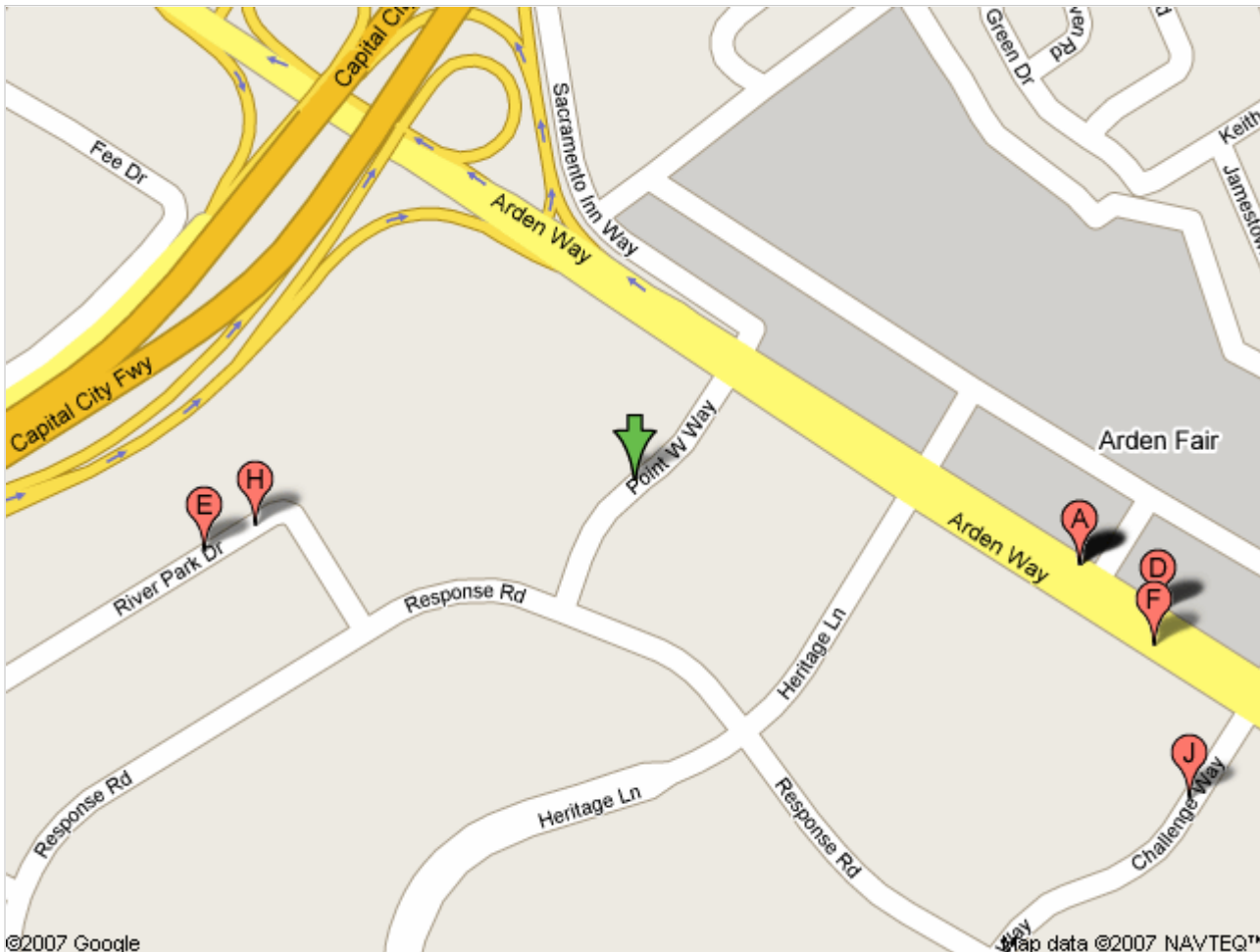



Results 31-40 of about 20,164 for
restaurants near 2001 Point W
Way, Sacramento, CA 95815

Get Google Maps on your phone
Text the word "GMAPS" to 466453



- A. Monterey Bay Cannery
1785 Challenge Way, Sacramento, CA
(916) 920-3474 - 2 reviews - 0.4 mi SE
- B. Mikuni Sushi
1735 Arden Way, Sacramento, CA
(916) 920-2373 - 2 reviews - 0.3 mi E
- C. I Love Teriyaki
1735 Arden Way # 210, Sacramento, CA
(916) 641-2216 - 0.3 mi E
- D. Coco's Bakery Restaurant
1830 Arden Way, Sacramento, CA
(916) 922-6741 - 0.4 mi E
- E. Mikuni
1455 Response Rd # 230, Sacramento, CA
(916) 576-2641 - 0.5 mi SW
- F. Harvard Street Grill
2200 Harvard St, Sacramento, CA
(916) 922-4700 - 0.5 mi NW
- G. Catalina Restaurant Co
1830 Arden Way, Sacramento, CA
(916) 922-0220 - 0.4 mi E
- H. Luau Garden Chinese Buffet
1890 Arden Way, Sacramento, CA
(916) 929-3690 - 1 review - 0.5 mi SE
- I. Romano's Macaroni Grill
2001 Alta Arden Expy, Sacramento, CA
(916) 921-2711 - 2 reviews - 0.7 mi E
- J. Burger King
1915 Arden Way, Sacramento, CA
(916) 925-5024 - 2 reviews - 0.6 mi E

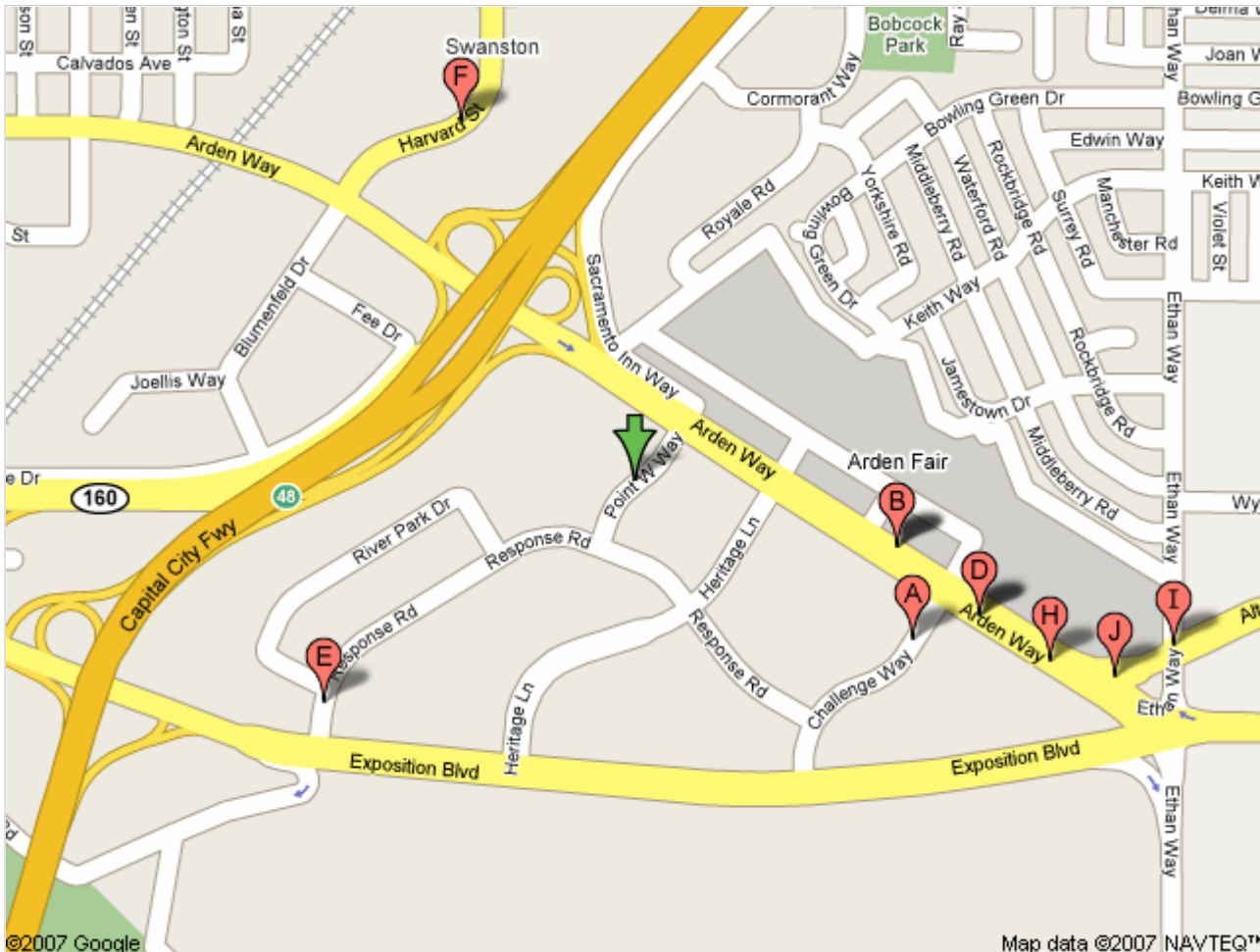



Results 41-50 of about 20,164 for restaurants near 2001 Point W Way, Sacramento, CA 95815

Get Google Maps on your phone
Text the word "GMAPS" to 466453

- A. Mimi's Cafe
2029 Alta Arden Expy, Sacramento, CA
(916) 614-9278 - 2 reviews - 0.7 mi E
- B. Punch Line Sacramento
2100 Arden Way # 225, Sacramento, CA
(916) 925-5500 - 3 reviews - 0.9 mi E
- C. Food To You
1600 Sacramento Inn Way # 209, Sacramento, CA
(916) 649-3663 - 4 reviews - 0.5 mi N
- D. Buca Di Beppo
1249 Howe Ave, Sacramento, CA
(916) 922-6673 - ★★★★★ - 1.2 mi SE
- E. Kleenair Restaurant Steam
1657 Silica Ave, Sacramento, CA
(916) 485-4393 - 0.6 mi N
- F. Countertops Designs Inc
1522 Silica Ave, Sacramento, CA
(916) 929-4562 - 0.6 mi N
- G. Chili's Grill & Bar
2100 Arden Way # 185, Sacramento, CA
(916) 929-5838 - 3 reviews - 0.9 mi E
- H. Kitchen Restaurant
2225 Hurley Way # 101, Sacramento, CA
(916) 568-7171 - ★★★★★ - 1.2 mi SE
- I. Jamba Juice
2100 Arden Way # 192, Sacramento, CA
(916) 920-1606 - 1 review - 0.9 mi E
- J. Red Lobster Restaurants
1400 Howe Ave, Sacramento, CA
(916) 921-6011 - 1 review - 1.1 mi SE

