

**PACIFIC FISHERY
MANAGEMENT COUNCIL**



CHAIR'S RECEPTION

Friday, June 20, 2014

6:00 p.m.

Pool North Tower

Hyatt Regency Orange County

Garden Grove, California



GARDEN GROVE TRANSIENT OCCUPANCY TAX EXEMPTION
REQUEST FORM

This form must be completed by all employees/officers of the federal government or federal credit union requesting exemption from Transient Occupancy Tax. Any exemption applies only for the days which the employee/officers are engaged in official business as stated on your traveling orders or conference agenda. Any additional charges incurred due to others staying with the employee/officer are subject to transient occupancy tax.

Name of Hotel/Motel _____

Address of Hotel/Motel _____

Federal Employee/Officer Occupying Room _____

Title _____ Business Phone _____

Name of Employer _____

Employer Address _____

Direct Supervisor's Name and Telephone _____

Exemption Dates _____
(occupancy dates in which you are engaged in official federal government business)

I hereby certify that I am a federal government employee or federal credit union employee and my motel/hotel stay at the above named facility is to be used for federal government/credit union business. If this stay is used in whole or on part for non-business purposes, I shall be liable for payment of transient occupancy tax to the City of Garden Grove for any non-business days.

I hereby certify under penalty of perjury under the laws of the State of California that the foregoing is true and correct. Executed in Garden Grove, California on

month day year

Signature of Employee/Officer Occupying Printed Name of Employee/Officer



Pacific Council Meeting Schedule 2014-2015

2014

DATES

LOCATION

March 8-13, 2014

Advisory Bodies may begin Fri, March 7
Council Session begins Sat, March 8

[Doubletree by Hilton Sacramento](#)

2001 Point West Way - Sacramento, CA 95815
Telephone: 916-929-8855

April 5-10, 2014

Advisory Bodies may begin Fri, April 4
Council Session begins Sat, April 5

[Hilton Vancouver Washington](#)

301 W Sixth Street – Vancouver, WA 98660
Telephone: 360-993-4500

June 20-25, 2014

Advisory Bodies may begin Thu, June 19
Council Session begins Fri, June 20

[Hyatt Regency Orange County](#)

11999 Harbor Boulevard – Garden Grove, CA 92840
Telephone: 714-750-1234

Public Comment received in the Council Office by **May 23, 2014** will be included in the briefing materials distributed prior to the meeting.

Public Comment received in the Council Office after May 23 but by **June 13, 2014** will be distributed at the June meeting.

September 12-17, 2014

Advisory Bodies may begin Thu, Sept 11
Council Session begins Fri, Sept 12

[DoubleTree by Hilton Spokane City Center](#)

322 N Spokane Falls Court – Spokane, WA 99201
Telephone: 509-455-9600

Public Comment received in the Council Office by **August 15, 2014** will be included in the briefing materials distributed prior to the meeting.

Public Comment received in the Council Office after August 15 but by **September 5, 2014** will be distributed at the September meeting.

November 14-19, 2014

Advisory Bodies may begin Thurs, Nov 13
Council Session begins Fri, Nov 14

[Hilton Orange County/Costa Mesa](#)

3050 Bristol Street - Costa Mesa, CA 92626
Telephone: 714-540-7000

Public Comment received in the Council Office by **October 17, 2014** will be included in the briefing materials distributed prior to the meeting.

Public Comment received in the Council Office after October 17 but by **November 7, 2014** will be distributed at the November meeting.

2015

DATES	LOCATION
March 7-12, 2015 Advisory Bodies may begin Fri, March 6 Council Session begins Sat, March 7	Hilton Vancouver Washington 301 W Sixth Street – Vancouver, WA 98660 Telephone: 360-993-4500
Public Comment received in the Council Office by February 9, 2015 will be included in the briefing materials distributed before the meeting. Public Comment received in the Council Office after February 9 but by March 2, 2015 will be distributed at the March meeting.	
April 11-16, 2015 Advisory Bodies may begin Fri, Apr 10 Council Session begins Sat, April 11	DoubleTree by Hilton Sonoma One Doubletree Drive – Rohnert Park, CA 94928 Telephone: 707-584-5466
Public Comment received in the Council Office by March 20, 2015 will be included in the briefing materials distributed before the meeting. Public Comment received in the Council Office after March 20 but by April 6, 2015 will be distributed at the April meeting.	
June 12-17, 2015 Advisory Bodies may begin Thu, June 11 Council Session begins Fri, June 12	DoubleTree by Hilton Spokane City Center 322 N Spokane Falls Court – Spokane, WA 99201 Telephone: 509-455-9600
Public Comment received in the Council Office by May 15, 2015 will be included in the briefing materials distributed before the meeting. Public Comment received in the Council Office after May 15 but by June 8, 2015 will be distributed at the June meeting.	
September 11-16, 2015 Advisory Bodies may begin Thu, Sept 10 Council Session begins Fri, Sept 11	Doubletree Hotel Sacramento 2001 Point West Way - Sacramento, CA 95815 Telephone: 916-929-8855
Public Comment received in the Council Office by August 14, 2015 will be included in the briefing materials distributed before the meeting. Public Comment received in the Council Office after August 14 but by September 4, 2015 will be distributed at the September meeting.	
November 14-19, 2015 Advisory Bodies may begin Fri, Nov 13 Council Session begins Sat, Nov 14	Hyatt Regency Orange County 11999 Harbor Boulevard – Garden Grove, CA 92840 Telephone: 714-750-1234
Public Comment received in the Council Office by October 16, 2015 will be included in the briefing materials distributed before the meeting. Public Comment received in the Council Office after October 16 but by November 6, 2015 will be distributed at the November meeting.	

DIRECTIONS

Hyatt Regency Orange County

11999 Harbor Blvd.

Garden Grove, California, USA, 92840

714 750 1234

From Los Angeles Int'l Airport (LAX):

Origination: 1 World Way, Los Angeles, CA 90045:

I-105 East to

I-605 South to

CA-91 East to

I-5 South

Exit Harbor Boulevard South (Exit 110A)

Our Orange County hotel is 1.8 miles on right, at Chapman and Harbor

From Orange County/John Wayne Airport (SNA):

Origination: 18601 Airport Way, Santa Ana, CA 92707

I-405 North to

CA-55 North to

I-5 North

Exit Chapman Avenue

Turn left on Chapman Avenue

Our Orange County hotel is 1.5 miles on right, at Chapman and Harbor

From Hyatt Regency Orange County to Disneyland® Resort Anaheim

Head south on Harbor Boulevard

U-turn at W. Manchester Avenue

Entrance to Disneyland Resort will be on immediate right

1313 South Harbor Boulevard

Anaheim, CA 92802

Contact Hyatt Regency Orange County Guest Services at:
714 740 6051 for more information.



Hyatt Regency Orange County
11999 Harbor Boulevard
Garden Grove, CA 92840
T: 714 740 6116
F: 714 971 1721
www.orangecounty.hyatt.com

Local Transportation

Disneyland® Resort Shuttle

- Distance 1 mile
- Shuttle departs the hotel on the top of and :30 after each hour
- Shuttle picks up from Disneyland at :20 and :50 after each hour

Anaheim Convention Center

- Distance 1 mile
- Taxi service approximately \$7 - \$10
- Arrange transportation for your large group to any of these destinations with your dedicated Sales Representative
- All other transportation arrangements can be made by calling the hotel concierge directly at 714 750 1234

- Contact the hotel concierge to arrange shuttles and daily tours to the following:

- Knott's Berry Farm
- Medieval Times
- Los Angeles Tours / Hollywood
- Universal Studios Los Angeles
- Sea World San Diego

- Super Shuttle telephone: 800 200 6655

*Prices may vary and are subject to change

John Wayne / Orange County Airport

- Distance 13 miles
- Super Shuttle \$10/person each way
- Disneyland Resort Bus \$11/person to airport
- Town car \$50 one way
- SUV \$55 one way
- Van \$75 one way (up to 10 passengers)
- Limo \$85 one way + 20% service charge

Long Beach Airport

- Distance 17 miles
- Super Shuttle \$35/person each way
- Town car \$60 one way
- SUV \$70 one way
- Van \$75 one way (up to 10 passengers)
- Limo \$110 one way + 20% service charge

Los Angeles International Airport

- Distance 37 miles
- Super Shuttle \$16/person each way
- Disneyland Resort Bus \$17/person to airport
- Town car \$100 one way
- SUV \$110 one way
- Van \$120 one way (up to 10 passengers)
- Limo \$140 one way + 20% service charge





Hyatt Regency Orange County
11999 Harbor Boulevard
Garden Grove, CA 92840
T: 714 740 6116
F: 714 971 1721
www.orangecounty.hyatt.com

Orange County Attractions

Disneyland® Resort

- Disneyland Park, Disney's California Adventure Park, Downtown Disney
- Located 1 mile from the hotel
- Shuttle provided every ½ hour to/from the hotel

Angel Stadium

- Home of MLB's Los Angeles Angels of Anaheim
- Located 2 miles from the hotel

Honda Center

- Home of the NHL's Anaheim Ducks
- Located 2.5 miles from the hotel

The Anaheim GardenWalk

- Outdoor retail shops, dining and entertainment
- Located 1.5 miles from the hotel

The Block at Orange

- Outdoor retail shops, dining and entertainment
- Located 2 miles from the hotel

South Coast Plaza

- Premier, upscale shopping and dining
- Located 13 miles from the hotel

Knott's Berry Farm

- Family theme park
- Located 9 miles from the hotel

Medieval Times

- Theme dinner and jousting tournament
- Located 9 miles from the hotel

Crystal Cathedral

- Famous worship center
- Located 1 mile from the hotel

Discovery Science Center

- Family science exhibits and programs
- Located 5 miles from the hotel

Bowers Museum of Cultural Art

- Art and exhibits from around the world
- Located 4 miles from the hotel

World-Famous Beaches

- Huntington Beach – 12 miles
- Newport Beach – 15 miles
- Laguna Beach – 20 miles





Hyatt Regency Orange County
 11999 Harbor Boulevard
 Garden Grove, CA 92840
 T: 714 740 6032
 F: 714 971 1721
www.orangecounty.hyatt.com

Local Restaurants

Walking distance from the hotel:

	<u>Cuisine</u>	<u>Telephone</u>	<u>Price Scale</u>
TusCA	Italian	At Hotel	\$\$
OC Brewhouse	American	At Hotel	\$\$
Starbucks	Café	At Hotel	\$
Oggi's Pizza	American	714.534.3599	\$\$\$
Buca di Beppo	Italian	714.740.1087	\$\$
Outback Steakhouse	Steakhouse	714.663.1107	\$\$\$
Joe's Crab Shack	Seafood	714.703.0505	\$\$\$
Red Robin	American	714.971.4775	\$\$
Coco's Bakery	American	714.772.0414	\$\$
La Casa Garcia	Mexican	714.740.1108	\$\$

Within 10 minutes of the hotel:

	<u>Cuisine</u>	<u>Telephone</u>	<u>Price Scale</u>
Alcatraz Brewing Company	American	714.939.8686	\$\$
Bubba Gump	Seafood	714.635.4867	\$\$\$
Café Tu Tu Tango	Appetizers	714.769.2222	\$\$
California Pizza Kitchen	American	714.991.0305	\$\$\$
Cheesecake Factory	American	714.533.7500	\$\$\$
El Torito	Mexican	714.939.6711	\$\$
ESPN Zone	American	714.300.3776	\$\$
Koji's Sushi & Shabu Shabu	Japanese	714.769.0200	\$\$\$
Market Broiler	Seafood	714.769.FISH	\$\$\$
Morton's Steakhouse	Steakhouse	714.621.0101	\$\$\$\$
PF Changs	Chinese	714.507.2021	\$\$\$
Ralph Brennan's Jazz Kitchen	Creole	714.776.5200	\$\$\$
Red Lobster	Seafood	714.638.9500	\$\$
Ruth's Chris	Steakhouse	714.750.5466	\$\$\$\$
The White House	Italian	714.772.1381	\$\$\$\$

Price Scale:

\$\$

\$5-\$10

\$\$\$

\$10-\$18

\$\$\$\$

Over \$18



Hyatt Garden Grove PFMC Hotel Map:

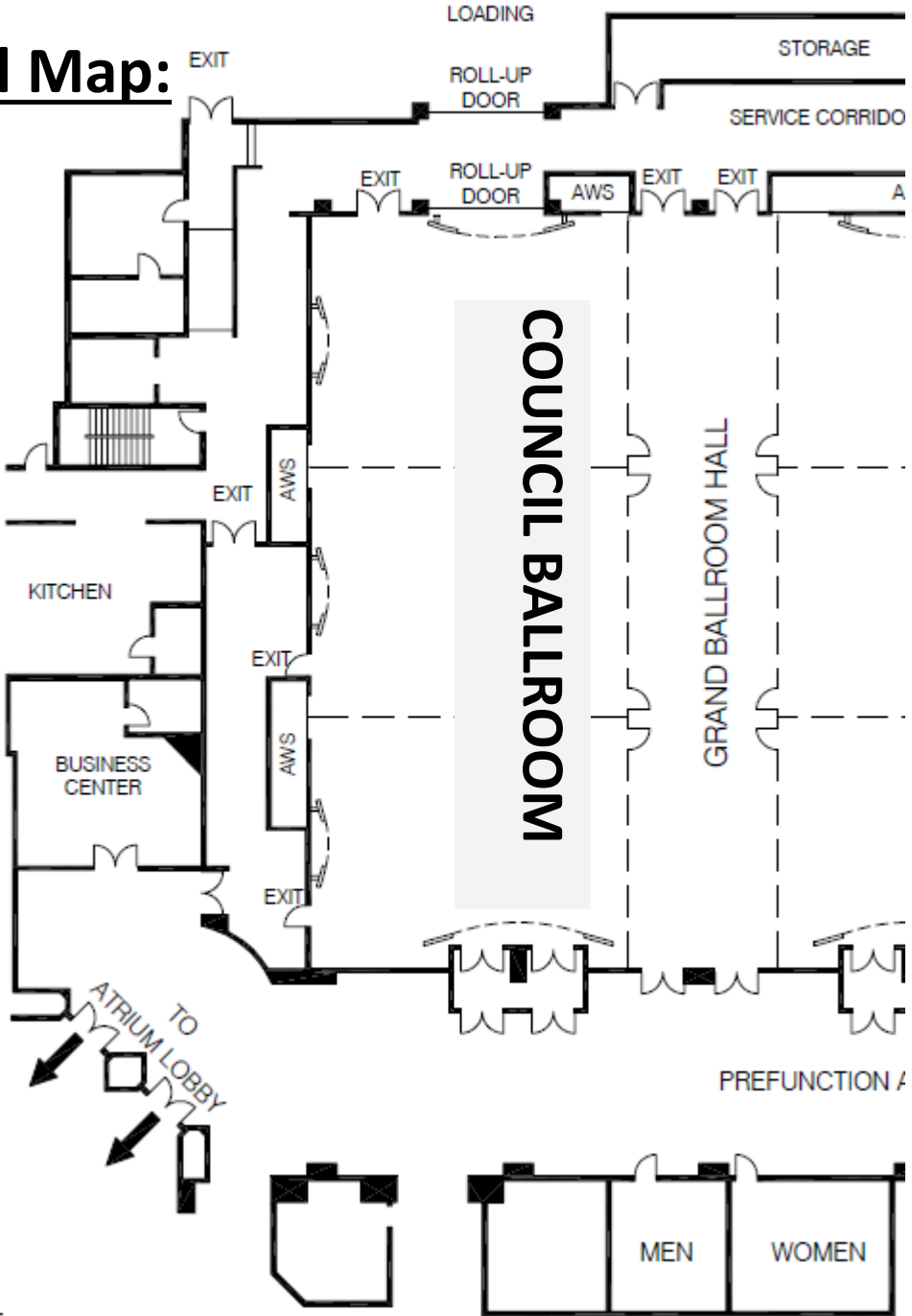
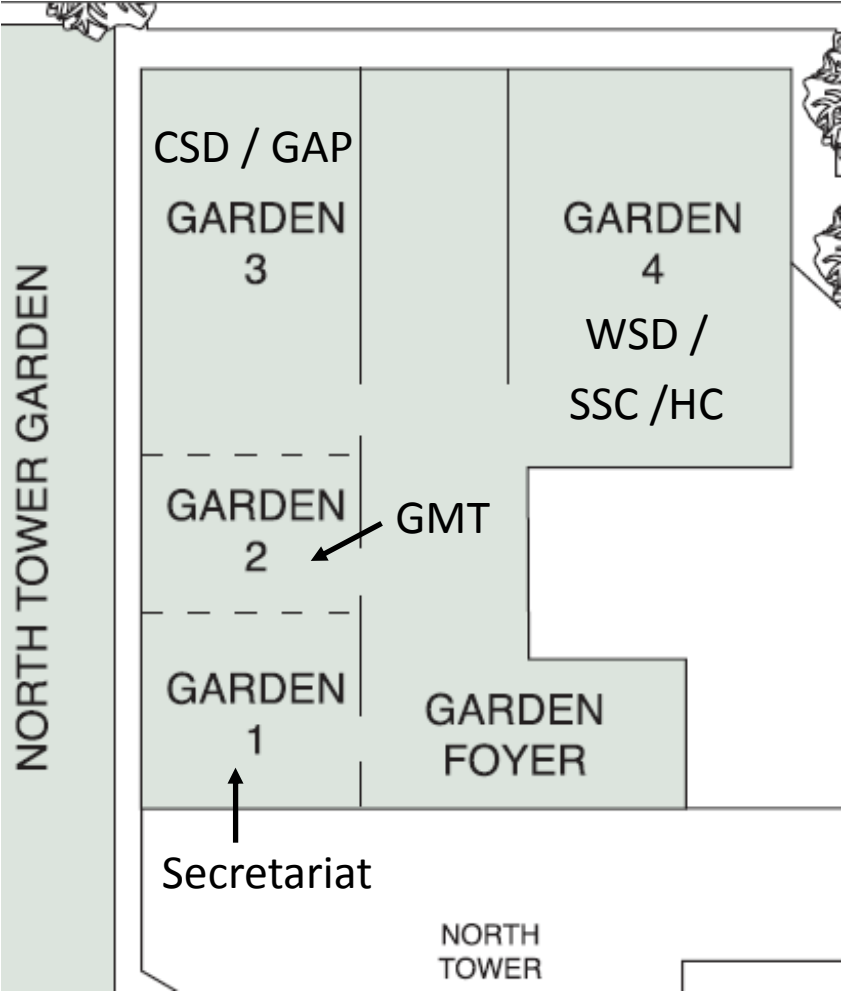

North Tower, 2nd Floor Meeting Rooms

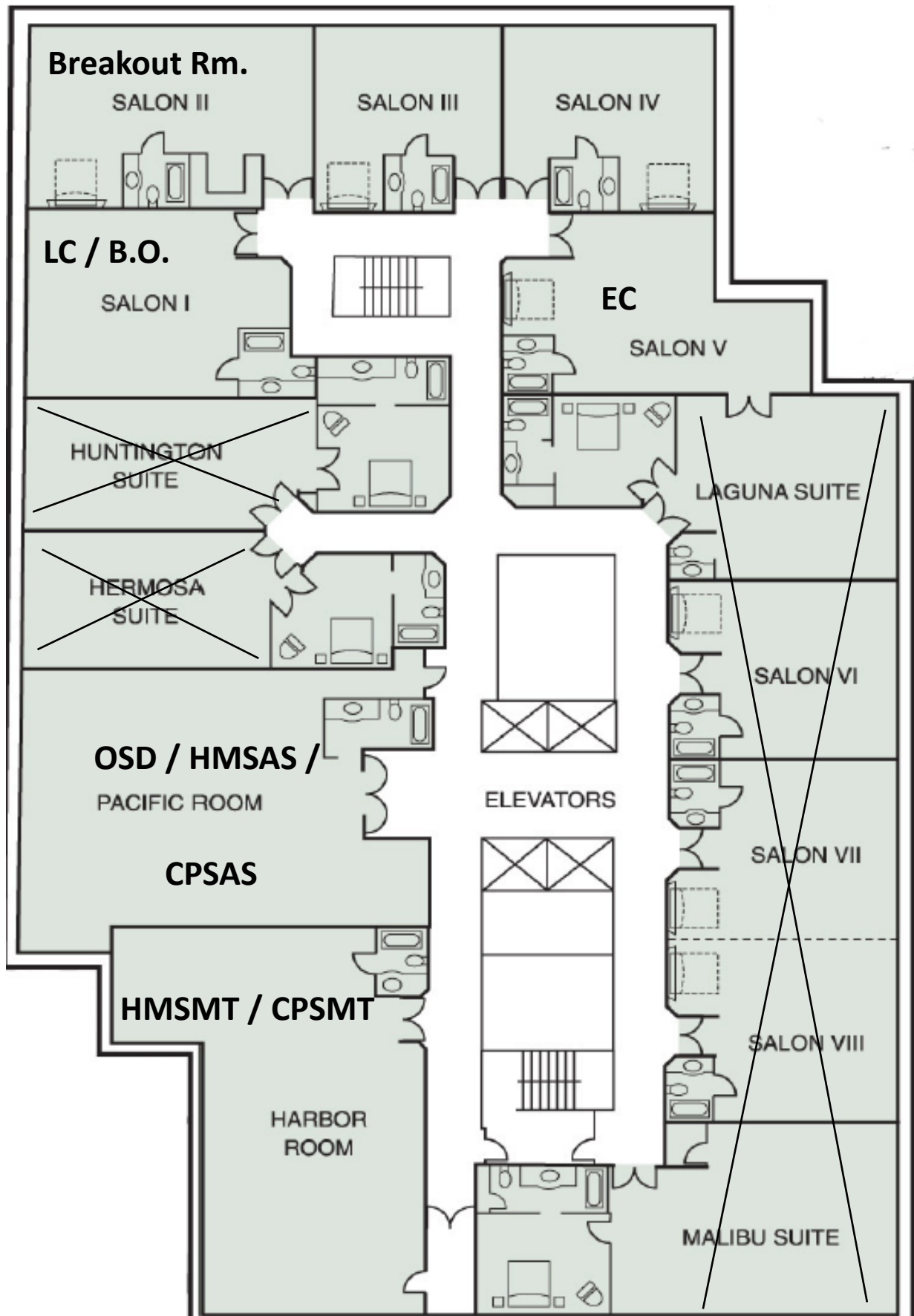

MEMBERSHIP ROSTER



MAY 30, 2014



Roster published by the Pacific Fishery Management Council pursuant to National Oceanic and Atmospheric Administration contract number NA10NMF4410014

PACIFIC FISHERY MANAGEMENT COUNCIL

7700 NE Ambassador Place, Suite 101 – Portland, Oregon 97220-1384
Telephone 503-820-2280 – Toll Free 866-806-7204 – Fax: 503-820-2299
Website www.pcouncil.org

COUNCIL STAFF

<u>Name</u>	<u>Title</u>	<u>Extension</u>	<u>Email</u>
Kim Ambert	Administrative Specialist	421	Kimberly.Ambert@noaa.gov
Kelly Ames	Staff Officer: Groundfish and Pacific Halibut	426	Kelly.Ames@noaa.gov
Mike Burner	Staff Officer: Salmon, Ecosystem Management	414	Mike.Burner@noaa.gov
John Coon	Operations and Transitions Specialist	412	John.Coon@noaa.gov
Patricia Crouse	Fiscal Specialist	408	Patricia.Crouse@noaa.gov
Kit Dahl	Staff Officer: Highly Migratory Species, NEPA	422	Kit.Dahl@noaa.gov
John DeVore	Staff Officer: Groundfish, Scientific and Statistical Committee	413	John.Devore@noaa.gov
Renee Dorval	Administrative Specialist	420	Renee.Dorval@noaa.gov
Jennifer Gilden	Staff Officer: Habitat, Information, Communications, Legislative Matters	418	Jennifer.Gilden@noaa.gov
Kerry Griffin	Staff Officer: Coastal Pelagic Species, Marine Protected Areas, Essential Fish Habitat	409	Kerry.Griffin@noaa.gov
Donald Hansen	Special Assistant to the Executive Director		Don.Hansen@noaa.gov
Kris Kleinschmidt	Information Technology Specialist	425	Kris.Kleinschmidt@noaa.gov
Sandra Krause	Senior Information Technology Specialist	419	Sandra.Krause@noaa.gov
Donald Mclsaac	Executive Director		Donald.Mclsaac@noaa.gov
Carolyn Porter	Executive Specialist	411	Carolyn.Porter@noaa.gov
Jim Seger	Staff Officer: Fishery Economics and Enforcement Consultants	416	Jim.Seger@noaa.gov
Chuck Tracy	Deputy Director	415	Chuck.Tracy@noaa.gov
Brett Wiedoff	Staff Officer: Groundfish, Electronic Monitoring	424	Brett.L.Wiedoff@noaa.gov

LEGAL COUNSEL

Ryan Couch
Northwest Section

National Oceanic and Atmospheric
Administration, Office of General
Counsel, Northwest Section
7600 Sand Point Way NE, BIN C15700
Seattle, WA 98115-6300

Telephone: 206-526-6097
Email: Ryan.Couch@noaa.gov

Judson Feder
Southwest Section

National Oceanic and Atmospheric
Administration, Office of General
Counsel, Southwest Section
501 West Ocean Boulevard, Ste 4470
Long Beach, CA 90802-4213

Telephone: 562-980-4067
Email: Judson.Feder@noaa.gov

Sheila Lynch
Northwest Section

National Oceanic and Atmospheric
Administration, Office of General
Counsel, Northwest Section
7600 Sand Point Way NE, BIN C15700
Seattle, WA 98115-6300

Telephone: 206-526-6533
Email: Sheila.Lynch@noaa.gov

Mariam McCall
Northwest Section

National Oceanic and Atmospheric
Administration, Office of General
Counsel, Northwest Section
7600 Sand Point Way NE, BIN C15700
Seattle, WA 98115-6300

Telephone: 206-526-4504
Email: Mariam.McCall@noaa.gov

COUNCIL MEMBERS

ANDERSON, MR. PHIL State of Washington Principal Official	Director Washington Dept. of Fish and Wildlife 600 Capitol Way N Olympia, WA 98501-1091	Telephone: 360-902-2720 Email: philip.anderson@dfw.wa.gov
1 st Designee: Ms. Michele Culver 2 nd Designee: Mr. Kyle Adicks	michele.culver@dfw.wa.gov vincent.adicks@dfw.wa.gov	Telephone: 360-249-1211 Telephone: 360-902-2664
BONHAM, MR. CHUCK State of California Principal Official	California Dept. of Fish and Wildlife Director 1416 Ninth Street Sacramento, CA 95814	Telephone: 916-653-7667 Email: director@wildlife.ca.gov
1 st Designee: Ms. Marci Yaremko 2 nd Designee: Ms. Joanna Grebel 3 rd Designee: Mr. Bob Farrell 4 th Designee: Dr. Craig Shuman	marci.yaremko@wildlife.ca.gov joanna.grebel@wildlife.ca.gov bob.farrell@wildlife.ca.gov craig.shuman@wildlife.ca.gov	Telephone: 858-442-3004 Telephone: 831-649-2804 Telephone: 707-477-6657 Telephone: 805-568-1246
BRIZENDINE, MR. BUZZ At-Large Appointment	2838 Garrison Street San Diego, CA 92106	Telephone: 619-933-7828 Email: buzzbriz@gmail.com
CAMPBELL, MS. CORA (nonvoting) State of Alaska Principal Official	Commissioner, Alaska Dept. of Fish and Game PO Box 115526 Juneau, AK 99811-5526	Telephone: 907-465-4100 Email: dfg.commissioner@alaska.gov
Designee: Mr. David Bedford	david.bedford@alaska.gov	Telephone: 907-465-4115
CRABBE, MR. DAVID California Obligatory Appointment	PO Box 4224 Carmel, CA 93921	Telephone: 831-622-6826 Email: dcrabbe@comcast.net
ELICKER, MR. ROY State of Oregon Principal Official	Director, Oregon Dept. of Fish and Wildlife 4034 Fairview Industrial Drive SE Salem, OR 97302	Telephone: 503-947-6000 Email: roy.elicker@state.or.us
1 st Designee: Ms. Gway Kirchner 2 nd Designee: Mr. Troy Buell 3 rd Designee: Dr. Caren Braby 4 th Designee: Mr. Chris Kern	gway.r.kirchner@state.or.us troy.v.buell@state.or.us caren.e.braby@state.or.us j.chris.kern@state.or.us	Telephone: 541-867-0300 ext. 267 Telephone: 541-867-0300 ext. 225 Telephone: 541-867-4741 Telephone: 971-673-6031
FELDNER, MR. JEFF At-Large Appointment	470 Killdeer Drive Siletz, OR 97380	Telephone: 541-444-2460 Email: jfeldner@jnrcom.com
GROMLICH, RDML RICHARD (nonvoting) U.S. Coast Guard	U.S. Coast Guard 915 Second Ave, Rm 3590 Seattle, WA 98174-1067	Telephone: 206-220-7090 Email: richard.t.gromlich@uscg.mil
1 st Designee: LCDR Gregg Casad 2 nd Designee: Mr. Brian Corrigan	gregg.w.casad@uscg.mil brian.p.corrigan@uscg.mil	Telephone: 206-220-7305 Telephone: 206-220-7309
HAESEKER, DR. STEVEN (nonvoting) USFWS	U.S. Fish and Wildlife Service 1211 SE Cardinal Ct, Ste 100 Vancouver, WA 98683	Telephone: 360-604-2500 Email: steve_haeseker@fws.gov
Designee: Ms. Christina Wang	Christina_wang@fws.gov	Telephone: 360-604-2583
HANSON, DR. DAVID (nonvoting) Parliamentarian Pacific States Marine Fisheries Commission	Pacific States Marine Fisheries Commission 3468 22nd Street NW Hackensack, MN 56452	Telephone: 503-805-2372 Email: dave_hanson@psmfc.org
HOGAN, MR. DAVID (nonvoting) U.S. State Dept.	U.S. Dept. of State LES/OMC, Room 2758 2201 C St NW, Ste 2758 Washington, DC 20520	Telephone: 202-647-2335 Email: HoganDF@State.gov

COUNCIL MEMBERS (CONTINUED)

LINCOLN, MR. RICH Washington Obligatory Appointment	1410 113 th Avenue SE Olympia, WA 98501	Telephone: 503-320-3278 Email: rlincolnabroad@hotmail.com
LOWMAN, MS. DOROTHY Chair Oregon Obligatory Appointment	6507 SW Barnes Road Portland, OR 97225	Telephone: 503-804-4234 Email: dmlowman01@comcast.net
MOORE, MR. VIRGIL State of Idaho Principal Official 1st Designee: Mr. Cal Groen 2nd Designee: Mr. Dave Ortmann	Director, Idaho Dept. of Fish and Game PO Box 25 Boise, ID 83707-0025 crgroen@hotmail.com cdadavid@aol.com	Telephone: Email: Telephone: 208-553-5825 Telephone: 208-765-8733
MYER, MR. DALE At-Large Appointment	Arctic Storm, Inc. 400 N 34th St, Ste 306 Seattle, WA 98103	Telephone: 206-547-6557 Email: dmyer@arcticstorm.com
POLLARD, MR. HERB Vice Chair Idaho Obligatory Appointment	2169 S Linda Vista Place Boise, ID 83709	Telephone: 208-859-0263 Email: hapollard@yahoo.com
SONES, MR. DAVID Tribal Appointment	PO Box 618 Neah Bay, WA 98357	Telephone: 360-645-2193 Email: ddavid160@centurytel.net
STELLE, MR. WILLIAM NMFS West Coast Region Designee: Mr. Bob Turner Designee: Mr. Frank Lockhart Designee: Mr. Mark Helvey Designee: Dr. Peter Dygert Designee: Mr. Kevin Duffy	Regional Administrator, West Coast Region National Marine Fisheries Service 7600 Sand Point Way NE, BIN C15700 Seattle, WA 98115-0070 bob.turner@noaa.gov frank.lockhart@noaa.gov mark.helvey@noaa.gov peter.dygert@noaa.gov kevin.duffy@noaa.gov	Telephone: 206-526-6150 Email: Will.Stelle@noaa.gov Telephone: 360-753-5825 Telephone: 206-526-6142 Telephone: 562-980-4040 Telephone: 206-526-6734 Telephone: 206-526-4743
WOLFORD, MR. DAN At-Large	16171 Jasmine Way Los Gatos, CA 95032	Telephone: 408-356-2465 Email: danwolford@earthlink.net

STANDING COUNCIL MEMBER COMMITTEES

Budget Committee

MR. DAVID ORTMANN, Chair
MS. MICHELE CULVER
DR. DAVID HANSON
MS. DOROTHY LOWMAN
MR. DALE MYER
MR. DAN WOLFORD
MR. BOB TURNER

LEGISLATIVE COMMITTEE

DR. DAVID HANSON, Chair
MR. DAVID CRABBE
MS. DOROTHY LOWMAN
MR. DALE MYER
MR. DAN WOLFORD

REPRESENTATIVES TO OTHER FORUMS

Ms. Dorothy Lowman

*Council Coordinating Committee Video and Electronic
Monitoring Subcommittee* (June 2012)

Ms. Dorothy Lowman

Western and Central Pacific Fisheries Commission

Ms. Gway Kirchner

Ms. Michele Culver / Mr. Tom Marking

*International Pacific Halibut Commission (IPHC)
IPHC Management Strategy Advisory Body*

Ms. Michele Culver

Alternate: Ms. Gway Kirchner

Regional Planning Body for West Coast Region (June 2012)

Mr. Buzz Brizendine

U.S. – Canada Albacore Treaty Forum

Mr. Phil Anderson

*U.S. Section of the Joint Management Committee of the
U.S. – Canada Pacific Hake/Whiting Agreement* (April 2011)

ADVISORY BODIES

COASTAL PELAGIC SPECIES ADVISORY SUBPANEL

CARROLL, MR. RICHARD Processor	Ilwaco Fish Company PO Box 800 Ilwaco, WA 98624	Telephone: 360-642-3773 Email: rcarroll@ilwacofish.com
HAWORTH, MR. DAVID California Commercial	F/V Barbara H 4369 Niagra Avenue San Diego, CA 92107	Telephone: 619-884-3247 Email: tiffnick147@aol.com
HOINSKY, Ms. TERRY California Commercial	President, Fishermen's Union of America 30554 Santa Luna Drive Ranchos Palos Verdes, CA 90275	Telephone: 310-833-5434 Email: terry.hoinsky@cox.net
JURLIN, MR. NICK California Commercial	Southbound Fisheries, Inc. 133 The Promenade N., Unit 317 Long Beach, CA 90802	Telephone: 310-344-9310 Email: fveileen@gmail.com
LAW, MR. EUGENE Oregon Commercial	754 Olalla Rd Toledo, OR 97391	Telephone: 541-336-2645 Email: mslaw2645@hotmail.com
McTEE, Ms. SARAH Conservation	Environmental Defense Fund 123 Mission Street, 28 th Floor San Francisco, CA 94105	Telephone: 415-293-6103 Email: smctee@edf.org
OKONIEWSKI , MR. MIKE Co-Chair Processor	Pacific Seafood 1635 Down River Dr Woodland, WA 98674	Telephone: 360-225-8553 Email: mokoniewski@pacseafood.com
PLESCHNER-STEELE, Ms. DIANE Co-Chair Processor	Executive Director, California Wetfish Producers Association PO Box 1951 Buellton, CA 93427	Telephone: 805-693-5430 Email: dplesch@earthlink.net
STRASSER, CPT PAUL California Charter/Sport	Owner, Independence Sportfishing 3430 Mulldae Avenue San Pedro, CA 90732	Telephone: 310-612-4747 Email: paulstrasser112@gmail.com
ZUANICH, MR. ROBERT P. Washington Commercial	Purse Seine Vessels' Owners Association, Executive Director 1900 W Nickerson, Ste 320 Seattle, WA 98119	Telephone: 206-283-7733 Email: rpz@psvoa.com

COASTAL PELAGIC SPECIES MANAGEMENT TEAM

VACANCIES: One NMFS SWFSC Position.

DORVAL, DR. EMMANIS NMFS	National Marine Fisheries Service 8901 La Jolla Shores Drive La Jolla, CA 92037	Telephone: 858-337-7385 Email: emmanis.dorval@noaa.gov
EMMETT, DR. ROBERT Co-Chair NMFS	NOAA Fisheries NWFSC Pt. Adams Research Station PO Box 155 Hammond, OR 97121	Telephone: 503-861-1818 ext. 31 Email: robert.emmett@noaa.gov
HILL, DR. KEVIN NMFS	National Marine Fisheries Service PO Box 271 La Jolla, CA 92038-0271	Telephone: 858-546-7052 Email: kevin.hill@noaa.gov
LYNN, MR. KIRK CDFW	California Dept. of Fish and Wildlife 8901 La Jolla Shores Drive La Jolla, CA 92037	Telephone: 858-546-7167 Email: kirk.lynn@wildlife.ca.gov
PROTASIO, Ms. CHELSEA CDFW	California Dept. of Fish and Wildlife 20 Lower Ragsdale Drive, Suite 100 Monterey, CA 93940	Telephone: 831-649-2994 Email: chelsea.protasio@wildlife.ca.gov
SARICH, MR. ALAN TRIBAL	Quinalt Indian Nation PO Box 189 Taholah, WA 98587	Telephone: 360-276-8215 ext. 465 Email: asarich@quinault.org
SCHMITT, Ms. CYREIS ODFW	Oregon Dept. of Fish and Wildlife 2040 SE Marine Science Dr. Newport, OR 97365-5294	Telephone: 541-867-0300 ex. 265 Email: cyreis.c.schmitt@state.or.us
WARGO, Ms. LORNA Co Chair WDFW	Washington Dept. of Fish and Wildlife 48 Devonshire Road Montesano, WA 98563	Telephone: 360-249-1221 Email: lorna.wargo@dfw.wa.gov

ECOSYSTEM ADVISORY SUBPANEL

ADAMS, DR. PETE California	Adams Fishery Consulting 544 Mariano Drive Sonoma, CA 95476	Telephone: 415-279-0685 Email: petebadams@gmail.com
DYE, MR. PAUL Chair Washington	The Nature Conservancy 1917 First Avenue Seattle, WA 98101	Telephone: 206-436-6238 Email: pdye@tnc.org
ENTICKNAP, MR. BEN Oregon	Pacific Project Manager, Oceana 222 NW Davis Street, Ste. 200 Portland, OR 97209	Telephone: 503-235-0278 Email: BEnticknap@oceana.org
FOSMARK, MS. KATHY California	F/V Seeadler PO Box 1338 Pebble Beach, CA 93953	Telephone: 831-238-0647 Email: Kfosmark@aol.com
KLINGER, DR. TERRIE Washington	School of Marine and Environmental Affairs Box 355685, University of Washington Seattle, WA 98105-6715	Telephone: 206-685-2499 Email: tklinger@uw.edu
MARUSKA, MR. DON California	San Luis Obispo Science and Ecosystem Alliance 895 Napa Avenue, Ste. A-5 Morro Bay, CA 93442	Telephone: 805-772-4667 Email: dmaruska@slosea.org
McMULLEN, MR. SCOTT Oregon	Oregon Fishermen's Cable Comm. 2021 Marine Drive, Ste 102 Astoria, OR 97103	Telephone: 503-325-2285 Email: smcmullen@ofcc.com
STONE, MR. NATE Washington	Fury Group, Inc. 4005 20 th Avenue W, Ste 207 Seattle, WA 98199	Telephone: 206-783-3844 Email: furygroup@aol.com
WARRENS, MR. FRANK Vice Chair Oregon	President, Frank Warrens Automotive and Marine Services, Inc. 50 NW 20th Ave Portland, OR 97209-1903	Telephone: 503-228-6607 Email: frank@frankwarrensauto.com

ENFORCEMENT CONSULTANTS

CHADWICK, SGT. DAN
Washington

Washington Dept. of Fish and Wildlife
PO Box 553
Naselle, WA 98638

Telephone: 360-581-3337
Email: dan.chadwick@dfw.wa.gov

CORRIGAN, MR. BRIAN
Interim Chair
13th Coast Guard District

U.S. Coast Guard
915 2nd Ave, Rm 3562
Seattle, WA 98174-1067

Telephone: 206-220-7309
Email: brian.p.corrigan@uscg.mil

GIAMMANCO, LCDR JOE
11th Coast Guard District

U.S. Coast Guard
Coast Guard Island, Bldg. 50-5
Alameda, CA 94501-5100
Shannon.m.anthony@uscg.mil

Telephone: 510-437-3374
Email: joseph.s.giammanco@uscg.mil

Designee: **LT Shannon Anthony**

Telephone: 510-437-5332

GILES, ACTING SAC BILL
NMFS West Coast Region

Special Agent in Charge
National Marine Fisheries Service
7600 Sand Point Way NE, BIN C15700
Seattle, WA 98115-0070
dayna.matthews@noaa.gov

Telephone: 206-526-6133
Email: william.giles@noaa.gov

Designee: **Mr. Dayna Matthews**

Telephone: 360-753-4409

PUCCINELLI, CAPT. ROBERT
California

California Dept. of Fish and Wildlife
20 Lower Ragsdale Drive, Suite 100
Monterey, CA 93940

Telephone: 831-649-2901
Email: robert.puccinelli@wildlife.ca.gov

SAGAPOLU, SAC MARTINA
NMFS West Coast Region

Special Agent in Charge, NMFS West
Coast Region
501 W. Ocean BLVD, Ste. 4300
Long Beach, CA 90802
nicholas.call@noaa.gov

Telephone: 562-980-4050
Email: martina.sagapolu@noaa.gov

Designee: **SA Nicholas Call**

Telephone: 707-575-6075

SCHWARTZ, LT TIM
Oregon

Oregon State Police, Fish and Wildlife
General Headquarters
255 Capitol Street NE, 4th Floor
Salem, OR 97310

Telephone: 503-934-0222
Email: tim.schwartz@state.or.us

ESSENTIAL FISH HABITAT REVIEW COMMITTEE (GROUND FISH)

BOWLBY, MR. ED NMS Designee: Ms. Karen Reyna	NOAA Olympic Coast NMS 115 East Railroad Ave., Suite 301 Port Angeles, WA 98362	Telephone: 360-457-6622 Email: ed.bowlby@noaa.gov
COPPS, MR. STEVE NMFS WCR	National Marine Fisheries Service 7600 Sand Point Way, NE Seattle, WA 98115-0070	Telephone: Email: steve.copps@noaa.gov
EDER, MR. ROBERT Commercial Fixed Gear	F/V Timmy Boy PO Box 721 Newport, OR 97365	Telephone: 541-265-6633 Email: 1roberteder@gmail.com
GOLDFINGER, DR. CHRIS Academic	Oregon State University Ocean Administration Building, Unit 102 Corvallis, OR 97331	Telephone: 541-737-2064 Email: gold@coas.oregonstate.edu
GREENE, DR. GARY Academic	Moss Landing Marine Laboratories 8272 Moss Landing Road Moss Landing, CA 95039	Telephone: 831-633-7264 Email: greene@mlml.calstate.edu
MACKEY, Ms. MEGAN Vice Chair Conservation	Ecotrust 721 NW 9 th Avenue, Suite 200 Portland, OR 97209	Telephone: 503-467-0784 Email: mmackey@ecotrust.org
MATTHEWS, MR. DAYNA NMFS WCR	National Marine Fisheries Service Office of Law Enforcement 510 Desmond Drive SE, Suite 103 Lacey, WA 98503	Telephone: 360-753-4409 Email: dayna.matthews@noaa.gov
PETTINGER, MR. BRAD Chair Commercial Trawl	Oregon Trawl Commission 16289 Hwy 101 South, Suite C Brookings, OR 97415	Telephone: 541-469-7830 Email: bpettinger@ortrawl.net
SCHUMACKER, MR. JOE Tribal Designee: Ms. Jennifer Hagen	Quinault Indian Nation PO Box 424 Taholah, WA 98587 jennifer.hagen@quileutenation.org	Telephone: 360-276-8215 Email: jschumacker@quinault.org Telephone: 360-374-2059
SHESTER, DR. GEOFF Conservation	Oceana CA Program Director 99 Pacific Street, Suite 155C Monterey, CA 93940	Telephone: 831-643-9266 Email: gshester@oceana.org
STADLER, DR. JOHN NMFS WCR	National Marine Fisheries Service Fish Biologist, WCR EFH Coordinator 510 Desmond Drive SE, Suite 103 Lacey, WA 98503	Telephone: 360-534-9328 Email: john.stadler@noaa.gov
WAKEFIELD, DR. WALDO NMFS NWFSC	National Marine Fisheries Service 2032 SE OSU Drive Newport, OR 97365	Telephone: 541-867-0542 Email: waldo.wakefield@noaa.gov
YOKLAVICH, Ms. MARY NMFS SWFSC	National Marine Fisheries Service 110 Shaffer Road Santa Cruz, CA 95060	Telephone: 831-420-3940 Email: mary.yoklavich@noaa.gov

GROUNDFISH ALLOCATION COMMITTEE – VOTING MEMBERS

VACANCIES: One CDFW and One ODFW Position.

ANDERSON, MR. PHIL WDFW	Washington Dept. of Fish and Wildlife 600 Capitol Way N Olympia, WA 98501-1091	Telephone: 360-902-2720 Email: philip.anderson@dfw.wa.gov
HANSON, DR. DAVID Pacific States Marine Fisheries Commission	Pacific States Marine Fisheries Commission 3468 22nd Street NW Hackensack, MN 56452	Telephone: 218-675-5231 Email: dave_hanson@psmfc.org
LOCKHART, MR. FRANK NMFS WCR	National Marine Fisheries Service 7600 Sand Point Way, NE Seattle, WA 98115-0070	Telephone: 206-526-6142 Email: frank.lockhart@noaa.gov
WOLFORD, MR. DAN Chair At-Large	16171 Jasmine Way Los Gatos, CA 95032	Telephone: 408-356-2465 Email: danwolford@earthlink.net

GROUNDFISH ALLOCATION COMMITTEE – NON-VOTING

BORNSTEIN, MR. ANDREW Shoreside Processing	Bornstein Seafoods PO Box 58 Astoria, OR 97103	Telephone: 503-325-6164 Email: Andrew@bornstein.com
GHIO, MR. TOM Open Access Fishery	Ghio Fish Company 112 Gilbert CT Santa Cruz, CA 95065	Telephone: 831-295-5511 Email: ghiofish2000@yahoo.com
JUD, MR. SHEMS Conservation	Environmental Defense Fund 1749 Regency Street West Linn, OR 97068	Telephone: 503-358-7053 Email: sjud@edf.org
LEIPZIG, MR. PETER Limited Entry Non-Whiting Trawl	Executive Director, Fisherman's Marketing Association 1585 Heartwood Drive, Ste E McKinleyville, CA 95519	Telephone: 707-840-0182 Email: pete@trawl.org
LONGO EDER, MS. MICHELE Limited Entry Fixed Gear	F/V Timmy Boy PO Box 721 Newport, OR 97365	Telephone: 541-265-3337 Email: michele@michelelongoeder.com
OSBORN, MR. ROBERT Recreational Fisher	United Anglers of Southern California PO Box 385 Surfside, CA 90743	Telephone: 562-592-0857 Email: bob@pacificangler.com
WALDECK, MR. DANIEL A. At-sea Processing	Executive Director, Pacific Whiting Conservation Cooperative 2505 SE 11 th Avenue, Suite 358 Portland, OR 97202	Telephone: 971-544-7787 Email: dwaldeck@comcast.net

GROUND FISH ADVISORY SUBPANEL

ALVERSON, MR. ROBERT Fixed Gear At-Large	Fishing Vessel Owner's Association 4005 - 20th Ave W, Room 232 Seattle, WA 98199-1290	Telephone: 206-283-7735 Email: roberta@fvoa.org
ANCONA, MR. TOM Chair Bottom Trawl	Tommy's Marine Service - F/V Caito Bros, Inc. PO Box 1227 Fort Bragg, CA 95437	Telephone: 707-964-5423 Email: ancona@mcn.org
BUTLER, MR. WAYNE Oregon Charter Boat Operator	Prowler Charters PO Box 674 Bandon, OR 97411	Telephone: 541-260.0899 Email: wayne.b1@mycomspan.com
CEDERGREEN, MR. MARK Washington Charter Boat Operator	Westport Charterboat Association PO Box 546 Westport, WA 98595-0546	Telephone: 360-268-0445 Email: mcedergreen@olynet.com
CHAMBERS, MS. SUSAN Processor At-Large	PO Box 3447 Coos Bay, OR 97420	Telephone: 541-297-2875 Email: pelagics1618@gmail.com
DUNN, MR. KEVIN Trawl At-Large	180 West Irving Avenue Astoria, OR 97103-6418	Telephone: 503-440-2866 Email: kdunn3201@charter.net
HOLLOWAY, MR. JOHN Vice Chair Sport Fisheries At-Large	Executive Board Secretary, Oregon Anglers/Oregon RFA 6823 SW Burlingame Ave Portland, OR 97219-2127	Telephone: 503-245-1281 Email: RFAoregon@comcast.net
INGLES, MR. ROBERT C. California Charter North of Pt Conception	Golden Gate Fisherman's Association PO Box 3728 Hayward, CA 94544	Telephone: 510-581-2628 Email: sherry@fishingboat.com
JONER, MR. STEVE Tribal Fisheries	Makah Fisheries Management 113 Shaffer Road Port Angeles, WA 98363	Telephone: 360-461-3249 Email: gofish@olypen.com
JUD, MR. SHERMS Conservation	Environmental Defense Fund 1749 Regency Street West Linn, OR 97068	Telephone: 503-358-7053 Email: sjud@edf.org
LIBBY, MR. TOM E. Processor	CA Shellfish Co., Inc. 90085 Logan Road Astoria, OR 97103	Telephone: 503-325-5276 Email: Tom.CalShell@gmail.com
LONGO-EDER, MS. MICHELE Fixed Gear At-Large	Michele Longo-Eder Attorney At Law, LLC PO Box 1530 Newport, OR 97365	Telephone: 541-265-3337 Email: michele@michelelongoeder.com
MANN, MS. HEATHER Mid-Water Trawl	Midwater Trawlers Cooperative PO Box 176 Siletz, OR 97380	Telephone: 541-272-4544 Email: heathermunromann@gmail.com

Groundfish Advisory Subpanel *(continued)*

MARKING, MR. TOM Sport Fisheries At-Large	1456 Whitmire Avenue McKinleyville, CA 95519	Telephone: 707-839-2073 Email: tmmarking@gmail.com
MILES, MR. JEFF Open Access North of Cape Mendocino	PO Box 424 Port Orford, OR 97465	Telephone: 541-332-1835 Email: JanDDmiles@frontier.com
PAINE, MR. BRENT Trawl At-Large	United Catcher Boats Association 4005 20 th Avenue West, Suite 116 Seattle, WA 98199	Telephone: 206-282-2599 Email: bpaine@ucba.org
PLATT, MR. DAN Southern Open Access	STMA 16791 Franklin Road Fort Bragg, CA 95437	Telephone: 707-813-7221 Email: morefish@mcn.org
RICHTER, MR. GERRY Fixed Gear At-Large	B & G Seafoods, Inc. 217 Calle Manzanita Santa Barbara, CA 93105	Telephone: 805-569-3099 Email: gdrfish@msn.com
SEILER, MR. DAVE Washington Sport Fisher At- Large	9538 Gate Road SW Olympia, WA 98512	Telephone: 360-273-7548 Email: kndseiler@gmail.com
WALDECK, MR. DANIEL A. At-Sea Processor	Executive Director, Pacific Whiting Conservation Cooperative 2505 SE 11 th Avenue, Suite 348 Portland, OR 97202	Telephone: 971-544-7787 Email: dwaldeck@comcast.net
ZIMM, MR. LOUIS California Charter North of Point Conception	Sportfishing Association of California 3762 Dupont Street San Diego, CA 92106	Telephone: 619-224-7908 Email: glzimm@cox.net

Groundfish Endangered Species Workgroup

AGNESS, Ms. ALISON Protected Resources	National Marine Fisheries Service 7600 Sand Point Way NE Seattle, WA 98115	Telephone: 206-526-6152 Email: Alison.agness@noaa.gov
BJORKLAND, DR. RHEMA Sea Turtle Taxa	Duke University, Marine Laboratory Beaufort, NC 28516	Telephone: Email: rhema.bjorkland@duke.edu
BRABY, DR. CAREN ODFW	Oregon Dept. of Fish and Wildlife 2040 SE Marine Science Drive Newport, OR 97365	Telephone: 541-867-4741 Email: caren.e.braby@state.or.us
COPPS, MR. STEVE NMFS WCR	National Marine Fisheries Service 7600 Sand Point Way, NE Seattle, WA 98115-0070	Telephone: Email: steve.copps@noaa.gov
GOOD, MR. THOMAS Seabird Taxa	National Marine Fisheries Service 2725 Montlake Blvd E Seattle, WA 98112-2097	Telephone: 206-860-3220 Email: tom.good@noaa.gov
GREBEL, Ms. JOANNA CDFW	California Dept. of Fish and Wildlife 20 Lower Ragsdale Drive, Suite 100 Monterey, CA 93940	Telephone: 831-649-2804 Email: joanna.grebel@wildlife.ca.gov
GUSTAFSON, DR. RICHARD Fish Taxa	National Marine Fisheries Service 2725 Montlake Blvd E Seattle, WA 98112-2097	Telephone: Email:
HANSON, MR. BRAD Marine Mammal Taxa	National Marine Fisheries Service 2725 Montlake Blvd E Seattle, WA 98112-2097	Telephone: 206-860-3220 Email: brad.hanson@noaa.gov
JANNOT, DR. JASON Observer Program	National Marine Fisheries Service 2725 Montlake Blvd E Seattle, WA 98112-2097	Telephone: 206-302-1755 Email: jason.jannot@noaa.gov
NILES, MR. COREY WDFW	Washington Dept. of Fish and Wildlife 48 Devonshire Road Montesano, WA 98563-9618	Telephone: 360-249-1223 Email: corey.niles@dfw.wa.gov
SCORDINO, MR. JONATHAN WA Coast Tribal	Makah Tribe Fisheries Management PO Box 115 Neah Bay, WA 98357	Telephone: 360-645-3176 Email: jonathan.scordino@makah.com
TODD, Ms. LAURA USFWS	U.S. Fish and Wildlife Service 2127 SE Marine Science Drive Newport, OR 97365	Telephone: 541-867-4558 Email:

GROUNDFISH MANAGEMENT TEAM

VACANCIES: One West Coast Groundfish Observer Program Position.

BRADY, MR. COLBY NMFS WCR	National Marine Fisheries Service 7600 Sand Point Way NE Seattle, WA 98115	Telephone: 206-526-6117 Email: colby.brady@noaa.gov
BUDRICK, MR. JOHN CDFW	California Dept. of Fish and Wildlife 350 Harbor Blvd. Belmont, CA 94002	Telephone: 650-413-1501 Email: john.budrick@wildlife.ca.gov
ERICKSON, MR. DANIEL Chair ODFW	Oregon Dept. of Fish and Wildlife 2040 SE Marine Science Drive Newport, OR 97365	Telephone: 541-867-0300 ext. 229 Email: Daniel.L.Erickson@state.or.us
JONES, MR. ROBERT F. Tribal Agency	Northwest Indian Fisheries Commission PO Box 1029 Forks, WA 98331	Telephone: 360-374-5501 Email: rjones@nwifc.org
KOSAKA, Ms. ROSEMARY NMFS SWFSC	NOAA/NMFS Fisheries Ecology Division 110 Shaffer Road Santa Cruz, CA 95060	Telephone: 831-420-3988 Email: rosemary.kosaka@noaa.gov
LEOS, MR. ROBERT CDFW	California Dept. of Fish and Wildlife 20 Lower Ragsdale Drive, Suite 100 Monterey, CA 93940	Telephone: 831-649-2889 Email: robert.leos@wildlife.ca.gov
MATSON, DR. SEAN NMFS WCR	National Marine Fisheries Service 7600 Sand Point Way NE Seattle, WA 98115	Telephone: 206-526-6187 Email: sean.matson@noaa.gov
MATTES, Ms. LYNN ODFW	Oregon Dept. of Fish and Wildlife 2040 SE Marine Science Drive Newport, OR 97365	Telephone: 541-867-0300 ex. 237 Email: lynn.mattes@state.or.us
NILES, MR. COREY WDFW	Washington Dept. of Fish and Wildlife 48 Devonshire Road Montesano, WA 98563-9618	Telephone: 360-249-1223 Email: corey.niles@dfw.wa.gov
REED, Ms. HEATHER Vice Chair WDFW	Washington Dept. of Fish and Wildlife 48 Devonshire Road Montesano, WA 98563-9618	Telephone: 360-249-1202 Email: reedhjr@dfw.wa.gov
TAYLOR, DR. IAN NMFS NWFSC	NMFS NWFSC 2725 Montlake Blvd. East Seattle, WA 98112	Telephone: 206-861-7603 Email: ian.taylor@noaa.gov

HABITAT COMMITTEE

VACANCIES: One Northwest or Columbia River Tribal Position.

DEHART, DR. DOUGLAS Conservation	Coffee Creek Bioscience 915 Clearbrook Drive Oregon City, OR 97045	Telephone: 503-701-4578 Email: ddehart@onemain.com
GREENE, DR. CORREIGH NMFS NWFSC	National Marine Fisheries Service NWFSC 2725 Montlake Blvd. East Seattle, WA 98112-2097	Telephone: 206-860-5611 Email: correigh.greene@noaa.gov
GRUNDER, MR. SCOTT IDFG	Idaho Dept. of Fish and Game 600 S Walnut, PO Box 25 Boise, ID 83707-0025	Telephone: 208-287-2774 Email: scott.grunder@idfg.idaho.gov
HAESEKER, DR. STEVEN (nonvoting) USFWS Designee: Ms. Christina Wang	U.S. Fish and Wildlife Service 1211 SE Cardinal Ct, Ste 100 Vancouver, WA 98683 Christina_wang@fws.gov	Telephone: 360-604-2500 Email: steve_haeseker@fws.gov Telephone: 360-604-2583
HAMILTON, MS. LIZ Sport Fisheries At-Large	Executive Director, Northwest Sportfishing Industry Association PO Box 4 Oregon City, OR 97045-0004	Telephone: 503-631-8859 Email: nsializ@aol.com
KAWAHARA, MR. JOEL Co-Chair Commercial Fisheries	3652 Lindsay Hill Rd Quilcene, WA 98376	Telephone: 206-406-7026 Email: joelkaw@earthlink.net
MEREMS, MS. ARLENE ODFW	Oregon Dept. of Fish and Wildlife 2040 SE Marine Science Drive Newport, OR 97365	Telephone: 541-867-0300 ex. 246 Email: arlene.r.merems@state.or.us
ORCUTT, MR. MIKE California Tribes	Hoopla Valley Tribe PO Box 930 Hoopla, CA 95546-0417	Telephone: 530-625-4267 Email: director@hoopla-nsn.gov
QUAN, MS. JENNIFER WDFW	Washington Dept. of Fish and Wildlife PO Box 43137 Olympia, WA 98504	Telephone: 360-902-2224 Email: jennifer.quan@dfw.wa.gov
RECHT, MS. FRAN Co-Chair PSMFC	Pacific States Marine Fisheries Commission PO Box 221 Depoe Bay, OR 97341-0221	Telephone: 541-765-2229 Email: franrecht@centurytel.net
SCHEIBLAUER, MR. STEPHEN At-Large	Harbormaster, City of Monterey 256 Figueroa Street Monterey, CA 93940	Telephone: 831-646-3951 Email: scheibla@ci.monterey.ca.us
STADLER, DR. JOHN NMFS WCR Designee: Ms. Korie Schaeffer	National Marine Fisheries Service 1201 NE Lloyd Blvd., Ste. 1100 Portland, OR 97232 korie.schaeffer@noaa.gov	Telephone: 503-231-6290 Email: john.stadler@noaa.gov Telephone: 707-575-6087

Habitat Committee *(continued)*

WILKINS, MR. ERIC
CDFW

California Dept. of Fish and Wildlife
Senior Environmental Scientist
20 Lower Ragsdale Drive, Suite 100
Monterey, CA 93940

Telephone: 831-649-2813
Email: eric.wilkins@wildlife.ca.gov

WOONINCK, DR. LISA
National Marine Sanctuaries

Office of National Marine Sanctuaries
West Coast Regional Office
99 Pacific Street, Bldg. 200 – Ste K
Monterey, CA 93940

Telephone: 831-647-1920
Email: lisa.wooninck@noaa.gov

HIGHLY MIGRATORY SPECIES ADVISORY SUBPANEL

VACANCIES: One Processor South of Cape Mendocino

BUELL, Ms. LINDA
Northern Charter Boat
Operator

7695 Galloway Road
Cloverdale, OR 97112

Telephone: 503-965-2238
Email: norwester@garibaldicharters.com

DUPUY, Mr. PETE
Commercial At-Large

Ocean Pacific Sea Food
18212 Rosita St
Tarzana, CA 91356

Telephone: 818-343-9927
Email: lapazkd@aol.com

FARWELL, Mr. CHUCK
Conservation

Monterey Bay Aquarium,
Tuna Research and Conservation
886 Cannery Row
Monterey, CA 93940

Telephone: 831-648-4826
Email: cfarwell@mbayaq.org

FELANDO, Mr. AUGUST
Commercial Purse Seine

870 San Antonio Pl
San Diego, CA 92106

Telephone: 619-223-7654
Email: augustfelando@aol.com

FOSMARK, Mr. STEVEN
Commercial Gillnet Fisheries

Owner/Operator, F/V Seeadler
3059 Sherman Rd
Pebble Beach, CA 93953

Telephone: 831-373-5238
Email: fvseeadler@aol.com

FRICKE, Mr. DOUGLAS
Chair
Commercial At-Large

Boat Seafoods
PO Box 2402
Westport, WA 98595

Telephone: 360-580-3027
Email: dfricke@techline.com

HEIKKILA, Mr. WAYNE
Vice Chair
Commercial Troll

Executive Director, Western Fishboat
Owner's Association
PO Box 992723
Redding, CA 96099

Telephone: 530-229-1097
Email: wfoa@charter.net

MARCHAND, JR., Mr. PIERRE
Processor

President, Jessie's Ilwaco Fish
Company
PO Box 800
Ilwaco, WA 98624-0800

Telephone: 360-642-3773
Email: pierrem@ilwacofish.com

OSBORN, Mr. ROBERT
Private Recreational

United Anglers of Southern California
PO Box 385
Surfside, CA 90743

Telephone: 562-857-6949
Email: bob@pacificangler.com

SUTTON, Mr. BILL
Commercial At-Large

F/V Aurelia
876 S Rice Rd
Ojai, CA 93023

Telephone: 805-646-9685
Email: seafreshto@aol.com

THOMPSON, Mr. MIKE
Southern Charter Boat
Operator

26032 Via Del Rey
San Juan Capistrano, CA 92675

Telephone: 949-675-0551
Email: mthompson041@cox.net

TOM, Ms. PAMELA
Public At-Large

University of California
Food Science and Technology Dept.
One Shields Avenue
Davis, CA 95616

Telephone: 530-752-1465 msg only
Email: pdtom@ucdavis.edu

HIGHLY MIGRATORY SPECIES MANAGEMENT TEAM

HEBERER, MR. CRAIG
Co Chair
NMFS West Coast Region

U.S. Fish and Wildlife Service
2177 Salk Avenue
Carlsbad, CA 92008

Telephone: 760-431-9440 ex. 303
Email: craig.heberer@noaa.gov

HUGHES, MR. KIRT
Chair
WDFW

Washington Dept. of Fish and Wildlife
48 Devonshire Road
Montesano, WA 98563

Telephone: 360-480-2421
Email: kirt.hughes@dfw.wa.gov

LAUGHLIN, MS. LEEANNE
CDFW

California Dept. of Fish and Wildlife
4665 Lampson Ave, Ste C
Los Alamitos, CA 90720

Telephone: 562-342-7167
Email: leeanne.laughlin@wildlife.ca.gov

NORTHCUT, MR. KRIS
Tribal Agency

Quileute Natural Resources
PO Box 187
La Push, WA 98350

Telephone: 360-374-6074
Email: kris.northcut@quileutenation.org

SCHMITT, MS. CYREIS
Co Chair
ODFW

Oregon Dept. of Fish and Wildlife
2040 SE Marine Science Dr
Newport, OR 97365-5294

Telephone: 541-867-4741
Email: cyreis.c.schmitt@state.or.us

SIPPEL, DR. TIM
NMFS SWFSC

National Marine Fisheries Service
8901 La Jolla Shores Dr.
La Jolla, CA 92037-1508

Telephone:
Email: tim.sippel@noaa.gov

STOHS, DR. STEPHEN
NMFS SWFSC

National Marine Fisheries Service
PO BOX 271
La Jolla, CA 92037-1508

Telephone: 858-546-7084
Email: Stephen.Stohs@noaa.gov

TAYLOR, MS. HEIDI
NMFS West Coast Region

National Marine Fisheries Service
501 W Ocean Blvd, Ste 4200
Long Beach, CA 90802

Telephone: 562-980-4039
Email: heidi.taylor@noaa.gov

MODEL EVALUATION WORKGROUP

CLEMONS, MR. ETHAN ODFW	Oregon Dept. of Fish and Wildlife 2040 SE Marine Science Drive Newport, OR 97365	Telephone: 541-867-0300 ex. 242 Email: Ethan.R.Clemons@state.or.us
HAGEN-BREAUX, MS. ANGELIKA WDFW	Washington Dept. of Fish and Wildlife 600 Capitol Way N Olympia, WA 98501-1091	Telephone: 360 902-2841 Email: angelika.hagen-breaux@dfw.wa.gov
Designee: Mr. Jim Packer	packejfp@dfw.wa.gov	Telephone: 360-902-2754
JOHNSON, DR. GALEN Tribal Agency	Northwest Indian Fisheries Commission 6730 Martin Way E Olympia, WA 98516-5540	Telephone: Email: gjohnson@nwifc.org
LAVOY, MR. LARRIE Vice Chair NMFS WCR	National Marine Fisheries Service 510 Desmond Drive SE, Ste 103 Lacey, WA 98503	Telephone: 360-753-4063 Email: larrie.lavoy@noaa.gov
PALMER-ZWAHLEN, MS. MELODIE CDFW	California Dept. of Fish and Wildlife 5355 Skylane Blvd., Suite B Santa Rosa, CA 95403	Telephone: 707-576-2870 Email: melodie.palmer@wildlife.ca.gov
RANKIS, MR. ANDY Chair NW Indian Fisheries Commission	Northwest Indian Fisheries Commission 6730 Martin Way E Olympia, WA 98516	Telephone: 360-438-1181 ex. 322 Email: arankis@nwifc.org
SHARMA, MR. RISHI Columbia River Inter-Tribal Fish Commission	Columbia River Inter-Tribal Fish Commission 729 NE Oregon St, Ste 200 Portland, OR 97232	Telephone: 503-238-0667 Email: shar@critfc.org
YUEN, MR. HENRY USFWS	U.S. Fish and Wildlife Service 1211 SE Cardinal Ct, Ste 100 Vancouver, WA 98683	Telephone: 360-604-2500 Email: henry_yuen@fws.gov

SALMON ADVISORY SUBPANEL

VACANCIES: One California Troll and California Gillnet Position.

FRANK, MR. CALVIN Washington Tribes	Quinault Indian Nation PO box 373 Bay Center, WA 98527	Telephone: 360-942-7809 Email: calvin.frankcf@gmail.com
GORELNIK, MR. MARC California Sport Fisheries	Coastside Fishing Club 8042 Terrace Drive El Cerrito, CA 94530	Telephone: 415-409-9529 Email: marc@gorelniklaw.com
HEAP, MR. RICHARD Vice Chair Oregon Sport Fisheries	95975 N. Brookside Drive Brookings, OR 97415	Telephone: 541-469-7111 Email: fiskare@charter.net
HEIKKILA, MR. PAUL Oregon Troll	786 S. 1st Ave. Coquille, OR 97423	Telephone: 541-396-3096 Email: heikkilaart@gmail.com
HIE, MR. JIM Conservation	Pacific Marine Conservation Council 1423 Vista Ave Napa, CA 94559	Telephone: 707-695-8661 Email: jnahie@att.net
HILLEMEIER, MR. DAVE California Tribes	Yurok Tribe PO Box 1027 Klamath, CA 95548	Telephone: 707-482-1350 ext. 315 Email: Dave@yuroktribe.nsn.us
OLSON, MR. JIM Washington Troll	F/V Cynthia T PO Box 586 Auburn, WA 98071-0586	Telephone: 253-833-8739 Email: Jaocto@juno.com
REINHOLDT, MR. GERALD K. Processor	Reinholdt Fisheries 62313 S Canaan Rd St. Helens, OR 97051-9117	Telephone: 503-397-3369 Email: reinholdtfish@gmail.com
SCULLY, DR. RICHARD Idaho Sport Fisheries	2428 Seaport Drive Lewiston, ID 83501	Telephone: 208-241-4095 Email: scullyrjs@cableone.net
SMITH, MR. BUTCH Chair Washington Charter Boat	Co-Ho Charters PO Box 268 Ilwaco, WA 98624	Telephone: 360-642-3333 Email: coho@willapabay.org
SORENSEN, MR. MIKE Oregon Charter Boat	603 Camp 12 Lp Toledo, OR 97391	Telephone: 541-444-2552 Email: fvmissraven@hotmail.com
STONE, MR. CRAIG California Charter Boat	Emeryville Sportfishing 3310 Powell St Emeryville, CA 94608	Telephone: 510-654-6040 Email: emvlsport@aol.com
WATROUS, MR. STEVE Washington Sport Fisheries	Garonaire, Inc. 2515 Kauffman Ave Vancouver, WA 98660	Telephone: 360-696-1604 Email: branchofic@aol.com

SALMON TECHNICAL TEAM

VACANCIES: One Tribal Position.

FOSTER, MR. CRAIG
ODFW

Oregon Dept. of Fish and Wildlife
17330 SE Evelyn St
Clackamas, OR 97015

Telephone: 971-673-6026
Email: craig.a.foster@state.or.us

KOPE, DR. ROBERT
Chair
NMFS NWFSC

National Marine Fisheries Service
2725 Montlake Blvd E
Seattle, WA 98112-2097

Telephone: 206-860-3374
Email: robert.kope@noaa.gov

LAVOY, MR. LARRIE
NMFS WCR

National Marine Fisheries Service
510 Desmond Drive SE, Ste 103
Lacey, WA 98503

Telephone: 360-753-4063
Email: larrie.lavoy@noaa.gov

MILWARD, MR. DOUG
WDFW

Washington Dept. of Fish and Wildlife
600 Capitol Way N
Olympia, WA 98501-1091

Telephone: 360-902-2739
Email: douglas.milward@dfw.wa.gov

O'FARRELL, DR. MICHAEL
Vice Chair
NMFS SWFSC

National Marine Fisheries Service
110 Shaffer Rd
Santa Cruz, CA 95060

Telephone: 831-420-3976
Email: michael.ofarrell@noaa.gov

PALMER-ZWAHLEN, MS. MELODIE
CDFW

California Dept. of Fish and Wildlife
5355 Skylane Blvd., Suite B
Santa Rosa, CA 95403

Telephone: 707-576-2870
Email: melodie.palmer@wildlife.ca.gov

YUEN, MR. HENRY
USFWS

U.S. Fish and Wildlife Service
1211 SE Cardinal Ct, Ste 100
Vancouver, WA 98683

Telephone: 360-604-2500
Email: henry_yuen@fws.gov

SCIENTIFIC AND STATISTICAL COMMITTEE

VACANCIES: One NMFS SWFSC Position and one IDFG Representative.

COOPER, DR. ANDREW At-Large	Simon Fraser University 8888 University TASC 1 Bldg. Rm 8408 Burnaby, BC CANADA V5A 1S6	Telephone: 778-782-3954 Email: andrew_cooper@sfu.ca
DORN, DR. MARTIN NMFS Alaska Fisheries Science Center	National Marine Fisheries Service 7600 Sand Point Way NE, BIN C15700 Seattle, WA 98115-0070	Telephone: 206-526-6548 Email: martin.dorn@noaa.gov
GERTSEVA, DR. VLADLENA At-Large	NMFS NWFSC 2725 Montlake Blvd. East Seattle, WA 98112	Telephone: 206-860-3457 Email: vladlena.gertseva@noaa.gov
HAMEL, DR. OWEN NMFS Northwest Fisheries Science Center	National Marine Fisheries Service 2725 Montlake Blvd E Seattle, WA 98112	Telephone: 206-860-3481 Email: owen.hamel@noaa.gov
HUPPERT, DR. DANIEL At-Large	2314 N. 37 th Street Seattle, WA 98103	Telephone: 206-543-0111 Email: huppert@uw.edu
JAGIELO, MR. TOM At-Large	Fisheries Service Consultant 2744 NE 54 th Street Seattle, WA 98105	Telephone: 360-791-9089 Email: tomjagiello@msn.com
JOHNSON, DR. GALEN Tribal Agency	Northwest Indian Fisheries Commission 6730 Martin Way E Olympia, WA 98516-5540	Telephone: Email: gjohnson@nwifc.org
KEY, MS. MEISHA Chair CDFW	California Dept. of Fish and Wildlife C/O NMFS SWFSC 110 Shaffer Road Santa Cruz, CA 95060	Telephone: 831-420-3973 Email: meisha.key@wildlife.ca.gov
LAWSON, DR. PETER NMFS Northwest Fisheries Science Center	National Marine Fisheries Service 2030 S Marine Science Dr Newport, OR 97365-5296	Telephone: 541-867-0430 Email: Peter.W.Lawson@noaa.gov
LEE, DR. TODD At-Large	NOAA/NWFSC/Fram Division 2725 Montlake Blvd. East Seattle, WA 98112-2097	Telephone: 206-302-2436 Email: todd.lee@noaa.gov
PUNT, DR. ANDRE At-Large	University of Washington Box 355020 Seattle, WA 98195-5020	Telephone: 206-221-6319 Email: aepunt@u.washington.edu
SAMPSON, DR. DAVID ODFW	Oregon State University Coastal Oregon Marine Experiment Sta. 2030 SE Marine Science Drive Newport, OR 97365	Telephone: 541-867-0386 Email: David.Sampson@OregonState.edu

Scientific and Statistical Committee *(continued)*

SATTERTHWAITE, DR. WILLIAM
Vice Chair
 At-Large

National Marine Fisheries Service
 110 Shaffer Rd
 Santa Cruz, CA 95060

Telephone: 831-420-3997
 Email: will.satterthwaite@noaa.gov

THOMSON, Ms. CINDY
 NMFS Southwest Fisheries
 Science Center

National Marine Fisheries Service
 110 Shaffer Rd
 Santa Cruz, CA 95060

Telephone: 831-420-3911
 Email: Cindy.Thomson@noaa.gov

TSOU, DR. TIEN SHUI
 WDFW

Washington Dept. of Fish and Wildlife
 600 Capitol Way North
 Olympia, WA 98501

Telephone: 360-902-2855
 Email: Tien-Shui.Tsou@dfw.wa.gov

SSC Subcommittee Assignments, June 2014

Salmon	Groundfish	Coastal Pelagic Species	Highly Migratory Species	Economics	Ecosystem-Based Management
Pete Lawson	Vlada Gertseva	André Punt	André Punt	Cindy Thomson	Martin Dorn
Owen Hamel	Andrew Cooper	Owen Hamel	Andrew Cooper	Vlada Gertseva	Vlada Gertseva
Galen Johnson	Martin Dorn	Dan Huppert	David Sampson	Dan Huppert	Pete Lawson
Meisha Key	Owen Hamel	Tom Jagielo		Todd Lee	Galen Johnson
Will Satterthwaite	Tom Jagielo	Meisha Key		André Punt	Todd Lee
	Meisha Key			David Sampson	André Punt
	André Punt				Will Satterthwaite
	David Sampson				Cindy Thomson
	Tien-Shui Tsou				Tien-Shui Tsou

Bold denotes Subcommittee Chairperson

AD HOC COUNCIL COMMITTEES

Cost Recovery Committee (June 2011)

Culver, Ms. Michele	Fisher, Mr. Randy (Chair)	Giles, Mr. Bill	Jincks, Mr. David
Lockhart, Mr. Frank	McClure, Ms. Michelle	Moore, Mr. Rod	Paine, Mr. Brent
Pettinger, Mr. Brad	Waldeck, Mr. Dan		

Ecosystem Workgroup (June 2013)

deReynier, Ms. Yvonne	Gilbertson, Dr. Larry	Lindsay, Mr. Josh	Niles, Mr. Corey
Schmitt, Ms. Cyreis	Scully, Dr. Richard	Wilson-Vandenberg, Ms. Deb	

Groundfish Amendment 24 Workgroup (April 2012)

Biegel, Ms. Sarah	Dorn, Dr. Martin	Duffy, Mr. Kevin	Grebel, Ms. Joanna
Hastie, Dr. Jim	Mattes, Ms. Lynn	McCall, Ms. Mariam	Moore, Mr. Rod
Niles, Mr. Corey			

Groundfish Electronic Monitoring Policy Advisory Committee (June 2013)

Alverson, Mr. Bob	Bettencourt, Mr. Geoff	Hanson, Dr. Dave	Hunter, Mr. Travis
Jud, Mr. Shems	Kujala, Mr. Paul	Mann, Ms. Heather	McElderry, Mr. Howard
Paine, Mr. Brent			

Groundfish Electronic Monitoring Technical Advisory Committee (June 2013)

Brady, Mr. Colby	Chadwick, Sgt. Dan	Colpo, Mr. Dave	Matthews, Mr. Dayna
McCall, Ms. Mariam	McVeigh, Mr. Jon	Puccinelli, Mr. Bob	Sommer, Ms. Maggie

Groundfish Process Improvement Committee (November 2010)

Cope, Dr. Jason	Culver, Ms. Michele	Dorn, Dr. Martin	Duffy, Mr. Kevin
Kirchner, Ms. Gway	Lockhart, Mr. Frank	Lynch, Ms. Sheila	Mattes, Ms. Lynn
Niles, Mr. Corey	Waldeck, Mr. Dan	Williams, Ms. Sarah	Wolford, Mr. Dan

Lower Columbia River Natural Coho Workgroup (March 2014)

Beamsderfer, Ray	Ellis, Mr. Stuart (Chair)	Jording, Mr. Jeromy (Vice Chair)	Kern, Mr. Chris
LeFleur, Ms. Cindy	Milward, Mr. Doug	Patiño, Mr. Enrique	Rankis, Mr. Andy
Whisler, Mr. Jeff			

Mitchell Act Committee (September 2010)

Cedergreen, Mr. Mark	Haeseker, Dr. Steve	Ortmann, Mr. Dave	Sones, Mr. David
----------------------	---------------------	-------------------	------------------

South of Humbug Pacific Halibut Policy Committee (June 2012)

Culver, Ms. Michelle	Duffy, Mr. Kevin	Williams, Mr. Gregg	Yaremko, Ms. Marci
----------------------	------------------	---------------------	--------------------

South of Humbug Pacific Halibut Workgroup (April 2012)

Mattes, Ms. Lynn Reed, Ms. Heather Williams, Mr. Gregg Williams, Ms. Sarah
Wilson-Vandenberg, Ms. Deb

Trawl Rationalization Regulatory Evaluation Committee (April 2011)

Bornstein, Mr. Andrew Chadwick, Sgt. Dan Erickson, Mr. Dan Farrell, Mr. Bob
Goen, Ms. Jamie Hanson, Dr. Dave Hunter, Mr. Travis Jincks, Mr. David
Kujala, Mr. Paul Larkin, Mr. Marion Libby, Mr. Tom Matthews, Mr. Dayna
Moore, Mr. Rod Paine, Mr. Brent

ACRONYMS USED IN THIS ROSTER

ADFG.... Alaska Dept. of Fish and Game
CDFW ... California Dept. of Fish and Wildlife
IATTC... Inter-American Tropical Tuna Commission
IDFG Idaho Dept. of Fish and Game
NMFS.... National Marine Fisheries Service
NMS National Marine Sanctuaries
NOAA ... National Oceanic and Atmospheric
Administration

NWFSC... Northwest Fisheries Science Center
ODFW Oregon Dept. of Fish and Wildlife
PFMC..... Pacific Fishery Management Council
PSMFC.... Pacific States Marine Fisheries Commission
SWFSC ... Southwest Fisheries Science Center
USFWS ... United States Fish and Wildlife Service
WCR West Coast Region
WDFW Washington Dept. of Fish and Wildlife

PFMC
05/30/14